

**Attachment A**  
**Subsurface Utility Easement Parcels**

15040

2004-417

| BW #  | PIN        | OWNER  |
|-------|------------|--|
| 44-13 | 1737310130 | GLITHERO THOMAS P. & JAN E.  |
| 44-14 | 1737310120 | THOMPSON JAMES V. & KRISTEN L.   |
| 44-15 | 1737300140 | FREY ROBERT A. & JANET A.  |
| 44-16 | 1737300130 | CARTER JAMES G. & JANET E.   |
| 44-17 | 1737300120 | THOMPSON DAVID P. & MAUDJEAN   |
| 44-19 | 1737300010 | DAOURA PETER W. & KRISTI J.  |
| 44-20 | 9492100190 | FUKURA GLENN T. & DALE E.  |
| 44-21 | 9492100200 | WOOD DAVID WAYNE & JEANNE R.   |
| 44-22 | 9492100210 | GRAVES RONALD V. & JANET B.  |
| 44-23 | 9492100220 | LANDA JORGE FELIX & SHIRLEY MAY  |
| 44-24 | 0626059037 | LANDA JORGE F. & SHIRLEY M.  |
| 44-25 | 0626059197 | MONAHAN JAMES T.   |
| 44-26 | 0626059208 | PRICER LEWIS L. & VIRGINIA E.  |
| 44-27 | 0626059289 | DOUD ROBERT D. & APRIL   |
| 44-28 | 0626059128 | VEILLEUX MELISSA & KISER GERALD  |
| 44-30 | 0526059080 | FIRST BAPTIST CHURCH OF BOTHELL, WASHINGTON, INC.                                      |
| 44-31 | 0526059162 | BLUE CEDAR LLC   |
| 44-33 | 0526059048 | BEAN JACK S.   |
| 44-34 | 3927000330 | S/I NORTH CREEK II, L.L.C.   |
| 44-35 | 3927000010 | CORPORATION OF THE PRESIDING BISHOP OF THE CHURCH OF JESUS CHRIST OF LATTER-DAY SAINTS |
| 44-36 | 3927000340 | S/I NORTH CREEK II, L.L.C.   |
| 44-37 | 6137850020 | STEJUN INVESTMENT, INC.  |
| 44-38 | 8030008888 | STONEBROOK CONDOMINIUM   |
| 44-39 | 626059005  | STACK DENIS M  |
| 41-5  | 0426059009 | RET DEFINED FIXED BENEFIT PENSION PLAN & TRUST   |
| 41-7  | 0426059014 | RET DEFINED FIXED BENEFIT PENSION PLAN & TRUST   |
| 41-8  | 3395430410 | FRASER ROBERT T. & DONNA D.  |
| 41-9  | 3395430420 | DILLENBECK RANDY A. & SHIRLEY D.   |
| 41-10 | 3395430430 | PICKRELL CHARLEENE M.  |
| 41-11 | 3395430440 | THOMPSON-BIRDSALL ANNE   |
| 41-12 | 3395430550 | HAIGHT VERONA O.   |
| 41-13 | 3395430540 | MANGUM MICHAEL A. & ALYSON N.  |
| 41-14 | 3395430530 | SACCO ANNELIES J.  |
| 41-15 | 3395430780 | WILDER, BONNIE M.  |
| 41-16 | 3395430790 | CHEIRRETT MARGARET G.  |
| 41-17 | 3395430800 | NICHOLAS RICHARD S. & WENDI F.   |
| 41-18 | 3395440080 | GORMLEY ROSEMARY C.  |
| 41-22 | 3395467777 | HOLLYHILLS OWNERS ASSOCIATION, INC   |
| 41-23 | 3395437777 | HOLLYHILLS OWNERS ASSOCIATION, INC   |
| NCC-1 | 6979200320 | PHOENIX MUTUAL LIFE INSURANCE COMPANY  |
| NCC-2 | 6979200050 | ALLSTATE INSURANCE COMPANY   |
| NCC-3 | 6979200080 | BOTHELL PROPERTIES, INC.   |
| NCC-4 | 6979200040 | CURRAN PROPERTIES L.P.   |

**Attachment A  
Subsurface Utility Easement Parcels**

**15040**

**Shoreline Segment – (Outfall to Portal 5) Subsurface Utility Easements**

| PARCEL ID | TAX PIN        | OWNER NAME     | SITE ADDRESS                       | SEGMENT   |
|-----------|----------------|----------------|------------------------------------|-----------|
| 19-2      | 27033500300600 | BRIGGS KAREN E | 20450 RICHMOND BEACH DR<br>WOODWAY | SHORELINE |

**SEGMENT 19-2 BRIGGS - LEGAL DESCRIPTION:**

**PARCEL A**

LOT 1 OF TOWN OF WOODWAY SHORT PLAT RECORDED FEBRUARY 9, 1990 AND RECORDED UNDER RECORDING NO. 9002090297, IN SNOHOMISH COUNTY, WASHINGTON.

**PARCEL B**

A NON-EXCLUSIVE EASEMENT FOR INGRESS AND EGRESS AS DELINEATED ON SAID SHORT PLAT.  
COUNTY OF SNOHOMISH, STATE OF WASHINGTON

| PARCEL ID | TAX PIN        | OWNER NAME        | SITE ADDRESS                       | SEGMENT   |
|-----------|----------------|-------------------|------------------------------------|-----------|
| 19-3      | 27033500302300 | LEITNER JEFFREY D | 20452 RICHMOND BEACH DR<br>WOODWAY | SHORELINE |

**SEGMENT 19-3 LEITNER - LEGAL DESCRIPTION:**

**PARCEL A**

LOT 2 OF TOWN OF WOODWAY SHORT PLAT RECORDED FEBRUARY 9, 1990 UNDER RECORDING NO. 9002090297, IN SNOHOMISH COUNTY, WASHINGTON.

**PARCEL B**

A NON-EXCLUSIVE EASEMENT FOR INGRESS AND EGRESS AS DELINEATED ON SAID SHORT PLAT.  
COUNTY OF SNOHOMISH, STATE OF WASHINGTON

| PARCEL ID | TAX PIN    | OWNER NAME                       | SITE ADDRESS                  | SEGMENT   |
|-----------|------------|----------------------------------|-------------------------------|-----------|
| 19-4      | 0226039172 | PRIDEMORE<br>DAVID W & CYNTHIA K | 2621 NW 205TH ST<br>SHORELINE | SHORELINE |

**SEGMENT 19-4 PRIDEMORE - LEGAL DESCRIPTION:**

THE NORTH 156.60 FEET OF GOVERNMENT LOT 1, SECTION 2, TOWNSHIP 26 NORTH, RANGE 3 EAST, W.M., IN KING COUNTY, WASHINGTON, LYING EASTERLY OF THE GREAT NORTHERN RAILWAY RIGHT-OF-WAY,

EXCEPT THE EAST 660.00 FEET THEREOF,

AND EXCEPT THE FOLLOWING DESCRIBED PORTION:

BEGINNING AT THE INTERSECTION OF THE SOUTHERLY LINE OF THE SAID NORTH 156.60 FEET WITH THE EASTERLY LINE OF RICHMOND BEACH DRIVE (OLYMPIC AVENUE);

THENCE EASTERLY ALONG SAID SOUTHERLY LINE 315.00 FEET;

THENCE NORTHERLY PARALLEL WITH THE EASTERLY LINE OF GOVERNMENT LOT 1, 140.00 FEET;

THENCE WESTERLY ALONG A LINE PARALLEL TO THE NORTHERLY LINE OF SAID GOVERNMENT LOT 1 TO EASTERLY LINE OF SAID RICHMOND BEACH DRIVE;

THENCE SOUTHERLY ALONG SAID EASTERLY LINE TO THE POINT OF BEGINNING.

COUNTY OF KING, STATE OF WASHINGTON

| PARCEL ID | TAX PIN    | OWNER NAME                     | SITE ADDRESS                  | SEGMENT   |
|-----------|------------|--------------------------------|-------------------------------|-----------|
| 19-5      | 1837700010 | DEOBALD LYLE R<br>& JESSIE KIM | 20425 25TH AV NW<br>SHORELINE | SHORELINE |

**SEGMENT 19-5 DEOBALD - LEGAL DESCRIPTION:**

LOT 1 OF CRESTMOOR ADDITION, ACCORDING TO PLAT RECORDED IN VOLUME 56 OF PLATS AT PAGE (S) 7, IN KING COUNTY, WASHINGTON.  
COUNTY OF KING, STATE OF WASHINGTON

**Attachment A  
Subsurface Utility Easement Parcels**

**15040**

| PARCEL ID | TAX PIN    | OWNER NAME                 | SITE ADDRESS                  | SEGMENT   |
|-----------|------------|----------------------------|-------------------------------|-----------|
| 19-6      | 7280300152 | MATTHEWS<br>DANA CHRISTINE | 2320 NW 204TH ST<br>SHORELINE | SHORELINE |

**SEGMENT 19-6 MATTHEWS - LEGAL DESCRIPTION:**

LOT 29 OF RICHMOND BEACH VILLA SITES, ACCORDING TO PLAT RECORDED IN VOLUME 10 OF PLATS AT PAGE(S) 65, IN KING COUNTY, WASHINGTON.  
EXCEPT THAT PORTION THEREOF DESCRIBED AS FOLLOWS:  
COMMENCING AT THE MOST SOUTHERLY CORNER OF SAID LOT 29;  
THENCE NORTH 0°00'22" WEST ALONG THE EAST LINE OF LOT 29, A DISTANCE OF 152.0 FEET;  
THENCE SOUTH 62°09'11" WEST A DISTANCE OF 74.14 FEET;  
THENCE IN A SOUTHWESTERLY DIRECTION 35 FEET, MORE OR LESS, TO A POINT ON THE WEST LINE OF LOT 29 WHICH BEARS NORTH 44°05'32" WEST 135 FEET FROM THE POINT OF BEGINNING;  
THENCE SOUTH 44°05'32" WEST 135 FEET ALONG THE WEST LINE OF LOT 29 TO THE POINT OF BEGINNING.  
TOGETHER WITH THAT PORTION OF VACATED NORTHWEST 205TH ADJOINING SAID LOT 29 ON THE NORTH.  
TOGETHER WITH THAT PORTION OF LOT 30, RICHMOND BEACH VILLA SITES ADDITION, ACCORDING TO PLAT THEREOF, RECORDED IN VOLUME 10 OF PLATS, PAGE 65, IN KING COUNTY, WASHINGTON, DESCRIBED AS FOLLOWS:  
COMMENCING AT THE NORTHEAST CORNER OF SAID LOT 30;  
THENCE SOUTH 0°03'55" EAST ALONG THE EAST LINE THEREOF 26.65 FEET TO THE CENTERLINE OF AN EXISTING STREAM;  
THENCE ALONG SAID CENTERLINE THE FOLLOWING COURSES:  
SOUTH 70°47'12" WEST 44.28 FEET;  
THENCE SOUTH 81°08'05" WEST 65.94 FEET TO THE WEST LINE OF SAID LOT 30;  
THENCE NORTH 0°00'25" WEST ALONG SAID WEST LINE 54.82 FEET TO THE NORTHWEST CORNER OF SAID LOT 30;  
THENCE SOUTH 88°09'36" EAST ALONG THE NORTH LINE THEREOF 107.00 FEET TO THE POINT OF BEGINNING.  
TOGETHER WITH THAT PORTION OF NORTHWEST 205TH STREET ADJACENT AS ATTACHED BY OPERATION OF LAW.  
(ALSO KNOWN AS PORTION OF UNRECORDED KING COUNTY LOT LINE ADJUSTMENT NO. 891L0239, IN KING COUNTY, WASHINGTON.)  
COUNTY OF KING, STATE OF WASHINGTON

| PARCEL ID | TAX PIN    | OWNER NAME                   | SITE ADDRESS                  | SEGMENT   |
|-----------|------------|------------------------------|-------------------------------|-----------|
| 19-7      | 7280300162 | WRIGHT<br>GEORGE S & JENNY C | 2162 NW 204TH ST<br>SHORELINE | SHORELINE |

**SEGMENT 19-7 WRIGHT - LEGAL DESCRIPTION:**

LOT 2, KING COUNTY SHORT PLAT NUMBER 183056, RECORDED UNDER RECORDING NUMBER 8502040790, RECORDS OF KING COUNTY, WASHINGTON.  
TOGETHER WITH LOT 30, RICHMOND BEACH VILLA SITES ADDITION, ACCORDING TO PLAT THEREOF, RECORDED IN VOLUME 10 OF PLATS, PAGE 65, IN KING COUNTY, WASHINGTON.  
EXCEPT THE SOUTH 78 FEET THEREOF.  
EXCEPT THAT PORTION OF SAID LOT 30 DESCRIBED AS FOLLOWS:  
COMMENCING AT THE NORTHEAST CORNER OF SAID LOT 30; THENCE SOUTH 0°03'55" EAST ALONG THE EAST LINE THEREOF 26.65 FEET TO THE CENTERLINE OF AN EXISTING STREAM; THENCE ALONG SAID CENTERLINE THE FOLLOWING COURSES:  
SOUTH 70°47'12" WEST 44.28 FEET; THENCE SOUTH 81°08'05" WEST 65.94 FEET TO THE WEST LINE OF SAID LOT 30; THENCE NORTH 0°00'25" WEST ALONG SAID WEST LINE 54.82 FEET TO THE NORTHWEST CORNER OF SAID LOT 30; THENCE SOUTH 88°09'36" EAST ALONG THE NORTH LINE THEREOF 107.00 FEET TO THE POINT OF BEGINNING.  
COUNTY OF KING, STATE OF WASHINGTON

**Attachment A  
Subsurface Utility Easement Parcels**

| PARCEL ID | TAX PIN    | OWNER NAME                | SITE ADDRESS                  | SEGMENT   |
|-----------|------------|---------------------------|-------------------------------|-----------|
| 19-8      | 7280300165 | WARTMAN<br>BRIAN & SHARON | 2154 NW 204TH ST<br>SHORELINE | SHORELINE |

**SEGMENT 19-8 WARTMAN - LEGAL DESCRIPTION:**

TRACT 32, RICHMOND BEACH VILLA SITES, ACCORDING TO THE PLAT THEREOF RECORDED IN VOLUME 10 OF PLATS, PAGE 65, IN KING COUNTY, WASHINGTON.  
COUNTY OF KING, STATE OF WASHINGTON

| PARCEL ID | TAX PIN    | OWNER NAME  | SITE ADDRESS                  | SEGMENT   |
|-----------|------------|-------------|-------------------------------|-----------|
| 19-9      | 7280300170 | WARTMAN B C | 2144 NW 204TH ST<br>SHORELINE | SHORELINE |

**SEGMENT 19-9 WARTMAN - LEGAL DESCRIPTION:**

LOT 33, RICHMOND BEACH VILLA SITES, ACCORDING TO THE PLAT THEREOF RECORDED IN VOLUME 10 OF PLATS, PAGE 65, RECORDS OF KING COUNTY, WASHINGTON.  
TOGETHER WITH VACATED NORTHWEST 205TH STREET ADJACENT THERETO.  
COUNTY OF KING, STATE OF WASHINGTON

| PARCEL ID | TAX PIN    | OWNER NAME                      | SITE ADDRESS                  | SEGMENT   |
|-----------|------------|---------------------------------|-------------------------------|-----------|
| 19-10     | 7280300176 | LIN YVONNE P<br>& KRALL DAVID J | 2134 NW 204TH ST<br>SHORELINE | SHORELINE |

**SEGMENT 19-10 LIN/KRALL - LEGAL DESCRIPTION:**

PARCEL A: LOT 34 OF RICHMOND BEACH VILLA SITES, ACCORDING TO PLAT RECORDED IN VOLUME 10 OF PLATS AT PAGE 65, IN KING COUNTY, WASHINGTON.  
EXCEPT THE SOUTH 90 FEET AS MEASURED ALONG THE EAST AND WEST LINES.  
PARCEL B: A NON-EXCLUSIVE EASEMENT FOR INGRESS AND EGRESS OVER AND ACROSS THE WEST 25 FEET MEASURED ALONG THE NORTH AND SOUTH LINES OF SAID SOUTH 90 FEET.  
COUNTY OF KING, STATE OF WASHINGTON

| PARCEL ID | TAX PIN    | OWNER NAME                   | SITE ADDRESS | SEGMENT   |
|-----------|------------|------------------------------|--------------|-----------|
| 19-11     | 7280300181 | PEDERSEN<br>DALE D & DONNA L |              | SHORELINE |

**SEGMENT 19-11 PEDERSEN- LEGAL DESCRIPTION:**

THAT PORTION OF VACATED NORTHWEST 205TH STREET LYING ADJACENT TO THE NORTH LINE OF LOTS 35 AND THE WEST 32 FEET OF LOT 36, RICHMOND BEACH VILLA SITES, ACCORDING TO THE PLAT THEREOF RECORDED IN VOLUME 10 OF PLATS, PAGE 65, RECORDS OF KING COUNTY, WASHINGTON.  
COUNTY OF KING, STATE OF WASHINGTON

| PARCEL ID | TAX PIN    | OWNER NAME                      | SITE ADDRESS                  | SEGMENT   |
|-----------|------------|---------------------------------|-------------------------------|-----------|
| 19-12     | 7280300182 | LEE<br>DAVID G<br>& MINZI CHENG | 2126 NW 204TH ST<br>SHORELINE | SHORELINE |

**SEGMENT 19-12 LEE - LEGAL DESCRIPTION:**

LOT 1, CITY OF SHORELINE SHORT PLAT NO. SHSP 98048 RECORDED UNDER KING COUNTY RECORDING NO. 20020226900008, RECORDS OF KING COUNTY, WASHINGTON.  
COUNTY OF KING, STATE OF WASHINGTON

**Attachment A  
Subsurface Utility Easement Parcels**

| PARCEL ID | TAX PIN    | OWNER NAME                             | SITE ADDRESS                  | SEGMENT   |
|-----------|------------|--|-------------------------------|-----------|
| 19-13     | 7280300185 | ANUNSEN PATRICK<br>& LINDQUIST LINDA K | 2116 NW 204TH ST<br>SHORELINE | SHORELINE |

**SEGMENT 19-13 ANUNSEN - LEGAL DESCRIPTION:**

TRACT 36, RICHMOND BEACH VILLA SITES, ACCORDING TO THE PLAT THEREOF RECORDED IN VOLUME 10 OF PLATS, PAGE 65, RECORDS OF KING COUNTY, WASHINGTON.  
EXCEPT THE WEST 32 FEET THEREOF.  
TOGETHER WITH THAT PORTION OF VACATED NORTHWEST 205TH STREET ADJACENT THERETO.  
COUNTY OF KING, STATE OF WASHINGTON

| PARCEL ID | TAX PIN    | OWNER NAME              | SITE ADDRESS                  | SEGMENT   |
|-----------|------------|-------------------------|-------------------------------|-----------|
| 19-14     | 7280300190 | ROGERS<br>BRENT & JULIE | 2108 NW 204TH ST<br>SHORELINE | SHORELINE |

**19-14 ROGERS - LEGAL DESCRIPTION:**

LOT 37 OF RICHMOND BEACH VILLA SITES, AS PER PLAT RECORDED IN VOLUME 10 OF PLATS, PAGE 65, RECORDS OF KING COUNTY, WASHINGTON.  
TOGETHER WITH THAT PORTION OF VACATED NORTHWEST 205TH STREET ADJACENT THERETO.  
COUNTY OF KING, STATE OF WASHINGTON

| PARCEL ID | TAX PIN    | OWNER NAME                           | SITE ADDRESS                  | SEGMENT   |
|-----------|------------|--------------------------------------|-------------------------------|-----------|
| 19-15     | 7280300196 | MARTIN RACHEL<br>& SANDERSON WILLIAM | 2010 NW 204TH ST<br>SHORELINE | SHORELINE |

**19-15 MARTIN - LEGAL DESCRIPTION:**

ALL THAT PORTION OF LOT 38 OF RICHMOND BEACH VILLA SITES, AS PER PLAT RECORDED IN VOLUME 10 OF PLATS, PAGE 65, RECORDS OF KING COUNTY, DESCRIBED AS FOLLOWS:  
BEGINNING AT THE SOUTHWEST CORNER OF SAID LOT 38;  
THENCE EAST ALONG THE SOUTH LINE 11 40 FEET;  
THENCE NORTH 45°51'30" EAST ALONG THE SOUTHEASTERLY LINE OF SAID LOT 38, A DISTANCE OF 98.6 FEET;  
THENCE NORTH 44°08'30" WEST AT RIGHT ANGLES 42.0 FEET;  
THENCE NORTH 34°00'00" WEST 50 FEET,  
THENCE NORTH 36 11 FEET TO A POINT ON THE NORTH LINE OF SAID LOT 38;  
THENCE NORTH 88°17'00" WEST ALONG THE NORTH LINE 25.01 FEET TO THE NORTHWEST CORNER;  
THENCE SOUTH ALONG THE WEST LINE 177.18 FEET TO THE SOUTHWEST CORNER AND POINT OF BEGINNING.  
COUNTY OF KING, STATE OF WASHINGTON

**Attachment A  
Subsurface Utility Easement Parcels**

**15040**

| PARCEL ID | TAX PIN    | OWNER NAME                           | SITE ADDRESS                              | SEGMENT   |
|-----------|------------|--------------------------------------|---|-----------|
| 19-16     | 7280300195 | LANG II<br>LAURENCE H<br>& ROSALIE H | 2004 NW 204 <sup>TH</sup> ST<br>SHORELINE | SHORELINE |

**SEGMENT 19-16 LANG - LEGAL DESCRIPTION:**

LOT 38 PLAT OF RICHMOND BEACH VILLA SITES ACCORDING TO THE PLAT THEREOF, RECORDED IN VOLUME 10 OF PLATS PAGE(S) 65 IN KING COUNTY WASHINGTON;  
EXCEPT THE FOLLOWING DESCRIBED TRACTS:  
BEGINNING AT THE SOUTHWEST CORNER OF SAID LOT 38;  
THENCE EAST ALONG THE SOUTH LINE 11.40 FEET;  
THENCE NORTH 45°51'30" EAST ALONG THE SOUTHEASTERLY LINE OF SAID LOT 38 DISTANCE OF 98.6 FEET;  
THENCE NORTH 44°08'30" WEST AT RIGHT ANGLES 42.0 FEET;  
THENCE NORTH 34° WEST 50 FEET;  
THENCE NORTH 36.11 FEET TO A POINT ON THE NORTH LINE OF SAID LOT 38;  
THENCE NORTH 88°17' WEST ALONG THE NORTH LINE 25.01 FEET TO THE NORTHWEST CORNER;  
THENCE SOUTH ALONG THE WEST LINE 177.18 FEET TO THE SOUTHWEST CORNER AND POINT OF BEGINNING;  
TOGETHER WITH THAT PORTION OF VACATED 205TH STREET ADJOINING WHICH UPON VACATION ATTACHED TO SAID PROPERTY BY OPERATION OF LAW.  
COUNTY OF KING, STATE OF WASHINGTON

| PARCEL ID | TAX PIN    | OWNER NAME                     | SITE ADDRESS                   | SEGMENT   |
|-----------|------------|--------------------------------|--------------------------------|-----------|
| 19-17     | 0226039345 | TRUONG WAYNE<br>& MACH SUANTIN | 20418 20TH AVE NW<br>SHORELINE | SHORELINE |

**SEGMENT 19-17 TRUONG/MACH - LEGAL DESCRIPTION:**

THE NORTH 90 FEET OF THE WEST 185.00 FEET OF THE NORTH HALF OF THE NORTH HALF OF THE NORTHWEST QUARTER OF THE NORTHEAST QUARTER OF THE NORTHEAST QUARTER OF SECTION 2, TOWNSHIP 26 NORTH, RANGE 3 EAST, W.M., IN KING COUNTY, WASHINGTON;  
EXCEPT THE WEST 20 FEET THEREOF;  
AND EXCEPT COUNTY ROAD;  
EXCEPT THE NORTH 20 FEET THEREOF;  
AND EXCEPT THE EAST 60 FEET THEREOF;  
(ALSO KNOWN AS LOT A OF UNRECORDED LOT LINE ADJUSTMENT NO. 384129)  
COUNTY OF KING, STATE OF WASHINGTON

| PARCEL ID | TAX PIN    | OWNER NAME                    | SITE ADDRESS                  | SEGMENT   |
|-----------|------------|-------------------------------|-------------------------------|-----------|
| 19-18     | 0226039346 | ADDIS<br>ALVIN L & PATRICIA A | 1919 NW 205TH ST<br>SHORELINE | SHORELINE |

**SEGMENT 19-18 ADDIS - LEGAL DESCRIPTION:**

THE EAST 60 FEET OF THE WEST 185 FEET OF THE NORTH HALF OF THE NORTH HALF OF THE NORTHWEST QUARTER OF THE NORTHEAST QUARTER OF THE NORTHEAST QUARTER OF SECTION 2, TOWNSHIP 26 NORTH, RANGE 3 EAST, W.M., IN KING COUNTY, WASHINGTON;  
EXCEPT THE WEST 7 FEET OF THE SOUTH 70 FEET.  
COUNTY OF KING, STATE OF WASHINGTON

**Attachment A  
Subsurface Utility Easement Parcels**

**15040**

| PARCEL ID | TAX PIN    | OWNER NAME                      | SITE ADDRESS                  | SEGMENT   |
|-----------|------------|---------------------------------|-------------------------------|-----------|
| 19-19     | 0226039133 | GREGORY<br>THOMAS D & DEBORAH A | 1843 NW 205TH ST<br>SHORELINE | SHORELINE |

**SEGMENT 19-19 GREGORY - LEGAL DESCRIPTION:**

PARCEL A

THE EAST 100 FEET OF THE WEST 285 FEET OF THE NORTH HALF OF THE NORTH HALF OF THE NORTHWEST QUARTER OF THE NORTHEAST QUARTER OF THE NORTHEAST QUARTER OF SECTION 2, TOWNSHIP 26 NORTH, RANGE 3 EAST, W.M., IN KING COUNTY, WASHINGTON.

PARCEL B

A NON-EXCLUSIVE EASEMENT FOR INGRESS AND EGRESS OVER THE NORTH 20 FEET OF THE NORTHWEST QUARTER OF THE NORTHEAST QUARTER OF THE NORTHEAST QUARTER OF SAID SECTION 2;

EXCEPT THE WEST 20 FEET THEREOF.

COUNTY OF KING, STATE OF WASHINGTON

| PARCEL ID | TAX PIN    | OWNER NAME             | SITE ADDRESS                  | SEGMENT   |
|-----------|------------|------------------------|-------------------------------|-----------|
| 19-20     | 0226039135 | JOHNSTON, STEPHEN R JR | 1837 NW 205TH ST<br>SHORELINE | SHORELINE |

**SEGMENT 19-20 JOHNSTON - LEGAL DESCRIPTION:**

PARCEL A

THE NORTH HALF OF THE NORTH HALF OF THE NORTHWEST QUARTER OF THE NORTHEAST QUARTER OF THE NORTHEAST QUARTER OF SECTION 2, TOWNSHIP 26 NORTH, RANGE 3 EAST, W.M., IN KING COUNTY, WASHINGTON;

EXCEPT THE WEST 285 FEET AND THE EAST 285 FEET THEREOF.

PARCEL B

A NON-EXCLUSIVE EASEMENT FOR INGRESS AND EGRESS OVER THE NORTH 20 FEET OF THE WEST 285 FEET OF THE NORTHEAST QUARTER OF THE NORTHEAST QUARTER OF SAID SECTION 2;

EXCEPT THE WEST 20 FEET THEREOF.

COUNTY OF KING, STATE OF WASHINGTON

| PARCEL ID | TAX PIN    | OWNER NAME       | SITE ADDRESS                  | SEGMENT   |
|-----------|------------|------------------|-------------------------------|-----------|
| 19-21     | 0226039131 | OLSEN MARGARET E | 1827 NW 205TH ST<br>SHORELINE | SHORELINE |

**SEGMENT 19-21 OLSEN - LEGAL DESCRIPTION:**

PARCEL A

THE WEST 105 FEET OF THE EAST 285 FEET OF THE NORTH HALF OF THE NORTH HALF OF THE NORTHWEST QUARTER OF THE NORTHEAST QUARTER OF THE NORTHEAST QUARTER OF SECTION 2, TOWNSHIP 26 NORTH, RANGE 3 EAST, W.M., IN KING COUNTY, WASHINGTON.

PARCEL B

A NON-EXCLUSIVE EASEMENT FOR INGRESS AND EGRESS OVER THE NORTH 20 FEET OF THE NORTHEAST QUARTER OF THE NORTHEAST QUARTER OF SAID SECTION 2;

EXCEPT THE WEST 20 FEET THEREOF.

COUNTY OF KING, STATE OF WASHINGTON

**Attachment A**  
**Subsurface Utility Easement Parcels**

**15040**

| PARCEL ID | TAX PIN    | OWNER NAME                        | SITE ADDRESS                  | SEGMENT   |
|-----------|------------|-----------------------------------|-------------------------------|-----------|
| 19-22     | 0226039134 | MCKEE JAMES<br>& KUIPERS JO ELLYN | 1815 NW 205TH ST<br>SHORELINE | SHORELINE |

**SEGMENT 19-22 MCKEE/KUIPERS - LEGAL DESCRIPTION:**

THE WEST 90 FEET OF THE EAST 180 FEET OF THE NORTH HALF OF THE NORTH HALF OF THE NORTHWEST QUARTER OF THE NORTHEAST QUARTER OF THE NORTHEAST QUARTER OF SECTION 2, TOWNSHIP 26 NORTH, RANGE 3 EAST, W.M., IN KING COUNTY, WASHINGTON;  
TOGETHER WITH AN EASEMENT FOR INGRESS AND EGRESS OVER THE NORTH 20 FEET OF THE EAST 90 FEET OF THE NORTH HALF OF THE NORTH HALF OF THE NORTHWEST QUARTER OF THE NORTHEAST QUARTER OF THE NORTHEAST QUARTER OF SECTION 2.  
COUNTY OF KING, STATE OF WASHINGTON

| PARCEL ID | TAX PIN    | OWNER NAME     | SITE ADDRESS     | SEGMENT   |
|-----------|------------|----------------|------------------|-----------|
| 19-23     | 0226039138 | SANKEY SCOTT R | 1805 NW 205TH ST | SHORELINE |

**SEGMENT 19-23 SANKEY - LEGAL DESCRIPTION:**

THE EAST 90 FEET OF THE NORTH HALF OF THE NORTH HALF OF THE NORTHWEST QUARTER OF THE NORTHEAST QUARTER OF THE NORTHEAST QUARTER OF SECTION 2, TOWNSHIP 26 NORTH, RANGE 3 EAST, W.M., IN KING COUNTY, WASHINGTON.  
EXCEPT THE WEST 20 FEET THEREOF.  
TOGETHER WITH AN EASEMENT OVER THE NORTH 20 FEET OF THE NORTH HALF OF THE NORTH HALF OF THE NORTHWEST QUARTER OF THE NORTHEAST QUARTER OF THE NORTHEAST QUARTER OF SECTION 2, TOWNSHIP 26 NORTH, RANGE 3 EAST, W.M., IN KING COUNTY, WASHINGTON.  
EXCEPT THE WEST 20 FEET THEREOF.  
COUNTY OF KING, STATE OF WASHINGTON

| PARCEL ID | TAX PIN    | OWNER NAME                  | SITE ADDRESS                 | SEGMENT   |
|-----------|------------|-----------------------------|------------------------------|-----------|
| 19-24     | 3298800090 | LEE<br>EDMOND A & BARBARA L | 849 NW 205TH ST<br>SHORELINE | SHORELINE |

**SEGMENT 19-24 LEE - LEGAL DESCRIPTION:**

LOT 9 OF HIGHLAND PARK ESTATES, ACCORDING TO PLAT RECORDED OCTOBER 24, 1995 IN VOLUME 175 OF PLATS AT PAGE(S) 1 THROUGH 5, INCLUSIVE, UNDER RECORDING NO. 9510241350, IN KING COUNTY, WASHINGTON.  
COUNTY OF KING, STATE OF WASHINGTON

| PARCEL ID | TAX PIN    | OWNER NAME                  | SITE ADDRESS    | SEGMENT   |
|-----------|------------|-----------------------------|-----------------|-----------|
| 19-25     | 3298800080 | LEE<br>EDMOND A & BARBARA L | 845 NW 205TH ST | SHORELINE |

**SEGMENT 19-25 LEE - LEGAL DESCRIPTION:**

LOT 8 OF HIGHLAND PARK ESTATES, ACCORDING TO PLAT RECORDED OCTOBER 24, 1995 IN VOLUME 175 OF PLATS AT PAGE(S) 1 THROUGH 5, INCLUSIVE, UNDER RECORDING NO. 9410241350, IN KING COUNTY, WASHINGTON.  
COUNTY OF KING, STATE OF WASHINGTON

| PARCEL ID | TAX PIN    | OWNER NAME                        | SITE ADDRESS                        | SEGMENT   |
|-----------|------------|-----------------------------------|-------------------------------------|-----------|
| 19-27     | 7417700300 | SHURGARD STORAGE<br>CENTERS, INC. | 20041 BALLINGER WAY NE<br>SHORELINE | SHORELINE |

**SEGMENT 19-27 SHURGARD - LEGAL DESCRIPTION:**



**Attachment A  
Subsurface Utility Easement Parcels**

**15040**

LOT 30 IN BLOCK 1 OF ROSE ADDITION NO. 2, ACCORDING TO PLAT RECORDED IN VOLUME 34 OF PLATS AT PAGE 26, IN KING COUNTY, WASHINGTON;  
EXCEPT THAT PORTION DEEDED TO THE STATE OF WASHINGTON UNDER RECORDING NO. 5687947;  
TOGETHER WITH THAT PORTION CONVEYED BY THE STATE OF WASHINGTON UNDER RECORDING NO. 9106120961.  
COUNTY OF KING, STATE OF WASHINGTON

| PARCEL ID | TAX PIN    | OWNER NAME                       | SITE ADDRESS | SEGMENT   |
|-----------|------------|----------------------------------|--------------|-----------|
| 19-28     | 3298807777 | WRIGHT<br>M PAUL & MARY C, ET AL |              | SHORELINE |

**SEGMENT 19-28 WRIGHT ET AL - LEGAL DESCRIPTION:**

TRACT C, HIGHLAND PARK ESTATES ACCORDING TO PLAT RECORDED IN VOLUME 175 OF PLATS, PAGES 1 THROUGH 5 INCLUSIVE, RECORDS OF KING COUNTY, WASHINGTON.  
COUNTY OF KING, STATE OF WASHINGTON

| PARCEL ID | TAX PIN        | OWNER NAME   | SITE ADDRESS | SEGMENT   |
|-----------|----------------|--|--------------|-----------|
| 19-29     | 00995300241400 | BURLINGTON<br>NORTHERN SANTA FE<br>RAILWAY COMPANY |              | SHORELINE |

**SEGMENT 19-29 BNSF - LEGAL DESCRIPTION:**

THAT PORTION OF THE SOUTH 247.5 FEET OF THE SOUTHWEST QUARTER OF SECTION 35, TOWNSHIP 27 NORTH, RANGE 3 EAST, W.M. IN SNOHOMISH COUNTY, WASHINGTON, LYING WITHIN A STRIP OF LAND 25 FEET ON EACH SIDE OF THE CENTER LINE OF THE RAILWAY OF THE SEATTLE AND MONTANA RAILWAY COMPANY, AS SAID CENTER LINE WAS LOCATED, STAKED OUT AND ESTABLISHED ON OCTOBER 13, 1890, AS CONVEYED BY DEED RECORDED OCTOBER 13, 1890 UNDER RECORDING NO. 5662, IN VOLUME 13 OF DEEDS, PAGES 251 THROUGH 254, RECORDS OF SNOHOMISH COUNTY, WASHINGTON;  
EXCEPT ANY PORTION LYING WITHIN THE NON-VACATED PORTION OF HEBERLEIN ROAD.  
COUNTY OF SNOHOMISH, STATE OF WASHINGTON

**Attachment A  
Subsurface Utility Easement Parcels**

**15040**

**Kenmore Segment – (Portal 5 to 44) Subsurface Utility Easements**

| PARCEL ID | TAX PIN    | OWNER NAME                        | SITE ADDRESS                       | SEGMENT |
|-----------|------------|-----------------------------------|------------------------------------|---------|
| 5-2       | 7417700280 | KLOKSTAD<br>PROPERTIES II, L.L.C. | 20021 BALLINGER WY NE<br>SHORELINE | KENMORE |

**SEGMENT 5-2 KLOKSTAD - LEGAL DESCRIPTION:**

LOT 28 IN BLOCK 1 OF ROSE ADDITION NO. 2, ACCORDING TO PLAT RECORDED IN VOLUME 34 OF PLATS AT PAGE 26, IN KING COUNTY, WASHINGTON;  
EXCEPT PORTION FOR ROAD AS CONDEMNED BY SUPERIOR COURT CAUSE NO. 615536.  
COUNTY OF KING, STATE OF WASHINGTON

| PARCEL ID | TAX PIN    | OWNER NAME          | SITE ADDRESS                  | SEGMENT |
|-----------|------------|---------------------|-------------------------------|---------|
| 5-4       | 4022901111 | CAROLYN S UHT TRUST | 2518 NE 195TH ST<br>SHORELINE | KENMORE |

**SEGMENT 5-4 UHT - LEGAL DESCRIPTION:**

LOT 1 OF KING COUNTY SHORT PLAT NO. 1178137, RECORDED UNDER KING COUNTY NO. 7906280902, IN KING COUNTY, WASHINGTON.  
COUNTY OF KING, STATE OF WASHINGTON

| PARCEL ID | TAX PIN    | OWNER NAME               | SITE ADDRESS | SEGMENT |
|-----------|------------|--------------------------|--------------|---------|
| 5-5       | 4022902996 | NESTOR<br>JOHN & DOROTHY |              | KENMORE |

**SEGMENT 5-5 NESTOR - LEGAL DESCRIPTION:**

**PARCEL M**

THOSE PORTIONS OF LOT 24, BLOCK 9, FIRST ADDITION TO LAKE FOREST PARK ACCORDING TO PLAT RECORDED IN VOLUME 20 OF PLATS, PAGE 82, RECORDS OF KING COUNTY, WASHINGTON, DESCRIBED AS FOLLOWS:

BEGINNING AT THE SOUTHEAST CORNER OF SAID LOT 24; THENCE NORTHERLY ALONG THE EAST LINE THEREOF TO A POINT IN A LINE 25 FEET NORTHERLY OF AND PARALLEL WITH THE SOUTH LINE OF SAID LOT AND THE TRUE POINT OF BEGINNING; THENCE NORTH 89°37'09" WEST ALONG SAID PARALLEL LINE A DISTANCE OF 33.60 FEET; THENCE NORTH 86°18'38" WEST A DISTANCE OF 86.62 FEET TO A POINT IN A LINE 30 FEET NORTHERLY OF AND PARALLEL WITH THE SOUTH LINE OF SAID LOT 24; THENCE EASTERLY ALONG SAID PARALLEL LINE A DISTANCE OF 120.07 FEET TO A POINT IN THE EAST LINE OF SAID LOT 24; THENCE SOUTHERLY ALONG SAID EAST LINE A DISTANCE OF 5 FEET TO THE TRUE POINT OF BEGINNING;

ALSO,

BEGINNING AT THE SOUTHEAST CORNER OF SAID LOT 24; THENCE NORTH 89°37'09" WEST ALONG THE SOUTH LINE THEREOF A DISTANCE OF 147.53 FEET TO THE TRUE POINT OF BEGINNING; THENCE CONTINUING NORTH 89°37'09" WEST ALONG SAID SOUTH LINE A DISTANCE OF 300.10 FEET TO A POINT IN THE WEST LINE OF SAID LOT, THE SAME BEING THE EASTERLY MARGIN OF 40TH PLACE NORTHEAST A DISTANCE OF 30.68 FEET TO A POINT IN A LINE 30 FEET NORTHERLY OF AND PARALLEL WITH THE SOUTH LINE OF SAID LOT 24; THENCE SOUTH 89°37'09" EAST ALONG SAID PARALLEL LINE A DISTANCE OF 306.52 FEET; THENCE SOUTH 0°22'51" WEST A DISTANCE OF 30 FEET TO THE TRUE POINT OF BEGINNING.

COUNTY OF KING, STATE OF WASHINGTON

**Attachment A  
Subsurface Utility Easement Parcels**

**15040**

| PARCEL ID | TAX PIN    | OWNER NAME                       | SITE ADDRESS                         | SEGMENT |
|-----------|------------|----------------------------------|--------------------------------------|---------|
| 5-7       | 4027700614 | WYSS CRAIG<br>& SMITH S. ABIGAIL | 19504 47TH AV NE<br>LAKE FOREST PARK | KENMORE |

**SEGMENT 5-7 WYSS - LEGAL DESCRIPTION:**

THAT PORTION OF LOT 50, BLOCK 4, LAKE FOREST PARK ESTATES, ACCORDING TO THE PLAT THEREOF RECORDED IN VOLUME 34 OF PLATS, PAGES 8, 9 AND 10, RECORDS OF KING COUNTY, WASHINGTON, LYING SOUTHERLY AND WESTERLY OF THE FOLLOWING DESCRIBED LINE:  
BEGINNING AT THE MOST NORTHERLY CORNER OF SAID LOT 50;  
THENCE SOUTHERLY ALONG THE WESTERLY LINE THEREOF, 120.77 FEET TO THE TRUE POINT OF BEGINNING;  
THENCE SOUTH 73°00'00" EAST 159.68 FEET;  
THENCE SOUTH 11°21'24" EAST TO THE SOUTH LINE THEREOF AND THE TERMINUS OF SAID LINE.  
COUNTY OF KING, STATE OF WASHINGTON

| PARCEL ID | TAX PIN    | OWNER NAME                            | SITE ADDRESS                         | SEGMENT |
|-----------|------------|---------------------------------------|--------------------------------------|---------|
| 5-10      | 2763710090 | RHODES<br>EARL MURPHY<br>& ALICE LYNN | 19415 49TH PL NE<br>LAKE FOREST PARK | KENMORE |

**SEGMENT 5-10 RHODES - LEGAL DESCRIPTION:**

LOT 9 OF GILLY ADD. NO. 3, ACCORDING TO PLAT RECORDED JUNE 17, 1969 IN VOLUME 90 OF PLATS AT PAGE(S) 7, IN KING COUNTY, WASHINGTON.  
COUNTY OF KING, STATE OF WASHINGTON

| PARCEL ID | TAX PIN    | OWNER NAME                | SITE ADDRESS                         | SEGMENT |
|-----------|------------|---------------------------|--------------------------------------|---------|
| 5-11      | 2763710100 | FERNANDEZ<br>CHRISTIANA I | 19420 49TH PL NE<br>LAKE FOREST PARK | KENMORE |

**SEGMENT 5-11 FERNANDEZ - LEGAL DESCRIPTION:**

LOT 10 OF GILLY ADD. NO. 3, ACCORDING TO PLAT RECORDED JUNE 17, 1969 IN VOLUME 90 OF PLATS AT PAGE(S) 7, IN KING COUNTY, WASHINGTON.  
COUNTY OF KING, STATE OF WASHINGTON

| PARCEL ID | TAX PIN    | OWNER NAME                 | SITE ADDRESS                         | SEGMENT |
|-----------|------------|----------------------------|--------------------------------------|---------|
| 5-12      | 4027700600 | BRADBURN<br>ROBBIN & DORIS | 5204 NE 193RD PL<br>LAKE FOREST PARK | KENMORE |

**SEGMENT 5-12 BRADBURN - LEGAL DESCRIPTION:**

LOT 2 OF KING COUNTY SHORT PLAT NO. 1080084, ACCORDING TO THE SHORT PLAT RECORDED UNDER KING COUNTY RECORDING NO. 8106030631; SITUATE IN THE CITY OF LAKE FOREST PARK, COUNTY OF KING, STATE OF WASHINGTON.  
COUNTY OF KING, STATE OF WASHINGTON

**Attachment A  
Subsurface Utility Easement Parcels**

**15040**

| PARCEL ID | TAX PIN    | OWNER NAME                     | SITE ADDRESS                         | SEGMENT |
|-----------|------------|--------------------------------|--------------------------------------|---------|
| 5-13      | 4027700595 | DUNN MICHAEL<br>& SHERER NANCY | 5210 NE 193RD PL<br>LAKE FOREST PARK | KENMORE |

**SEGMENT 5-13 DUNN/SHERER - LEGAL DESCRIPTION:**

PARCEL A

LOT 2 TOGETHER WITH THE SOUTHWESTERLY 10 FEET OF LOT 1 OF KING COUNTY SHORT PLAT NO. 379401, ACCORDING TO THE PLAT RECORDED JUNE 2, 1981 UNDER RECORDING NO. 8106020850, IN KING COUNTY, WASHINGTON;  
(ALSO KNOWN AS LOT LINE ADJUSTMENT NO. 582075 RECORDED UNDER KING COUNTY RECORDING NO. 9212211165).

PARCEL B

A NON-EXCLUSIVE EASEMENT FOR INGRESS AND EGRESS AS DISCLOSED IN KING COUNTY SHORT PLAT NOS. 8103160557 AND 8106020850, IN KING COUNTY, WASHINGTON.  
COUNTY OF KING, STATE OF WASHINGTON

| PARCEL ID | TAX PIN    | OWNER NAME                     | SITE ADDRESS                         | SEGMENT |
|-----------|------------|--------------------------------|--------------------------------------|---------|
| 5-14      | 4027700590 | SIEGEL<br>MICHAEL A & BONITA S | 5214 NE 193RD PL<br>LAKE FOREST PARK | KENMORE |

**SEGMENT 5-14 SIEGEL - LEGAL DESCRIPTION:**

PARCEL A

LOT 1 OF KING COUNTY SHORT PLAT NO. 379401, ACCORDING TO THE PLAT RECORDED JUNE 2, 1981 UNDER RECORDING NO. 8106020850, IN KING COUNTY, WASHINGTON; EXCEPT THE SOUTHWESTERLY 10 FEET THEREOF.  
(ALSO KNOWN AS LOT LINE ADJUSTMENT NO. 582075 RECORDED UNDER KING COUNTY RECORDING NO. 9212211165).

PARCEL B

A NON-EXCLUSIVE EASEMENT FOR INGRESS AND EGRESS AS DISCLOSED IN KING COUNTY SHORT PLAT NOS. 8103160557 AND 8106020850, IN KING COUNTY, WASHINGTON.  
COUNTY OF KING, STATE OF WASHINGTON

| Parcel ID | Tax PIN    | Owner Name                     | Site Address                         | Segment |
|-----------|------------|--------------------------------|--------------------------------------|---------|
| 5-15      | 4027700594 | LORBIECKI<br>GLENN L & JEANA S | 5220 NE 193RD PL<br>LAKE FOREST PARK | KENMORE |

**SEGMENT 5-15 LORBIECKI - LEGAL DESCRIPTION:**

LOT 4, OF KING COUNTY SHORT PLAT NO. 379040 RECORDED UNDER RECORDING NO. 8103160557, IN KING COUNTY, WASHINGTON  
COUNTY OF KING, STATE OF WASHINGTON

| PARCEL ID | TAX PIN    | OWNER NAME    | SITE ADDRESS                         | SEGMENT |
|-----------|------------|---------------|--------------------------------------|---------|
| 5-16      | 4027700630 | NIXON DARLENE | 19505 53RD AV NE<br>LAKE FOREST PARK | KENMORE |

**SEGMENT 5-16 NIXON - LEGAL DESCRIPTION:**

THE WEST 169.59 FEET OF THE SOUTH 100 FEET OF LOT 53, ALSO THE SOUTH 25 FEET LYING OF THE WEST 169.59 FEET OF SAID LOT 53, BLOCK 4, LAKE FOREST PARK ESTATES, ACCORDING TO THE PLAT THEREOF RECORDED IN VOLUME 34 OF PLATS, PAGES 8 THROUGH 10, INCLUSIVE, IN KING COUNTY, WASHINGTON.  
COUNTY OF KING, STATE OF WASHINGTON

**Attachment A  
Subsurface Utility Easement Parcels**

| PARCEL ID | TAX PIN    | OWNER NAME                    | SITE ADDRESS                         | SEGMENT |
|-----------|------------|-------------------------------|--------------------------------------|---------|
| 5-18      | 4027700587 | FULMER<br>JAMES R & CORALYNNE | 19361 53RD AV NE<br>LAKE FOREST PARK | KENMORE |

**SEGMENT 5-18 FULMER - LEGAL DESCRIPTION:**

THAT PORTION OF LOT 44, BLOCK 4, LAKE FOREST PARK ESTATES, ACCORDING TO THE PLAT THEREOF RECORDED IN VOLUME 34 OF PLATS, PAGE 8, RECORDS OF KING COUNTY, WASHINGTON, DESCRIBED AS FOLLOWS:

BEGINNING AT THE NORTHEAST CORNER OF SAID LOT;

THENCE WEST ALONG THE NORTH BOUNDARY LINE 159.59 FEET TO THE NORTHWEST CORNER THEREOF;

THENCE SOUTHEASTERLY ALONG THE WEST BOUNDARY LINE OF SAID LOT, 125 FEET;

THENCE EASTERLY TO A POINT ON THE EAST BOUNDARY LINE OF SAID LOT, 100 FEET

SOUTHEASTERLY FROM THE NORTHEAST CORNER THEREOF;

THENCE NORTHWESTERLY ALONG THE EAST BOUNDARY LINE 100 FEET TO THE POINT OF BEGINNING.

COUNTY OF KING, STATE OF WASHINGTON

| PARCEL ID | TAX PIN    | OWNER NAME                  | SITE ADDRESS                         | SEGMENT |
|-----------|------------|-----------------------------|--------------------------------------|---------|
| 5-19      | 4027700520 | HANSEN<br>ROBERT W & JEAN E | 19504 53RD AV NE<br>LAKE FOREST PARK | KENMORE |

**SEGMENT 5-19 HANSEN - LEGAL DESCRIPTION:**

THAT PORTION OF LOTS 38 AND 54, BLOCK 4, LAKE FOREST PARK ESTATES, ACCORDING TO PLAT RECORDED IN VOLUME 34 OF PLATS, PAGE 8, IN KING COUNTY, WASHINGTON, LYING SOUTH OF THE NORTH LINE OF LOT 38, EXTENDED WEST AND WEST OF THE EAST LINE OF LOT 54, EXTENDED SOUTH.

COUNTY OF KING, STATE OF WASHINGTON

| PARCEL ID | TAX PIN    | OWNER NAME                      | SITE ADDRESS                         | SEGMENT |
|-----------|------------|---------------------------------|--------------------------------------|---------|
| 5-20      | 4027700516 | RONGERUDE<br>RUTH T & RANDALL N | 5402 NE 195TH ST<br>LAKE FOREST PARK | KENMORE |

**SEGMENT 5-20 RONGERUDE - LEGAL DESCRIPTION:**

THAT PORTION OF LOT 38, BLOCK 4, LAKE FOREST PARK ESTATES, ACCORDING TO THE PLAT THEREOF RECORDED IN VOLUME 34 OF PLATS, PAGES, 8, 9 AND 10, RECORDS OF KING COUNTY, WASHINGTON, LYING BETWEEN THE SOUTHERLY PROLONGATION OF THE EASTERLY LINE OF LOT 54 OF SAID BLOCK 4 AND A LINE 105 FEET EASTERLY OF AND PARALLEL THERETO. AN UNDIVIDED 1/6TH INTEREST IN THAT CERTAIN PROPERTY FURTHER DESCRIBED UNDER RECORDING NO. 5778654.

COUNTY OF KING, STATE OF WASHINGTON

**Attachment A  
Subsurface Utility Easement Parcels**

**15040**

| PARCEL ID | TAX PIN    | OWNER NAME     | SITE ADDRESS                         | SEGMENT |
|-----------|------------|----------------|--------------------------------------|---------|
| 5-21      | 4027700514 | MAININI ANDY W | 5414 NE 195TH ST<br>LAKE FOREST PARK | KENMORE |

**SEGMENT 5-21 MAININI - LEGAL DESCRIPTION:**

**PARCEL A**

THE WEST 100 FEET OF THE NORTH 80 FEET OF THAT PORTION OF LOT 38, BLOCK 4, LAKE FOREST PARK ESTATES, ACCORDING TO THE PLAT THEREOF RECORDED IN VOLUME 34 OF PLATS, PAGE 8, RECORDS OF KING COUNTY, WASHINGTON, LYING EAST OF A LINE BEING 110 FEET EAST OF THE SOUTHERLY PROLONGATION OF THE EAST LINE OF LOT 54 OF SAID BLOCK 4, EXTENDED TO THE SOUTH LINE OF SAID LOT 38;

EXCEPT THE EAST 153.0 FEET AS MEASURED ALONG THE NORTH LINE THEREOF;

TOGETHER WITH THAT PORTION OF LOT 38, BLOCK 4, LAKE FOREST PARK ESTATES, ACCORDING TO THE PLAT RECORDED IN VOLUME 34 OF PLATS, PAGE 8, RECORDS OF KING COUNTY, WASHINGTON, LYING EASTERLY OF A LINE WHICH BEGINS 105 FEET EAST OF THE NORTHWEST CORNER OF SAID LOT 38;

THENCE SOUTH AT RIGHT ANGLES TO SAID NORTH LINE TO THE NORTHERLY LINE OF AS EASEMENT AND THE TERMINUS OF SAID LINE, SAID EASEMENT BEING DESCRIBED AS FOLLOWS:

BEGINNING AT THE SOUTHEAST CORNER OF SAID LOT 38;

THENCE WEST ALONG THE SOUTH LINE THEREOF 333.75 FEET;

THENCE SOUTH 81°52'21" WEST 106.07 FEET TO THE NORTH LINE OF THE SOUTH 85 FEET OF LOT 39;

THENCE WEST ALONG SAID NORTH LINE 195.56 FEET TO THE WEST LINE OF LOT 39;

THENCE NORTH 28°21'10" WEST ALONG SAID WEST LINE 17.04 FEET TO THE NORTHWEST CORNER OF LOT 39;

THENCE EAST ALONG THE NORTH LINE THEREOF 167.23 FEET TO THE SOUTHERLY EXTENSION OF THE WEST LINE OF LOT 37 IN BLOCK 4 OF SAID PLAT;

THENCE NORTH 81°52'12" EAST 141.42 FEET TO THE NORTH LINE THE SOUTH 20 FEET OF LOT 38;

THENCE EAST ALONG SAID NORTH LINE 331.6 FEET, MORE OR LESS, TO THE EAST LINE OF LOT 38;

THENCE SOUTHERLY ALONG SAID LINE 20.31 FEET, MORE OR LESS, TO THE POINT OF BEGINNING;

EXCEPT THE NORTH 80 FEET OF THE EAST 353.58 FEET OF SAID LOT 38, AS MEASURED ALONG THE NORTH LINE THEREOF;

SITUATE IN THE COUNTY OF KING, STATE OF WASHINGTON.

**PARCEL B**

A NON-EXCLUSIVE EASEMENT FOR INGRESS, EGRESS OVER THE FOLLOWING DESCRIBED PROPERTY,

THOSE PORTIONS OF LOTS 38 AND 39, BLOCK 4, LAKE FOREST PARK ESTATES, ACCORDING TO THE PLAT THEREOF RECORDED IN VOLUME 34 OF PLATS, PAGE 8, RECORDS OF KING COUNTY, WASHINGTON, AS DESCRIBED AS FOLLOWS:

BEGINNING AT THE SOUTHEAST CORNER OF SAID LOT 38;

THENCE WEST ALONG THE SOUTH LINE THEREOF 333.75 FEET;

THENCE SOUTH 81°52'21" WEST 106.07 FEET TO THE NORTH LINE OF THE SOUTH 85 FEET OF LOT 39;

THENCE WEST ALONG SAID NORTH LINE 195.56 FEET TO THE WEST LINE OF LOT 39;

THENCE NORTH 28°21'10" WEST ALONG SAID WEST LINE 17.04 FEET TO THE NORTHWEST CORNER OF LOT 39;

THENCE EAST ALONG THE NORTH LINE THEREOF 167.23 FEET TO THE SOUTHERLY EXTENSION OF THE WEST LINE OF LOT 37, BLOCK 4 OF SAID PLAT;

THENCE NORTH 81°52'12" EAST 141.42 FEET TO THE NORTH LINE OF THE SOUTH 20 FEET OF LOT 38;

THENCE EAST ALONG SAID NORTH LINE 331.6 FEET, MORE OR LESS, TO THE EAST LINE OF LOT 38;

THENCE SOUTHERLY ALONG SAID EAST LINE 20.31 FEET, MORE OR LESS, TO THE POINT OF BEGINNING.

COUNTY OF KING, STATE OF WASHINGTON

**Attachment A**  
**Subsurface Utility Easement Parcels**

**15040**

| PARCEL ID | TAX PIN    | OWNER NAME   | SITE ADDRESS                         | SEGMENT |
|-----------|------------|--------------|--------------------------------------|---------|
| 5-22      | 4027700513 | PINELLI JOEY | 5422 NE 195TH ST<br>LAKE FOREST PARK | KENMORE |

**SEGMENT 5-22 PINELLI - LEGAL DESCRIPTION:**

PARCEL A

THAT PORTION OF LOT 38 IN BLOCK 4 OF LAKE FOREST PARK ESTATES, ACCORDING TO PLAT RECORDED IN VOLUME 34 OF PLATS AT PAGE (S) 8, IN KING COUNTY, WASHINGTON, LYING EASTERLY OF A LINE WHICH BEGINS 210.29 FEET EAST OF THE NORTHWEST CORNER OF SAID LOT, THENCE RUNNING SOUTH AT RIGHT ANGLES TO SAID NORTH LINE, TO THE SOUTH LINE THEREOF AND THE TERMINUS OF THIS LINE DESCRIPTION, EXCEPT THE EAST 153.0 FEET, AS MEASURED ALONG THE NORTH LINE THEREOF, EXCEPT THE SOUTH 20.0 FEET THEREOF

PARCEL B

AN UNDIVIDED INTEREST IN THE SOUTHERLY 20 FEET OF LOT 38 IN BLOCK 4 OF LAKE FOREST PARK ESTATES, ACCORDING TO PLAT RECORDED IN VOLUME 34 OF PLATS AT PAGE(S) 8, IN KING COUNTY, WASHINGTON,

EXCEPT THAT PORTION THEREOF LYING WESTERLY OF A LINE 105 FEET EASTERLY OF AND PARALLEL TO THE SOUTHERLY PROLONGATION OF THE EASTERLY LINE OF LOT 54 OF BLOCK 4 OF SAID ADDITION,

ALSO EXCEPT THAT PORTION LYING NORTHWESTERLY OF A LINE DESCRIBED AS FOLLOWS COMMENCING AT A POINT ON THE NORTHERLY LINE OF SAID LOT 38, WHICH IS 105 FEET EASTERLY OF THE SOUTHERLY PROLONGATION OF THE EASTERLY LINE OF LOT 54, BLOCK 4 OF SAID ADDITION;

THENCE SOUTHERLY AT RIGHT ANGLES TO SAID NORTHERLY LINE TO A POINT ON THE NORTHERLY LINE OF AN EASEMENT FOR INGRESS AND EGRESS AS ESTABLISHED BY INSTRUMENT RECORDED UNDER RECORDING NO 5778654, AND THE TRUE POINT OF BEGINNING OF SAID LINE DESCRIPTION; THENCE NORTHEASTERLY ALONG THE NORTHWESTERLY LINE OF SAID EASEMENT TO ITS INTERSECTION WITH THE NORTHERLY LINE OF THE SOUTHERLY 20 FEET OF SAID LOT 38, AND THE TERMINUS OF SAID LINE DESCRIPTION

PARCEL C: AN UNDIVIDED INTEREST IN THE NORTH 15 FEET OF THE WEST 130 FEET OF LOT 39 IN BLOCK 4 OF LAKE FOREST PARK ESTATES, ACCORDING TO PLAT RECORDED IN VOLUME 34 OF PLATS AT PAGE(S) 8, IN LAKE COUNTY, WASHINGTON, AS MEASURED ALONG THE SOUTH LINE OF SAID LOT 39.

COUNTY OF KING, STATE OF WASHINGTON

| PARCEL ID | TAX PIN    | OWNER NAME             | SITE ADDRESS                         | SEGMENT |
|-----------|------------|------------------------|--------------------------------------|---------|
| 5-24      | 4027700517 | ASKMAN<br>ARLENE JOYCE | 19503 55TH AV NE<br>LAKE FOREST PARK | KENMORE |

**SEGMENT 5-24 ASKMAN - LEGAL DESCRIPTION:**

THE SOUTH 15 FEET OF THE EAST 153 FEET OF LOT 37, BLOCK 4, LAKE FOREST PARK ESTATES, AS MEASURED ALONG THE SOUTH LINE THEREOF TOGETHER WITH THE NORTH 80 FEET OF THE EAST 153 FEET OF LOT 38, BLOCK 4, LAKE FOREST PARK ESTATES, AS MEASURED ALONG THE NORTH LINE THEREOF, ACCORDING TO THE PLAT RECORDED IN VOLUME 34 OF PLATS, PAGE 8, IN KING COUNTY, WASHINGTON.

COUNTY OF KING, STATE OF WASHINGTON

**Attachment A**  
**Subsurface Utility Easement Parcels**

**15040**

| PARCEL ID | TAX PIN    | OWNER NAME                    | SITE ADDRESS                | SEGMENT |
|-----------|------------|-------------------------------|-----------------------------|---------|
| 5-27      | 8123700050 | GREGERSEN<br>SCOTT M & MARY E | 5559 NE 195TH ST<br>KENMORE | KENMORE |

**SEGMENT 5-27 GREGERSEN - LEGAL DESCRIPTION:**

LOT 5 OF SUNRISE TERRACE, ACCORDING TO PLAT RECORDED IN VOLUME 67 OF PLATS AT PAGES 88 AND 89, IN KING COUNTY, WASHINGTON.  
COUNTY OF KING, STATE OF WASHINGTON

| PARCEL ID | TAX PIN    | OWNER NAME                    | SITE ADDRESS                | SEGMENT |
|-----------|------------|-------------------------------|-----------------------------|---------|
| 5-28      | 4027700788 | COYNE<br>ANTHONY G & YUMIKO H | 5802 NE 195TH ST<br>KENMORE | KENMORE |

**SEGMENT 5-28 COYNE - LEGAL DESCRIPTION:**

**PARCEL A**

A PORTION OF LOT 25, BLOCK 5, LAKE FOREST PARK ESTATES, ACCORDING TO THE PLAT THEREOF RECORDED IN VOLUME 34 OF PLATS, PAGE 8, RECORDS OF KING COUNTY, WASHINGTON, DESCRIBED AS FOLLOWS:

COMMENCING AT THE NORTHWESTERLY CORNER OF SAID LOT 25;  
THENCE SOUTH 88°35'54" EAST ALONG THE NORTH LINE OF SAID LOT 25, A DISTANCE OF 30.10 FEET TO THE TRUE POINT OF BEGINNING;  
THENCE CONTINUING SOUTH 88°35'54" EAST ALONG THE NORTHERLY MARGIN OF SAID LOT 25, A DISTANCE OF 100.00 FEET;  
THENCE SOUTH 05°58'29" WEST PARALLEL WITH THE WEST LINE OF SAID LOT 25, A DISTANCE OF 90.36 FEET;  
THENCE NORTH 88°35'54" WEST 100.00 FEET;  
THENCE NORTH 05°58'29" EAST 90.36 FEET TO THE TRUE POINT OF BEGINNING;

**PARCEL B**

A NON-EXCLUSIVE EASEMENT FOR INGRESS AND EGRESS CREATED BY INSTRUMENT RECORDED UNDER RECORDING NO. 6180729, IN KING COUNTY, WASHINGTON.  
COUNTY OF KING, STATE OF WASHINGTON

| PARCEL ID | TAX PIN    | OWNER NAME                   | SITE ADDRESS                | SEGMENT |
|-----------|------------|------------------------------|-----------------------------|---------|
| 5-30      | 4027700794 | HOFFMAN<br>JAMES H & ROBYN J | 5823 NE 195TH ST<br>KENMORE | KENMORE |

**SEGMENT 5-30 HOFFMAN - LEGAL DESCRIPTION:**

THAT PORTION OF LOT 26, BLOCK 5, LAKE FOREST PARK ESTATES, ACCORDING TO THE PLAT THEREOF RECORDED IN VOLUME 34 OF PLATS, PAGES 8, 9 AND 10, RECORDS OF KING COUNTY, WASHINGTON, DESCRIBED AS FOLLOWS:

BEGINNING AT THE SOUTHWESTERLY CORNER OF SAID LOT 26;  
THENCE SOUTH 88°35'54" EAST ALONG THE SOUTH LINE OF SAID LOT 26, A DISTANCE OF 230.10 FEET TO THE TRUE POINT OF BEGINNING;  
THENCE NORTH 05°58'29" EAST PARALLEL WITH THE WEST LINE OF SAID LOT 26, A DISTANCE OF 68.70 FEET;  
THENCE SOUTH 88°35'54" EAST 20.00 FEET TO A POINT ON A CURVE TO WHICH POINT THE TANGENT BEARS SOUTH 05°58'29" WEST;  
THENCE NORTHEASTERLY ALONG SAID CURVE TO THE RIGHT, AN ARC DISTANCE OF 29.82 FEET, SAID CURVE HAVING RADIUS OF 20.00 FEET;  
THENCE NORTH 05°58'29" EAST 13.22 FEET;  
THENCE SOUTH 88°35'54" EAST 61.43 FEET;  
THENCE SOUTH 05°58'29" WEST 100.39 FEET;  
THENCE NORTH 88°35'54" WEST 99.00 FEET TO THE TRUE POINT OF BEGINNING.  
TOGETHER WITH AN UNDIVIDED 1/6 INTEREST IN THAT CERTAIN ROADWAY AS CREATED AND DESCRIBED BY INSTRUMENT RECORDED MAY 25, 1967 UNDER RECORDING NO. 6180729, RECORDS OF KING COUNTY, WASHINGTON.  
COUNTY OF KING, STATE OF WASHINGTON



**Attachment A**  
**Subsurface Utility Easement Parcels**

**15040**

| PARCEL ID | TAX PIN    | OWNER NAME  | SITE ADDRESS                | SEGMENT |
|-----------|------------|-------------|-----------------------------|---------|
| 5-31      | 4027700791 | BRANCA JOHN | 5822 NE 195TH ST<br>KENMORE | KENMORE |

**SEGMENT 5-31 BRANCA - LEGAL DESCRIPTION:**

THAT PORTION OF LOT 25, BLOCK 5, LAKE FOREST PARK ESTATES, ACCORDING TO THE PLAT THEREOF RECORDED IN VOLUME 34 OF PLATS, PAGE 8, RECORDS OF KING COUNTY, WASHINGTON, DESCRIBED AS FOLLOWS:  
 BEGINNING AT THE NORTHWESTERLY CORNER OF SAID LOT 25;  
 THENCE SOUTH 88°35'54" EAST ALONG THE NORTH LINE OF SAID LOT 25 A DISTANCE OF 230.10 FEET TO THE TRUE POINT OF BEGINNING;  
 THENCE CONTINUING SOUTH 88°35'54" EAST, A DISTANCE OF 99.90 FEET;  
 THENCE SOUTH 05°58'29" WEST PARALLEL WITH THE WEST LINE OF SAID LOT 25, A DISTANCE OF 100.39 FEET;  
 THENCE NORTH 88°35'54" WEST 61.43 FEET;  
 THENCE NORTH 05°58'29" EAST 10.03 FEET;  
 THENCE NORTH 88°35'54" WEST 38.47 FEET;  
 THENCE NORTH 05°58'29" EAST 90.36 FEET TO THE TRUE POINT OF BEGINNING;  
 TOGETHER WITH AN UNDIVIDED 1/6 INTEREST IN THAT CERTAIN ROADWAY AS CREATED BY INSTRUMENT RECORDED MAY 25, 1967, UNDER KING COUNTY RECORDING NO. 6180729, BEING A PORTION OF LOTS 25 AND 26 IN BLOCK 5 DESCRIBED AS FOLLOWS:  
 BEGINNING AT THE SOUTHWESTERLY CORNER OF SAID LOT 26;  
 THENCE SOUTH 88°35'54" EAST, ALONG THE SOUTH LINE OF SAID LOT 26, A DISTANCE OF 30.10 FEET;  
 THENCE NORTH 05°58'29" EAST, PARALLEL WITH THE WEST LINE OF SAID LOT 26, A DISTANCE OF 90.36 FEET TO THE TRUE POINT OF BEGINNING;  
 THENCE SOUTH 88°35'54" EAST, 178.34 FEET TO A POINT ON A CURVE AT WHICH POINT THE RADIAL BEARS SOUTH 05°58'29" WEST;  
 THENCE SOUTHEASTERLY ALONG SAID CURVE TO THE RIGHT, AN ARC DISTANCE OF 33.01 FEET AT WHICH POINT THE TANGENT OF SAID CURVE BEARS NORTH 05°58'29" EAST AND HAVING A RADIUS OF 20.00 FEET;  
 THENCE SOUTH 88°35'54" EAST 20.00 FEET TO A POINT ON A CURVE AT WHICH POINT THE TANGENT BEARS SOUTH 05°58'29" WEST;  
 THENCE NORTHEASTERLY ALONG SAID CURVE TO THE RIGHT, AN ARC DISTANCE OF 29.82 FEET, SAID CURVE HAVING A RADIUS OF 20.00 FEET;  
 THENCE NORTH 05°58'29" EAST 23.25 FEET;  
 THENCE NORTH 88°35'54" WEST 238.47 FEET;  
 THENCE SOUTH 05°58'29" WEST, 20.06 FEET TO THE TRUE POINT OF BEGINNING.  
 COUNTY OF KING, STATE OF WASHINGTON

| PARCEL ID | TAX PIN    | OWNER NAME                  | SITE ADDRESS                | SEGMENT |
|-----------|------------|-----------------------------|-----------------------------|---------|
| 5-32      | 4027700772 | TAKABA<br>YOSHIYA & WHITNEY | 5827 NE 195TH PL<br>KENMORE | KENMORE |

**SEGMENT 5-32 TAKABA - LEGAL DESCRIPTION:**

**PARCEL A**

LOT 3 OF KING COUNTY SHORT PLAT NO. L98S0011, ACCORDING TO SHORT PLAT RECORDED JANUARY 23, 2002 UNDER RECORDING NO. 20020123900025, IN KING COUNTY, WASHINGTON.

**PARCEL B**

A NON-EXCLUSIVE EASEMENT FOR INGRESS AND EGRESS AS CREATED BY INSTRUMENT RECORDED UNDER RECORDING NO. 7601120190, IN KING COUNTY, WASHINGTON.  
 COUNTY OF KING, STATE OF WASHINGTON

**Attachment A  
Subsurface Utility Easement Parcels**

**15040**

| PARCEL ID | TAX PIN    | OWNER NAME                                       | SITE ADDRESS                 | SEGMENT |
|-----------|------------|--|------------------------------|---------|
| 5-33      | 4027700773 | NOVOTNY KRISTAN &<br>MUHITTINOGLU<br>MEHMET OMUR | 19409 61ST AVE NE<br>KENMORE | KENMORE |

**SEGMENT 5-33 NOVOTNY/MUHITTINOGLU - LEGAL DESCRIPTION:**

LOT 4 OF KING COUNTY SHORT PLAT NO. L98S0011, ACCORDING TO SHORT PLAT RECORDED JANUARY 23, 2002 UNDER RECORDING NO. 20020123900025, IN KING COUNTY, WASHINGTON;  
TOGETHER WITH AN UNDIVIDED INTEREST IN TRACTS A AND B OF SAID SHORT PLAT.  
COUNTY OF KING, STATE OF WASHINGTON

| PARCEL ID | TAX PIN    | OWNER NAME             | SITE ADDRESS                 | SEGMENT |
|-----------|------------|------------------------|------------------------------|---------|
| 5-34      | 4027700790 | YU ENYOU<br>& LI PATTI | 19411 61ST AVE NE<br>KENMORE | KENMORE |

**SEGMENT 5-34 YU/LI - LEGAL DESCRIPTION:**

LOT 1 OF KING COUNTY SHORT PLAT NO. L98S0011, ACCORDING TO SHORT PLAT RECORDED JANUARY 23, 2002 UNDER RECORDING NO. 20020123900025, IN KING COUNTY, WASHINGTON;  
TOGETHER WITH AN UNDIVIDED INTEREST IN TRACTS A AND B OF SAID SHORT PLAT.  
COUNTY OF KING, STATE OF WASHINGTON

| PARCEL ID | TAX PIN    | OWNER NAME          | SITE ADDRESS                | SEGMENT |
|-----------|------------|---------------------|-----------------------------|---------|
| 5-35      | 4027700798 | CHIHARA PAULINE SUE | 19509 61ST AV NE<br>KENMORE | KENMORE |

**SEGMENT 5-35 CHIHARA - LEGAL DESCRIPTION:**

LOT 2 OF KING COUNTY SHORT PLAT NUMBER R478016, RECORDED UNDER RECORDING NUMBER 7912170566, IN KING COUNTY, WASHINGTON  
COUNTY OF KING, STATE OF WASHINGTON

| PARCEL ID | TAX PIN    | OWNER NAME                  | SITE ADDRESS                | SEGMENT |
|-----------|------------|-----------------------------|-----------------------------|---------|
| 5-36      | 4027700799 | WANG<br>CHUNG-YIH & MIN-CHU | 19415 61ST AV NE<br>KENMORE | KENMORE |

**SEGMENT 5-36 WANG - LEGAL DESCRIPTION:**

**PARCEL A**

LOT 1 OF KING COUNTY SHORT PLAT NO. R478016, RECORDED UNDER RECORDING NO. 7912170566, IN KING COUNTY, WASHINGTON.

**PARCEL B**

AN EASEMENT OVER A PORTION OF THE NORTH 30 FEET OF THE NORTHEAST QUARTER OF THE SOUTHWEST QUARTER LYING WESTERLY OF 61ST AVE. N.E., SITUATE IN SECTION 2, TOWNSHIP 25 NORTH, RANGE 4 EAST, W.M., IN KING COUNTY, WASHINGTON.  
COUNTY OF KING, STATE OF WASHINGTON

**Attachment A**  
**Subsurface Utility Easement Parcels**

**15040**

| PARCEL ID | TAX PIN    | OWNER NAME                     | SITE ADDRESS                | SEGMENT |
|-----------|------------|--------------------------------|-----------------------------|---------|
| 5-38      | 4027701216 | DUNHAM<br>GREG D & CHRISTINE L | 19506 61ST AV NE<br>KENMORE | KENMORE |

**SEGMENT 5-38 DUNHAM - LEGAL DESCRIPTION:**

THE WEST 140 FEET OF LOT 5, BLOCK 8, LAKE FOREST PARK ESTATES, ACCORDING TO THE PLAT THEREOF RECORDED IN VOLUME 34 OF PLATS, PAGE 8, RECORDS OF KING COUNTY, WASHINGTON; AS MEASURED ALONG AND AT RIGHT ANGLES TO THE SOUTH LINE OF SAID LOT; EXCEPT THE SOUTH 75 FEET THEREOF; AND EXCEPT THE NORTH 10 FEET THEREOF.  
COUNTY OF KING, STATE OF WASHINGTON

| PARCEL ID | TAX PIN    | OWNER NAME                             | SITE ADDRESS                | SEGMENT |
|-----------|------------|--|-----------------------------|---------|
| 5-39      | 4027701213 | KEENEY GEORGE &<br>TAYLOR-KEENEY LAURI | 6115 NE 195TH PL<br>KENMORE | KENMORE |

**SEGMENT 5-39 KEENEY - LEGAL DESCRIPTION:**

PARCEL A

PARCEL 1 OF KING COUNTY SHORT PLAT NO. 876081, ACCORDING TO PLAT RECORDED MARCH 14, 1977 UNDER RECORDING NO. 7703140537, WHICH IS AN AMENDMENT OF SHORT PLAT RECORDED NOVEMBER 15, 1976 UNDER RECORDING NO. 7611151084, IN KING COUNTY, WASHINGTON.

PARCEL B

A NON-EXCLUSIVE EASEMENT FOR INGRESS AND EGRESS CREATED BY INSTRUMENT RECORDED SEPTEMBER 2, 1964 UNDER RECORDING NO. 5782028, IN KING COUNTY, WASHINGTON.  
COUNTY OF KING, STATE OF WASHINGTON

| PARCEL ID | TAX PIN    | OWNER NAME                                   | SITE ADDRESS | SEGMENT |
|-----------|------------|--|--------------|---------|
| 5-40      | 4027701214 | KEENEY<br>GEORGE WM &<br>TAYLOR-KEENEY LAURI |              | KENMORE |

**SEGMENT 5-40 KEENEY - LEGAL DESCRIPTION:**

PARCEL A

PARCEL 2 OF KING COUNTY SHORT PLAT NO. 876081, ACCORDING TO PLAT RECORDED NOVEMBER 15, 1976 UNDER RECORDING NO. 7611151084, IN KING COUNTY, WASHINGTON.

PARCEL B

A NON-EXCLUSIVE EASEMENT FOR INGRESS AND EGRESS CREATED BY INSTRUMENT RECORDED SEPTEMBER 2, 1964 UNDER RECORDING NO. 5782028, IN KING COUNTY, WASHINGTON.  
COUNTY OF KING, STATE OF WASHINGTON

| PARCEL ID | TAX PIN    | OWNER NAME                 | SITE ADDRESS                | SEGMENT |
|-----------|------------|----------------------------|-----------------------------|---------|
| 5-41      | 4027701219 | GOETZ<br>TRACY J & KAREN L | 6140 NE 195TH PL<br>KENMORE | KENMORE |

**SEGMENT 5-41 GOETZ - LEGAL DESCRIPTION:**

LOT 6, BLOCK 8, LAKE FOREST PARK ESTATES, ACCORDING TO THE PLAT THEREOF RECORDED IN VOLUME 34 OF PLATS, PAGE 8, IN KING COUNTY, WASHINGTON; EXCEPT THAT PORTION LYING WESTERLY OF CENTER LINE OF CREEK; AND TOGETHER WITH A 20 FOOT WIDE EASEMENT MEASURED ALONG THE SOUTH BOUNDARY OF SAID WESTERLY PORTION FOR ACCESS AND SERVICE TO EASTERLY PORTION OF SAID LOT 6.  
COUNTY OF KING, STATE OF WASHINGTON

**Attachment A  
Subsurface Utility Easement Parcels**

**15040**

| PARCEL ID | TAX PIN    | OWNER NAME                                   | SITE ADDRESS | SEGMENT |
|-----------|------------|--|--------------|---------|
| 5-42      | 4027701217 | KEENEY<br>GEORGE WM &<br>TAYLOR-KEENEY LAURI |              | KENMORE |

**SEGMENT 5-42 KEENEY - LEGAL DESCRIPTION:**

**PARCEL A**

PARCEL 3 OF KING COUNTY SHORT PLAT NO. 876081, ACCORDING TO PLAT RECORDED NOVEMBER 15, 1976 UNDER RECORDING NO. 7611151084, IN KING COUNTY, WASHINGTON.

**PARCEL B**

A NON-EXCLUSIVE EASEMENT FOR INGRESS AND EGRESS CREATED BY INSTRUMENT RECORDED SEPTEMBER 2, 1964 UNDER RECORDING NO. 5782028, IN KING COUNTY, WASHINGTON.  
COUNTY OF KING, STATE OF WASHINGTON

| PARCEL ID | TAX PIN    | OWNER NAME   | SITE ADDRESS | SEGMENT |
|-----------|------------|--------------|--------------|---------|
| 5-43      | 4027701218 | ROSS CRAIG N |              | KENMORE |

**SEGMENT 5-43 ROSS - LEGAL DESCRIPTION:**

LOT 4 OF KING COUNTY SHORT PLAT NO. 876081 AS RECORDED NOVEMBER 15, 1976 UNDER RECORDING NO. 7611151084 AND REVISED BY RECORDING NO. 7703140537, RECORDS OF KING COUNTY, WASHINGTON.  
COUNTY OF KING, STATE OF WASHINGTON

| PARCEL ID | TAX PIN    | OWNER NAME                | SITE ADDRESS                | SEGMENT |
|-----------|------------|---------------------------|-----------------------------|---------|
| 5-44      | 1112600060 | JATA<br>WAYNE E & CHERI A | 6157 NE 195TH CT<br>KENMORE | KENMORE |

**SEGMENT 5-44 JATA - LEGAL DESCRIPTION:**

LOT 6 OF BRIGHTON PARK, ACCORDING TO PLAT RECORDED JULY 26, 1988 IN VOLUME 142 OF PLATS AT PAGE(S) 29 AND 30, UNDER RECORDING NO. 8807260698, IN KING COUNTY, WASHINGTON.  
AND THAT PORTION OF LOT 5 OF BRIGHTON PARK, ACCORDING TO PLAT RECORDED JULY 26, 1988 IN VOLUME 142 OF PLATS AT PAGE(S) 29 AND 30, UNDER RECORDING NO. 8807260698, LYING SOUTHERLY OF THE FOLLOWING DESCRIBED LINE:  
BEGINNING AT THE SOUTHWESTERLY CORNER OF SAID LOT 5;  
THENCE SOUTH 71°54'46" EAST 65.97 FEET;  
THENCE SOUTH 72°30'11" EAST 30.00 FEET;  
THENCE SOUTH 70°50'13" EAST 38.10 FEET TO THE SOUTHEASTERLY CORNER OF SAID LOT 5 AND THE TERMINUS OF SAID DESCRIBED LINE.  
(ALSO KNOWN AS LOT "B" OF UNRECORDED KING COUNTY LOT LINE ADJUSTMENT NO. S89M0002)  
COUNTY OF KING, STATE OF WASHINGTON

**Attachment A  
Subsurface Utility Easement Parcels**

**15040**

| PARCEL ID | TAX PIN    | OWNER NAME                   | SITE ADDRESS                | SEGMENT |
|-----------|------------|------------------------------|-----------------------------|---------|
| 5-45      | 1112600050 | LAIRD<br>DAVID R & BEVERLY A | 6162 NE 195TH CT<br>KENMORE | KENMORE |

**SEGMENT 5-45 LAIRD - LEGAL DESCRIPTION:**

LOT 5 OF BRIGHTON PARK, ACCORDING TO PLAT RECORDED JULY 26, 1988 IN VOLUME 142 OF PLATS AT PAGE(S) 29 AND 30, UNDER RECORDING NO. 8807260698, IN KING COUNTY, WASHINGTON; EXCEPT THAT PORTION LYING SOUTHERLY OF THE FOLLOWING DESCRIBED LINE:  
BEGINNING AT THE SOUTHWESTERLY CORNER OF SAID LOT 5;  
THENCE SOUTH 71°54'46" EAST 65.97 FEET;  
THENCE SOUTH 72°30'11" EAST 30.00 FEET;  
THENCE SOUTH 70°50'13" EAST 38.10 FEET TO THE SOUTHEASTERLY CORNER OF SAID LOT 5 AND THE TERMINUS OF SAID DESCRIBED LINE.  
(ALSO KNOWN AS LOT "A" OF UNRECORDED KING COUNTY LOT LINE ADJUSTMENT NO. S89M0002)  
COUNTY OF KING, STATE OF WASHINGTON

| PARCEL ID | TAX PIN    | OWNER NAME      | SITE ADDRESS                | SEGMENT |
|-----------|------------|-----------------|-----------------------------|---------|
| 5-48      | 3824100284 | ROGERS NADENE E | 6204 NE 195TH ST<br>KENMORE | KENMORE |

**SEGMENT 5-48 ROGERS - LEGAL DESCRIPTION:**

LOT 2, CITY OF KENMORE SHORT PLAT NO. FSP01-008, RECORDED UNDER RECORDING NO. 20011212900013, RECORDS OF KING COUNTY, WASHINGTON.  
COUNTY OF KING, STATE OF WASHINGTON

| PARCEL ID | TAX PIN    | OWNER NAME                 | SITE ADDRESS                | SEGMENT |
|-----------|------------|----------------------------|-----------------------------|---------|
| 5-49      | 3824100285 | PIERCE<br>MARK A & SUSAN T | 19514 62ND AV NE<br>KENMORE | KENMORE |

**SEGMENT 5-49 PIERCE - LEGAL DESCRIPTION:**

THE SOUTH 98.33 FEET OF THE NORTH 196.66 FEET OF LOT 1, BLOCK 4, KENOVER ADDITION, ACCORDING TO THE PLAT THEREOF RECORDED IN VOLUME 43 OF PLATS, AT PAGE 1, RECORDS OF KING COUNTY, WASHINGTON.  
COUNTY OF KING, STATE OF WASHINGTON

| PARCEL ID | TAX PIN    | OWNER NAME                                | SITE ADDRESS                | SEGMENT |
|-----------|------------|---|-----------------------------|---------|
| 5-50      | 3824100291 | DAVIS<br>WILLIAM CLINTON<br>& ELLEN MARIE | 6218 NE 195TH ST<br>KENMORE | KENMORE |

**SEGMENT 5-50 DAVIS - LEGAL DESCRIPTION:**

THE SOUTH 100 FEET OF LOT 2, BLOCK 4, KENOVER ADDITION, ACCORDING TO THE PLAT THEREOF RECORDED IN VOLUME 43 OF PLATS, PAGE 1, RECORDS OF KING COUNTY, WASHINGTON  
COUNTY OF KING, STATE OF WASHINGTON

| PARCEL ID | TAX PIN    | OWNER NAME                     | SITE ADDRESS                | SEGMENT |
|-----------|------------|--------------------------------|-----------------------------|---------|
| 5-51      | 3824100296 | SCHMALE<br>JAMES T & CYNTHIA E | 6228 NE 195TH ST<br>KENMORE | KENMORE |

**SEGMENT 5-51 SCHMALE - LEGAL DESCRIPTION:**

THE SOUTH 96 FEET OF LOT 3, BLOCK 4, KENOVER ADDITION, ACCORDING TO THE PLAT THEREOF RECORDED IN VOLUME 43 OF PLATS, PAGE 1, RECORDS OF KING COUNTY, WASHINGTON.  
COUNTY OF KING, STATE OF WASHINGTON

**Attachment A**  
**Subsurface Utility Easement Parcels**

**15040**

| PARCEL ID | TAX PIN    | OWNER NAME                    | SITE ADDRESS                | SEGMENT |
|-----------|------------|-------------------------------|-----------------------------|---------|
| 5-52      | 3824100299 | SPORE<br>WESLEY M & BEVERLY J | 6238 NE 195TH ST<br>KENMORE | KENMORE |

**SEGMENT 5-52 SPORE - LEGAL DESCRIPTION:**

LOT 4 OF KING COUNTY SHORT PLAT NO. 175026, ACCORDING TO PLAT RECORDED MAY 22, 1975  
UNDER RECORDING NO. 7505220481, IN KING COUNTY, WASHINGTON.  
COUNTY OF KING, STATE OF WASHINGTON

| PARCEL ID | TAX PIN    | OWNER NAME                   | SITE ADDRESS                | SEGMENT |
|-----------|------------|------------------------------|-----------------------------|---------|
| 5-54      | 3824100320 | O'KEEFE<br>KEVIN W+DEBORAH K | 19507 63RD PL NE<br>KENMORE | KENMORE |

**SEGMENT 5-54 O'KEEFE - LEGAL DESCRIPTION:**

THAT PORTION OF LOT 8 IN BLOCK 4 OF KENOVER ADDITION, ACCORDING TO THE PLAT THEREOF  
RECORDED IN VOLUME 43 OF PLATS, PAGE 1, RECORDS OF KING COUNTY, WASHINGTON,  
DESCRIBED AS FOLLOWS:  
BEGINNING AT THE NORTHWEST CORNER OF SAID LOT 8 AND RUNNING  
THENCE SOUTH, ALONG THE WESTERLY LINE OF SAID LOT 196 FEET TO THE TRUE POINT OF  
BEGINNING;  
THENCE CONTINUING ALONG THE WESTERLY LINE OF SAID LOT 99 FEET TO THE SOUTHWEST  
CORNER OF SAID LOT 8;  
THENCE EAST, ALONG THE SOUTHERLY LINE OF SAID LOT, TO THE SOUTHEAST CORNER OF SAID  
LOT 8;  
THENCE NORTH ALONG THE EASTERLY LINE OF SAID LOT 39;  
THENCE WESTERLY PARALLEL TO THE SOUTHERLY LINE OF SAID LOT 8, 10 FEET;  
THENCE NORTHERLY PARALLEL TO THE EASTERLY LINE OF SAID LOT 8, 60 FEET;  
THENCE WESTERLY PARALLEL TO THE SOUTHERLY LINE OF SAID LOT 90 FEET TO THE WESTERLY  
LINE OF SAID LOT AND THE TRUE POINT OF BEGINNING,  
TOGETHER WITH VACATED STREET ADJACENT THAT WOULD ATTACH BY OPERATION OF LAW.  
COUNTY OF KING, STATE OF WASHINGTON

**Attachment A  
Subsurface Utility Easement Parcels**

**15040**

| PARCEL ID | Tax PIN    | OWNER NAME                        | SITE ADDRESS                | SEGMENT |
|-----------|------------|-----------------------------------|-----------------------------|---------|
| 5-55      | 3824100327 | YEH<br>CHING HSIUNG<br>& CHAO HAO | 19506 63RD PL NE<br>KENMORE | KENMORE |

**SEGMENT 5-55 YEH - LEGAL DESCRIPTION:**

THAT PORTION OF LOT 9, BLOCK 4, KENOVER ADDITION, ACCORDING TO THE PLAT THEREOF, RECORDED IN VOLUME 43 OF PLATS, PAGE 1, IN KING COUNTY, WASHINGTON, DESCRIBED AS FOLLOWS  
 BEGINNING AT THE NORTHEAST CORNER OF LOT 2 AND RUNNING  
 THENCE SOUTH ALONG THE EASTERLY LINE OF SAID LOT 196 FEET TO THE TRUE POINT OF BEGINNING,  
 THENCE CONTINUING ALONG THE EASTERLY LINE OF SAID LOT 99 FEET TO THE SOUTHEAST CORNER OF SAID LOT 9,  
 THENCE WEST ALONG THE SOUTH LINE OF SAID LOT TO THE SOUTHWEST CORNER OF SAID LOT 9,  
 THENCE NORTH ALONG WEST LINE OF SAID LOT 39 FEET,  
 THENCE EASTERLY AND PARALLEL TO THE SOUTHERLY LINE OF SAID LOT 9, 40 FEET,  
 THENCE ON A CURVE TO THE RIGHT WITH A RADIUS OF 20 FEET, THE CENTER OF WHICH IS ON THE EASTERLY EXTENSION OF THE LAST DESCRIBED LINE, AN ARC DISTANCE OF 31.40 FEET,  
 THENCE NORTHERLY AND PARALLEL WITH THE EASTERLY LINE OF SAID LOT 9, A DISTANCE OF 20 FEET TO THE POINT ON A CURVE TO THE RIGHT WITH A RADIUS OF 20 FEET, THE CENTER OF WHICH IS ON THE NORTHERLY EXTENSION OF THE LAST DESCRIBED LINE, AN ARC DISTANCE OF 31.40 FEET,  
 THENCE EASTERLY AND PARALLEL TO THE SOUTHERLY LINE OF SAID LOT 9, 90 FEET TO THE EASTERLY LINE OF SAID LOT AND THE TRUE POINT OF BEGINNING,  
 TOGETHER WITH AN UNDIVIDED 1/6 INTEREST TO THE ROADWAY CREATED BY INSTRUMENT RECORDED UNDER RECORDING NUMBER 5561249 (BEING A CORRECTION AND RE-RECORDING OF RECORDING NUMBER 5543324)  
 TOGETHER WITH THAT PORTION OF NORTHEAST 195 STREET AS VACATED UNDER KING COUNTY ORDINANCE NUMBER 5212 (NOVEMBER 24, 1980) WHICH ATTACHES BY OPERATION OF LAW.  
 COUNTY OF KING, STATE OF WASHINGTON

| PARCEL ID | Tax PIN    | OWNER NAME      | SITE ADDRESS                | SEGMENT |
|-----------|------------|-----------------|-----------------------------|---------|
| 5-56      | 3824100332 | WILLARD FRANK D | 19505 64TH AV NE<br>KENMORE | KENMORE |

**SEGMENT 5-56 WILLARD - LEGAL DESCRIPTION:**

LOT 10, BLOCK 4, KENOVER ADDITION, ACCORDING TO THE PLAT THEREOF RECORDED IN VOLUME 43 OF PLATS, PAGE 1, IN KING COUNTY, WASHINGTON; EXCEPT THE NORTH 201 FEET THEREOF; AND TOGETHER WITH THAT PORTION OF VACATED NORTHEAST 195TH STREET, WHICH ATTACHES BY OPERATION OF LAW.  
 COUNTY OF KING, STATE OF WASHINGTON

| PARCEL ID | Tax PIN    | OWNER NAME                    | SITE ADDRESS                | SEGMENT |
|-----------|------------|-------------------------------|-----------------------------|---------|
| 5-57      | 3824100336 | CHARD<br>HARRY E & BRIGITTE H | 19504 64TH AV NE<br>KENMORE | KENMORE |

**SEGMENT 5-57 CHARD - LEGAL DESCRIPTION:**

LOT 11, BLOCK 4, KENOVER ADDITION, ACCORDING TO THE PLAT THEREOF RECORDED IN VOLUME 43 OF PLATS, AT PAGE 1, RECORDS OF KING COUNTY, WASHINGTON.  
 EXCEPT THE NORTH 196 FEET THEREOF.  
 COUNTY OF KING, STATE OF WASHINGTON

| PARCEL ID | Tax PIN    | OWNER NAME | SITE ADDRESS     | SEGMENT |
|-----------|------------|------------|------------------|---------|
| 5-58      | 3824100342 | MORETTI    | 6366 NE 194TH ST | KENMORE |

**Attachment A  
Subsurface Utility Easement Parcels**

**15040**

|  |  |                         |         |  |
|--|--|-------------------------|---------|--|
|  |  | VINCENT C & CONSTANCE M | KENMORE |  |
|--|--|-------------------------|---------|--|

**SEGMENT 5-58 MORETTI - LEGAL DESCRIPTION:**

**PARCEL A**

LOT 2 OF KING COUNTY SHORT PLAT NO. 685020, ACCORDING TO PLAT RECORDED DECEMBER 9, 1985 UNDER RECORDING NO. 8512090477, IN KING COUNTY, WASHINGTON;  
TOGETHER WITH THAT PORTION OF VACATED NORTHEAST 195TH STREET ADJOINING OR ABUTTING THEREON, WHICH UPON VACATION, ATTACHED TO SAID PREMISES BY OPERATION OF LAW.

**PARCEL B**

AN EASEMENT FOR INGRESS AND EGRESS OVER TRACT A OF PRESTIGE HEIGHTS DIVISION NO. 2, ACCORDING TO PLAT RECORDED IN VOLUME 116 OF PLATS AT PAGES 66 THROUGH 68, IN KING COUNTY, WASHINGTON.  
COUNTY OF KING, STATE OF WASHINGTON

| PARCEL ID | TAX PIN    | OWNER NAME            | SITE ADDRESS                | SEGMENT |
|-----------|------------|-----------------------|-----------------------------|---------|
| 5-59      | 3820100120 | TU<br>I-CHANG & ANNIE | 19502 65TH AV NE<br>KENMORE | KENMORE |

**SEGMENT 5-59 TU - LEGAL DESCRIPTION:**

LOT 24, KENMORE TERRACE, ACCORDING TO THE PLAT THEREOF RECORDED IN VOLUME 59 OF PLATS, PAGE(S) 71 AND 72 INCLUSIVE, RECORDS OF KING COUNTY, WASHINGTON.  
COUNTY OF KING, STATE OF WASHINGTON

| PARCEL ID | TAX PIN    | OWNER NAME                  | SITE ADDRESS                | SEGMENT |
|-----------|------------|-----------------------------|-----------------------------|---------|
| 5-60      | 8833510120 | NEILL<br>ALLAN H & JANICE M | 19428 65TH AV NE<br>KENMORE | KENMORE |

**SEGMENT 5-60 NEILL - LEGAL DESCRIPTION:**

LOT 12 OF UPLAKE VISTA NO. 2, ACCORDING TO PLAT RECORDED MAY 12, 1976 IN VOLUME 99 OF PLATS AT PAGE(S) 97 AND 98, IN KING COUNTY, WASHINGTON.  
COUNTY OF KING, STATE OF WASHINGTON

| PARCEL ID | TAX PIN    | OWNER NAME                    | SITE ADDRESS                | SEGMENT |
|-----------|------------|-------------------------------|-----------------------------|---------|
| 5-61      | 8833510110 | BURTON<br>WILLIAM D & BARBARA | 19422 65TH PL NE<br>KENMORE | KENMORE |

**SEGMENT 5-61 BURTON - LEGAL DESCRIPTION:**

LOT 11 OF UPLAKE VISTA NO. 2, ACCORDING TO PLAT RECORDED MAY 12, 1976 IN VOLUME 99 OF PLATS AT PAGE(S) 97 AND 98, IN KING COUNTY, WASHINGTON.  
COUNTY OF KING, STATE OF WASHINGTON

| PARCEL ID | TAX PIN    | OWNER NAME                   | SITE ADDRESS                | SEGMENT |
|-----------|------------|------------------------------|-----------------------------|---------|
| 5-62      | 3820100125 | SMITH<br>JON D & CHARLOTTE M | 6521 NE 196TH ST<br>KENMORE | KENMORE |

**SEGMENT 5-62 SMITH - LEGAL DESCRIPTION:**

LOT 25, KENMORE TERRACE, ACCORDING TO THE PLAT THEREOF RECORDED IN VOLUME 59 OF PLATS, PAGE(S) 71 AND 72 INCLUSIVE, RECORDS OF KING COUNTY, WASHINGTON.  
COUNTY OF KING, STATE OF WASHINGTON



**Attachment A  
Subsurface Utility Easement Parcels**

**15040**

| PARCEL ID | TAX PIN    | OWNER NAME                      | SITE ADDRESS                | SEGMENT |
|-----------|------------|---------------------------------|-----------------------------|---------|
| 5-63      | 3820100130 | PRATHER<br>CHARLES D & JULIANNA | 6531 NE 196TH ST<br>KENMORE | KENMORE |

**SEGMENT 5-63 PRATHER - LEGAL DESCRIPTION:**

LOT 26, KENMORE TERRACE, ACCORDING TO THE PLAT THEREOF RECORDED IN VOLUME 59 OF PLATS, PAGE(S) 71 AND 72 INCLUSIVE, RECORDS OF KING COUNTY, WASHINGTON.  
COUNTY OF KING, STATE OF WASHINGTON

| PARCEL ID | TAX PIN    | OWNER NAME                  | SITE ADDRESS                | SEGMENT |
|-----------|------------|-----------------------------|-----------------------------|---------|
| 5-64      | 8833510100 | KIM<br>CHIN MO & CHONG BANG | 19416 65TH PL NE<br>KENMORE | KENMORE |

**SEGMENT 5-64 KIM - LEGAL DESCRIPTION:**

LOT 10 OF UPLAKE VISTA NO. 2, ACCORDING TO PLAT RECORDED MAY 12, 1976 IN VOLUME 99 OF PLATS AT PAGE(S) 97 AND 98, IN KING COUNTY, WASHINGTON.  
COUNTY OF KING, STATE OF WASHINGTON

| PARCEL ID | TAX PIN    | OWNER NAME       | SITE ADDRESS                | SEGMENT |
|-----------|------------|------------------|-----------------------------|---------|
| 5-65      | 8833510090 | WESTPHAL LYNNE E | 19410 65TH PL NE<br>KENMORE | KENMORE |

**SEGMENT 5-65 WESTPHAL - LEGAL DESCRIPTION:**

LOT 9 OF UPLAKE VISTA NO. 2, ACCORDING TO PLAT RECORDED MAY 12, 1976 IN VOLUME 99 OF PLATS AT PAGE(S) 97 AND 98, IN KING COUNTY, WASHINGTON.  
COUNTY OF KING, STATE OF WASHINGTON

| PARCEL ID | TAX PIN    | OWNER NAME                       | SITE ADDRESS                | SEGMENT |
|-----------|------------|----------------------------------|-----------------------------|---------|
| 5-66      | 6708200090 | HUGHES<br>JOHN EDWARD & LALLIE C | 19425 66TH PL NE<br>KENMORE | KENMORE |

**SEGMENT 5-66 HUGHES - LEGAL DESCRIPTION:**

LOT 9 OF PENTLAND WOODS DIVISION NO. 2, ACCORDING TO PLAT RECORDED IN VOLUME 67 OF PLATS AT PAGES 42 AND 43, IN SNOHOMISH COUNTY, WASHINGTON.  
COUNTY OF SNOHOMISH, STATE OF WASHINGTON

| PARCEL ID | TAX PIN    | OWNER NAME                   | SITE ADDRESS                | SEGMENT |
|-----------|------------|------------------------------|-----------------------------|---------|
| 5-69      | 6708200100 | NORDSLETTEN<br>OLIN & ARLETT | 19420 66TH PL NE<br>KENMORE | KENMORE |

**SEGMENT 5-69 NORDSLETTEN - LEGAL DESCRIPTION:**

LOT 10 OF PENTLAND WOODS DIVISION NO. 2, ACCORDING TO PLAT RECORDED IN VOLUME 67 OF PLATS AT PAGES 42 AND 43, IN SNOHOMISH COUNTY, WASHINGTON;  
TOGETHER WITH THAT PORTION OF LOT 11 OF SAID PLAT DESCRIBED AS FOLLOWS:  
COMMENCING AT THE WESTERLY CORNER OF SAID LOT 11, THE TRUE POINT OF BEGINNING;  
THENCE SOUTH 27° EAST A DISTANCE OF 6 FEET ALONG THE SOUTHWESTERLY LINE;  
THENCE NORTHEASTERLY TO THE NORTH CORNER OF SAID LOT 11;  
THENCE SOUTH 60° WEST A DISTANCE OF 164.9 FEET TO THE TRUE POINT OF BEGINNING.  
COUNTY OF SNOHOMISH, STATE OF WASHINGTON

**Attachment A  
Subsurface Utility Easement Parcels**

**15040**

| PARCEL ID | TAX PIN    | OWNER NAME                 | SITE ADDRESS                | SEGMENT |
|-----------|------------|----------------------------|-----------------------------|---------|
| 5-72      | 6708200130 | SCHULTZ<br>PAUL A & MARY T | 19413 67TH AV NE<br>KENMORE | KENMORE |

**SEGMENT 5-72 SCHULTZ - LEGAL DESCRIPTION:**

LOT 13 OF PENTLAND WOODS DIVISION NO. 2, ACCORDING TO PLAT RECORDED IN VOLUME 67 OF PLATS AT PAGES 42 AND 43, IN KING COUNTY, WASHINGTON.  
COUNTY OF KING, STATE OF WASHINGTON

| PARCEL ID | TAX PIN    | OWNER NAME                  | SITE ADDRESS                | SEGMENT |
|-----------|------------|-----------------------------|-----------------------------|---------|
| 5-74      | 6708200140 | LACY<br>GENE H & MARY ELLEN | 19414 67TH AV NE<br>KENMORE | KENMORE |

**SEGMENT 5-74 LACY - LEGAL DESCRIPTION:**

LOT 14 OF PENTLAND WOODS DIVISION NO. 2, ACCORDING TO PLAT RECORDED IN VOLUME 67 OF PLATS AT PAGES 42 AND 43, IN KING COUNTY, WASHINGTON.  
COUNTY OF KING, STATE OF WASHINGTON

| PARCEL ID | TAX PIN    | OWNER NAME                     | SITE ADDRESS                | SEGMENT |
|-----------|------------|--------------------------------|-----------------------------|---------|
| 5-75      | 0126049212 | STEVENSON<br>STORM J & KATHRYN | 6707 NE 195TH ST<br>KENMORE | KENMORE |

**SEGMENT 5-75 STEVENSON - LEGAL DESCRIPTION:**

PARCEL A

LOT 2 OF KING COUNTY SHORT PLAT NO. 278036, ACCORDING TO PLAT RECORDED MAY 17, 1979 UNDER RECORDING NO. 7905170576, IN KING COUNTY, WASHINGTON.

PARCEL B

A NON-EXCLUSIVE EASEMENT FOR INGRESS AND EGRESS CREATED BY INSTRUMENT RECORDED JULY 30, 1992 UNDER RECORDING NO. 8602240746, IN KING COUNTY, WASHINGTON.  
COUNTY OF KING, STATE OF WASHINGTON

| PARCEL ID | TAX PIN    | OWNER NAME                     | SITE ADDRESS                | SEGMENT |
|-----------|------------|--------------------------------|-----------------------------|---------|
| 5-76      | 0126049056 | STEVENSON<br>KATHRYN P+STORM J | 6709 NE 195TH ST<br>KENMORE | KENMORE |

**SEGMENT 5-76 STEVENSON - LEGAL DESCRIPTION:**

LOT 3 OF KING COUNTY SHORT PLAT NO. 278036, ACCORDING TO PLAT RECORDED MAY 17, 1979 UNDER RECORDING NO. 7905170576, IN KING COUNTY, WASHINGTON.  
COUNTY OF KING, STATE OF WASHINGTON

**Attachment A  
Subsurface Utility Easement Parcels**

**15040**

| PARCEL ID | TAX PIN    | OWNER NAME    | SITE ADDRESS | SEGMENT |
|-----------|------------|---------------|--------------|---------|
| 5-81      | 0114100255 | MCDUGALL ELIN |              | KENMORE |

**SEGMENT 5-81 MCDUGALL - LEGAL DESCRIPTION:**

THE WEST 338 FEET OF LOT 12, BLOCK 4, ALDERWOOD MANOR NO. 14, ACCORDING TO THE PLAT THEREOF RECORDED IN VOLUME 26 OF PLATS, PAGE 4, RECORDS OF KING COUNTY, WASHINGTON, DESCRIBED AS FOLLOWS:  
 BEGINNING AT THE SOUTHWEST CORNER OF SAID LOT;  
 THENCE NORTHERLY ALONG THE WESTERLY LINE OF SAID LOT 116.16 FEET;  
 THENCE EASTERLY TO A POINT ON THE EAST LINE 126.68 FEET NORTH OF THE SOUTHEAST CORNER;  
 THENCE SOUTHERLY ALONG THE EAST LINE 126.68 FEET;  
 THENCE WESTERLY ALONG THE SOUTHERLY LINE 687.42 FEET TO THE POINT OF BEGINNING.  
 EXCEPT THE NORTH 96 FEET OF THE WEST 200 FEET THEREOF.  
 COUNTY OF KING, STATE OF WASHINGTON

| PARCEL ID | TAX PIN    | OWNER NAME    | SITE ADDRESS                | SEGMENT |
|-----------|------------|---------------|-----------------------------|---------|
| 5-82      | 0114100221 | KING WALTER J | 19507 73RD AV NE<br>KENMORE | KENMORE |

**SEGMENT 5-82 KING - LEGAL DESCRIPTION:**

THAT PORTION OF TRACT 9, BLOCK 4, ALDERWOOD MANOR NO. 14, ACCORDING TO THE PLAT THEREOF RECORDED IN VOLUME 26 OF PLATS, PAGE 4, RECORDS OF KING COUNTY, WASHINGTON, LYING SOUTH OF THE SOUTH LINE OF THE NORTH 70.00 FEET IN WIDTH OF SAID TRACT AND EAST OF A LINE DESCRIBED AS FOLLOWS:  
 BEGINNING ON THE NORTH LINE OF SAID TRACT 9 AT A POINT 342.00 FEET EAST OF THE NORTHWEST CORNER THEREOF;  
 THENCE SOUTH PARALLEL WITH THE WEST LINE OF SAID TRACT A DISTANCE OF 70.00 FEET;  
 THENCE EAST PARALLEL WITH THE NORTH LINE OF SAID TRACT A DISTANCE OF 8.53 FEET;  
 THENCE SOUTH PARALLEL WITH THE WEST LINE OF SAID TRACT TO THE SOUTH LINE OF SAID TRACT AND TERMINUS OF THE LINE.  
 COUNTY OF KING, STATE OF WASHINGTON

| PARCEL ID | TAX PIN    | OWNER NAME                    | SITE ADDRESS | SEGMENT |
|-----------|------------|-------------------------------|--------------|---------|
| 5-84      | 0114100145 | WERRIES<br>ELLIS H & MURIEL A |              | KENMORE |

**SEGMENT 5-84 WERRIES - LEGAL DESCRIPTION:**

LOT 12, BLOCK 3, ALDERWOOD MANOR NO. 14, ACCORDING TO THE PLAT THEREOF RECORDED IN VOLUME 26 OF PLATS, PAGE 4, RECORDS OF KING COUNTY, WASHINGTON.  
 EXCEPT THE EAST 250 FEET THEREOF.  
 COUNTY OF KING, STATE OF WASHINGTON

| PARCEL ID | TAX PIN    | OWNER NAME                      | SITE ADDRESS                | SEGMENT |
|-----------|------------|---------------------------------|-----------------------------|---------|
| 5-86      | 0114100136 | WERRIES<br>DALE S & CATHERINE G | 19501 75TH AV NE<br>KENMORE | KENMORE |

**SEGMENT 5-86 WERRIES - LEGAL DESCRIPTION:**

**PARCEL A**

LOT 2 OF KING COUNTY SHORT PLAT NO. 984067, ACCORDING TO SHORT PLAT RECORDED JUNE 10, 1985 UNDER RECORDING NO. 8506100550, IN KING COUNTY, WASHINGTON.

**PARCEL B**

A NON-EXCLUSIVE EASEMENT FOR INGRESS AND EGRESS AS DELINEATED ON SAID SHORT PLAT.  
 COUNTY OF KING, STATE OF WASHINGTON

**Attachment A**  
**Subsurface Utility Easement Parcels**

| PARCEL ID | TAX PIN    | OWNER NAME                       | SITE ADDRESS                | SEGMENT |
|-----------|------------|----------------------------------|-----------------------------|---------|
| 5-87      | 0114100169 | DEXTER STAN<br>& CARTER JEANETTE | 19504 75TH AV NE<br>KENMORE | KENMORE |

**SEGMENT 5-87 DEXTER/CARTER - LEGAL DESCRIPTION:**

LOT 2 OF CITY OF KENMORE SHORT PLAT NO. FP-00-009, ACCORDING TO SHORT PLAT RECORDED SEPTEMBER 14, 2000 UNDER RECORDING NO. 20000914900003, IN KING COUNTY, WASHINGTON. COUNTY OF KING, STATE OF WASHINGTON

| PARCEL ID | TAX PIN    | OWNER NAME                   | SITE ADDRESS | SEGMENT |
|-----------|------------|------------------------------|--------------|---------|
| 5-91      | 4027707777 | STROM<br>FRANS ALLAN & EDITH |              | KENMORE |

**SEGMENT 5-91 STROM - LEGAL DESCRIPTION:**

THAT PORTION OF LOTS 25 AND 26, BLOCK 5, LAKE FOREST PARK ESTATES, ACCORDING TO THE PLAT THEREOF RECORDED IN VOLUME 34 OF PLATS, PAGE 8, RECORDS OF KING COUNTY, WASHINGTON, DESCRIBED AS FOLLOWS:  
 BEGINNING AT THE SOUTHWESTERLY CORNER OF SAID LOT 26;  
 THENCE SOUTH 88°35'54" EAST, ALONG THE SOUTH LINE OF LOT 26, A DISTANCE OF 30.10 FEET;  
 THENCE NORTH 05°58'29" EAST, PARALLEL WITH THE WEST LINE OF SAID LOT 26, A DISTANCE OF 90.36 FEET TO THE TRUE POINT OF BEGINNING;  
 THENCE SOUTH 88°35'54" EAST 178.34 FEET TO A POINT ON A CURVE AT WHICH POINT THE RADIAL BEARS SOUTH 05°58'29" WEST;  
 THENCE SOUTHEASTERLY ALONG SAID CURVE TO THE RIGHT AN ARC DISTANCE OF 33.01 FEET AT WHICH POINT THE TANGENT OF SAID CURVE BEARS NORTH 05°58'29" EAST AND HAVING A RADIUS OF 20.00 FEET;  
 THENCE SOUTH 88°35'54" EAST 20.00 FEET TO A POINT ON A CURVE AT WHICH POINT THE TANGENT BEARS SOUTH 05°58'29" WEST;  
 THENCE NORTHEASTERLY ALONG SAID CURVE TO THE RIGHT, AN ARC DISTANCE OF 29.82 FEET, SAID CURVE HAVING A RADIUS OF 20.00 FEET;  
 THENCE NORTH 05°58'29" EAST 23.25 FEET;  
 THENCE NORTH 88°35'54" WEST 238.47 FEET;  
 THENCE SOUTH 05°58'29" WEST 20.06 FEET TO THE TRUE POINT OF BEGINNING.  
 COUNTY OF KING, STATE OF WASHINGTON

| PARCEL ID | TAX PIN    | OWNER NAME                  | SITE ADDRESS | SEGMENT |
|-----------|------------|-----------------------------|--------------|---------|
| 5-92      | 4027707777 | HEALD<br>BRUCE R. & LOIS E. |              | KENMORE |

**SEGMENT 5-92 HEALD - LEGAL DESCRIPTION:**

THAT PORTION OF TRACT 26, BLOCK 5, LAKE FOREST PARK ESTATE, ACCORDING TO PLAT RECORDED IN VOLUME 34 OF PLATS, PAGE 8, RECORDS OF KING COUNTY, WASHINGTON, DESCRIBED AS FOLLOWS:  
 BEGINNING AT A POINT ON THE EAST LINE THEREOF 90.0 FEET NORTH 14°54'50" EAST FROM THE SOUTHEAST CORNER THEREOF;  
 THENCE CONTINUING ALONG THE EAST LINE NORTH 14°54'50" EAST A DISTANCE OF 12.96 FEET TO THE NORTHEAST CORNER THEREOF;  
 THENCE ALONG THE NORTH LINE NORTH 88°51'07" WEST A DISTANCE OF 130.0 FEET;  
 THENCE SOUTH 14°54'50" WEST, PARALLEL TO THE EAST LINE, A DISTANCE OF 30.96 FEET;  
 THENCE SOUTH 88°51'07" EAST A DISTANCE OF 20.0 FEET;  
 THENCE NORTH 14°54'50" EAST A DISTANCE OF 18.0 FEET;  
 THENCE SOUTH 88°55'07" EAST A DISTANCE OF 110.0 FEET TO THE POINT OF BEGINNING;  
 TOGETHER WITH THAT PORTION OF TRACT 25, SAID BLOCK 5, OF SAID PLAT OF LAKE FOREST PARK ESTATES, DESCRIBED AS THE SOUTHERLY 12.96 FEET, AS MEASURED ALONG AND PARALLEL TO, THE EAST LINE THEREOF OF THE EASTERLY 130.0 FEET, AS MEASURED ALONG THE SOUTH LINE THEREOF.  
 COUNTY OF KING, STATE OF WASHINGTON

**Attachment A  
Subsurface Utility Easement Parcels**

**15040**

**Bothell Segment – (Portal 44 to 41) Subsurface Utility Easements**

| PARCEL ID | TAX PIN    | OWNER NAME                    | SITE ADDRESS                 | SEGMENT |
|-----------|------------|-------------------------------|------------------------------|---------|
| 44-4      | 1737320030 | REA THOMAS P<br>& DOLAN NANCY | 19319 89TH AVE NE<br>BOTHELL | BOTHELL |

**SEGMENT 44-4 REA/DOLAN - LEGAL DESCRIPTION:**

LOT 3, CONIFER VIEW NO. 3, ACCORDING TO THE PLAT THEREOF RECORDED IN VOLUME 98 OF PLATS, PAGES 97 AND 98, IN KING COUNTY, WASHINGTON.  
COUNTY OF KING, STATE OF WASHINGTON

| PARCEL ID | TAX PIN    | OWNER NAME         | SITE ADDRESS                 | SEGMENT |
|-----------|------------|--------------------|------------------------------|---------|
| 44-7      | 1737320100 | KRZESZOWSKI PAUL H | 19318 89TH AVE NE<br>BOTHELL | BOTHELL |

**SEGMENT 44-7 KRESZOWSKI - LEGAL DESCRIPTION:**

LOT 10, CONIFER VIEW NO. 3, ACCORDING TO THE PLAT THEREOF RECORDED IN VOLUME 98 OF PLATS, PAGES 97 AND 98, RECORDS OF KING COUNTY, WASHINGTON.  
COUNTY OF KING, STATE OF WASHINGTON

| PARCEL ID | TAX PIN    | OWNER NAME                   | SITE ADDRESS                 | SEGMENT |
|-----------|------------|------------------------------|------------------------------|---------|
| 44-8      | 1737320140 | ADAMS<br>JAY B & GENEVIEVE K | 19325 90TH AVE NE<br>BOTHELL | BOTHELL |

**SEGMENT 44-8 ADAMS - LEGAL DESCRIPTION:**

LOT 14, CONIFER VIEW NO. 3, ACCORDING TO THE PLAT THEREOF RECORDED IN VOLUME 98 OF PLATS, PAGES 97 AND 98, IN KING COUNTY, WASHINGTON.  
COUNTY OF KING, STATE OF WASHINGTON

| PARCEL ID | TAX PIN    | OWNER NAME                     | SITE ADDRESS                 | SEGMENT |
|-----------|------------|--------------------------------|------------------------------|---------|
| 44-9      | 1737320150 | DENNIS<br>STEPHEN G & SHERRY C | 19317 90TH AVE NE<br>BOTHELL | BOTHELL |

**SEGMENT 44-9 DENNIS - LEGAL DESCRIPTION:**

LOT 15 OF CONIFER VIEW NO. 3, AS PER PLAT RECORDED IN VOLUME 98 OF PLATS, PAGES 97 AND 98, RECORDS OF KING COUNTY.  
COUNTY OF KING, STATE OF WASHINGTON

| PARCEL ID | TAX PIN    | OWNER NAME                     | SITE ADDRESS                 | SEGMENT |
|-----------|------------|--------------------------------|------------------------------|---------|
| 44-10     | 1737320160 | NELSON<br>ROBERT H & CYNTHIA J | 19305 90TH AVE NE<br>BOTHELL | BOTHELL |

**SEGMENT 44-10 NELSON - LEGAL DESCRIPTION:**

LOT 16, CONIFER VIEW NO. 3, ACCORDING TO THE PLAT RECORDED IN VOLUME 98 OF PLATS, PAGES 97 AND 98, KING COUNTY, WASHINGTON.  
COUNTY OF KING, STATE OF WASHINGTON

| PARCEL ID | TAX PIN    | OWNER NAME  | SITE ADDRESS     | SEGMENT |
|-----------|------------|-------------|------------------|---------|
| 44-11     | 1737310010 | ESPINOZA JR | 19242 90TH PL NE | BOTHELL |

**Attachment A**  
**Subsurface Utility Easement Parcels**

**15040**

|  |  |                   |         |  |
|--|--|-------------------|---------|--|
|  |  | JOSE & NATHALIE M | BOTHELL |  |
|--|--|-------------------|---------|--|

**SEGMENT 44-11 ESPINOZA - LEGAL DESCRIPTION:**

LOT 1, CONIFER VIEW NO. 2, ACCORDING TO THE PLAT THEREOF RECORDED IN VOLUME 95 OF PLATS, PAGE 17, IN KING COUNTY, WASHINGTON.  
COUNTY OF KING, STATE OF WASHINGTON

| PARCEL ID | TAX PIN    | OWNER NAME               | SITE ADDRESS                 | SEGMENT |
|-----------|------------|--------------------------|------------------------------|---------|
| 44-12     | 1737310140 | PARKS<br>R C & MICHELE R | 19240 90TH AVE NE<br>BOTHELL | BOTHELL |

**SEGMENT 44-12 PARKS - LEGAL DESCRIPTION:**

LOT 14, CONIFER VIEW NO. 2, ACCORDING TO THE PLAT THEREOF, RECORDED IN VOLUME 95 OF PLATS, PAGE 17, IN KING COUNTY, WASHINGTON.  
COUNTY OF KING, STATE OF WASHINGTON

| PARCEL ID | TAX PIN    | OWNER NAME                   | SITE ADDRESS                 | SEGMENT |
|-----------|------------|------------------------------|------------------------------|---------|
| 44-13     | 1737310130 | GLITHERO<br>THOMAS P & JAN E | 19232 90TH AVE NE<br>BOTHELL | BOTHELL |

**SEGMENT 44-13 GLITHERO - LEGAL DESCRIPTION:**

LOT 13, CONIFER VIEW NO. 2, ACCORDING TO THE PLAT RECORDED IN VOLUME 95 OF PLATS, PAGE 17, IN KING COUNTY, WASHINGTON.  
COUNTY OF KING, STATE OF WASHINGTON

| PARCEL ID | TAX PIN    | OWNER NAME                      | SITE ADDRESS                 | SEGMENT |
|-----------|------------|---------------------------------|------------------------------|---------|
| 44-14     | 1737310120 | THOMPSON<br>JAMES V & KRISTEN L | 19222 90TH AVE NE<br>BOTHELL | BOTHELL |

**SEGMENT 44-14 THOMPSON - LEGAL DESCRIPTION:**

LOT 12, CONIFER VIEW NO. 2, ACCORDING TO THE PLAT THEREOF RECORDED IN VOLUME 95 OF PLATS, PAGE 17, RECORDS OF KING COUNTY, WASHINGTON.  
COUNTY OF KING, STATE OF WASHINGTON

| PARCEL ID | TAX PIN    | OWNER NAME                 | SITE ADDRESS                 | SEGMENT |
|-----------|------------|----------------------------|------------------------------|---------|
| 44-15     | 1737300140 | FREY<br>ROBERT A & JANET A | 19229 91ST AVE NE<br>BOTHELL | BOTHELL |

**SEGMENT 44-15 FREY - LEGAL DESCRIPTION:**

LOT 14, CONIFER VIEW, ACCORDING TO THE PLAT THEREOF RECORDED IN VOLUME 87 OF PLATS, PAGES 47 AND 48, RECORDS OF KING COUNTY, WASHINGTON.  
COUNTY OF KING, STATE OF WASHINGTON

| PARCEL ID | TAX PIN    | OWNER NAME                  | SITE ADDRESS                 | SEGMENT |
|-----------|------------|-----------------------------|------------------------------|---------|
| 44-16     | 1737300130 | CARTER<br>JAMES G & JANET E | 19234 91ST AVE NE<br>BOTHELL | BOTHELL |

**SEGMENT 44-16 CARTER - LEGAL DESCRIPTION:**

LOT 13, CONIFER VIEW, ACCORDING TO THE PLAT THEREOF RECORDED IN VOLUME 87 OF PLATS, PAGES 47 AND 48, RECORDS OF KING COUNTY, WASHINGTON.  
COUNTY OF KING, STATE OF WASHINGTON

**Attachment A**  
**Subsurface Utility Easement Parcels**

15040

| PARCEL ID | TAX PIN    | OWNER NAME                     | SITE ADDRESS                 | SEGMENT |
|-----------|------------|--------------------------------|------------------------------|---------|
| 44-17     | 1737300120 | THOMPSON<br>DAVID P & MAUDJEAN | 19230 91ST AVE NE<br>BOTHELL | BOTHELL |

**SEGMENT 44-17 THOMPSON - LEGAL DESCRIPTION:**

LOT 12, CONIFER VIEW, ACCORDING TO THE PLAT THEREOF RECORDED IN VOLUME 87 OF PLATS, PAGES 47 AND 48, RECORDS OF KING COUNTY, WASHINGTON;  
TOGETHER WITH THAT PORTION OF LOT 2 AND LOT 3 IN SAID PLAT DESCRIBED AS FOLLOWS:  
BEGINNING AT THE S.E. CORNER OF SAID LOT 12;  
THENCE SOUTH 89°25'15" EAST, ALONG THE EASTERLY EXTENSION OF THE SOUTH LINE OF SAID LOT, A DISTANCE OF 7.14 FEET;  
THENCE NORTH 3°25'14" WEST 120.85 FEET TO THE NORTHWEST CORNER OF SAID LOT 2;  
THENCE SOUTH 0°33'45" WEST ALONG THE WEST LINE OF SAID LOTS 2 AND 3, A DISTANCE OF 102.60 FEET TO THE POINT OF BEGINNING.  
COUNTY OF KING, STATE OF WASHINGTON

| PARCEL ID | TAX PIN    | OWNER NAME                   | SITE ADDRESS                 | SEGMENT |
|-----------|------------|------------------------------|------------------------------|---------|
| 44-19     | 1737300010 | DAOURA<br>PETER W & KRISTI J | 19247 92ND AVE NE<br>BOTHELL | BOTHELL |

**SEGMENT 44-19 DAOURA - LEGAL DESCRIPTION:**

LOT 1, CONIFER VIEW, ACCORDING TO THE PLAT THEREOF RECORDED IN VOLUME 87 OF PLATS, PAGES 47 AND 48, IN KING COUNTY, WASHINGTON.  
COUNTY OF KING, STATE OF WASHINGTON

| PARCEL ID | TAX PIN    | OWNER NAME                 | SITE ADDRESS                 | SEGMENT |
|-----------|------------|----------------------------|------------------------------|---------|
| 44-20     | 9492100190 | FUKURA<br>GLENN T & DALE E | 19312 92ND AVE NE<br>BOTHELL | BOTHELL |

**SEGMENT 44-20 FUKURA - LEGAL DESCRIPTION:**

LOT 19, WISTFUL VISTA DIVISION B, ACCORDING TO THE PLAT THEREOF RECORDED IN VOLUME 76 OF PLATS, PAGE(S) 96 INCLUSIVE, RECORDS OF KING COUNTY, WASHINGTON.  
COUNTY OF KING, STATE OF WASHINGTON

| PARCEL ID | TAX PIN    | OWNER NAME                        | SITE ADDRESS                | SEGMENT |
|-----------|------------|-----------------------------------|-----------------------------|---------|
| 44-21     | 9492100200 | WOOD<br>DAVID WAYNE &<br>JEANNE R | 9215 NE 195TH PL<br>BOTHELL | BOTHELL |

**SEGMENT 44-21 WOOD - LEGAL DESCRIPTION:**

LOT 20, WISTFUL VISTA DIVISION B, ACCORDING TO THE PLAT THEREOF RECORDED IN VOLUME 76 OF PLATS, PAGE(S) 96 INCLUSIVE, RECORDS OF KING COUNTY, WASHINGTON.  
COUNTY OF KING, STATE OF WASHINGTON

| PARCEL ID | TAX PIN    | OWNER NAME                   | SITE ADDRESS                | SEGMENT |
|-----------|------------|------------------------------|-----------------------------|---------|
| 44-22     | 9492100210 | GRAVES<br>RONALD V & JANET B | 9219 NE 195TH ST<br>BOTHELL | BOTHELL |

**SEGMENT 44-22 GRAVES - LEGAL DESCRIPTION:**

LOT 21, WISTFUL VISTA DIVISION B, ACCORDING TO THE PLAT THEREOF RECORDED IN VOLUME 76 OF PLATS, PAGE(S) 96 INCLUSIVE, RECORDS OF KING COUNTY, WASHINGTON.  
COUNTY OF KING, STATE OF WASHINGTON

**Attachment A  
Subsurface Utility Easement Parcels**

| PARCEL ID | TAX PIN    | OWNER NAME                         | SITE ADDRESS | SEGMENT |
|-----------|------------|------------------------------------|--------------|---------|
| 44-23     | 9492100220 | LANDA<br>JORGE FELIX & SHIRLEY MAY |              | BOTHELL |

**SEGMENT 44-23 LANDA - LEGAL DESCRIPTION:**

TRACT A, WISTFUL VISTA DIVISION B, ACCORDING TO THE PLAT THEREOF RECORDED IN VOLUME 76 OF PLATS, PAGE(S) 96 INCLUSIVE, RECORDS OF KING COUNTY, WASHINGTON.  
COUNTY OF KING, STATE OF WASHINGTON

| PARCEL ID | TAX PIN    | OWNER NAME                   | SITE ADDRESS                   | SEGMENT |
|-----------|------------|------------------------------|--------------------------------|---------|
| 44-24     | 0626059037 | LANDA<br>JORGE F & SHIRLEY M | 19419 BOTHELL WY NE<br>BOTHELL | BOTHELL |

**SEGMENT 44-24 LANDA - LEGAL DESCRIPTION:**

THE NORTH 335 FEET OF THE NORTHEAST QUARTER OF THE NORTHWEST QUARTER OF THE SOUTHEAST QUARTER OF SECTION 6, TOWNSHIP 26 NORTH, RANGE 5 EAST, W.M., IN KING COUNTY, WASHINGTON.

EXCEPT THAT PORTION LYING NORTHERLY OF THE SOUTHERLY LINE OF EVERGREEN WAY NORTHEAST.

TOGETHER WITH THAT PORTION DESCRIBED AS FOLLOWS:

COMMENCING AT A POINT ON THE NORTH BOUNDARY LINE OF THE NORTHWEST QUARTER OF THE SOUTHEAST QUARTER OF SECTION 6, TOWNSHIP 26 NORTH, RANGE 5 EAST, W.M., IN KING COUNTY, WASHINGTON AT ITS INTERSECTION WITH THE SOUTHWESTERLY BOUNDARY OF PAVED HIGHWAY, THE SAME BEING 225 FEET, MORE OR LESS, WEST OF THE NORTHEAST CORNER OF SAID NORTHWEST QUARTER OF THE SOUTHEAST QUARTER;

THENCE WEST ALONG SAID BOUNDARY LINE, 71.5 FEET;

THENCE NORTH 25.5 FEET, MORE OR LESS, TO THE SOUTHWESTERLY MARGIN OF PAVED HIGHWAY;

THENCE SOUTHEASTERLY ALONG THE SOUTHWESTERLY MARGIN OF PAVED HIGHWAY TO THE POINT OF BEGINNING.

COUNTY OF KING, STATE OF WASHINGTON



**Attachment A**  
**Subsurface Utility Easement Parcels**

| PARCEL ID | TAX PIN    | OWNER NAME      | SITE ADDRESS                  | SEGMENT |
|-----------|------------|-----------------|-------------------------------|---------|
| 44-25     | 0626059197 | MONAHAN JAMES T | 19331 100TH AVE NE<br>BOTHELL | BOTHELL |

**SEGMENT 44-25 MONAHAN - LEGAL DESCRIPTION:**

PARCEL A

THE NORTH HALF OF THE NORTHEAST QUARTER OF THE NORTHEAST QUARTER OF THE SOUTHEAST QUARTER OF SECTION 6, TOWNSHIP 26 NORTH, RANGE 5 EAST, WILLAMETTE MERIDIAN, IN KING COUNTY, WASHINGTON;

EXCEPT THE WEST 300 FEET OF THE EAST 330 FEET OF THE NORTH 160 FEET THEREOF; AND EXCEPT THE WEST 175 FEET OF THE EAST 205 FEET OF THE SOUTH 155 FEET THEREOF; AND EXCEPT THE EAST 30 FEET THEREOF;

PARCEL A-1:

A NON-EXCLUSIVE EASEMENT FOR INGRESS AND EGRESS OVER, ACROSS AND UNDER A 30 FOOT STRIP, THE CENTERLINE OF WHICH COMMENCES AT A POINT SOUTH 1° 00' 32" WEST 174.93 FEET FROM THE NORTHEAST CORNER OF THE NORTH HALF OF THE NORTHEAST QUARTER OF THE NORTHEAST QUARTER OF THE SOUTHEAST QUARTER OF SAID SECTION 6;  
 THENCE NORTH 88° 00' 16" WEST 30 FEET TO THE POINT OF BEGINNING;  
 THENCE CONTINUING NORTH 88° 00' 16" WEST 250 FEET.

PARCEL B

THE NORTH 120 FEET OF THE SOUTH HALF OF THE NORTHEAST QUARTER OF THE NORTHEAST QUARTER OF THE SOUTHEAST QUARTER OF SECTION 6, TOWNSHIP 26 NORTH, RANGE 5 EAST, WILLAMETTE MERIDIAN, IN KING COUNTY, WASHINGTON;

EXCEPT THE EAST 323 FEET THEREOF;

PARCEL B-1:

AN EASEMENT FOR INGRESS AND EGRESS OVER THE SOUTH 30 FEET OF THE WEST 183 FEET OF THE EAST 223 FEET AND THE SOUTH 20 FEET OF THE EAST 140 FEET OF SAID NORTH 120 FEET OR THE SOUTH HALF OF THE NORTHEAST QUARTER OF THE NORTHEAST QUARTER OF THE SOUTHEAST QUARTER OF SECTION 6, TOWNSHIP 26 NORTH, RANGE 5 EAST, WILLAMETTE MERIDIAN, IN KING COUNTY, WASHINGTON;  
 EXCEPT THAT PORTION THEREOF LYING WITHIN 100TH AVENUE N.E.  
 COUNTY OF KING, STATE OF WASHINGTON

| PARCEL ID | TAX PIN    | OWNER NAME                     | SITE ADDRESS                 | SEGMENT |
|-----------|------------|--------------------------------|------------------------------|---------|
| 44-26     | 0626059208 | PRICER<br>LEWIS L & VIRGINIA E | 19337 100TH AV NE<br>BOTHELL | BOTHELL |

**SEGMENT 44-26 PRICER - LEGAL DESCRIPTION:**

PARCEL A

THE WEST 100 FEET OF THE EAST 330 FEET OF THE NORTH 160 FEET OF THE NORTH HALF OF THE NORTHEAST QUARTER OF THE NORTHEAST QUARTER OF THE SOUTHEAST QUARTER OF SECTION 6, TOWNSHIP 26 NORTH, RANGE 5 EAST, W.M., IN KING COUNTY, WASHINGTON.

PARCEL B

AN EASEMENT FOR INGRESS AND EGRESS OVER, ACROSS AND UNDER A 30 FOOT STRIP, THE CENTER LINE OF WHICH COMMENCES AT A POINT SOUTH 1°00'32" WEST 174.93 FEET FROM THE NORTHEAST CORNER OF THE NORTH HALF OF THE NORTHEAST QUARTER OF THE NORTHEAST QUARTER OF THE SOUTHEAST QUARTER OF SAID SECTION;  
 THENCE NORTH 88°00'16" WEST 20 FEET TO THE POINT OF BEGINNING;  
 THENCE CONTINUING NORTH 88°00'16" WEST 260 FEET.  
 COUNTY OF KING, STATE OF WASHINGTON

**Attachment A**  
**Subsurface Utility Easement Parcels**

15040

| PARCEL ID | TAX PIN    | OWNER NAME               | SITE ADDRESS                 | SEGMENT |
|-----------|------------|--------------------------|------------------------------|---------|
| 44-27     | 0626059289 | DOUD<br>ROBERT D & APRIL | 19513 100TH AV NE<br>BOTHELL | BOTHELL |

**SEGMENT 44-27 DOUD - LEGAL DESCRIPTION:**

**PARCEL A**

THE WEST HALF, THE EAST LINE OF WHICH IS PARALLEL WITH THE WEST LINE OF THE FOLLOWING DESCRIBED TRACT:

THAT PORTION OF THE SOUTH HALF OF THE SOUTHEAST QUARTER OF THE SOUTHEAST QUARTER OF THE NORTHEAST QUARTER OF SECTION 6, TOWNSHIP 26 NORTH, RANGE 5 EAST, W.M., IN KING COUNTY, WASHINGTON, DESCRIBED AS FOLLOWS:

BEGINNING ON THE EAST LINE OF SAID SUBDIVISION AT A POINT 120 FEET SOUTH OF THE NORTHEAST CORNER THEREOF;

THENCE WESTERLY ON A LINE PARALLEL WITH AND 120 FEET TO THE TRUE POINT OF BEGINNING;

THENCE SOUTHEASTERLY ALONG A LINE WHICH WOULD INTERSECT THE SOUTHERLY LINE OF SAID SUBDIVISION AT A POINT 100 FEET WESTERLY OF THE SOUTHEAST CORNER THEREOF, TO THE NORTHERLY LINE OF THE SOUTHERLY 200 FEET OF SAID SUBDIVISION;

THENCE WESTERLY ALONG SAID NORTHERLY LINE TO THE EAST LINE OF THE WEST 3 ACRES OF SAID SUBDIVISION;

THENCE NORTH ALONG SAID LINE TO A POINT 120 FEET SOUTH OF THE NORTH LINE OF SAID SUBDIVISION;

THENCE EASTERLY ON A LINE PARALLEL WITH AND 120 FEET SOUTH OF THEN NORTH LINE OF SAID SUBDIVISION, 136 FEET, MORE OR LESS, TO THE TRUE POINT OF BEGINNING.

**PARCEL B**

A NON-EXCLUSIVE EASEMENT FOR INGRESS AND EGRESS AND UTILITIES OVER THE SOUTH 20.00 FEET OF THAT PORTION OF THE SOUTH HALF OF THE SOUTHEAST QUARTER OF THE SOUTHEAST QUARTER OF THE NORTHEAST QUARTER OF SECTION 6, TOWNSHIP 26 NORTH, RANGE 5 EAST, W.M., IN KING COUNTY, WASHINGTON, LYING EAST OF THE EAST LINE OF THE WEST 3.00 ACRES OF SAID SUBDIVISION;

EXCEPT THE EAST 20.00 FEET THEREOF CONVEYED TO KING COUNTY FOR ROAD BY DEED

RECORDED UNDER RECORDING NO. 850582.

COUNTY OF KING, STATE OF WASHINGTON

| PARCEL ID | TAX PIN    | OWNER NAME                         | SITE ADDRESS                 | SEGMENT |
|-----------|------------|------------------------------------|------------------------------|---------|
| 44-28     | 0626059128 | VEILLEUX MELISSA &<br>KISER GERALD | 19415 100TH AV NE<br>BOTHELL | BOTHELL |

**SEGMENT 44-28 VEILLEUX/KISER - LEGAL DESCRIPTION:**

THE EAST 230 FEET OF THE NORTH 100 FEET OF THE NORTH HALF OF THE NORTHEAST QUARTER OF THE NORTHEAST QUARTER OF THE SOUTHEAST QUARTER OF SECTION 6, TOWNSHIP 26 NORTH, RANGE 5 EAST, W.M., IN KING COUNTY, WASHINGTON.

EXCEPT COUNTY ROAD.

COUNTY OF KING, STATE OF WASHINGTON

| PARCEL ID | TAX PIN    | OWNER NAME  | SITE ADDRESS       | SEGMENT |
|-----------|------------|---|--------------------|---------|
| 44-30     | 0526059080 | FIRST BAPTIST<br>CHURCH OF BOTHELL,<br>WASHINGTON, INC. | 19507 104TH AVE NE | BOTHELL |

**SEGMENT 44-30 FIRST BAPTIST CHURCH - LEGAL DESCRIPTION:**

THE SOUTH HALF OF THE SOUTHEAST QUARTER OF THE SOUTHWEST QUARTER OF THE NORTHWEST QUARTER OF SECTION 5, TOWNSHIP 26 NORTH, RANGE 5 EAST, W.M., IN KING COUNTY, WASHINGTON.

EXCEPT THE EAST 30 FEET THEREOF.

EXCEPT COUNTY ROAD.

COUNTY OF KING, STATE OF WASHINGTON

**Attachment A**  
**Subsurface Utility Easement Parcels**

**15040**

| PARCEL ID | TAX PIN    | OWNER NAME     | SITE ADDRESS                  | SEGMENT |
|-----------|------------|----------------|-------------------------------|---------|
| 44-31     | 0526059162 | BLUE CEDAR LLC | 19207 104TH AVE NE<br>BOTHELL | BOTHELL |

**SEGMENT 44-31 BLUE CEDAR LLC - LEGAL DESCRIPTION:**

PARCEL 1 OF CITY OF BOTHELL BOUNDARY LINE ADJUSTMENT NO. 2004-00001 AS RECORDED APRIL 15, 2004 UNDER RECORDING NO. 20040415900008, RECORDS OF KING COUNTY, WASHINGTON.  
COUNTY OF KING, STATE OF WASHINGTON

| PARCEL ID | TAX PIN    | OWNER NAME  | SITE ADDRESS                 | SEGMENT |
|-----------|------------|-------------|------------------------------|---------|
| 44-33     | 0526059048 | BEAN JACK S | 19509 112TH AV NE<br>BOTHELL | BOTHELL |

**SEGMENT 44-33 BEAN - LEGAL DESCRIPTION:**

A PORTION OF THE SOUTHWEST QUARTER OF THE NORTHEAST QUARTER AND OF THE NORTHWEST QUARTER OF THE SOUTHEAST QUARTER OF SECTION 5, TOWNSHIP 26 NORTH, RANGE 5 EAST, W.M., IN KING COUNTY, WASHINGTON, DESCRIBED AS FOLLOWS:  
COMMENCING AT THE NORTHEAST CORNER OF THE SOUTH HALF OF THE SOUTHWEST QUARTER OF THE NORTHEAST QUARTER OF SAID SECTION 5;  
THENCE SOUTH 89°21'07" WEST 1305.88 FEET;  
THENCE SOUTH 1°27'07" EAST 512.62 FEET TO THE TRUE POINT OF BEGINNING OF THE TRACT HEREIN DESCRIBED, SAID POINT BEING ON THE WESTERLY BOUNDARY LINE OF THAT TRACT OF LAND IN THE EAST HALF OF SAID SECTION 5 HERETOFORE CONVEYED BY ANNA L. JOHNSON, A WIDOW, TO HAROLD H. DAHLQUIST BY INSTRUMENT RECORDED UNDER RECORDING NO. 2085069, AND DISTANT 512.62 FEET SOUTHERLY FROM THE NORTHWEST CORNER OF SAID TRACT CONVEYED BY JOHNSON TO DAHLQUIST;  
THENCE SOUTH 1°27'07" EAST 171.04 FEET;  
THENCE NORTH 89°21'07" EAST 1273.17 FEET, MORE OR LESS, TO THE WESTERLY MARGIN OF COUNTY ROAD;  
THENCE NORTH 1°12'47" WEST ALONG THE WESTERLY MARGIN OF SAID COUNTY ROAD, 171.04 FEET;  
THENCE SOUTH 89°21'07" WEST 1273.75 FEET, MORE OR LESS, TO THE TRUE POINT OF BEGINNING;  
EXCEPT ROADS.  
COUNTY OF KING, STATE OF WASHINGTON

| PARCEL ID | TAX PIN    | OWNER NAME                    | SITE ADDRESS | SEGMENT |
|-----------|------------|-------------------------------|--------------|---------|
| 44-34     | 3927000330 | S/I NORTH CREEK II,<br>L.L.C. |              | BOTHELL |

**SEGMENT 44-34 S/I NORTH CREEK - LEGAL DESCRIPTION:**

TRACT C, KOLL CENTER NORTH CREEK, ACCORDING TO THE PLAT THEREOF RECORDED IN VOLUME 132 OF PLATS, PAGES 29 THROUGH 35, INCLUSIVE, RECORDS OF KING COUNTY, WASHINGTON.  
COUNTY OF KING, STATE OF WASHINGTON

| PARCEL ID | TAX PIN    | OWNER NAME  | SITE ADDRESS                     | SEGMENT |
|-----------|------------|---|----------------------------------|---------|
| 44-35     | 3927000010 | CORPORATION OF THE<br>PRESIDING BISHOP OF THE<br>CHURCH OF JESUS CHRIST<br>OF LATTER-DAY SAINTS | 19500 NORTH CREEK PKY<br>BOTHELL | BOTHELL |

**SEGMENT 44-35 CORP OF PRES BP - LEGAL DESCRIPTION:**

LOT 1 OF CITY OF BOTHELL LOT LINE ADJUSTMENT NO. SPL0019-92 AS RECORDED MARCH 17, 1993 AND MAY 7, 1993 UNDER RECORDING NOS. 9303170862 AND 9305079006, RESPECTIVELY, RECORDS OF KING COUNTY, WASHINGTON.  
COUNTY OF KING, STATE OF WASHINGTON

**Attachment A  
Subsurface Utility Easement Parcels**

**15040**

| PARCEL ID | TAX PIN    | OWNER NAME                    | SITE ADDRESS                     | SEGMENT |
|-----------|------------|-------------------------------|----------------------------------|---------|
| 44-36     | 3927000340 | S/I NORTH CREEK II,<br>L.L.C. | 19600 NORTH CREEK PKY<br>BOTHELL | BOTHELL |

**SEGMENT 44-36 S/I NORTH CREEK - LEGAL DESCRIPTION:**

TRACT D, KOLL CENTER NORTH CREEK, ACCORDING TO THE PLAT THEREOF RECORDED IN VOLUME 132 OF PLATS, PAGES 29 THROUGH 35, INCLUSIVE, RECORDS OF KING COUNTY, WASHINGTON.  
COUNTY OF KING, STATE OF WASHINGTON

| PARCEL ID | TAX PIN    | OWNER NAME            | SITE ADDRESS                 | SEGMENT |
|-----------|------------|-----------------------|------------------------------|---------|
| 44-37     | 6137850020 | STEJUN INVESTMENT INC | 11611 NE 195TH ST<br>BOTHELL | BOTHELL |

**SEGMENT 44-37 STEJUN INVESTMENTS - LEGAL DESCRIPTION:**

LOT 2 OF NORTH CREEK RETAIL, A BINDING SITE PLAN, ACCORDING TO THE PLAT THEREOF RECORDED IN VOLUME 180 OF PLATS, PAGES 87 AND 88, IN KING COUNTY, WASHINGTON.  
COUNTY OF KING, STATE OF WASHINGTON

| PARCEL ID | TAX PIN    | OWNER NAME                | SITE ADDRESS | SEGMENT |
|-----------|------------|---------------------------|--------------|---------|
| 44-38     | 8030008888 | STONEBROOK<br>CONDOMINIUM |              | BOTHELL |

**SEGMENT 44-38 STONEBROOK - LEGAL DESCRIPTION**

THE COMMON ELEMENTS OF STONEBROOK CONDOMINIUM, ACCORDING TO DECLARATION THEREOF RECORDED UNDER KING COUNTY RECORDING NO. 9111262316, AND ANY AMENDMENT(S) THERETO; AS SHOWN ON SURVEY MAP AND PLANS, RECORDED IN VOLUME 107 OF CONDOMINIUMS, AT PAGES 71 THROUGH 76, IN KING COUNTY, WASHINGTON.  
COUNTY OF KING, STATE OF WASHINGTON

| PARCEL ID | TAX PIN   | OWNER NAME     | SITE ADDRESS | SEGMENT |
|-----------|-----------|----------------|--------------|---------|
| 44-39     | 626059005 | STACK DENIS M. |              | BOTHELL |

**SEGMENT 44-39 STACK - LEGAL DESCRIPTION**

THAT PORTION OF THE SOUTH 300 FEET OF THE EAST 235 FEET OF THE SOUTHWEST QUARTER OF THE NORTHEAST QUARTER, LYING NORTHERLY OF THE HIGHWAY, EXCEPT THE EAST 30 FEET, AND THAT PORTION OF THE NORTHWEST QUARTER OF THE SOUTHEAST QUARTER LYING NORTHERLY OF SAID HIGHWAY, EXCEPT THE EAST 30 FEET. ALL IN SECTION 6, TOWNSHIP 26 NORTH, RANGE 5 EAST, W.M., IN KING COUNTY, WASHINGTON.  
COUNTY OF KING, STATE OF WASHINGTON.

**Attachment A**  
**Subsurface Utility Easement Parcels**

**15040**

**Combined Pipeline Segment – (Portal 41 to BW Treatment Plant)**  
**Subsurface Utility Easements**

| PARCEL ID | TAX PIN    | OWNER NAME   | SITE ADDRESS | SEGMENT              |
|-----------|------------|--|--------------|----------------------|
| 41-5      | 0426059009 | RET DEFINED FIXED<br>BENEFIT PENSION<br>PLAN & TRUST |              | COMBINED<br>PIPELINE |

**SEGMENT 41-5 RET DEFINED - LEGAL DESCRIPTION:**

THAT PORTION OF THE NORTHEAST QUARTER OF THE SOUTHWEST QUARTER OF SECTION 4,  
TOWNSHIP 26 NORTH, RANGE 5 EAST, W.M., IN KING COUNTY, WASHINGTON, LYING EASTERLY OF A  
LINE DESCRIBED AS FOLLOWS:  
COMMENCING AT A POINT ON THE NORTH LINE OF SAID SUBDIVISION WHICH IS NORTH 89°57' WEST  
669.5 FEET FROM THE NORTHEAST CORNER THEREOF;  
THENCE SOUTH 1°02'20" EAST 658.98 FEET;  
THENCE SOUTH 28°41'20" EAST 748.82 FEET, MORE OR LESS, TO THE SOUTH LINE OF SAID  
SUBDIVISION;  
EXCEPT THE NORTH 20 FEET THEREOF;  
EXCEPT THAT PORTION CONVEYED TO THE CITY OF BOTHELL FOR PUMP STATION SITE UNDER  
RECORDING NO. 8509240568;  
AND EXCEPT THOSE PORTIONS CONVEYED FOR NORTHEAST HOLLYHILLS DRIVE BY RECORDING  
NOS. 8312020668 AND 9006011151.  
COUNTY OF KING, STATE OF WASHINGTON

| PARCEL ID | TAX PIN    | OWNER NAME   | SITE ADDRESS | SEGMENT              |
|-----------|------------|--|--------------|----------------------|
| 41-7      | 0426059014 | RET DEFINED FIXED<br>BENEFIT PENSION<br>PLAN & TRUST |              | COMBINED<br>PIPELINE |

**SEGMENT 41-7 RET DEFINED - LEGAL DESCRIPTION:**

THAT PORTION OF THE NORTHWEST QUARTER OF THE SOUTHEAST QUARTER OF SECTION 4,  
TOWNSHIP 26 NORTH, RANGE 5 EAST, W.M., IN KING COUNTY, WASHINGTON, LYING WEST OF THE  
WESTERLY BOUNDARIES OF HOLLYHILLS DIVISIONS 2, 3, 4 AND 5, ACCORDING TO THE PLAT  
THEREOF.  
EXCEPT THAT PORTION OF THE FOLLOWING DESCRIBED TRACT WITHIN SAID NORTHWEST  
QUARTER OF THE SOUTHEAST QUARTER:  
COMMENCING AT THE WEST QUARTER CORNER OF SAID SECTION 4;  
THENCE SOUTH 88°05'15" EAST ALONG THE EAST-WEST CENTERLINE OF SAID SECTION, 2,021.14  
FEET TO THE TRUE POINT OF BEGINNING;  
THENCE CONTINUING SOUTH 88°05'15" EAST ALONG SAID CENTERLINE, 1,063.82 FEET TO THE  
WESTERLY MARGIN OF THE PUGET SOUND POWER AND LIGHT COMPANY EASEMENT;  
THENCE SOUTH 8°23'42" WEST 201.28 FEET ALONG SAID WESTERLY MARGIN TO AN INTERSECTION  
WITH A LINE 200 FEET SOUTH OF AND PARALLEL TO SAID CENTERLINE OF SAID SECTION;  
THENCE NORTH 88°05'15" WEST ALONG SAID PARALLEL LINE 852.46 FEET;  
THENCE NORTH 1°54'45" EAST 20 FEET TO THE TRUE POINT OF BEGINNING.  
AND EXCEPT THOSE PORTIONS CONVEYED FOR NORTHEAST HOLLYHILLS DRIVE BY RECORDING  
NOS. 8312020668 AND 9006011151.  
COUNTY OF KING, STATE OF WASHINGTON

**Attachment A  
Subsurface Utility Easement Parcels**

**15040**

| PARCEL ID | TAX PIN    | OWNER NAME                   | SITE ADDRESS                  | SEGMENT              |
|-----------|------------|------------------------------|-------------------------------|----------------------|
| 41-8      | 3395430410 | FRASER<br>ROBERT T & DONNA D | 19405 127TH AVE NE<br>BOTHELL | COMBINED<br>PIPELINE |

**SEGMENT 41-8 FRASER - LEGAL DESCRIPTION:**

LOT 41, HOLLYHILLS DIVISION FOUR, ACCORDING TO THE PLAT THEREOF RECORDED IN VOLUME 102 OF PLATS, PAGES 41 AND 42, RECORDS OF KING COUNTY, WASHINGTON.  
COUNTY OF KING, STATE OF WASHINGTON

| PARCEL ID | TAX PIN    | OWNER NAME                        | SITE ADDRESS                  | SEGMENT              |
|-----------|------------|-----------------------------------|-------------------------------|----------------------|
| 41-9      | 3395430420 | DILLENBECK<br>RANDY A & SHIRLEY D | 19407 127TH AVE NE<br>BOTHELL | COMBINED<br>PIPELINE |

**SEGMENT 41-9 DILLENBECK - LEGAL DESCRIPTION:**

LOT 42, HOLLYHILLS DIVISION FOUR, ACCORDING TO THE PLAT THEREOF RECORDED IN VOLUME 102 OF PLATS, PAGES 41 AND 42, IN KING COUNTY, WASHINGTON.  
COUNTY OF KING, STATE OF WASHINGTON

| PARCEL ID | TAX PIN    | OWNER NAME         | SITE ADDRESS                  | SEGMENT              |
|-----------|------------|--------------------|-------------------------------|----------------------|
| 41-10     | 3395430430 | PICKRELL CHARLEENE | 19408 127TH AVE NE<br>BOTHELL | COMBINED<br>PIPELINE |

**SEGMENT 41-10 PICKRELL - LEGAL DESCRIPTION:**

LOT 43, HOLLYHILLS DIVISION FOUR, ACCORDING TO THE PLAT THEREOF RECORDED IN VOLUME 102 OF PLATS, PAGES 41 AND 42, IN KING COUNTY, WASHINGTON.  
COUNTY OF KING, STATE OF WASHINGTON

| PARCEL ID | TAX PIN    | OWNER NAME                | SITE ADDRESS                  | SEGMENT              |
|-----------|------------|---------------------------|-------------------------------|----------------------|
| 41-11     | 3395430440 | THOMPSON-BIRDSALL<br>ANNE | 19404 127TH AVE NE<br>BOTHELL | COMBINED<br>PIPELINE |

**SEGMENT 41-11 THOMPSON-BIRDSALL - LEGAL DESCRIPTION:**

LOTS 44 AND 45, HOLLYHILLS DIVISION 4, ACCORDING TO THE PLAT THEREOF RECORDED IN VOLUME 102 OF PLATS, PAGES 41 AND 42 IN KING COUNTY, WASHINGTON.  
COUNTY OF KING, STATE OF WASHINGTON

| PARCEL ID | TAX PIN    | OWNER NAME      | SITE ADDRESS                      | SEGMENT              |
|-----------|------------|-----------------|-----------------------------------|----------------------|
| 41-12     | 3395430550 | HAIGHT VERONA O | 19527 HOLLYHILLS DR NE<br>BOTHELL | COMBINED<br>PIPELINE |

**SEGMENT 41-12 HAIGHT - LEGAL DESCRIPTION:**

LOT 55, HOLLYHILLS DIVISION FOUR, ACCORDING TO THE PLAT THEREOF, RECORDED IN VOLUME 102 OF PLATS, PAGES 41 AND 42, RECORDS OF KING COUNTY, WASHINGTON.  
COUNTY OF KING, STATE OF WASHINGTON

15040

**Attachment A  
Subsurface Utility Easement Parcels**

| PARCEL ID | TAX PIN    | OWNER NAME                     | SITE ADDRESS                      | SEGMENT              |
|-----------|------------|--------------------------------|-----------------------------------|----------------------|
| 41-13     | 3395430540 | MANGUM<br>MICHAEL A & ALYSON N | 19503 HOLLYHILLS DR NE<br>BOTHELL | COMBINED<br>PIPELINE |

**SEGMENT 41-13 MANGUM - LEGAL DESCRIPTION:**

LOT 54, HOLLYHILLS, DIVISION NO. 4, ACCORDING TO THE PLAT THEREOF RECORDED IN VOLUME 102 OF PLATS, PAGES 41 AND 42, RECORDS OF KING COUNTY, WASHINGTON.  
COUNTY OF KING, STATE OF WASHINGTON

| PARCEL ID | TAX PIN    | OWNER NAME       | SITE ADDRESS                      | SEGMENT              |
|-----------|------------|------------------|-----------------------------------|----------------------|
| 41-14     | 3395430530 | SACCO ANNELIES J | 19501 HOLLYHILLS DR NE<br>BOTHELL | COMBINED<br>PIPELINE |

**SEGMENT 41-14 SACCO - LEGAL DESCRIPTION:**

LOT 53, HOLLY HILLS DIVISION 4, ACCORDING TO THE PLAT THEREOF RECORDED IN VOLUME 102 OF PLATS, PAGES 41 AND 42, IN KING COUNTY, WASHINGTON.  
EXCEPT THEREFROM LOT 53 THAT PORTION LYING SOUTHEASTERLY OF A LINE WHICH BEGINS AT A POINT ON THE SOUTHWESTERLY LINE OF SAID LOT, WHICH IS NORTH 41 DEGREES 40 MINUTES, 22 SECONDS, WEST 15 FEET FROM THE MOST SOUTHERLY CORNER OF SAID LOT AND RUNS NORTH 58 DEGREES 30 MINUTES, 02 SECONDS, EAST 84.93 FEET TO THE MOST EASTERLY CORNER OF SAID LOT;  
(ALSO BEING KNOWN AS PARCEL C ON CITY OF BOTHELL SHORT PLAT LOT LINE ADJUSTMENT D-85-2, RECORDED JUNE 5, 1986, UNDER RECORDING NO. 8606050265.)  
COUNTY OF KING, STATE OF WASHINGTON

| PARCEL ID | TAX PIN    | OWNER NAME          | SITE ADDRESS                      | SEGMENT              |
|-----------|------------|---------------------|-----------------------------------|----------------------|
| 41-15     | 3395430780 | WILDER<br>BONNIE M. | 19502 HOLLYHILLS DR NE<br>BOTHELL | COMBINED<br>PIPELINE |

**SEGMENT 41-15 WILDER - LEGAL DESCRIPTION:**

LOT 78 AND THAT PORTION OF LOT 77 OF HOLLYHILLS DIVISION 4, AS PER PLAT RECORDED IN VOLUME 102 OF PLATS, PAGES 41 AND 42, RECORDS OF KING COUNTY, WASHINGTON, DESCRIBED AS FOLLOWS:  
BEGINNING AT A POINT ON THE NORTHEASTERLY LINE OF SAID LOT 77, NORTH 26°0' 18" WEST 2 FEET FROM THE MOST EASTERLY CORNER OF SAID LOT 77;  
THENCE SOUTHWESTERLY TO A POINT ON THE SOUTHWESTERLY LINE OF SAID LOT;  
THENCE NORTH 41°40'22" WEST 3 FEET FROM THE MOST SOUTHERLY CORNER OF SAID LOT AND THE TERMINUS OF SAID LINE.  
COUNTY OF KING, STATE OF WASHINGTON

| PARCEL ID | TAX PIN    | OWNER NAME           | SITE ADDRESS                  | SEGMENT              |
|-----------|------------|----------------------|-------------------------------|----------------------|
| 41-16     | 3395430790 | CHEIRRETT MARGARET G | 12724 NE 195TH WAY<br>BOTHELL | COMBINED<br>PIPELINE |

**SEGMENT 41-16 CHEIRRETT - LEGAL DESCRIPTION:**

LOT 79, HOLLYHILLS DIVISION FOUR, AS PER PLAT RECORDED IN VOLUME 102 OF PLATS, PAGES 41 AND 42, RECORDS OF KING COUNTY, WASHINGTON.  
COUNTY OF KING, STATE OF WASHINGTON

**Attachment A  
Subsurface Utility Easement Parcels**

**15040**

| PARCEL ID | TAX PIN    | OWNER NAME                      | SITE ADDRESS                  | SEGMENT              |
|-----------|------------|---------------------------------|-------------------------------|----------------------|
| 41-17     | 3395430800 | NICHOLAS<br>RICHARD S & WENDI F | 12732 NE 195TH WAY<br>BOTHELL | COMBINED<br>PIPELINE |

**SEGMENT 41-17 NICHOLAS - LEGAL DESCRIPTION:**

LOT 80, HOLLYHILLS DIVISION FOUR, ACCORDING TO THE PLAT THEREOF RECORDED IN VOLUME 102 OF PLATS, PAGES 41 THROUGH 42, INCLUSIVE, RECORDS OF KING COUNTY, WASHINGTON.  
COUNTY OF KING, STATE OF WASHINGTON

| PARCEL ID | TAX PIN    | OWNER NAME         | SITE ADDRESS                  | SEGMENT              |
|-----------|------------|--------------------|-------------------------------|----------------------|
| 41-18     | 3395440080 | GORMLEY ROSEMARY C | 19501 129TH AVE NE<br>BOTHELL | COMBINED<br>PIPELINE |

**SEGMENT 41-18 GORMLEY - LEGAL DESCRIPTION:**

LOT 8, HOLLYHILLS DIVISION NO. 5, ACCORDING TO THE PLAT THEREOF, RECORDED IN VOLUME 113 OF PLATS, PAGES 58 AND 59, IN KING COUNTY, WASHINGTON.  
COUNTY OF KING, STATE OF WASHINGTON

| PARCEL ID | TAX PIN    | OWNER NAME                            | SITE ADDRESS | SEGMENT              |
|-----------|------------|---------------------------------------|--------------|----------------------|
| 41-22     | 3395467777 | HOLLYHILLS OWNERS<br>ASSOCIATION INC. |              | COMBINED<br>PIPELINE |

**SEGMENT 41-22 HOLLYHILLS - LEGAL DESCRIPTION:**

TRACT A OF HOLLYHILLS DIVISION SEVEN, ACCORDING TO PLAT RECORDED IN VOLUME 144 OF PLATS, PAGES 31 AND 32, RECORDS OF KING COUNTY, WASHINGTON.  
COUNTY OF KING, STATE OF WASHINGTON

| PARCEL ID | TAX PIN    | OWNER NAME                            | SITE ADDRESS | SEGMENT              |
|-----------|------------|---------------------------------------|--------------|----------------------|
| 41-23     | 3395437777 | HOLLYHILLS OWNERS<br>ASSOCIATION INC. |              | COMBINED<br>PIPELINE |

**SEGMENT 41-23 HOLLYHILLS - LEGAL DESCRIPTION:**

TRACT E OF HOLLYHILLS DIVISION FOUR, ACCORDING TO PLAT RECORDED IN VOLUME 102 OF PLATS, PAGES 41 AND 42, RECORDS OF KING COUNTY, WASHINGTON.  
COUNTY OF KING, STATE OF WASHINGTON



**Attachment A**  
**Subsurface Utility Easement Parcels**

15040

**North Creek Connector Utility Easements**

| PARCEL ID | TAX PIN    | OWNER NAME                               | SITE ADDRESS                  | SEGMENT                  |
|-----------|------------|--|-------------------------------|--------------------------|
| NCC-1     | 6979200320 | PHOENIX MUTUAL LIFE<br>INSURANCE COMPANY | 19204 N CREEK PKWY<br>BOTHELL | NORTH CREEK<br>CONNECTOR |

**SEGMENT NCC-1 PHOENIX MUTUAL - LEGAL DESCRIPTION:**

LOTS 32 AND 33, QUADRANT BUSINESS PARK-BOTHELL, ACCORDING TO THE PLAT RECORDED IN VOLUME 131 OF PLATS, PAGES 87 THROUGH 91, INCLUSIVE, IN KING COUNTY, WASHINGTON, COUNTY OF KING, STATE OF WASHINGTON

| PARCEL ID | TAX PIN    | OWNER NAME                    | SITE ADDRESS                  | SEGMENT                  |
|-----------|------------|-------------------------------|-------------------------------|--------------------------|
| NCC-2     | 6979200050 | ALLSTATE INSURANCE<br>COMPANY | 18911 N CREEK PKWY<br>BOTHELL | NORTH CREEK<br>CONNECTOR |

**SEGMENT NCC-2 ALLSTATE - LEGAL DESCRIPTION:**

LOTS 4 AND 5, QUADRANT BUSINESS PARK-BOTHELL, ACCORDING TO THE PLAT THEREOF RECORDED IN VOLUME 131 OF PLATS, PAGES 87 THROUGH 91, INCLUSIVE, RECORDS OF KING COUNTY, WASHINGTON.

TOGETHER WITH THAT PORTION OF LOTS 2 AND 3, QUADRANT BUSINESS PARK-BOTHELL, ACCORDING TO THE PLAT THEREOF RECORDED IN VOLUME 131 OF PLATS, PAGES 87 THROUGH 91, INCLUSIVE, RECORDS OF KING COUNTY, WASHINGTON, LYING SOUTHERLY OF A LINE DESCRIBED AS FOLLOWS:

BEGINNING AT A POINT ON THE WEST LINE OF SAID LOT 2 WHICH LIES NORTH 01°55'36" EAST 41.38 FEET FROM THE SOUTHWESTERLY CORNER OF SAID LOT 2;

THENCE SOUTH 82°06'00" EAST 694.26 FEET TO THE SOUTHWESTERLY MARGIN OF NORTH CREEK PARKWAY AND THE TERMINUS OF SAID LINE.

ALSO TOGETHER WITH THAT PORTION OF LOT 6, QUADRANT BUSINESS PARK-BOTHELL, ACCORDING TO THE PLAT THEREOF RECORDED IN VOLUME 131 OF PLATS, PAGES 87 THROUGH 91, INCLUSIVE, RECORDS OF KING COUNTY, WASHINGTON, LYING NORTHWESTERLY OF A LINE DESCRIBED AS FOLLOWS:

BEGINNING AT THE MOST SOUTHWESTERLY CORNER OF SAID LOT 6;

THENCE NORTHWESTERLY ALONG THE WEST LINE THEREOF 106.65 FEET TO THE TRUE POINT OF BEGINNING;

THENCE NORTH 64°09'48" EAST 88.05 FEET;

THENCE NORTH 19°24'58" EAST 70.71 FEET;

THENCE NORTH 27°36'10" EAST 86.06 FEET TO A POINT ON A CURVE TO THE RIGHT WITH A RADIUS OF 64.64 FEET THROUGH A CENTRAL ANGLE OF 36°56'11" FOR A DISTANCE OF 39.09 FEET;

THENCE NORTH 64°32'21" EAST 214.26 FEET;

THENCE NORTH 71°53'28" EAST 35.36 FEET TO A POINT ON THE WESTERLY MARGIN OF NORTH CREEK PARKWAY AND THE TERMINUS OF SAID LINE.

COUNTY OF KING, STATE OF WASHINGTON

| PARCEL ID | TAX PIN   | OWNER NAME                  | SITE ADDRESS                    | SEGMENT                  |
|-----------|-----------|-----------------------------|---------------------------------|--------------------------|
| NCC-3     | 697920080 | BOTHELL PROPERTIES,<br>INC. | 11715 N CREEK PKWY S<br>BOTHELL | NORTH CREEK<br>CONNECTOR |

**SEGMENT NCC-3 BOTHELL PROPERTIES - LEGAL DESCRIPTION:**

LOT 8 AND THE SOUTHEASTERLY 20 FEET OF LOT 7, QUADRANT BUSINESS PARK - BOTHELL, ACCORDING TO THE PLAT THEREOF RECORDED IN VOLUME 131 OF PLATS, PAGES 87 THROUGH 91, INCLUSIVE, RECORDS OF KING COUNTY, WASHINGTON, COUNTY OF KING, STATE OF WASHINGTON

**Attachment A**  
**Subsurface Utility Easement Parcels**

| PARCEL ID | TAX PIN    | OWNER NAME                | SITE ADDRESS                      | SEGMENT                  |
|-----------|------------|---------------------------|-----------------------------------|--------------------------|
| NCC-4     | 6979200040 | CURRAN PROPERTIES<br>L.P. | 19119 NORTH CREEK PKWY<br>BOTHELL | NORTH CREEK<br>CONNECTOR |

**SEGMENT NCC-4 CURRAN - LEGAL DESCRIPTION**

LOT 4, CITY OF BOTHELL LOT LINE ADJUSTMENT NO. D-88-67, RECORDED SEPTEMBER 12, 1988  
UNDER RECORDING NO. 8809120703, RECORDS OF KING COUNTY, WASHINGTON.  
COUNTY OF KING, STATE OF WASHINGTON

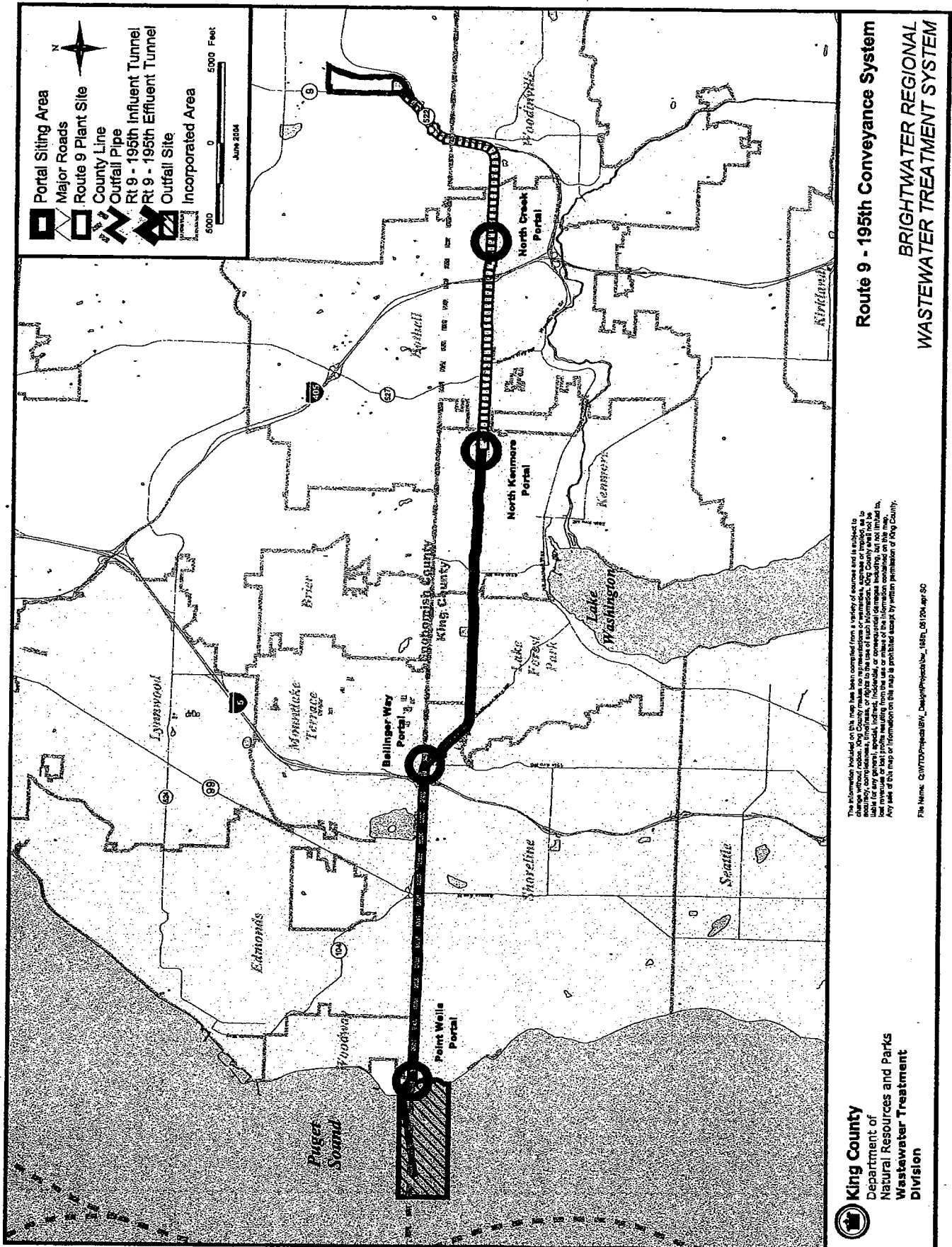



Map 1 of 2

**Easement Parcels within the City of Shoreline**  
**BRIGHTWATER REGIONAL**  
**WASTEWATER TREATMENT SYSTEM**

The information included on this map has been compiled from a variety of sources and is subject to change without notice. The information is provided for informational purposes only and is not intended to be used for any legal or financial purposes. The information is provided as is, without warranty, and the user assumes all responsibility for its use. The information is not intended to be used for any legal or financial purposes. The information is provided as is, without warranty, and the user assumes all responsibility for its use.

File Name: Q:\WTP\Projects\BW Design\Projects\Imported\_parcels.mxd 8C

**King County**  
 Department of  
 Natural Resources and Parks  
 Wastewater Treatment  
 Division

August 2004

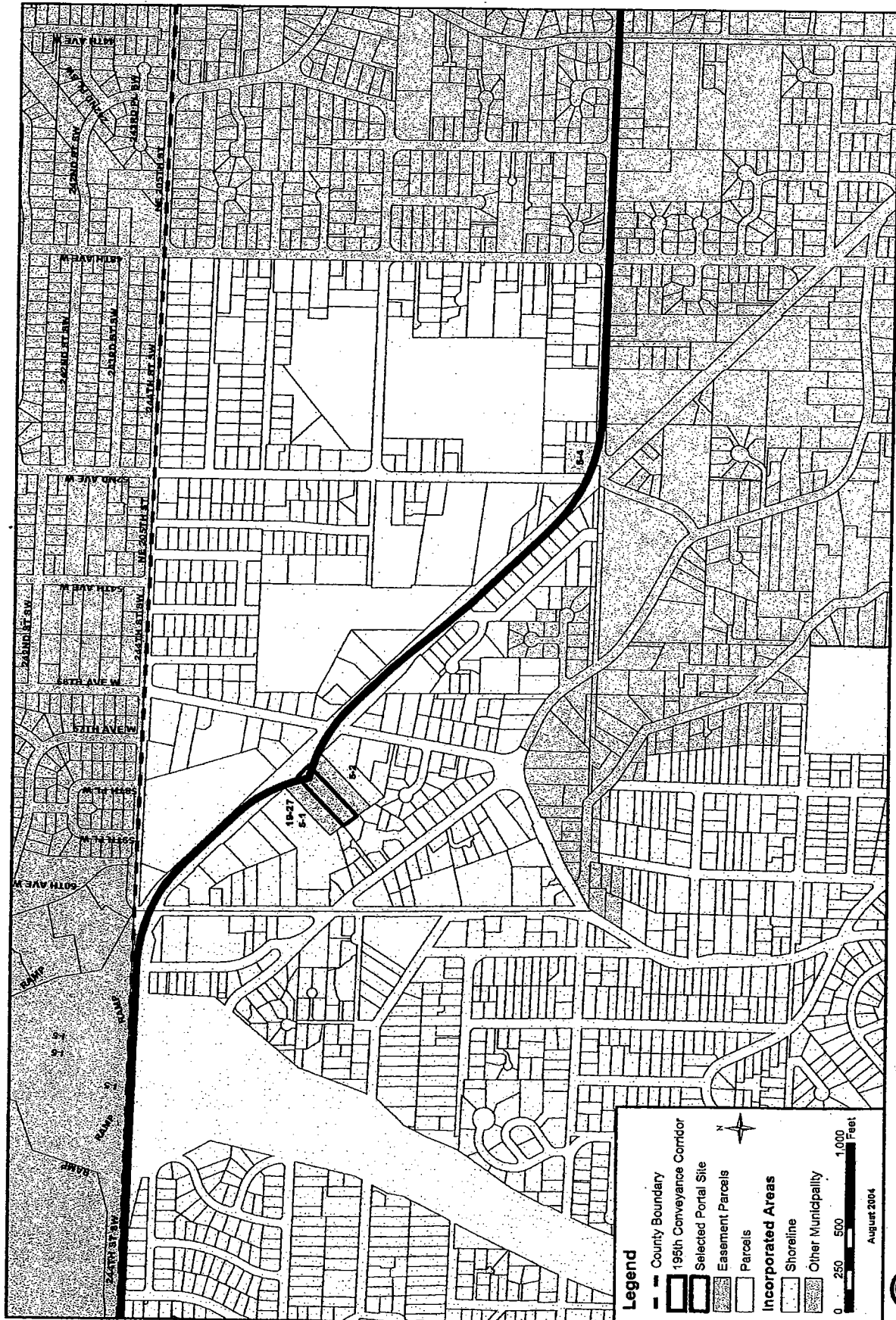

Map 2 of 2

# Easement Parcels within the City of Shoreline

BRIGHTWATER REGIONAL  
WASTEWATER TREATMENT SYSTEM

The information included on this map has been compiled from a variety of sources and is subject to change without notice. King County makes no representations or warranties, express or implied, as to the accuracy, completeness, or reliability of the information. King County shall not be liable for any damages, including reasonable attorneys' fees, arising from the use or misuse of the information. Any sale of this map or information on this map is prohibited except by written permission of King County.

File Name: C:\WTP\Projects\BRT\Design\Projects\Impacted\_Parcel.mxd 50

**King County**  
Department of  
Natural Resources and Parks  
Wastewater Treatment  
Division

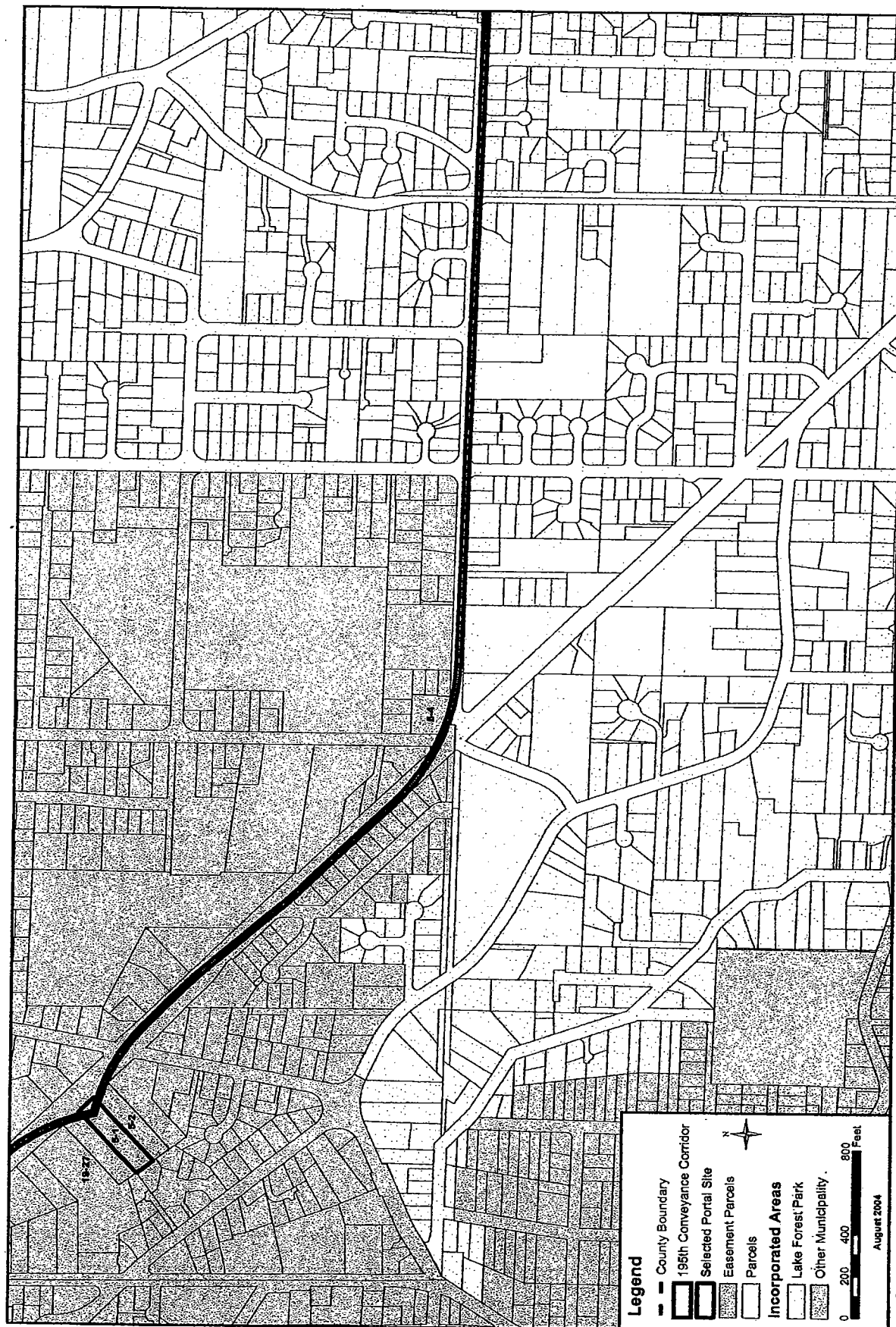

**Legend**

- County Boundary
- 195th Conveyance Corridor
- Selected Portal Site
- Easement Parcels
- Parcels
- Incorporated Areas
- Lake Forest Park
- Other Municipality



0 200 400 800 Feet

August 2004



**King County**  
 Department of  
 Natural Resources and Parks  
 Wastewater Treatment  
 Division

The information included on this map has been compiled from a variety of sources and is subject to change without notice. King County makes no representation or warranty, express or implied, as to accuracy, completeness, timeliness, or fitness for the use of such information. King County shall not be liable for any general, special, indirect, incidental, or consequential damages including, but not limited to, lost sales or profits, or any other damages, arising out of the use of the information contained on this map. Any sale of this map or information on this map is prohibited except by written permission of King County.

File Name: C:\WTP\proj\BWW\_Design\Project\Impacted\_parcels.mxd SC

Map 1 of 2

**Easement Parcels within  
 the City of Lake Forest Park  
 BRIGHTWATER REGIONAL  
 WASTEWATER TREATMENT SYSTEM**



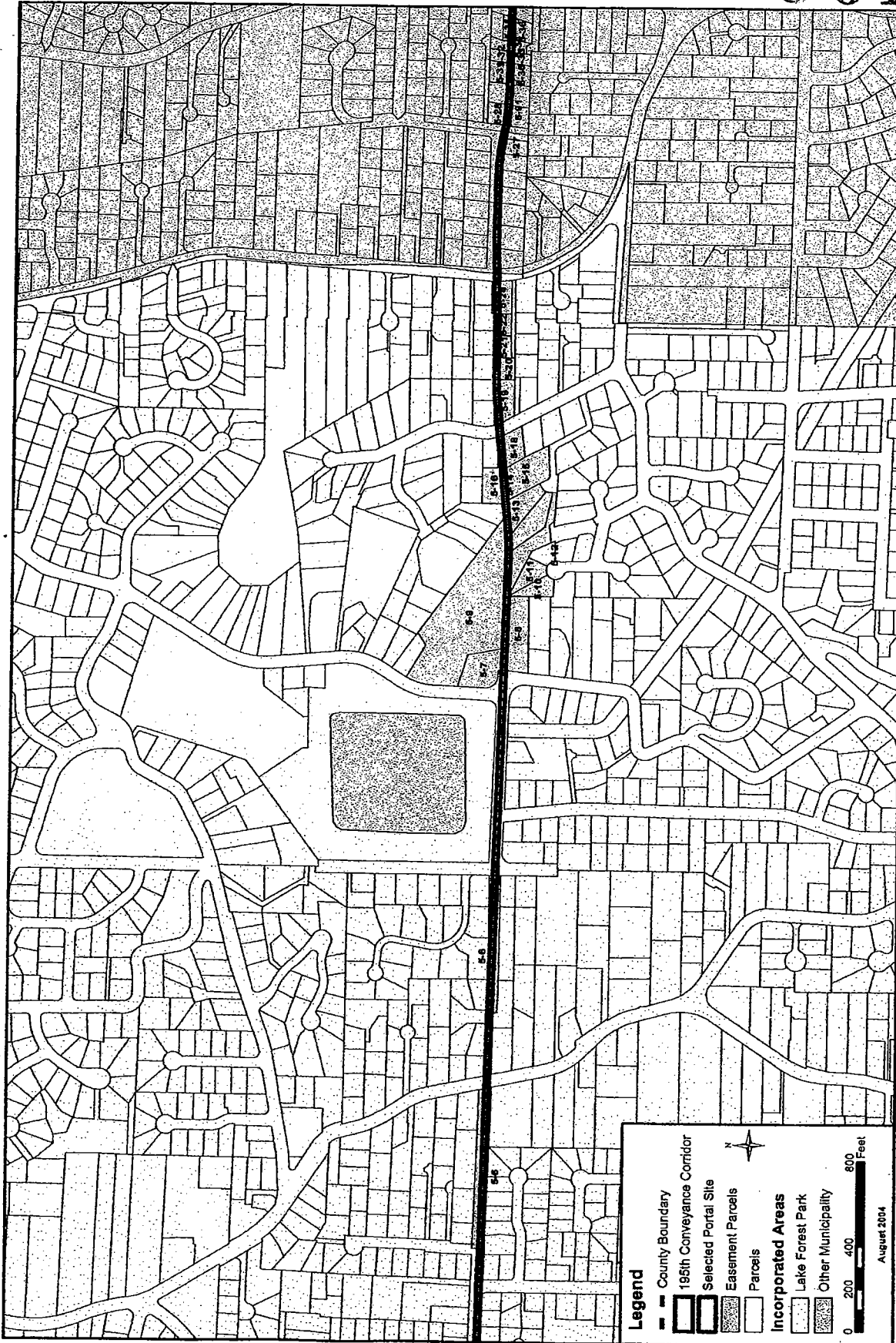

**Legend**

- County Boundary
- 195th Conveyance Corridor
- Selected Portal Site
- Easement Parcels
- Parcels
- Incorporated Areas
- Lake Forest Park
- Other Municipality

0 200 400 800 Feet

August 2004

**King County**  
 Department of  
 Natural Resources and Parks  
 Wastewater Treatment  
 Division

**Map 2 of 2**  
**Easement Parcels within**  
**the City of Lake Forest Park**  
**BRIGHTWATER TREATMENT SYSTEM**

The information included on this map has been compiled from a variety of sources and is subject to change without notice. King County makes no representations or warranties, express or implied, as to the accuracy, completeness, timeliness, or rights to the use of such information. King County shall not be liable for any damages, including but not limited to, direct, indirect, or consequential damages, arising from the use or reliance on this map. Any sale of this map or information on this map is prohibited except by written permission of King County.

File Name: Q:\WTD\Projects\BW\_Design\Projects\Impacted\_Parcel.mxd SC

## Exhibit A

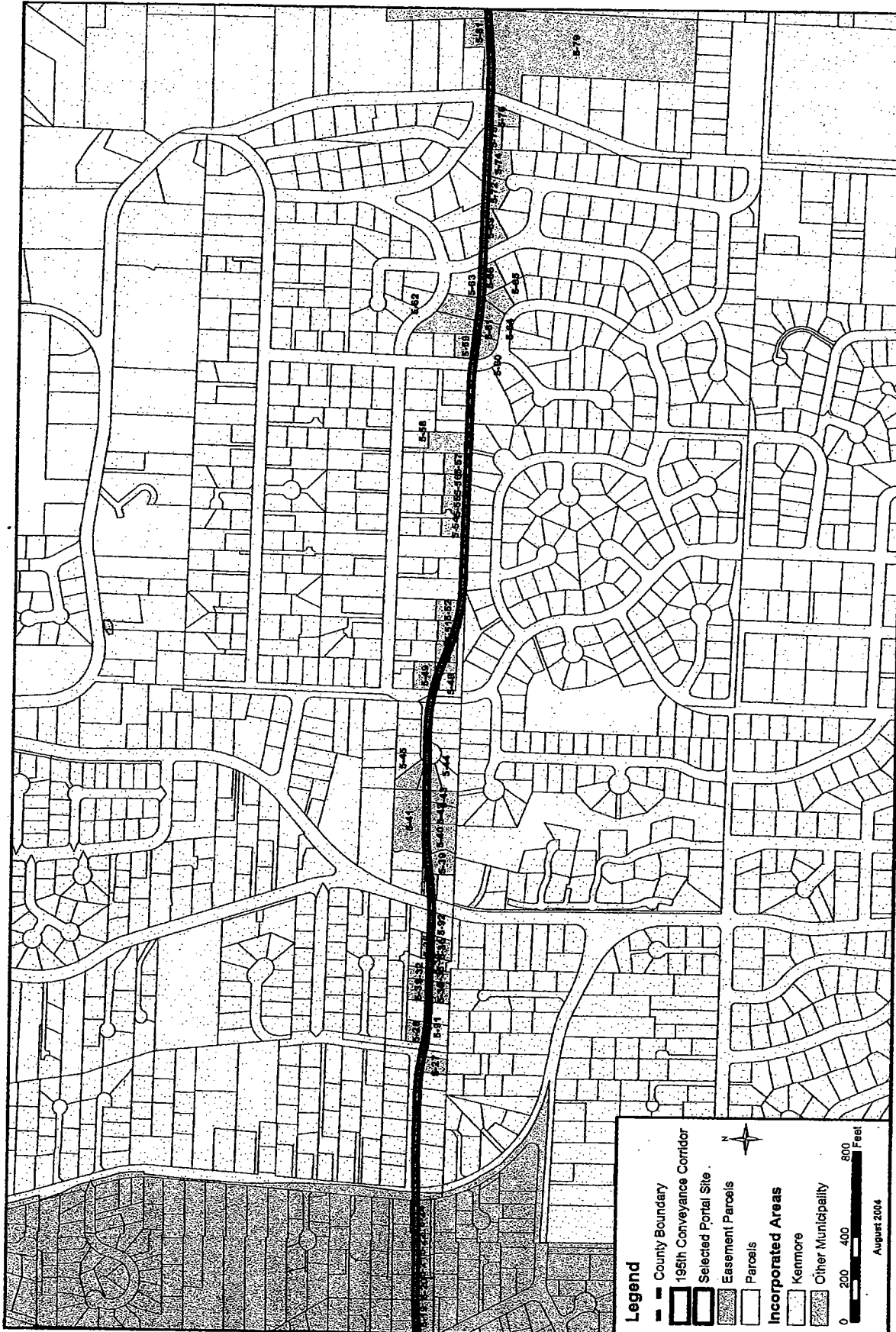

### Legend

- County Boundary
  - 195th Conveyance Corridor
  - Selected Portal Site
  - Easement Parcels
  - Parcels
  - Incorporated Areas
    - Kenmore
    - Other Municipality
- 0 200 400 800 Feet
- August 2004



**King County**  
 Department of  
 Natural Resources and Parks  
 Wastewater Treatment  
 Division

The information included on this map has been compiled from a variety of sources and is subject to change without notice. The County does not warrant the accuracy, completeness, timeliness, or reliability of the information included on this map. The County is not liable for any general, special, indirect, incidental, or consequential damages including, but not limited to, lost revenues or lost profits resulting from the use or misuse of the information contained on this map. Any use of this map or information on this map is prohibited except by written permission of King County.

File Name: Q:\WTP\Projects\BW\_Design\Project\Impacted\_parcels.mxd SC

Map 1 of 2

**Easement Parcels within the City of Kenmore**  
 BRIGHTWATER REGIONAL  
 WASTEWATER TREATMENT SYSTEM



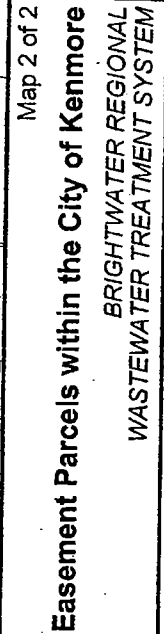

The information included on this map has been compiled from a variety of sources and is subject to change without notice. King County makes no representations or warranties, express or implied, as to accuracy, completeness, timeliness, or rights to the use of such information. King County shall not be liable for any general, special, indirect, incidental, or consequential damages including, but not limited to, lost revenues or lost profits resulting from the use or misuse of the information contained on this map. Any sale of the map or information on this map is prohibited except by written permission of King County.

File Name: Q:\WTD\Projects\BW\_Design\Projects\Impacted\_Parcel.mxd SC



**King County**  
**Department of**  
**Natural Resources and Parks**  
**Wastewater Treatment**  
**Division**

## Exhibit A

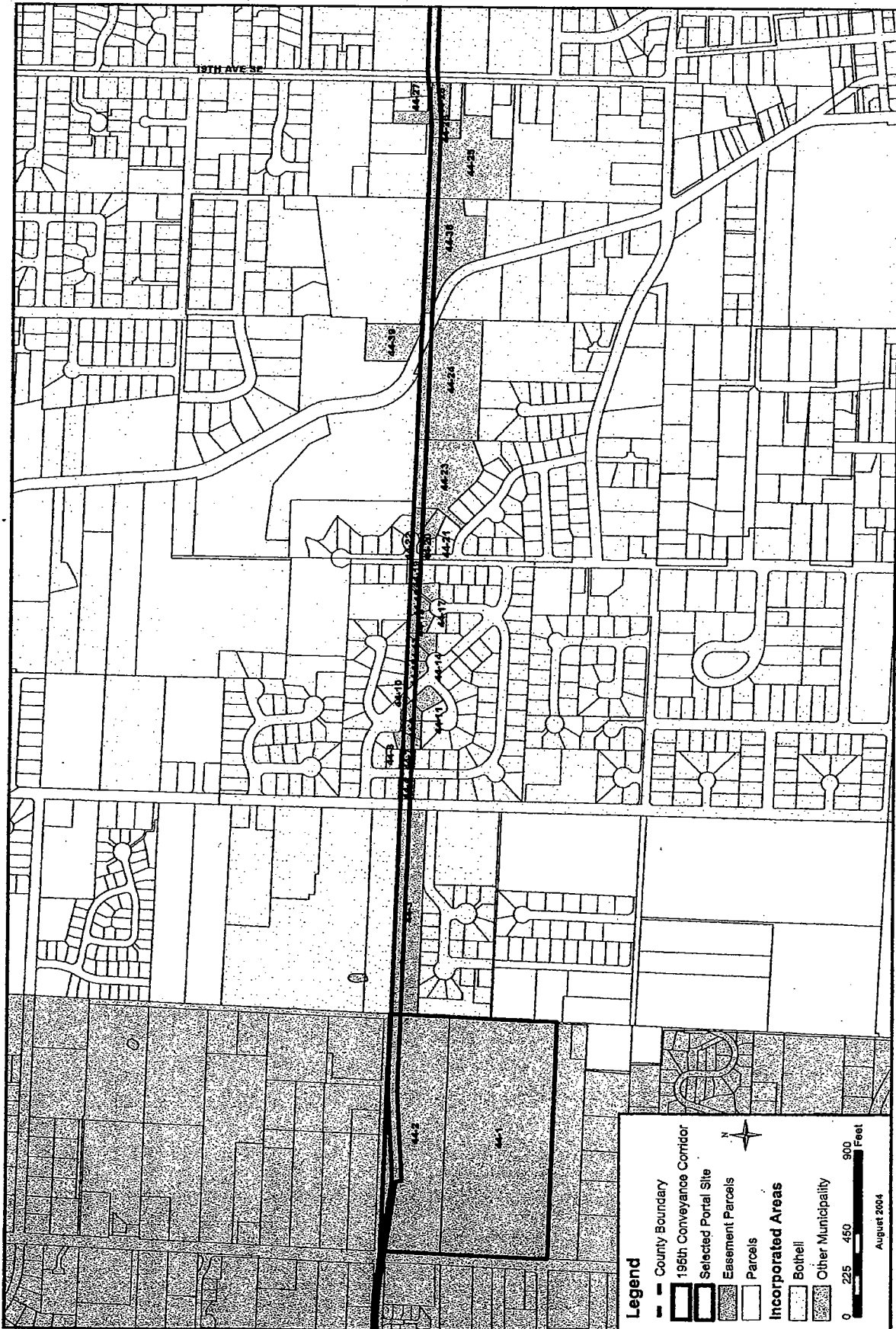

Map 1 of 3

### Easement Parcels within the City of Bothell

BRIGHTWATER REGIONAL  
WASTEWATER TREATMENT SYSTEM

The information included on this map has been compiled from a variety of sources and is subject to change without notice. King County makes no representation or warranty as to the accuracy, completeness, timeliness, or utility of the information. King County shall not be liable for any general, special, indirect, incidental, or consequential damages including, but not limited to, lost revenues or lost profits resulting from the use or misuse of the information contained on this map. Any use of this map or information on this map is prohibited except by written permission of King County.

File Name: Q:\WTD\Project\BW\_Design\Project\Impacted\_parcels.mxd 8C



**King County**

Department of

Natural Resources and Parks

Wastewater Treatment  
Division

#### Legend

- County Boundary
- 195th Conveyance Corridor
- Selected Portal Site
- Easement Parcels
- Parcels
- Incorporated Areas
- Bothell
- Other Municipality



August 2004

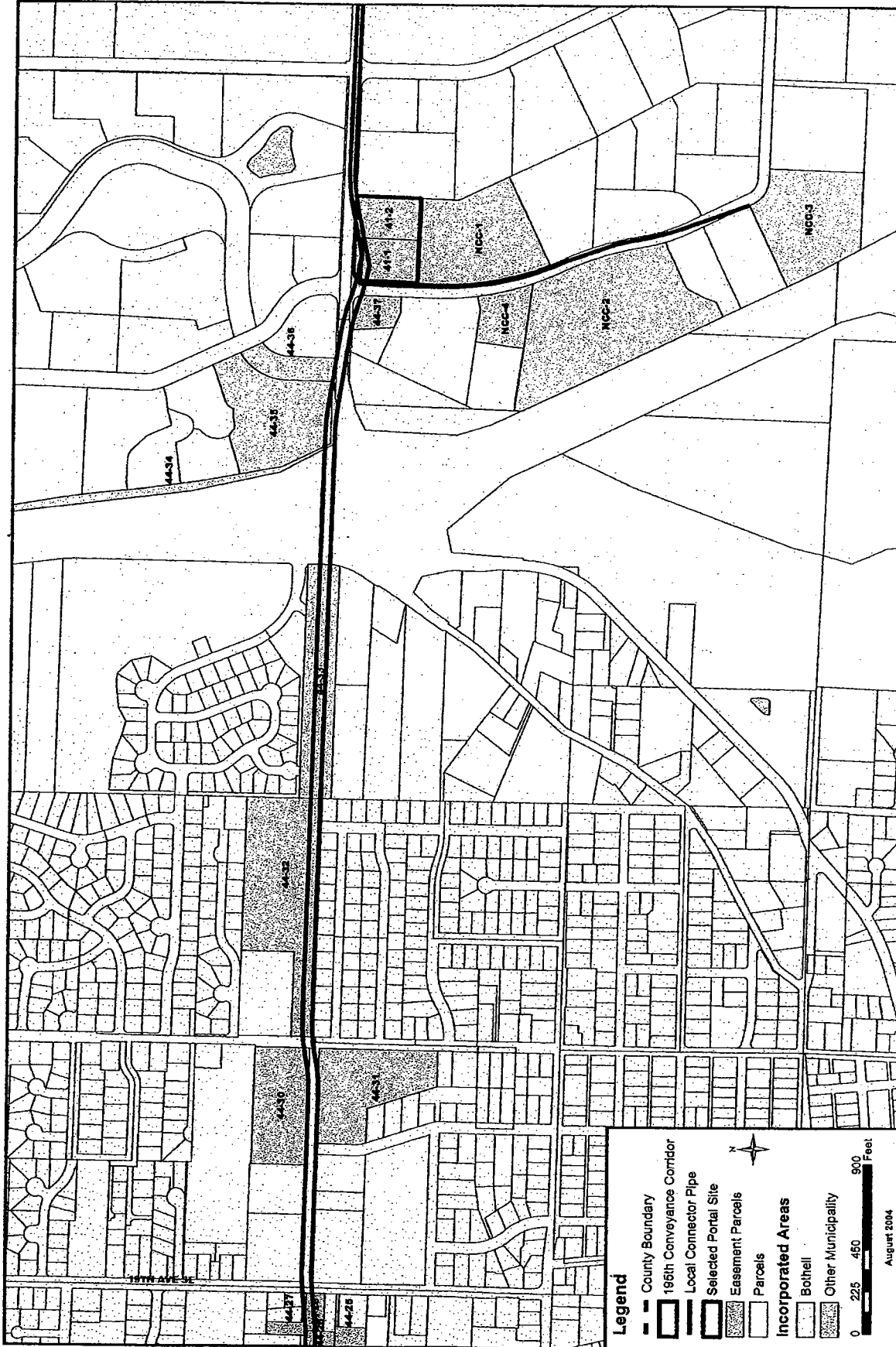

Map 2 of 3

# Easement Parcels within the City of Bothell

BRIGHTWATER REGIONAL  
WASTEWATER TREATMENT SYSTEM

The information included on this map has been compiled from a variety of sources and is subject to change without notice. King County makes no representations or warranties, express or implied, as to accuracy, completeness, timeliness, or rights to the use of such information. King County shall not be liable for any damages, including consequential damages, arising from the use of this map, whether or not such damages were foreseeable. Any use of this map or information on this map is prohibited except by written permission of King County.

File Name: Q:\WTP\Projects\BW\_Design\Projects\Impacted\_Parcel.mxd SC

**King County**  
Department of  
Natural Resources and Parks  
Wastewater Treatment  
Division

August 2004



## Legend

- County Boundary
- 196th Conveyance Corridor
- Local Connector Pipe
- Selected Portal Site
- Easement Parcels
- Parcels
- Incorporated Areas
- Bothell
- Other Municipality

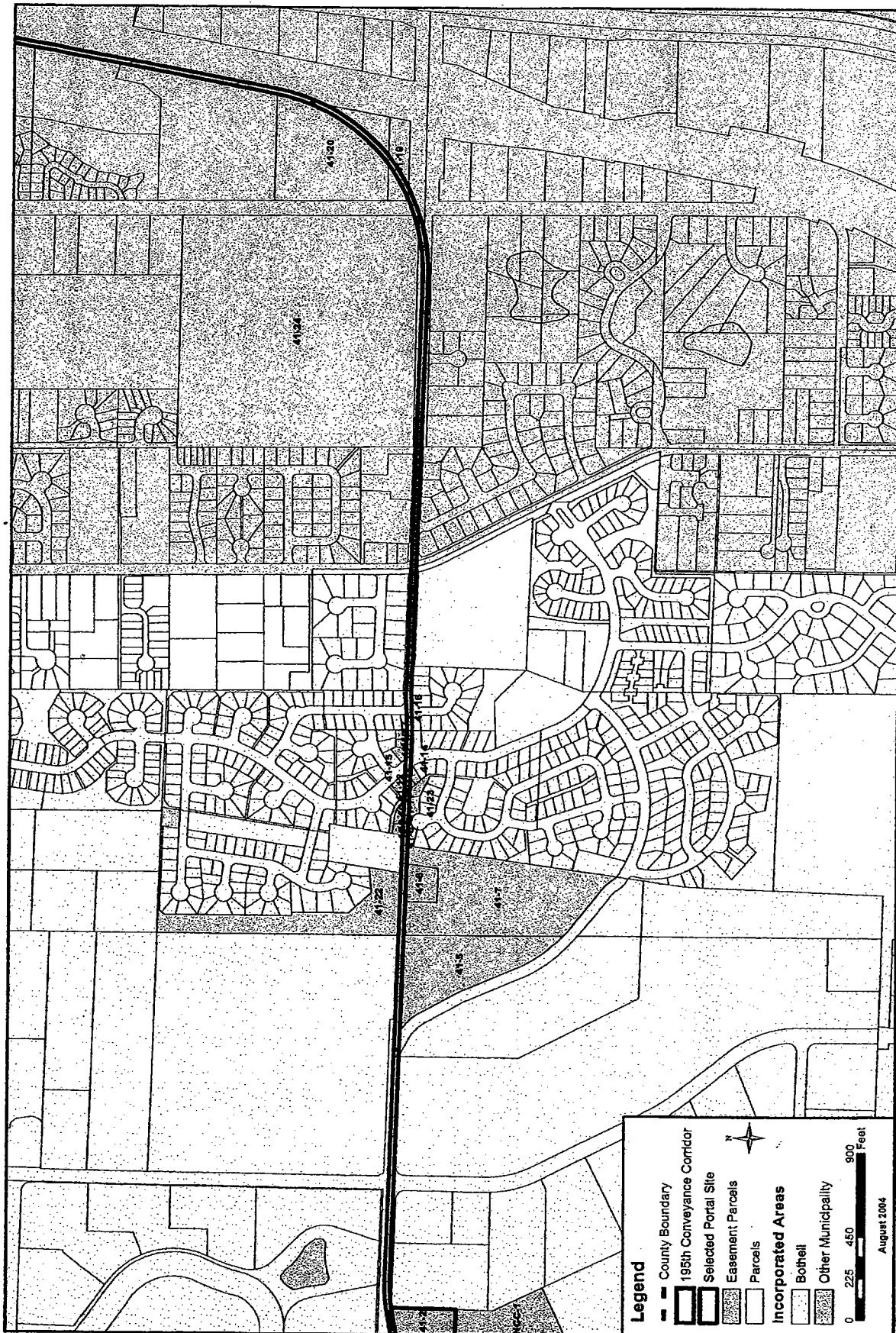

Map 3 of 3

### Easement Parcels within the City of Bothell

BRIGHTWATER REGIONAL  
WASTEWATER TREATMENT SYSTEM

The information included on this map has been compiled from a variety of sources and is subject to change without notice. The information is provided for informational purposes only and is not intended to be used for any purpose other than that for which it was prepared. The information is not intended to be used for any purpose other than that for which it was prepared. The information is not intended to be used for any purpose other than that for which it was prepared.

File Name: Q:\WTP\Projects\BW\_Design\Projects\Impacted\_Parcel.mxd SC

#### Legend

- County Boundary
- 195th Conveyance Corridor
- Selected Portal Site
- Easement Parcels
- Parcels
- Incorporated Areas
- Bothell
- Other Municipality

0 225 450 900 Feet

August 2004



**King County**

Department of  
Natural Resources and Parks  
Wastewater Treatment  
Division