



Better Properties Real Estate
6223 Mt. Tacoma Dr SW
Lakewood, WA 98499
Phone: 253-589-2680
Fax: 253-589-2668

Commercial Brokers
Association 2011
ALL RIGHTS RESERVED



CBA Form ST_LS
Single Tenant: Gross Lease
Rev. 1/2011
Page 1 of 22

LEASE AGREEMENT (Single Tenant - Gross Lease)

THIS LEASE AGREEMENT (the "Lease") is entered into and effective as of this 28 day of November, 2015, between Noble Pacific Enterprises LLC ("Landlord"), and Amana Global Company ("Tenant"). Landlord and Tenant agree as follows:

1. LEASE SUMMARY.

- a. **Leased Premises.** The leased commercial real estate (the "Premises") consists of the real property legally described on attached Exhibit A, and all improvements thereon, and commonly described as 22230 Russell Road Kent Wa 98032.
- b. **Lease Commencement Date.** The term of this Lease shall be for a period of 60 months and shall commence on September 1, 2016 or such earlier or later date as provided in Section 3 (the "Commencement Date").
- c. **Lease Termination Date.** The term of this Lease shall expire at midnight on August 31, 2021 or such earlier or later date as provided in Section 3 (the "Termination Date"). Tenant shall have no right or option to extend this Lease, unless otherwise set forth in a rider attached to this Lease (e.g., Option to Extend Rider, CBA Form OR).
- d. **Base Rent.** The base monthly rent shall be (check one): ☒ \$4500, or ☐ according to the Rent Rider attached hereto ("Base Rent"). Rent shall be payable at Landlord's address shown in Section 1(h) below, or such other place designated in writing by Landlord.
- e. **Prepaid Rent.** Upon execution of this Lease, Tenant shall deliver to Landlord the sum of \$0 as prepaid rent, to be applied to the Rent due for the months through of the Lease.
- f. **Security Deposit.** Upon execution of this Lease, Tenant shall deliver to Landlord the sum of \$0 to be held as a security deposit pursuant to Section 5 below. The security deposit shall be in the form of (check one): ☐ cash, ☐ letter of credit according to the Letter of Credit Rider (CBA Form LCR), attached hereto, or ☐ check.
- g. **Permitted Use.** The Premises shall be used only for storage of equipments and for no other purpose without the prior written consent of Landlord (the "Permitted Use").
- h. **Notice and Payment Addresses.**

Landlord: Noble Pacific Enterprises LLC

Fax No.: 2538726978
Email: blee28@aol.com

Tenant: Amana Global Company



Better Properties Real Estate
6223 Mt. Tacoma Dr SW
Lakewood, WA 98499
Phone: 253-589-2680
Fax: 253-589-2668

© Commercial Brokers
Association 2011
ALL RIGHTS RESERVED



CBA Form ST_LS
Single Tenant Gross Lease
Rev. 1/2011
Page 2 of 22

LEASE AGREEMENT
(Single Tenant - Gross Lease)

Fax No.: _____
Email: hafid1416@yahoo.com

2. PREMISES.

a. **Lease of Premises.** Landlord leases to Tenant, and Tenant leases from Landlord the Premises upon the terms specified in this Lease.

b. **Acceptance of Premises.** Except as specified elsewhere in this Lease, Landlord makes no representations or warranties to Tenant regarding the Premises, including the structural condition of the Premises or the condition of all mechanical, electrical, and other systems on the Premises. Except for any tenant improvements to be completed by Landlord as described on attached Exhibit B (the "Landlord's Work"), Tenant shall be responsible for performing any work necessary to bring the Premises into a condition satisfactory to Tenant. By signing this Lease, Tenant acknowledges that it has had adequate opportunity to investigate the Premises; acknowledges responsibility for making any corrections, alterations and repairs to the Premises (other than the Landlord's Work); and acknowledges that the time needed to complete any such items shall not delay the Commencement Date.

~~c. **Tenant Improvements.** Attached Exhibit B sets forth all of Landlord's Work, if any, and all tenant improvements to be completed by Tenant (the "Tenant's Work"), if any, that will be performed on the Premises. Responsibility for design, payment and performance of all such work shall be as set forth on attached Exhibit B. If Tenant fails to notify Landlord of any defects in the Landlord's Work within thirty (30) days of delivery of possession to Tenant, Tenant shall be deemed to have accepted the Premises in their then condition. If Tenant discovers any major defects in the Landlord's Work during this 30-day period that would prevent Tenant from using the Premises for the Permitted Use, Tenant shall notify Landlord in writing and the Commencement Date shall be delayed until Landlord has notified Tenant that Landlord has corrected the major defects and Tenant has had five (5) days to inspect and approve the Premises. The Commencement Date shall not be delayed if Tenant's inspection reveals minor defects in the Landlord's Work that will not prevent Tenant from using the Premises for the Permitted Use. Tenant shall prepare a punch list of all minor defects in Landlord's Work and provide the punch list to Landlord, which Landlord shall promptly correct.~~

3. **TERM.** The term of this Lease shall commence on the Commencement Date specified in Section 1, or on such earlier or later date as may be specified by written notice delivered by Landlord to Tenant advising Tenant that the Premises are ready for possession and specifying the Commencement Date, which shall not be less than _____ days (thirty (30) days if not filled in) following the date of such notice.

~~a. **Early Possession.** If Landlord permits Tenant to possess and occupy the Premises prior to the Commencement Date specified in Section 1, then such early occupancy shall not advance or change the Commencement Date or the Termination Date set forth in Section 1, but otherwise all terms and conditions of this Lease shall nevertheless apply during the period of early occupancy before the Commencement Date.~~



Better Properties Real Estate
6223 Mt. Tacoma Dr SW
Lakewood, WA 98499
Phone: 253-589-2680
Fax: 253-589-2668

© Commercial Brokers
Association 2011
ALL RIGHTS RESERVED



CBA Form ST_LS
Single Tenant Gross Lease
Rev. 1/2011
Page 3 of 22

LEASE AGREEMENT
(Single Tenant - Gross Lease)

~~b. **Delayed Possession.** Landlord shall act diligently to make the Premises available to Tenant; provided, however, neither Landlord nor any agent or employee of Landlord shall be liable for any damage or loss due to Landlord's inability or failure to deliver possession of the Premises to Tenant as provided in this Lease. If possession is delayed, the Commencement Date set forth in Section 1 shall also be delayed. In addition, the Termination Date set forth in Section 1 shall be modified so that the length of the Lease term remains the same. If Landlord does not deliver possession of the Premises to Tenant within _____ days (sixty (60) days if not filled in) after the Commencement Date specified in Section 1, Tenant may elect to cancel this Lease by giving written notice to Landlord within ten (10) days after such time period ends. If Tenant gives such notice of cancellation, the Lease shall be cancelled, all prepaid rent and security deposits shall be refunded to Tenant, and neither Landlord nor Tenant shall have any further obligations to the other. The first "Lease Year" shall commence on the Commencement Date and shall end on the date which is twelve (12) months from the end of the month in which the Commencement Date occurs. Each successive Lease Year during the initial term and any extension term shall be twelve (12) months, commencing on the first day following the end of the preceding Lease Year. To the extent that the tenant improvements are not completed in time for the Tenant to occupy or take possession of the Premises on the Commencement Date due to the failure of Tenant to fulfill any of its obligations under this Lease, the Lease shall nevertheless commence on the Commencement Date set forth in Section 1.~~

4. RENT

a. **Payment of Rent.** Tenant shall pay Landlord without notice, demand, deduction, or offset, in lawful money of the United States, the base monthly rental stated in Section 1 above in advance on or before the first day of each month during the Lease term beginning on (check one): ☒ the Commencement Date, or ☐ _____ (if no date specified, then on the Commencement Date), and shall also pay any other additional payments due to Landlord ("Additional Rent") (collectively, "rent" or "Rent") when required under this Lease. Payments for any partial month at the beginning or end of the Lease shall be prorated. All payments due to Landlord under this Lease, including late fees and interest, shall also constitute Additional Rent, and upon failure of Tenant to pay any such costs, charges or expenses, Landlord shall have the same rights and remedies as otherwise provided in this Lease for the failure of Tenant to pay rent.

b. **Late Charges; Default Interest.** If any sums payable by Tenant to Landlord under this Lease are not received within five (5) business days after their due date, Tenant shall pay Landlord an amount equal to the greater of \$100 or five percent (5%) of the delinquent amount for the cost of collecting and handling such late payment in addition to the amount due and as Additional Rent. ~~All delinquent sums payable by Tenant to Landlord and not paid within five (5) business days after their due date shall, at Landlord's option, bear interest at the rate of fifteen percent (15%) per annum, or the highest rate of interest allowable by law, whichever is less (the "Default Rate"). Interest on all delinquent amounts shall be calculated from the original due date to the date of payment.~~

c. **Less Than Full Payment.** Landlord's acceptance of less than the full amount of any payment due from Tenant shall not be deemed an accord and satisfaction or compromise of such payment unless Landlord specifically consents in writing to payment of such lesser sum as an accord and satisfaction or compromise of the amount which Landlord claims. Any portion that remains to be paid by Tenant shall be subject to the late charges and default interest provisions of this Section.



Better Properties Real Estate
6223 Mt. Tacoma Dr SW
Lakewood, WA 98499
Phone: 253-589-2680
Fax: 253-589-2668

Commercial Brokers
Association 2011
ALL RIGHTS RESERVED

CBA

CBA Form ST_LS
Single Tenant Gross Lease
Rev. 1/2011
Page 4 of 22

LEASE AGREEMENT
(Single Tenant - Gross Lease)

5. **SECURITY DEPOSIT.** Upon execution of this Lease, Tenant shall deliver to Landlord the security deposit specified in Section 1 above. Landlord's obligations with respect to the security deposit are those of a debtor and not of a trustee, and Landlord may commingle the security deposit with its other funds. If Tenant breaches any covenant or condition of this Lease, including but not limited to the payment of Rent, Landlord may apply all or any part of the security deposit to the payment of any sum in default and any damage suffered by Landlord as a result of Tenant's breach. Tenant acknowledges, however, that the security deposit shall not be considered as a measure of Tenant's damages in case of default by Tenant, and any payment to Landlord from the security deposit shall not be construed as a payment of liquidated damages for Tenant's default. If Landlord applies the security deposit as contemplated by this Section, Tenant shall, within five (5) days after written demand therefor by Landlord, deposit with Landlord the amount so applied. If Tenant complies with all of the covenants and conditions of this Lease throughout the Lease term, the security deposit shall be repaid to Tenant without interest within thirty (30) days after the surrender of the Premises by Tenant in the condition required by Section 11 of this Lease. RNL
H.T

6. **USES.** The Premises shall be used only for the Permitted Use specified in Section 1 above, and for no other business or purpose without the prior written consent of Landlord. No act shall be done on or around the Premises that is unlawful or that will increase the existing rate of insurance on the Premises, or cause the cancellation of any insurance on the Premises. Tenant shall not commit or allow to be committed any waste upon the Premises, or any public or private nuisance.

7. **COMPLIANCE WITH LAWS.** Tenant shall not cause or permit the Premises to be used in any way which violates any law, ordinance, or governmental regulation or order. Landlord represents to Tenant that, as of the Commencement Date, to Landlord's knowledge, but without duty of investigation, and with the exception of any Tenant's Work, the Premises comply with all applicable laws, rules, regulations, or orders, including without limitation, the Americans With Disabilities Act, if applicable, and Landlord shall be responsible to promptly cure at its sole cost any noncompliance which existed on the Commencement Date. Tenant shall be responsible for complying with all laws applicable to the Premises as a result of the Permitted Use, and Tenant shall be responsible for making any changes or alterations as may be required by law, rule, regulation, or order for Tenant's Permitted Use at its sole cost and expense. Otherwise, if changes or alterations are required by law, rule, regulation, or order unrelated to the Permitted Use, Landlord shall make changes and alterations at its expense.

8. **UTILITIES.** Landlord shall not be responsible for providing any utilities to the Premises and shall not be liable for any loss, injury or damage to person or property caused by or resulting from any variation, interruption, or failure of utilities due to any cause whatsoever, and rent shall not abate as a result thereof, except to the extent due to the intentional misconduct or gross negligence of Landlord. Tenant shall be responsible for determining whether available utilities and their capacities will meet Tenant's needs. Tenant shall install and connect, if necessary, and directly pay for all water, sewer, gas, janitorial, electricity, garbage removal, heat, telephone, Internet, cable services, and other utilities and services used by Tenant on the Premises during the term, whether or not such services are billed directly to Tenant. Tenant will also procure, or cause to be procured, without cost to Landlord, all necessary permits, licenses or other authorizations required for the lawful and proper installation, maintenance, replacement, and removal on or from the Premises of wires, pipes, conduits, tubes, and other equipment and appliances for use in supplying all utilities or services to the Premises. Landlord, upon request of Tenant, and at the sole expense and liability of Tenant, shall join with Tenant in any reasonable applications required for obtaining or continuing such utilities or services. RNL
H.T

LEASE AGREEMENT
(Single Tenant - Gross Lease)

9. ~~**TAXES.** Tenant shall pay all taxes, assessments, liens and license fees ("Taxes") levied, assessed or imposed by any authority having the direct or indirect power to tax or assess any such liens, related to or required by Tenant's use of the Premises as well as all Taxes on Tenant's personal property located on the Premises. Landlord shall pay all Taxes with respect to the Premises, including any Taxes resulting from a reassessment of the Premises due to a change of ownership or otherwise.~~

Handwritten: P.H.T.

10. **ALTERATIONS.** Tenant may make alterations, additions or improvements to the Premises, including any Tenant's Work identified on attached Exhibit B (the "Alterations"), only with the prior written consent of Landlord, which, with respect to Alterations not affecting the structural components of the Premises or utility systems therein, shall not be unreasonably withheld, conditioned, or delayed. Landlord shall have thirty (30) days in which to respond to Tenant's request for any Alterations so long as such request includes the name of Tenant's contractors and reasonably detailed plans and specifications therefor. The term "Alterations" shall not include the installation of shelves, movable partitions, Tenant's equipment, and trade fixtures that may be performed without damaging existing improvements or the structural integrity of the Premises, and Landlord's consent shall not be required for Tenant's installation or removal of those items. Tenant shall perform all work within the Premises at Tenant's expense in compliance with all applicable laws and shall complete all Alterations in accordance with plans and specifications approved by Landlord, using contractors approved by Landlord. Tenant shall pay, when due, or furnish a bond for payment (as set forth in Section 18) all claims for labor or materials furnished to or for Tenant at or for use in the Premises, which claims are or may be secured by any mechanics' or materialmen's liens against the Premises or any interest therein. Tenant shall remove all Alterations at the end of the Lease term unless Landlord conditioned its consent upon Tenant leaving a specified Alteration at the Premises, in which case Tenant shall not remove such Alteration and it shall become Landlord's property. Tenant shall immediately repair any damage to the Premises caused by removal of Alterations.

11. ~~**REPAIRS AND MAINTENANCE; SURRENDER.** Tenant shall, at its sole expense, maintain the entire Premises including without limitation the roof surface and normal repairs and maintenance to all heating, ventilation, and air conditioning ("HVAC") equipment at the Premises, in good condition and promptly make all repairs and replacements, whether structural or non-structural, necessary to keep the Premises in safe operating condition, including all utilities and other systems serving the Premises, but excluding the roof structure, subfloor, foundation, exterior walls, and capital repairs and replacements to the HVAC system (collectively, "Landlord's Repair Items"), which Landlord shall maintain in good condition and repair at Landlord's expense. Tenant shall not damage any Landlord's Repair Items and shall promptly repair any damage or injury done thereto caused by Tenant or its employees, officers, agents, servants, contractors, customers, clients, visitors, guests, or other licensees or invitees. Notwithstanding anything in this Section to the contrary, Tenant shall not be responsible for any repairs to the Premises made necessary by the negligence or willful misconduct of Landlord or its employees, officers, agents, servants, contractors, customers, clients, visitors, guests, or other licensees or invitees therein. If Tenant fails to perform Tenant's obligations under this Section, Landlord may at Landlord's option enter upon the Premises after ten (10) days' prior notice to Tenant and put the same in good order, condition and repair and the cost thereof together with interest thereon at the default rate set forth in Section 4 shall be due and payable as Additional Rent to Landlord together with Tenant's next installment of Base Rent. Upon expiration of the Lease term, whether by lapse of time or otherwise, Tenant shall promptly and peacefully surrender the Premises, together with all keys, to Landlord in as good condition as when received by Tenant from Landlord or as thereafter improved, reasonable wear and tear and insured casualty excepted.~~

Handwritten: P.H.T.

LEASE AGREEMENT
(Single Tenant - Gross Lease)

12. **ACCESS AND RIGHT OF ENTRY.** After twenty-four (24) hours' notice from Landlord (except in cases of emergency, when no notice shall be required), Tenant shall permit Landlord and its agents, employees and contractors to enter the Premises at all reasonable times to make repairs, inspections, alterations or improvements, provided that Landlord shall use reasonable efforts to minimize interference with Tenant's use and enjoyment of the Premises. This Section shall not impose any repair or other obligation upon Landlord not expressly stated elsewhere in this Lease. After reasonable notice to Tenant, Landlord shall have the right to enter the Premises for the purpose of (a) showing the Premises to prospective purchasers or lenders at any time, and to prospective tenants within one hundred eighty (180) days prior to the expiration or sooner termination of the Lease term; and, (b) for posting "for lease" signs within one hundred eighty (180) days prior to the expiration or sooner termination of the Lease term.

13. **SIGNAGE.** Tenant shall obtain Landlord's written consent as to size, location, materials, method of attachment, and appearance, before installing any signs upon the Premises. Tenant shall install any approved signage at Tenant's sole expense and in compliance with all applicable laws. Tenant shall not damage or deface the Premises in installing or removing signage and shall repair any injury or damage to the Premises caused by such installation or removal. H.T.

14. **DESTRUCTION OR CONDEMNATION.**

a. **Damage and Repair.** If the Premises are partially damaged but not rendered untenable, by fire or other insured casualty, then Landlord shall diligently restore the Premises to the extent required below and this Lease shall not terminate. Tenant may, however, terminate the Lease if Landlord is unable to restore the Premises within six (6) months of the casualty event by giving twenty (20) days notice of termination. H.T.

The Premises shall not be deemed untenable if twenty-five percent (25%) or less of the Premises are damaged. If insurance proceeds are not available or are not sufficient to pay the entire cost of restoring the Premises, or if Landlord's lender does not permit all or any part of the insurance proceeds to be applied toward restoration, then Landlord may elect to terminate this Lease and keep the insurance proceeds, by notifying Tenant within sixty (60) days of the date of such casualty.

If fifty (50) percent or more of the rentable area of the Premises are destroyed or damaged and rendered untenable, by fire or other casualty, Landlord may, at its option: (a) terminate this Lease as provided herein, or (b) restore the Premises to their previous condition to the extent required below; provided, however, if such casualty event occurs during the last six (6) months of the Lease term (after considering any option to extend the term timely exercised by Tenant) then either Tenant or Landlord may elect to terminate the Lease. If, within sixty (60) days after receipt by Landlord from Tenant of written notice that Tenant deems the Premises untenable, Landlord fails to notify Tenant of its election to restore the Premises, or if Landlord is unable to restore the Premises within six (6) months of the date of the casualty event, then Tenant may elect to terminate the Lease upon twenty (20) days' written notice to Landlord unless Landlord, within such twenty (20) day period, notifies Tenant that it will in fact restore the Premises or actually completes such restoration work to the extent required below, as applicable.

If Landlord restores the Premises under this Section, Landlord shall proceed with reasonable diligence to complete the work, and the Base Rent shall be abated in the same proportion as the untenable portion of the Premises bears to the whole Premises, provided that there shall be a Rent abatement only if the damage or destruction of the Premises did not result from, or was not

LEASE AGREEMENT
(Single Tenant - Gross Lease)

contributed to directly or indirectly by the act, fault or neglect of Tenant, or Tenant's employees, officers, agents, servants, contractors, customers, clients, visitors, guests, or other licensees or invitees. No damages, compensation or claim shall be payable by Landlord for inconvenience, loss of business or annoyance directly, incidentally or consequentially arising from any repair or restoration of any portion of the Premises. Landlord shall have no obligation to carry insurance of any kind for the protection of Tenant; any alterations or improvements paid for by Tenant; any Tenant Work identified in Exhibit B (regardless of who may have completed them); Tenant's furniture, or on any fixtures, equipment, improvements or appurtenances of Tenant under this Lease, and Landlord's restoration obligations hereunder shall not include any obligation to repair any damage thereto or replace the same. RL ✓
H T

b. **Condemnation.** If the Premises are made untenable by eminent domain, or conveyed under a threat of condemnation, this Lease shall automatically terminate as of the earlier of the date title vests in the condemning authority or the condemning authority first has possession of the Premises and all Rents and other payments shall be paid to that date. If the condemning authority takes a portion of the Premises that does not render the Premises untenable, then this Lease shall continue in full force and effect and the base monthly rent shall be equitably reduced based on the proportion by which the floor area of any structures is reduced. The reduction in Rent shall be effective on the earlier of the date the condemning authority first has possession of such portion or title vests in the condemning authority. Landlord shall be entitled to the entire award from the condemning authority attributable to the value of the Premises and Tenant shall make no claim for the value of its leasehold. Tenant shall be permitted to make a separate claim against the condemning authority for moving expenses if Tenant may terminate this Lease pursuant to this Section, provided that in no event shall Tenant's claim reduce Landlord's award.

15. INSURANCE.

a. **Tenant's Liability Insurance.** During the Lease term, Tenant shall pay for and maintain commercial general liability insurance with broad form property damage and contractual liability endorsements. This policy shall name Landlord, its property manager (if any), and other parties designated by Landlord as additional insureds using an endorsement form acceptable to Landlord, and shall insure Tenant's activities and those of Tenant's employees, officers, agents, servants, contractors, customers, clients, visitors, guests, or other licensees or invitees with respect to the Premises against loss, damage or liability for personal injury or bodily injury (including death) or loss or damage to property with a combined single limit of not less than \$2,000,000, and a deductible of not more than \$10,000. Tenant's insurance will be primary and noncontributory with any liability insurance carried by Landlord. Landlord may also require Tenant to obtain and maintain business income coverage for at least six (6) months, business auto liability coverage, and, if applicable to Tenant's Permitted Use, liquor liability insurance and/or warehouseman's coverage. RL ✓
H T

b. **Tenant's Property Insurance.** During the Lease term, Tenant shall pay for and maintain special form clauses of loss coverage property insurance (with coverage for earthquake if required by Landlord's lender and, if the Premises are situated in a flood plain, flood damage) for all of Tenant's personal property, fixtures, and equipment in the amount of their full replacement value, with a deductible of not more than \$10,000.

LEASE AGREEMENT
(Single Tenant - Gross Lease)

c. ~~Miscellaneous. Tenant's insurance required under this Section shall be with companies rated A-/VII or better in Best's Insurance Guide, and which are admitted in the State in which the Premises are located. No insurance policy shall be cancelled or reduced in coverage and each such policy shall provide that it is not subject to cancellation or a reduction in coverage except after thirty (30) days prior written notice to Landlord. Tenant shall deliver to Landlord upon commencement of the Lease and from time to time thereafter, copies of the insurance policies or evidence of insurance and copies of endorsements required by this Section. In no event shall the limits of such policies be considered as limiting the liability of Tenant under this Lease. If Tenant fails to acquire or maintain any insurance or provide any policy or evidence of insurance required by this Section, and such failure continues for three (3) days after written notice from Landlord, Landlord may, but shall not be required to, obtain such insurance for Landlord's benefit and Tenant shall reimburse Landlord for the costs of such insurance upon demand. Such amounts shall be Additional Rent payable by Tenant hereunder and in the event of non-payment thereof, Landlord shall have the same rights and remedies with respect to such non-payment as it has with respect to any other non-payment of Rent hereunder.~~

d. **Landlord's Insurance.** Landlord shall carry special form clauses of loss coverage property insurance for the improvements that make up the Premises (including their shell and core) in the amount of their full replacement value, and such other insurance of such types and amounts as Landlord, in its discretion, shall deem reasonably appropriate.

e. **Waiver of Subrogation.** Landlord and Tenant hereby release each other and any other tenant, their agents or employees, from responsibility for, and waive their entire claim of recovery for any loss or damage arising from any cause covered by property insurance required to be carried or otherwise carried by each of them. Each party shall provide notice to the property insurance carrier or carriers of this mutual waiver of subrogation, and shall cause its respective property insurance carriers to waive all rights of subrogation against the other. This waiver shall not apply to the extent of the deductible amounts to any such property policies or to the extent of liabilities exceeding the limits of such policies.

16. INDEMNIFICATION.

a. **Indemnification by Tenant.** Tenant shall defend, indemnify, and hold Landlord harmless against all liabilities, damages, costs, and expenses, including attorneys' fees, for personal injury, bodily injury (including death) or property damage arising from any negligent or wrongful act or omission of Tenant or Tenant's employees, officers, agents, servants, contractors, customers, clients, visitors, guests, or other licensees or invitees on or around the Premises, or arising from any breach of this Lease by Tenant. Tenant shall use legal counsel reasonably acceptable to Landlord in defense of any action within Tenant's defense obligation.

b. **Indemnification by Landlord.** Landlord shall defend, indemnify and hold Tenant harmless against all liabilities, damages, costs, and expenses, including attorneys' fees, for personal injury, bodily injury (including death) or property damage arising from any negligent or wrongful act or omission of Landlord or Landlord's employees, officers, agents, servants, contractors, customers, clients, visitors, guests, or other licensees or invitees on or around the Premises, or arising from any breach of this Lease by Landlord. Landlord shall use legal counsel reasonably acceptable to Tenant in defense of any action within Landlord's defense obligation.



Better Properties Real Estate
6223 Mt. Tacoma Dr SW
Lakewood, WA 98499
Phone: 253-589-2680
Fax: 253-589-2668

© Commercial Brokers
Association 2011
ALL RIGHTS RESERVED

CBA

CBA Form ST_LS
Single Tenant Gross Lease
Rev. 1/2011
Page 9 of 22

LEASE AGREEMENT
(Single Tenant - Gross Lease)

c. **Waiver of Immunity.** Landlord and Tenant each specifically and expressly waive any immunity that each may be granted under the Washington State Industrial Insurance Act, Title 51 RCW. Neither party's indemnity obligations under this Lease shall be limited by any limitation on the amount or type of damages, compensation, or benefits payable to or for any third party under the Worker Compensation Acts, Disability Benefit Acts or other employee benefit acts.

d. ~~**Exemption of Landlord from Liability.** Except to the extent of claims arising out of Landlord's gross negligence or intentional misconduct, Landlord shall not be liable for injury to Tenant's business or assets or any loss of income therefrom or for damage to any property of Tenant or of its employees, officers, agents, servants, contractors, customers, clients, visitors, guests, or other licensees or invitees, or any other person in or about the Premises.~~

e. **Survival.** The provisions of this Section shall survive expiration or termination of this Lease.

17. **ASSIGNMENT AND SUBLETTING.** Tenant shall not assign, sublet, mortgage, encumber or otherwise transfer any interest in this Lease (collectively referred to as a "Transfer") or any part of the Premises, without first obtaining Landlord's written consent which shall not be unreasonably withheld, conditioned, or delayed. No Transfer shall relieve Tenant of any liability under this Lease notwithstanding Landlord's consent to such Transfer. Consent to any Transfer shall not operate as a waiver of the necessity for Landlord's consent to any subsequent Transfer. In connection with each request for consent to a Transfer, Tenant shall pay the reasonable cost of processing same, including attorneys' fees, upon demand of Landlord, up to a maximum of \$1,250.

If Tenant is a partnership, limited liability company, corporation, or other entity, any transfer of this Lease by merger, consolidation, redemption or liquidation, or any change in the ownership of, or power to vote, which singularly or collectively represents a majority of the beneficial interest in Tenant, shall constitute a Transfer under this Section.

As a condition to Landlord's approval, if given, any potential assignee or sublessee otherwise approved by Landlord shall assume all obligations of Tenant under this Lease and shall be jointly and severally liable with Tenant and any guarantor, if required, for the payment of Rent and performance of all terms of this Lease. In connection with any Transfer, Tenant shall provide Landlord with copies of all assignments, subleases and assumption agreements or documents.

18. **LIENS.** Tenant shall not subject the Landlord's assets to any liens or claims of lien. Tenant shall keep the Premises free from any liens created by or through Tenant. Tenant shall indemnify and hold Landlord harmless from liability for any such liens including, without limitation, liens arising from any Alterations. If a lien is filed against the Premises by any person claiming by, through or under Tenant, Tenant shall, within ten (10) days after Landlord's demand, at Tenant's expense, either remove the lien or furnish to Landlord a bond in form and amount and issued by a surety satisfactory to Landlord, indemnifying Landlord and the Premises against all liabilities, costs and expenses, including attorneys' fees, which Landlord could reasonably incur as a result of such lien.

19. **DEFAULT.** The following occurrences shall each constitute a default by Tenant (an "Event of Default").

a. **Failure To Pay.** Failure by Tenant to pay any sum, including Rent, due under this Lease following five (5) days' notice from Landlord of the failure to pay.

LEASE AGREEMENT
(Single Tenant - Gross Lease)

b. **Vacation/Abandonment.** Vacation by Tenant of the Premises (defined as an absence for at least fifteen (15) consecutive days without prior notice to Landlord), or abandonment by Tenant of the Premises (defined as an absence of five (5) days or more while Tenant is in breach of some other term of this Lease). Tenant's vacation or abandonment of the Premises shall not be subject to any notice or right to cure.

c. ~~Insolvency. Tenant's insolvency or bankruptcy (whether voluntary or involuntary); or appointment of a receiver, assignee or other liquidating officer for Tenant's business; provided, however, that in the event of any involuntary bankruptcy or other insolvency proceeding, the existence of such proceeding shall constitute an Event of Default only if such proceeding is not dismissed or vacated within sixty (60) days after its institution or commencement.~~ Bul
H.T

d. **Levy or Execution.** The taking of Tenant's interest in this Lease or the Premises, or any part thereof, is taken by execution or other process of law directed against Tenant, or attachment of Tenant's interest in this Lease by any creditor of Tenant, if such attachment is not discharged within fifteen (15) days after being levied.

e. **Other Non-Monetary Defaults.** The breach by Tenant of any agreement, term or covenant of this Lease other than one requiring the payment of money and not otherwise enumerated in this Section or elsewhere in this Lease, which breach continues for a period of thirty (30) days after notice by Landlord to Tenant of the breach.

f. **Failure to Take Possession.** Failure by Tenant to take possession of the Premises on the Commencement Date or failure by Tenant to commence any Tenant Improvement in a timely fashion.

~~Landlord shall not be in default unless Landlord fails to perform obligations required of Landlord within a reasonable time, but in no event less than thirty (30) days after notice by Tenant to Landlord. If Landlord fails to cure any such default within the allotted time, Tenant's sole remedy shall be to seek actual money damages (but not consequential or punitive damages) for loss arising from Landlord's failure to discharge its obligations under this Lease. Nothing herein contained shall relieve Landlord from its duty to perform of any of its obligations to the standard prescribed in this Lease.~~ Bul
H.T

~~Any notice periods granted herein shall be deemed to run concurrently with and not in addition to any default notice periods required by law.~~ Bul
H.T

20. REMEDIES. Landlord shall have the following remedies upon an Event of Default. Landlord's rights and remedies under this Lease shall be cumulative, and none shall exclude any other right or remedy allowed by law.

LEASE AGREEMENT
(Single Tenant - Gross Lease)

a. ~~Termination of Lease. Landlord may terminate Tenant's interest under the Lease, but no act by Landlord other than notice of termination from Landlord to Tenant shall terminate this Lease. The Lease shall terminate on the date specified in the notice of termination. Upon termination of this Lease, Tenant will remain liable to Landlord for damages in an amount equal to the rent and other sums that would have been owing by Tenant under this Lease for the balance of the Lease term, less the net proceeds, if any, of any re-letting of the Premises by Landlord subsequent to the termination, after deducting all of Landlord's Reletting Expenses (as defined below). Landlord shall be entitled to either collect damages from Tenant monthly on the days on which rent or other amounts would have been payable under the Lease, or alternatively, Landlord may accelerate Tenant's obligations under the Lease and recover from Tenant: (i) unpaid rent which had been earned at the time of termination; (ii) the amount by which the unpaid rent which would have been earned after termination until the time of award exceeds the amount of rent loss that Tenant proves could reasonably have been avoided; (iii) the amount by which the unpaid rent for the balance of the term of the Lease after the time of award exceeds the amount of rent loss that Tenant proves could reasonably be avoided (discounting such amount by the discount rate of the Federal Reserve Bank of San Francisco at the time of the award, plus 1%); and (iv) any other amount necessary to compensate Landlord for all the detriment proximately caused by Tenant's failure to perform its obligations under the Lease, or which in the ordinary course would be likely to result from the Event of Default, including without limitation Reletting Expenses described below.~~

b. ~~Re-Entry and Reletting. Landlord may continue this Lease in full force and effect, and without demand or notice, re-enter and take possession of the Premises or any part thereof, expel the Tenant from the Premises and anyone claiming through or under the Tenant, and remove the personal property of either. Landlord may relet the Premises, or any part of them, in Landlord's or Tenant's name for the account of Tenant, for such period of time and at such other terms and conditions, as Landlord, in its discretion, may determine. Landlord may collect and receive the rents for the Premises. To the fullest extent permitted by law, the proceeds of any reletting shall be applied: first, to pay Landlord all Reletting Expenses (defined below); second, to pay any indebtedness of Tenant to Landlord other than rent; third, to the rent due and unpaid hereunder; and fourth, the residue, if any, shall be held by Landlord and applied in payment of other or future obligations of Tenant to Landlord as the same may become due and payable, and Tenant shall not be entitled to receive any portion of such revenue. Re-entry or taking possession of the Premises by Landlord under this Section shall not be construed as an election on Landlord's part to terminate this Lease, unless a notice of termination is given to Tenant. Landlord reserves the right following any re-entry or reletting, or both, under this Section to exercise its right to terminate the Lease. Tenant will pay Landlord the Rent and other sums which would be payable under this Lease if repossession had not occurred, less the net proceeds, if any, after reletting the Premises and after deducting Landlord's Reletting Expenses. "Reletting Expenses" is defined to include all expenses incurred by Landlord in connection with reletting the Premises, including without limitation, all repossession costs, brokerage commissions and costs for securing new tenants, attorneys' fees, remodeling and repair costs, costs for removing persons or property, costs for storing Tenant's property and equipment, and costs of tenant improvements and rent concessions granted by Landlord to any new Tenant, prorated over the life of the new lease.~~

c. ~~Waiver of Redemption Rights. Tenant, for itself, and on behalf of any and all persons claiming through or under Tenant, including creditors of all kinds, hereby waives and surrenders all rights and privileges which they may have under any present or future law, to redeem the Premises or to have a continuance of this Lease for the Lease term or any extension thereof.~~

LEASE AGREEMENT
(Single Tenant - Gross Lease)

d. ~~Nonpayment of Additional Rent. All costs which Tenant is obligated to pay to Landlord pursuant to this Lease shall in the event of nonpayment be treated as if they were payments of Rent, and Landlord shall have the same rights it has with respect to nonpayment of Rent.~~

e. ~~Failure to Remove Property. If Tenant fails to remove any of its property from the Premises at Landlord's request following an uncured Event of Default, Landlord may, at its option, remove and store the property at Tenant's expense and risk. If Tenant does not pay the storage cost within five (5) days of Landlord's request, Landlord may, at its option, have any or all of such property sold at public or private sale (and Landlord may become a purchaser at such sale), in such manner as Landlord deems proper, without notice to Tenant. Landlord shall apply the proceeds of such sale: (i) to the expense of such sale, including reasonable attorneys' fees actually incurred; (ii) to the payment of the costs or charges for storing such property; (iii) to the payment of any other sums of money which may then be or thereafter become due Landlord from Tenant under any of the terms hereof; and (iv) the balance, if any, to Tenant. Nothing in this Section shall limit Landlord's right to sell Tenant's personal property as permitted by law or to foreclose Landlord's lien for unpaid rent.~~

21. MORTGAGE SUBORDINATION AND ATTORNMEN. This Lease shall automatically be subordinate to any mortgage or deed of trust created by Landlord which is now existing or hereafter placed upon the Premises including any advances, interest, modifications, renewals, replacements or extensions ("Landlord's Mortgage"). Tenant shall attorn to the holder of any Landlord's Mortgage or any party acquiring the Premises at any sale or other proceeding under any Landlord's Mortgage provided the acquiring party assumes the obligations of Landlord under this Lease. Tenant shall promptly, and in no event later than fifteen (15) days after request, execute, acknowledge and deliver documents which the holder of any Landlord's Mortgage may reasonably require as further evidence of this subordination and attornment. Notwithstanding the foregoing, Tenant's obligations under this Section to subordinate in the future are conditioned on the holder of each Landlord's Mortgage and each party acquiring the Premises at any sale or other proceeding under any such Landlord's Mortgage not disturbing Tenant's occupancy and other rights under this Lease, so long as no uncured Event of Default by Tenant exists.

22. NON-WAIVER. Landlord's waiver of any breach of any provision contained in this Lease shall not be deemed to be a waiver of the same provision for subsequent acts of Tenant. The acceptance by Landlord of Rent or other amounts due by Tenant hereunder shall not be deemed to be a waiver of any previous breach by Tenant.

23. HOLDOVER. If Tenant shall, without the written consent of Landlord, remain in possession of the Premises and fail to return them to Landlord after the expiration or termination of the Lease, the tenancy shall be a holdover tenancy and shall be on a month-to-month basis, which may be terminated according to Washington law. During such tenancy, Tenant agrees to pay to Landlord 150% of the rate of rental last payable under this Lease, unless a different rate is agreed upon by Landlord. All other terms of the Lease shall remain in effect. Tenant acknowledges and agrees that this Section does not grant any right to Tenant to holdover, and that Tenant may also be liable to Landlord for any and all damages or expenses which Landlord may have to incur as a result of Tenant's holdover.

24. NOTICES. All notices under this Lease shall be in writing and effective (i) when delivered in person or via overnight courier to the other party, (ii) three (3) days after being sent by registered or certified mail to the other party at the address set forth in Section 1; or (iii) upon confirmed transmission by facsimile to the other party at the facsimile numbers set forth in Section 1. The addresses for notices



Better Properties Real Estate
6223 Mt. Tacoma Dr SW
Lakewood, WA 98499
Phone: 253-589-2680
Fax: 253-589-2668

© Commercial Brokers
Association 2011
ALL RIGHTS RESERVED



CBA Form ST_LS
Single Tenant Gross Lease
Rev. 1/2011
Page 13 of 22

LEASE AGREEMENT
(Single Tenant - Gross Lease)

and payment of rent set forth in Section 1 may be modified by either party only by written notice delivered in conformance with this Section.

25. COSTS AND ATTORNEYS' FEES. If Tenant or Landlord engage the services of an attorney to collect monies due or to bring any action for any relief against the other, declaratory or otherwise, arising out of this Lease, including any suit by Landlord for the recovery of Rent or other payments or possession of the Premises, the losing party shall pay the prevailing party a reasonable sum for attorneys' fees in such action, whether in mediation or arbitration, at trial, on appeal, or in any bankruptcy proceeding.

26. ESTOPPEL CERTIFICATES. Tenant shall, from time to time, upon written request of Landlord, execute, acknowledge and deliver to Landlord or its designee a written statement specifying the following, subject to any modifications necessary to make such statements true and complete: (i) the total rentable square footage of the Premises; (ii) the date the Lease term commenced and the date it expires; (iii) the amount of minimum monthly Rent and the date to which such Rent has been paid; (iv) that this Lease is in full force and effect and has not been assigned, modified, supplemented or amended in any way; (v) that this Lease represents the entire agreement between the parties; (vi) that all obligations under this Lease to be performed by either party have been satisfied; (vii) that there are no existing claims, defenses or offsets which the Tenant has against the enforcement of this Lease by Landlord; (viii) the amount of Rent, if any, that Tenant paid in advance; (ix) the amount of security that Tenant deposited with Landlord; (x) if Tenant has sublet all or a portion of the Premises or assigned its interest in the Lease and to whom; (xi) if Tenant has any option to extend the Lease or option to purchase the Premises; and (xii) such other factual matters concerning the Lease or the Premises as Landlord may reasonably request. Tenant acknowledges and agrees that any statement delivered pursuant to this Section may be relied upon by a prospective purchaser of Landlord's interest or assignee of any mortgage or new mortgagee of Landlord's interest in the Premises. If Tenant shall fail to respond within ten (10) days to Landlord's request for the statement required by this Section, Landlord may provide the statement and Tenant shall be deemed to have admitted the accuracy of the information provided by Landlord.

27. TRANSFER OF LANDLORD'S INTEREST. This Lease shall be assignable by Landlord without the consent of Tenant. In the event of any transfer or transfers of Landlord's interest in the Premises, other than a transfer for collateral purposes only, upon the assumption of this Lease by the transferee, Landlord shall be automatically relieved of obligations and liabilities accruing from and after the date of such transfer, including any liability for any retained security deposit or prepaid rent, for which the transferee shall be liable, and Tenant shall attorn to the transferee.

28. LANDLORD'S LIABILITY. Anything in this Lease to the contrary notwithstanding, covenants, undertakings and agreements herein made on the part of Landlord are made and intended not as personal covenants, undertakings and agreements for the purpose of binding Landlord personally or the assets of Landlord but are made and intended for the purpose of binding only the Landlord's interest in the Premises, as the same may from time to time be encumbered. ~~In no event shall Landlord or its partners, shareholders, or members, as the case may be, ever be personally liable hereunder.~~ *RVH*

29. RIGHT TO PERFORM. If Tenant shall fail to timely pay any sum or perform any other act on its part to be performed hereunder, Landlord may make any such payment or perform any act on Tenant's behalf. Tenant shall, within ten (10) days of demand, reimburse Landlord for its expenses incurred in making such payment or performance. Landlord shall (in addition to any other right or remedy of Landlord provided by law) have the same rights and remedies in the event of the nonpayment of sums due under this Section as in the case of default by Tenant in the payment of Rent.



Better Properties Real Estate
6223 Mt. Tacoma Dr SW
Lakewood, WA 98499
Phone: 253-589-2680
Fax: 253-589-2668

© Commercial Brokers
Association 2011
ALL RIGHTS RESERVED



CBA Form ST_LS
Single Tenant Gross Lease
Rev. 1/2011
Page 14 of 22

LEASE AGREEMENT
(Single Tenant - Gross Lease)

30. HAZARDOUS MATERIAL. As used herein, the term "Hazardous Material" means any hazardous, dangerous, toxic or harmful substance, material or waste including biomedical waste which is or becomes regulated by any local governmental authority, the State of Washington or the United States Government, due to its potential harm to the health, safety or welfare of humans or the environment. Landlord represents and warrants to Tenant that, to Landlord's knowledge without duty of investigation, there is no Hazardous Material on, in, or under the Premises as of the Commencement Date except as may otherwise have been disclosed to Tenant in writing before the execution of this Lease. If there is any Hazardous Material on, in, or under the Premises as of the Commencement Date which has been or thereafter becomes unlawfully released through no fault of Tenant, then Landlord shall indemnify, defend and hold Tenant harmless from any and all claims, judgments, damages, penalties, fines, costs, liabilities or losses including without limitation sums paid in settlement of claims, attorneys' fees, consultant fees and expert fees, incurred or suffered by Tenant either during or after the Lease term as the result of such contamination.

Tenant shall not cause or permit any Hazardous Material to be brought upon, kept, or used in or about, or disposed of on the Premises by Tenant, its employees, officers, agents, servants, contractors, customers, clients, visitors, guests, or other licensees or invitees, except with Landlord's prior consent and then only upon strict compliance with all applicable federal, state and local laws, regulations, codes and ordinances. If Tenant breaches the obligations stated in the preceding sentence, then Tenant shall indemnify, defend and hold Landlord harmless from any and all claims, judgments, damages, penalties, fines, costs, liabilities or losses including, without limitation, diminution in the value of the Premises; damages for the loss or restriction on use of rentable or usable space or of any amenity of the Premises, or elsewhere; damages arising from any adverse impact on marketing of space at the Premises; and sums paid in settlement of claims, attorneys' fees, consultant fees and expert fees incurred or suffered by Landlord either during or after the Lease term. These indemnifications by Landlord and Tenant include, without limitation, costs incurred in connection with any investigation of site conditions or any clean-up, remedial, removal or restoration work, whether or not required by any federal, state or local governmental agency or political subdivision, because of Hazardous Material present in the Premises, or in soil or ground water on or under the Premises. Tenant shall immediately notify Landlord of any inquiry, investigation or notice that Tenant may receive from any third party regarding the actual or suspected presence of Hazardous Material on the Premises.

Without limiting the foregoing, if the presence of any Hazardous Material brought upon, kept or used in or about the Premises by Tenant, its employees, officers, agents, servants, contractors, customers, clients, visitors, guests, or other licensees or invitees, results in any unlawful release of any Hazardous Material on the Premises, Tenant shall promptly take all actions, at its sole expense, as are necessary to return the Premises or any other property, to the condition existing prior to the release of any such Hazardous Material; provided that Landlord's approval of such actions shall first be obtained, which approval may be withheld at Landlord's sole discretion. The provisions of this Section shall survive expiration or termination of this Lease.

31. QUIET ENJOYMENT. So long as Tenant pays the Rent and performs all of its obligations in this Lease, Tenant's possession of the Premises will not be disturbed by Landlord or anyone claiming by, through or under Landlord.

32. MERGER. The voluntary or other surrender of this Lease by Tenant, or a mutual cancellation thereof, shall not work a merger and shall, at the option of Landlord, terminate all or any existing subtenancies or may, at the option of Landlord, operate as an assignment to Landlord of any or all of such subtenancies.

LEASE AGREEMENT
(Single Tenant - Gross Lease)

33. GENERAL.

- a. **Heirs and Assigns.** This Lease shall apply to and be binding upon Landlord and Tenant and their respective heirs, executors, administrators, successors and assigns.
- b. **Brokers' Fees.** Tenant represents and warrants to Landlord that except for Tenant's Broker, if any, described and disclosed in Section 35 of this Lease, it has not engaged any firm, finder or other person who would be entitled to any commission or fees for the negotiation, execution or delivery of this Lease and shall indemnify and hold harmless Landlord against any loss, cost, liability or expense incurred by Landlord as a result of any claim asserted by any such firm, finder or other person on the basis of any arrangements or agreements made or alleged to have been made by or on behalf of Tenant. Landlord represents and warrants to Tenant that except for Landlord's Broker, if any, described and disclosed in Section 35, it has not engaged any firm, finder or other person who would be entitled to any commission or fees for the negotiation, execution or delivery of this Lease and shall indemnify and hold harmless Tenant against any loss, cost, liability or expense incurred by Tenant as a result of any claim asserted by any such firm, finder or other person on the basis of any arrangements or agreements made or alleged to have been made by or on behalf of Landlord.
- c. **Entire Agreement.** This Lease contains all of the covenants and agreements between Landlord and Tenant relating to the Premises. No prior or contemporaneous agreements or understanding pertaining to the Lease shall be valid or of any force or effect and the covenants and agreements of this Lease shall not be altered, modified or amended to except in writing signed by Landlord and Tenant.
- d. **Severability.** Any provision of this Lease which shall prove to be invalid, void or illegal shall in no way affect, impair or invalidate any other provision of this Lease.
- e. **Force Majeure.** Time periods for either party's performance under any provisions of this Lease (excluding payment of Rent) shall be extended for periods of time during which the party's performance is prevented due to circumstances beyond such party's control, including without limitation, fires, floods, earthquakes, lockouts, strikes, embargoes, governmental regulations, acts of God, public enemy, war or other strife.
- f. **Governing Law.** This Lease shall be governed by and construed in accordance with the laws of the State of Washington.
- g. **Memorandum of Lease.** Neither this Lease nor any memorandum or "short form" thereof shall be recorded without Landlord's prior consent.
- h. **Submission of Lease Form Not an Offer.** One party's submission of this Lease to the other for review shall not constitute an offer to lease the Premises. This Lease shall not become effective and binding upon Landlord and Tenant until it has been fully signed by both of them.
- i. **Authority of Parties.** Each party signing this Lease represents and warrants to the other that it has the authority to enter into this Lease, that the execution and delivery of this Lease has been duly authorized, and that upon such execution and delivery this Lease shall be binding upon and enforceable against the party on signing.



Better Properties Real Estate
6223 Mt. Tacoma Dr SW
Lakewood, WA 98499
Phone: 253-589-2680
Fax: 253-589-2668

© Commercial Brokers
Association 2011
ALL RIGHTS RESERVED



CBA Form ST_LS
Single Tenant Gross Lease
Rev. 1/2011
Page 16 of 22

LEASE AGREEMENT
(Single Tenant - Gross Lease)

j. **Time.** "Day" as used herein means a calendar day and "business day" means any day on which commercial banks are generally open for business in the state where the Premises are situated. Any period of time which would otherwise end on a non-business day shall be extended to the next following business day. Time is of the essence of this Lease.

34. EXHIBITS AND RIDERS. The following exhibits and riders are made a part of this Lease, and the terms thereof shall control over any inconsistent provision in the sections of this Lease:

Exhibit A: Legal Description of the Premises
Exhibit B: Tenant Improvement Schedule

CHECK THE BOX FOR ANY OF THE FOLLOWING THAT WILL APPLY. CAPITALIZED TERMS USED IN THE RIDERS SHALL HAVE THE MEANING GIVEN TO THEM IN THE LEASE.

- ☐ Rent Rider
- ☐ Arbitration Rider
- ☐ Letter of Credit Rider
- ☐ Guaranty of Tenant's Lease Obligations Rider
- ☐ Option to Extend Rider

35. AGENCY DISCLOSURE. At the signing of this Lease,

Landlord is represented by _____ (insert name of Broker and Firm as licensed) (the "Landlord's Broker");

and Tenant is represented by _____ (insert name of Broker and Firm as licensed) (the "Tenant's Broker").

This Agency Disclosure creates an agency relationship between Landlord, Landlord's Broker (if any such person is disclosed), and any managing brokers who supervise Landlord's Broker's performance (collectively the "Supervising Brokers"). In addition, this Agency Disclosure creates an agency relationship between Tenant, Tenant's Broker (if any such person is disclosed), and any managing brokers who supervise Tenant's Broker's performance (also collectively the "Supervising Brokers"). If Tenant's Broker and Landlord's Broker are different real estate licensees affiliated with the same Firm, then both Tenant and Landlord confirm their consent to that Firm and both Tenant's and Landlord's Supervising Brokers acting as dual agents. If Tenant's Broker and Landlord's Broker are the same real estate licensee who represents both parties, then both Landlord and Tenant acknowledge that the Broker, his or her Supervising Brokers, and his or her Firm are acting as dual agents and hereby consent to such dual agency. If Tenant's Broker, Landlord's Broker, their Supervising Brokers, or their Firm are dual agents, Landlord and Tenant consent to Tenant's Broker, Landlord's Broker and their Firm being compensated based on a percentage of the rent or as otherwise disclosed on an attached addendum. Neither Tenant's Broker, Landlord's Broker nor either of their Firms are receiving compensation from more than one party to this transaction unless otherwise disclosed on an attached addendum, in which case Landlord and Tenant consent to such compensation. Landlord and Tenant confirm receipt of the pamphlet entitled "The Law of Real Estate Agency."

36. COMMISSION AGREEMENT. If Landlord has not entered into a listing agreement (or other compensation agreement with Landlord's Broker), Landlord agrees to pay a commission to Landlord's Broker (as identified in the Agency Disclosure paragraph above) as follows:



Better Properties Real Estate
6223 Mt. Tacoma Dr SW
Lakewood, WA 98499
Phone: 253-589-2680
Fax: 253-589-2668

© Commercial Brokers
Association 2011
ALL RIGHTS RESERVED



CBA Form ST_LS
Single Tenant Gross Lease
Rev. 1/2011
Page 17 of 22

LEASE AGREEMENT
(Single Tenant - Gross Lease)

☐ \$ _____
☐ _____ % of the gross rent payable pursuant to the Lease
☐ \$ _____ per square foot of the Premises
☐ Other _____

B.V.H.T.

Landlord's Broker ☐ shall ☐ shall not (shall not if not filled in) be entitled to a commission upon the extension by Tenant of the Lease term pursuant to any right reserved to Tenant under the Lease calculated ☐ as provided above or ☐ as follows _____ (if no box is checked, as provided above). Landlord's Broker ☐ shall ☐ shall not (shall not if not filled in) be entitled to a commission upon any expansion of the Premises pursuant to any right reserved to Tenant under the Lease, calculated ☐ as provided above or ☐ as follows _____ (if no box is checked, as provided above).

Any commission shall be earned upon execution of this Lease, and paid one-half upon execution of the Lease and one-half upon occupancy of the Premises by Tenant. Landlord's Broker shall pay to Tenant's Broker (as identified in the Agency Disclosure paragraph above) the amount stated in a separate agreement between them or, if there is no agreement, \$ _____ or _____ % (complete only one) of any commission paid to Landlord's Broker, within five (5) days after receipt by Landlord's Broker.

If any other lease or sale is entered into between Landlord and Tenant pursuant to a right reserved to Tenant under the Lease, Landlord ☐ shall ☐ shall not (shall not if not filled in) pay an additional commission according to any commission agreement or, in the absence of one, according to the commission schedule of Landlord's Broker in effect as of the execution of this Lease. Landlord's successor shall be obligated to pay any unpaid commissions upon any transfer of this Lease and any such transfer shall not release the transferor from liability to pay such commissions.



Better Properties Real Estate
6223 Mt. Tacoma Dr SW
Lakewood, WA 98499
Phone: 253-589-2680
Fax: 253-589-2668

© Commercial Brokers
Association 2011
ALL RIGHTS RESERVED
CBA Form ST_LS
Single Tenant Gross Lease
Rev. 1/2011
Page 18 of 22



LEASE AGREEMENT
(Single Tenant - Gross Lease)

37. **BROKER PROVISIONS:** LANDLORD'S BROKER, TENANT'S BROKER AND THEIR FIRMS HAVE MADE NO REPRESENTATIONS OR WARRANTIES CONCERNING THE PREMISES, THE MEANING OF THE TERMS AND CONDITIONS OF THIS LEASE, LANDLORD'S OR TENANT'S FINANCIAL STANDING, ZONING, COMPLIANCE OF THE PREMISES WITH APPLICABLE LAWS, SERVICE OR CAPACITY OF UTILITIES, OPERATING COSTS, OR HAZARDOUS MATERIALS. LANDLORD AND TENANT ARE EACH ADVISED TO SEEK INDEPENDENT LEGAL ADVICE ON THESE AND OTHER MATTERS ARISING UNDER THIS LEASE.

IN WITNESS WHEREOF this Lease has been executed the date and year first above written.



LANDLORD:

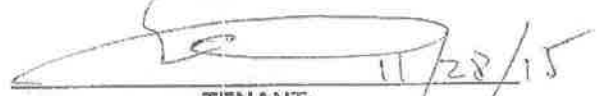

TENANT:

LANDLORD:

TENANT:



BY:



BY:

ITS:

ITS:



Better Properties Real Estate
6223 Mt. Tacoma Dr SW
Lakewood, WA 98499
Phone: 253-589-2680
Fax: 253-589-2668

© Commercial Brokers
Association 2011
ALL RIGHTS RESERVED



CBA Form ST_LS
Single Tenant Gross Lease
Rev. 1/2011
Page 19 of 22

LEASE AGREEMENT
(Single Tenant - Gross Lease)

STATE OF WASHINGTON

COUNTY OF _____

ss.

I certify that I know or have satisfactory evidence that _____ is the person who appeared before me and said person acknowledged that _____ signed this instrument, on oath stated that _____ was authorized to execute the instrument and acknowledged it as the _____ of _____ to be the free and voluntary act of such party for the uses and purposes mentioned in the instrument.

Dated this _____ day of _____, 20__.

(Signature of Notary)

(Legibly Print or Stamp Name of Notary)
Notary public in and for the state of Washington,
residing at _____
My appointment expires _____

STATE OF WASHINGTON

COUNTY OF _____

ss.

I certify that I know or have satisfactory evidence that _____ is the person who appeared before me and said person acknowledged that _____ signed this instrument, on oath stated that _____ was authorized to execute the instrument and acknowledged it as the _____ of _____ to be the free and voluntary act of such party for the uses and purposes mentioned in the instrument.

Dated this _____ day of _____, 20__.

(Signature of Notary)

(Legibly Print or Stamp Name of Notary)
Notary public in and for the state of Washington,
residing at _____
My appointment expires _____



Better Properties Real Estate
6223 Mt. Tacoma Dr SW
Lakewood, WA 98499
Phone: 253-589-2680
Fax: 253-589-2668

© Commercial Brokers
Association 2011
ALL RIGHTS RESERVED



CBA Form ST_LS
Single Tenant Gross Lease
Rev. 1/2011
Page 20 of 22

LEASE AGREEMENT
(Single Tenant - Gross Lease)

STATE OF WASHINGTON

COUNTY OF _____

ss.

I certify that I know or have satisfactory evidence that _____ is the person who appeared before me and said person acknowledged that _____ signed this instrument, on oath stated that _____ was authorized to execute the instrument and acknowledged it as the _____ of _____ to be the free and voluntary act of such party for the uses and purposes mentioned in the instrument.

Dated this _____ day of _____, 20__.

(Signature of Notary)

(Legibly Print or Stamp Name of Notary)
Notary public in and for the state of Washington,
residing at _____
My appointment expires _____

STATE OF WASHINGTON

COUNTY OF _____

ss.

I certify that I know or have satisfactory evidence that _____ is the person who appeared before me and said person acknowledged that _____ signed this instrument, on oath stated that _____ was authorized to execute the instrument and acknowledged it as the _____ of _____ to be the free and voluntary act of such party for the uses and purposes mentioned in the instrument.

Dated this _____ day of _____, 20__.

(Signature of Notary)

(Legibly Print or Stamp Name of Notary)
Notary public in and for the state of Washington,
residing at _____
My appointment expires _____



Better Properties Real Estate
6223 Mt. Tacoma Dr SW
Lakewood, WA 98499
Phone: 253-589-2680
Fax: 253-589-2668

© Commercial Brokers
Association 2011
ALL RIGHTS RESERVED



CBA Form ST_LS
Single Tenant Gross Lease
Rev. 1/2011
Page 21 of 22

LEASE AGREEMENT
(Single Tenant - Gross Lease)

EXHIBIT A

[Legal Description of the Premises]

POR GL 2 SEC 10 TGW POR GL 7 SEC 11 DAF - BEG 595.26 FT E & 165 FT N OF SW COR GL 2 TH
N 33-30-00 E 364.58 FT TH W 508.86 FT M/L TO E LN CO RD TH SWLY & SLY ALG SD E MGN CO
RD TO PT W OF TPOB TH E TO TPOB PLAT BLOCK: PLAT LOT:

Handwritten signature and initials: "B.L." and "H.T."

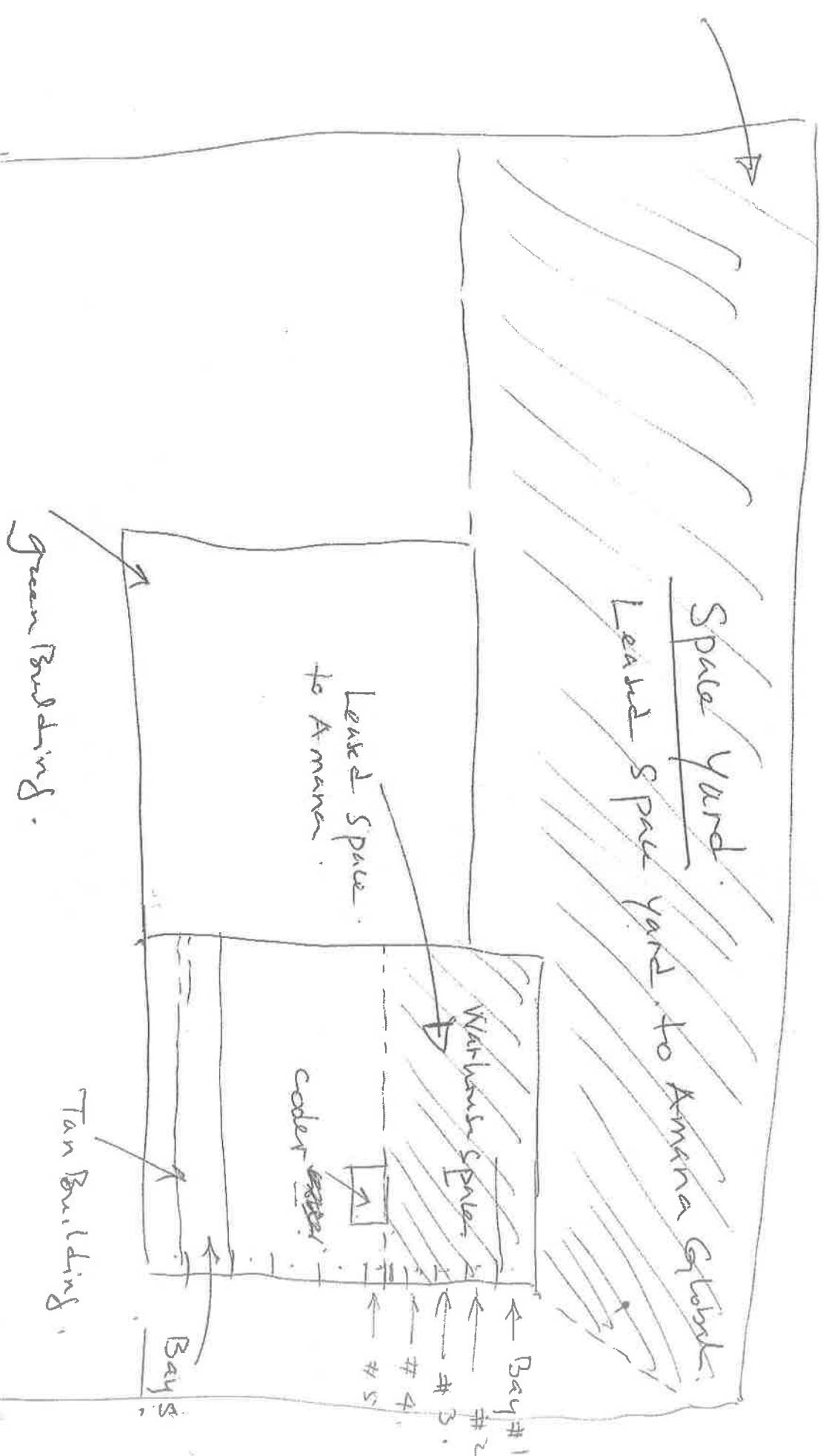

22230 Russell Rd.
 Kent 98032
 Russell Road

* Landlord: Noble Pacific Enterprises LLC
 * Tenant: Hafid Taherou
 Amana

Exhibit B

ADDENDUM TO LEASE AGREEMENT

The following is part of the commercial lease agreement dated November 28, 2015, between Noble Pacific Enterprises LLC ('Landlord'), and Amana Global Company ('Tenant'), regarding the leased premises located at 22230 Russell Road Kent, WA 98032.

IT IS AGREED BETWEEN THE LANDLORD AND TENANT AS FOLLOWS:

1. Leased Premises. The leased commercial real estate i) consists of an agreed area of approximately 9000 square feet warehouse space inside the "Tan color building" and the backyard space behind both the "Green color" and the "Tan color" buildings. The total rentable square feet space is outlined on the floor plan attached hereinto as Exhibit B (the "Premises"); ii) is located on the land legally described on attached Exhibit A; and iii) is commonly known as 22230 Russell Road Kent WA 98032.

2. Gross Rent. The gross monthly rent shall be \$4,500.00. Rent shall be payable at Landlord's address. The gross rent includes the triple net (NNN).

3. One Month Free Rent. Tenant will install concrete pad in the backyard at tenant own cost in order to receive one month free rent on January 2021.

4. Access to the Back of the Green Building: The Tenant will provide access to the landlord through the back yard to the green building.

5. Utilities and Services. The Landlord is responsible for the payment of the following utilities and other charges in relation to the Premises: electricity, natural gas, water and sewer. The Tenant is responsible for paying his own charges related to telephone, Internet and cable.

6. Rent

i). Payment of Rent. Tenant shall pay Landlord without notice or demand the monthly gross rent on or before the first day of each month during the Lease term.

ii). Late Charges; Default Interest. If tenant gross rent is not paid by (5) business days after their due date, Tenant shall pay Landlord an amount equal to the greater of \$100 or five percent (5%) of the delinquent amount.

7. Permitted use. The Premises shall be used only for warehousing and wholesale distribution and repair of industrial equipments and for no other purpose without the prior written consent of Landlord and such written consent shall not be unreasonably withheld, conditioned, or delayed.

11-11-15
R.L.

8. Commons Areas.

i). **Definition.** The term "Common Areas" means all areas, facilities and building systems that are provided and designated from time to time by Landlord for the general non-exclusive use and convenience of Tenant with other tenants and which are not leased or held for the exclusive use of particular tenant. To the extent that such areas and facilities exist within the Property, Common Areas include hallways, Entryways, stairs, elevators, driveways, walkways, terraces, docks, loading areas, restrooms, trash facilities, parking areas and garages, roadways, pedestrian sidewalks, landscaped areas, security areas, lobby or mall areas, common heating, ventilating and air conditioning systems, common electrical service, equipment and facilities, and common mechanical systems, equipment and facilities. Tenant shall comply with reasonable rules and regulations concerning the use of the common Areas adopted by Landlord from time to time.

ii). **Use of the Common Areas.** Tenant shall have the non-exclusive right, in common with such other tenants to whom Landlord has granted or may grant such rights, to use the Common Areas. Tenant shall have around the clock and unlimited access to use the common area.

9. Assignment and Subletting.

Tenant shall not assign, sublet, mortgage, encumber or otherwise transfer any interest in this Lease (collectively referred to as a "Transfer") or any part of the premises, without first obtaining Landlord's written consent, which shall not be unreasonably withheld, conditioned, or delayed.

10. Hazardous Material.

Tenant shall not cause or permit any Hazardous Material to be brought upon, kept, or used in or about, or disposed of on the Premises or the Property by Tenant, its employees, officers, agents, servants, contactors, customers, clients, visitors, guests, or other licensees or invitees, except with Landlord's prior consent and then only upon strict compliance with all applicable federal, state and local laws, regulations, codes and ordinances.

11. Insurance.

Tenant shall only pay for and maintain \$2,000,000 commercial General liability insurance during the term of this lease agreement and shall name Landlord as additional insured. No other insurance coverage shall be required from tenant.

12. Compliance with Laws. Tenant shall comply with all laws and regulations regarding the use of its premises. Tenant's breach of this section of lease (which is paragraph 7 at page 4) shall not constitute a breach of this lease agreement.

13. **Alterations.** Tenant shall not be required to hire a contractor to perform alterations in the premises as long as said alterations comply with all laws and regulations.

14. **Holdover.** If Landlord is entitled to double amount of the rent, under Washington law eviction process, when the tenant is holdover without the permission of the landlord, then, tenant shall only pay to landlord 100% (not 150% as indicated in paragraph 23 at page 13) of the rate of rental last payable under this lease.

15. Tenant shall not leave anything in the common area more than 24 hours. Anything left by the tenant in the common area more than 24 hours will be moved away at landlord discretion.

11/28/2015
DATE

11/28/2015
DATE

Noble Pacific Enterprises, LLC
LANDLORD

Aman Global
TENANT

[Signature]
BY

[Signature]
BY

HIT
[Signature]

LEASE AGREEMENT

THIS LEASE AGREEMENT (the "Lease") is entered into and effective as of December 31, 2015, between Noble Pacific Enterprises LLC ('Landlord') & Amana Global Company (Tenant'). Landlord and Tenant agree as follows:

LEASE SUMMARY,

- 1- The leased premises consist of approximately 2500 square feet warehouse space which include 1 bay (which is the 4th bay) and section of the 5th bay behind the cooler inside the "Tan color" building, and the outdoor back yard space of said building (see attached exhibit A for specific description).
- 2- The gross rent is \$1,100 per month include all utilities.
- 3- Tenant will provide access to the landlord through the back yard to the green building.
- 4- The term of this lease start December 31, 2015, and end August 31, 2016.
- 5- This lease agreement is effective as of today date of Dec 31, 2015.

12/31/15
DATE

12/31/15
DATE

Noble Pacific Enterprises LLC
LANDLORD

Amana Global
TENANT

[Signature]
BY

[Signature]
BY

Exhibit A

Landlord: Arto
Tenant: Arto

12/31/15
Hole Pacific Enterprises, LLC
Arman Global
12/31/15

Yard Space
Back
(Rented premises)

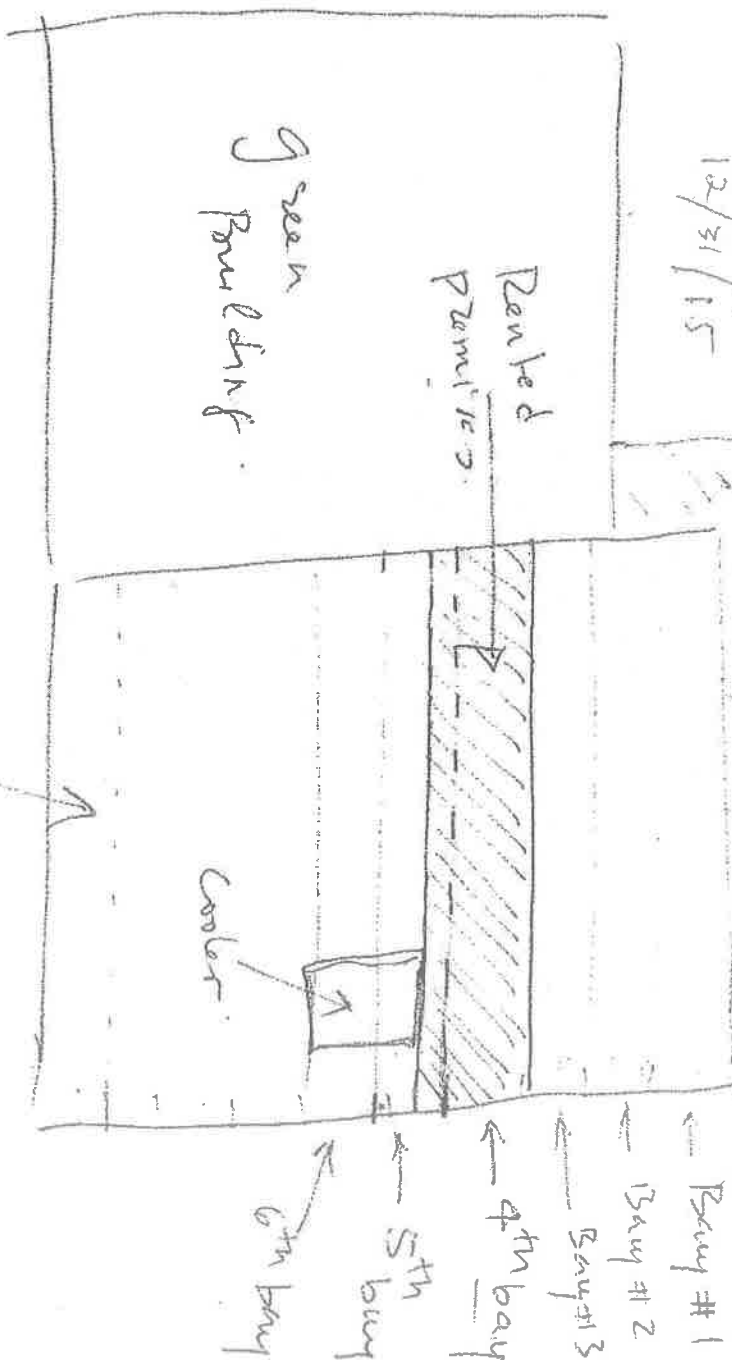

Arto

22230 Bushell Rd Kent 98032