

**SAMMAMISH PLATEAU WATER
AND SEWER DISTRICT**

**SEWER ANNEXATION
NE 1ST & JUNIPER AREA (WELL 9)**

MARCH 7TH, 2022

THAT PORTION OF THE NORTHWEST QUARTER OF SECTION 27, TOWNSHIP 24 NORTH,
RANGE 6 EAST, W.M., IN KING COUNTY, WASHINGTON, DESCRIBED AS FOLLOWS:

BEGINNING AT THE NORTHEAST CORNER OF THE SOUTHWEST QUARTER OF THE
NORTHWEST QUARTER OF SAID SECTION 27, ALSO BEING THE INTERSECTION OF THE
NORTHERLY RIGHT OF WAY MARGIN OF NE LOCUST ST (JORDAN AVE) WITH THE EASTERLY
RIGHT OF WAY MARGIN OF 3RD AVE NE (ALDER ST) AS SHOWN ON HERBERT S. UPPER'S
FIRST ADDITION TO ISSAQUAH ACCORDING TO THE PLAT THEREOF AS RECORDED IN
VOLUME 12 OF PLATS, PAGE 13; THENCE SOUTHERLY ALONG SAID EASTERLY RIGHT OF
WAY MARGIN TO THE INTERSECTION OF SAID EAST LINE WITH THE EASTERLY EXTENSION
OF THE SOUTHERLY RIGHT OF WAY MARGIN OF NE JUNIPER STREET (MELROSE AVE);
THENCE WESTERLY ALONG SAID SOUTHERLY RIGHT OF WAY MARGIN TO THE
NORTHEASTERLY RIGHT OF WAY MARGIN OF SR 90; THENCE NORTHWESTERLY ALONG
THE NORTHEASTERLY RIGHT OF WAY MARGIN TO THE SOUTHWESTERLY CORNER OF THE
SOUTH 60 FEET OF THE NORTH 120 FEET LESS ROADS, LOT 5, BLOCK 4, HERBERT S.
UPPER'S FIRST ADDITION TO ISSAQUAH; THENCE NORTHWESTERLY ALONG THE WEST
LINE THEREOF AND THE WEST LINE OF PARCEL C OF IS LLA 16-00005 RECORDED UNDER
RECORDING NUMBER 20160726900008 TO THE INTERSECTION OF THE NORTHWESTERLY
EXTENSION OF SAID WEST LINE WITH THE WESTERLY EXTENSION OF THE NORTHERLY
RIGHT OF WAY MARGIN OF NE LOCUST ST; THENCE EASTERLY ALONG SAID EXTENSION TO
THE POINT OF BEGINNING.

CONTAINING 12 ACRES, MORE OR LESS.

WRITTEN BY: VVB
CHECKED BY: CPC



03/07/22



**DAVID EVANS
AND ASSOCIATES INC.**

20300 Woodinville Snohomish Rd NE
Suite A | Woodinville, WA 98072
p: 425.415.2000
f: 425.486.5059
deainc.com

NW 1/4 SEC. 27, TWP. 24N., RGE. 6E

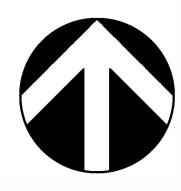
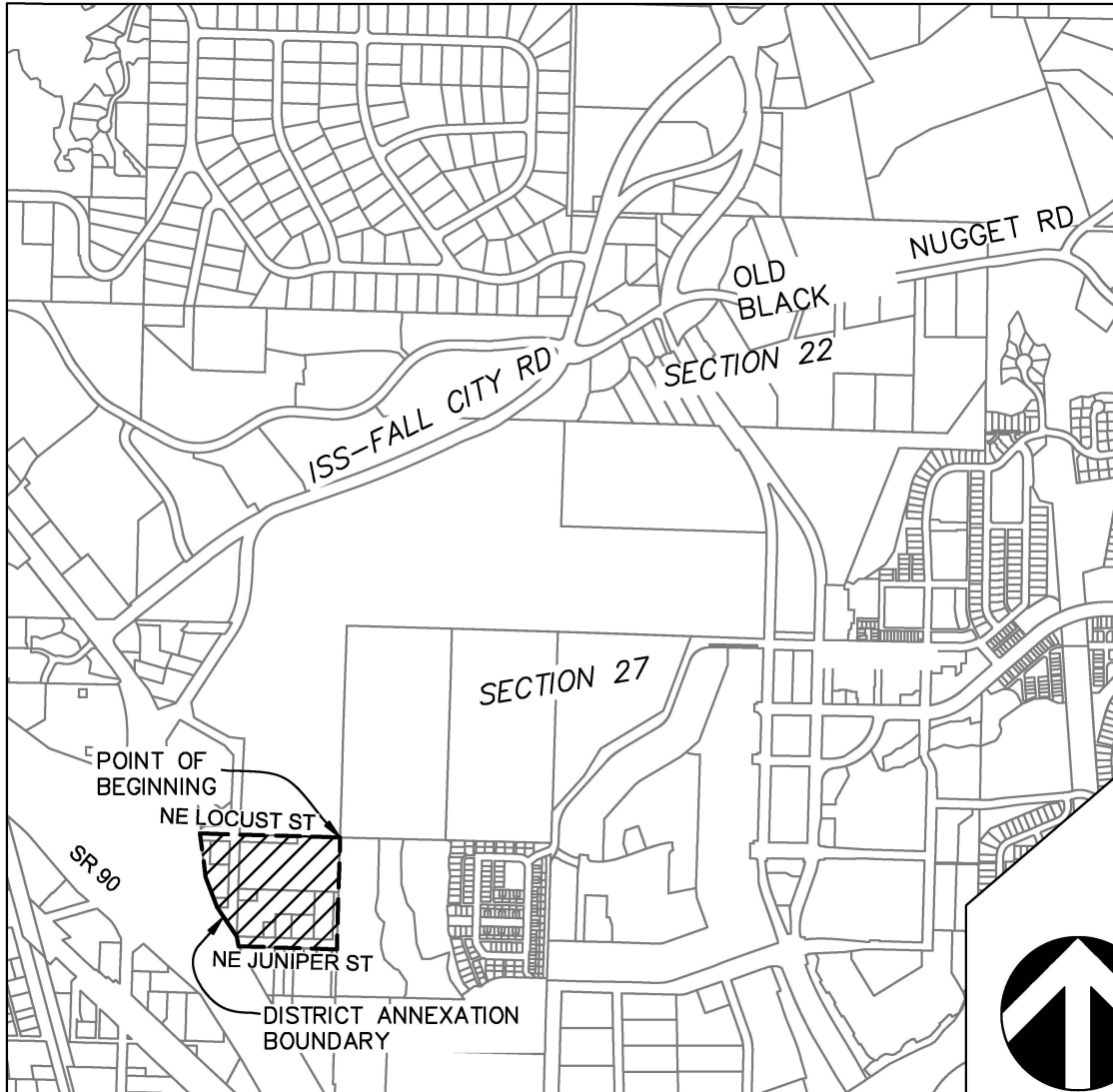

THIS EXHIBIT HAS BEEN PREPARED TO ASSIST IN THE INTERPRETATION OF THE ACCOMPANYING LEGAL DESCRIPTION. IF THERE IS A CONFLICT BETWEEN THE WRITTEN LEGAL DESCRIPTION AND THIS SKETCH, THE LEGAL DESCRIPTION SHALL PREVAIL.



**DAVID EVANS
AND ASSOCIATES INC.**
20300 Woodinville Snohomish Rd NE
Suite A - Woodinville, WA 98072
Phone: 425.415.2000