

9

18120

passed
9-0

R Dem →

9/21/15

S1

ea

Sponsor: Lambert

Proposed No.: 2015-0278

STRIKING AMENDMENT TO PROPOSED ORDINANCE 2015-0278, VERSION

1

On page 1, beginning on line 7, strike everything through page 4, line 55, and insert:

"STATEMENT OF FACTS:

1. Chapter 87.03 RCW authorizes the formation of an irrigation district for the purpose of irrigation of land.

2. RCW 87.03.019 allows irrigation districts to participate in and expend revenue on cooperative watershed management actions, for the purposes of water supply, water quality and water resource and habitat protection and management.

3. To initiate the formation of an irrigation district, a petition signed by the requisite number of property owners and containing the information required by RCW 87.03.020 shall be presented to the county legislative authority, together with a bond in a sum double the amount of the probable cost of organizing the proposed district.

4. On June 30, 2015, a petition, accompanied by a cash bond, was filed with the King County council requesting that necessary steps be taken to

18 organize an irrigation district in King County to be known as the
19 Snoqualmie Valley watershed improvement district.

20 5. Subsequent to filing the petition, petitioners requested the council
21 correct the petition by modifying the legal description and adding
22 additional nominations for initial board members, and petitioners provided
23 the council a list of parcels to be included within the boundaries of the
24 district, including acreage, tax parcel number, an address and an owner's
25 name. Included on that list are parcels owned by King County. The
26 corrected petition is Attachment A to this ordinance.

27 6. In accordance with the terms of the petition, property owned by
28 governmental entities and parcels of less than two acres are to be excluded
29 from the proposed district and therefore owners of such properties shall
30 not be eligible to vote in the election of whether an irrigation district shall
31 be formed and for the election of the directors.

32 7. The parcel list provided by the petitioners was updated with current
33 information, including taxpayer name and address and parcel size
34 provided by the department of assessments. The parcel list was also
35 modified to remove government-owned parcels and parcels less than two
36 acres in size. The updated parcel list is Attachment B to this ordinance.

37 8. Subsequent to filing the corrected petition, one person requested in
38 writing to be removed from the nominations for initial board members.

39 9. The petitioners complied with RCW 87.03.001 and chapter 36.93 RCW
40 and the petitioners filed a notice of intention to the boundary review board

41 on August 4, 2015. As part of the review by the boundary review board,
42 the petitioners filed an updated legal description for the boundaries of the
43 proposed district. The updated legal description is Attachment C to this
44 ordinance. The proposed action of creating the irrigation district was
45 deemed approved by the boundary review board on September 17, 2015.

46 10. Once the district is created, the processes in chapter RCW 87.03 shall
47 apply to any petition to add or exclude parcels from the district.

48 BE IT ORDAINED BY THE COUNCIL OF KING COUNTY:

49 SECTION 1. The corrected petition requesting organization of the Snoqualmie
50 Valley watershed improvement district, Attachment A to this ordinance, is hereby
51 accepted as presented.

52 SECTION 2. A cash bond, in a sum double the amount of the probable cost of
53 organizing the proposed irrigation district, is hereby accepted as sufficient.

54 SECTION 3. The proposed irrigation district shall be known as the Snoqualmie
55 Valley watershed improvement district.

56 SECTION 4. The boundaries of the proposed district shall be as set forth in
57 Attachment C to this ordinance.

58 SECTION 5. The ballot shall reflect the nominees for the initial board members
59 as shown in Attachment A to this ordinance, except that Steven Van Ess shall not be
60 included as a nominee.

61 SECTION 6. The parcel list, Attachment B to this ordinance, shall be used by the
62 clerk of the council as the list of eligible voters owning qualifying property under the

63 petition for the election of whether an irrigation district shall be formed and for the
64 election of the directors.

65 SECTION 7. The election shall be carried out in the manner detailed in
66 Attachment D to this ordinance and in accordance with chapter 87.03 RCW. The election
67 date of November 24, 2015, is hereby set."

68

69 Delete Attachment B, Parcel List, and insert Attachment B, Parcel List revised September
70 21, 2015

71

72 Delete Attachment C, Election Process, and insert Attachment C, Legal Description
73 revised September 21, 2015

74

75 Insert Attachment D, Election Process revised September 21, 2015

76

77 **EFFECT: Adds statements of fact regarding changes made to the petition**
78 **subsequent to filing; directs removal of one board member nominee; revises the**
79 **election date; and attaches an updated parcel list, legal description and election**
80 **process.**

Parcel List

Attachment B
Revised September 21, 2015

Parcel No.	Situs Address	TaxpayerName	AttnLine	HouseNbr	DirPrefix	Street	Street Type	DirSuffix	City	State	ZipCode	LotSize SQFT	LotSize Acres
0824079078	29826 SE ISSAQUAH-FALL CITY RD 98024	4J WA FARM LLC		29826	SE	ISSA-FALL CITY	RD		FALL CITY	WA	98024	231303	5.310
0824079077		4J WA FARMS LLC		29826	SE	ISSA-FALL CITY	RD		FALL CITY	WA	98024	378972	8.700
0626079013		ABACULO LLC		8421	SE	47TH	ST		MERCER ISLAND	WA	98040	771012	17.700
1226069010		ABACULO LLC		8421	SE	47TH	ST		MERCER ISLAND	WA	98040	872942	20.040
0726079032		ABACULO LLC		8421	SE	47TH	ST		MERCER ISLAND	WA	98040	1475377	33.870
0626079016	19228 DUVALL-MONROE RD NE 98019	ABACULO LLC		8421	SE	47TH	ST		MERCER ISLAND	WA	98040	3234330	74.250
3325079029	516 WEST SNOQUALMIE RIVER RD SE 98014	ABRAM JAMES L+ABRAM LYNN A		516	W	SNOQUALMIE RIVER	RD	SE	CARNATION	WA	98014	271829	6.240
2326069014	25529 NE 138TH ST 98019	ALLEN KERMIT+ALLEN LISA				P O BOX 22			DUVALL	WA	98019	1610413	36.970
0826079080	17015 300TH AVE NE 98019	ALLEN MARIAN B		17015		300TH	AVE	NE	DUVALL	WA	98019	95396	2.190
1024079012	3724 324TH AVE SE 98024	ALM IVAR R		3724		324TH	AVE	SE	FALL CITY	WA	98024	3255238	74.730
2825079034	1910 324TH WAY NE 98014	AMOS BOB D+DIANE		2012		FALL CITY-CARNATION	RD	NE	CARNATION	WA	98014	416433	9.560
1526069013	14920 W SNOQUALMIE VALLEY RD NE	ANDERSON MILES J		15617		212TH	AVE	NE	WOODINVILLE	WA	98077	147232	3.380
3126079014		ANDREWS DAVID		10721		296TH	AVE	NE	CARNATION	WA	98014	952221	21.860
3126079019		ANDREWS DAVID		10721		296TH AV		NE	CARNATION	WA	98014	1319868	30.300
3226079031		ANDREWS DAVID		10721		296TH AV		NE	CARNATION	WA	98014	1728025	39.670
0824079002		ANGRISANO ROBERT+MARGARET				P O BOX 1089			FALL CITY	WA	98024	217155	4.985
3626069018	27800 NE 100TH ST 98014	ARONZUA RICK				PO BOX 940			CARNATION	WA	98014	575305	13.207
2125079054	32010 NE 24TH ST 98014	ASTUTO JASON A		32010	NE	24TH	ST		CARNATION	WA	98014	122403	2.810
1724079031	30224 SE ISSAQUAH-FALL CITY RD 98024	AUFIERO COLLEEN		30224	SE	ISSAQUAH-FALL CITY	RD		FALL CITY	WA	98024	252578	5.798
0725079006		BAERWALD CATHRYN				PO BOX 418			CARNATION	WA	98014	867715	19.920
1524079031	4446 PRESTON-FALL CITY RD SE 98024	BALLESTRASSE ROY		4440		PRESTON FALL CITY	RD		FALL CITY	WA	98024	323215	7.420
1424079052		BALLESTRASSE ROY		4440		PRESTON FALL CITY	RD		FALL CITY	WA	98024	1764180	40.500
2324079045		BALLESTRASSE ROY A+PATRICIA		4440		PRESTON-FALL CITY	RD		FALL CITY	WA	98024	483951	11.110
1424079014	34518 SE DAVID POWELL RD 98024	BALLESTRASSE ROY A+PATRICIA		4440		PRESTON-FALL CITY	RD		FALL CITY	WA	98024	773190	17.750
1624079003	31918 SE 44TH ST 98024	BALLESTRASSE ROY+PATRICIA		4440		PRESTON FALL CITY	RD		FALL CITY	WA	98024	1616511	37.110
0726079036	28702 NE CHERRY VALLEY RD 98019	BALSER KENNETH E				PO BOX 422			DUVALL	WA	98019	952221	21.860
1524079002	33344 SE REDMOND-FALL CITY RD 98024	BARFUSE ULIS F				PO BOX 514			FALL CITY	WA	98024	142441	3.270
2125079045	2425 FALL CITY-CARNATION RD NE	BARRETT CAROL PACKWOOD		17410		87TH	AVE	SE	SNOHOMISH	WA	98296	104108	2.390
1724079024	30211 SE 40TH ST 98024	BEAR REBECCA K		30211	SE	40TH	ST		FALL CITY	WA	98024	321037	7.370
2825079060	1125 324TH WAY NE 98014	BEAUDETTE FREDERICA A+JULIA		1125		324TH WY		NE	CARNATION	WA	98014	129808	2.980
1226069030	17003 DUVALL-MONROE RD NE 98019	BELLAMY CAMERON		27916	NE	149TH	CT		DUVALL	WA	98019	331492	7.610
1426069030		BELLAMY RUTH COY		26808	NE	CHERRY VALLEY	RD		DUVALL	WA	98019	1156082	26.540
1426069009		BELLAMY RUTH COY		26808	NE	CHERRY VALLEY	RD		DUVALL	WA	98019	1524600	35.000
3126079036		BENNETT JOHN+JULIE		9922		284TH	AVE	NE	CARNATION	WA	98014	541886	12.440
0625079003	9922 284TH AVE NE 98014	BENNETT JOHN+JULIE		9922		284TH	AVE	NE	CARNATION	WA	98014	3851257	88.413
0325079018	7930 327TH AVE NE 98014	BENSON MATTHEW A	MCCLAIN JANA G	7930		327TH	AVE	NE	CARNATION	WA	98014	815878	18.730
1126069032	18203 WEST SNOQUALMIE VALLEY RD NE 98019	BERGLER PETER		18203	W	SNOQ VALLEY	RD	NE	DUVALL	WA	98019	450846	10.350
0424079015		BERT CARLSON FARMS INC		2344		NEAL ROAD	SE		FALL CITY	WA	98024	512173	11.758
0324079028	1841 FALL CITY-CARNATION RD SE 98024	BERT CARLSON FARMS INC		2344		NEAL ROAD	SE		FALL CITY	WA	98024	515750	11.840
0324079026		BERT CARLSON FARMS INC		2344		NEAL ROAD	SE		FALL CITY	WA	98024	518364	11.900
0324079029		BERT CARLSON FARMS INC		2344		NEAL ROAD	SE		FALL CITY	WA	98024	609840	14.000
0924079001	2412 NEAL RD SE 98024	BERT CARLSON FARMS INC		2344		NEAL ROAD	SE		FALL CITY	WA	98024	914760	21.000
0424079018	2220 NEAL RD SE 98024	BERT CARLSON FARMS INC		2344		NEAL ROAD	SE		FALL CITY	WA	98024	1531920	35.168
0424079017		BERT CARLSON FARMS INC		2344		NEAL ROAD	SE		FALL CITY	WA	98024	1640780	37.667
0424079020	2412 NEAL RD SE 98024	BERT CARLSON FARMS INC		2344		NEAL ROAD	SE		FALL CITY	WA	98024	1807304	41.490
0424079025		BERT CARLSON FARMS INC		2344		NEAL ROAD	SE		FALL CITY	WA	98024	2029562	46.592
2825079006	2111 FALL CITY-CARNATION RD NE 98014	BEVERIDGE NANCY	TRIM BONNIE	51		CABIN LANE			SELAH	WA	98942	2076995	47.681
2125079019		BEVERIDGE NANCY+TRIM BONNIE		51		CABIN	LN		SELAH	WA	98942	3709676	85.162
2925079047		BEYERS DAN		1550	W	SNOQUALMIE RIVER	RD	NE	CARNATION	WA	98014	292723	6.720
2925079056	1224 WEST SNOQUALMIE RIVER RD NE 98014	BEYERS DAN C		1550	W	SNOQUALMIE RIVER	RD		CARNATION	WA	98014	276267	6.342
2925079046	1550 WEST SNOQUALMIE RIVER RD NE 98014	BEYERS DAN C		1550	W	SNOQUALMIE RIVER	RD		CARNATION	WA	98014	900084	20.663
2825079017		BEYERS DAN C		1550	W	SNOQUALMIE RIVER	RD		CARNATION	WA	98014	2088256	47.940
0626079019		BIDERBOST DOROTHY J		20436		13TH	AVE	S	SEATAC	WA	98198	652509	14.980
0126069020		BIRUK SERGEY				PO BOX 1913			MILTON	WA	98354	3310560	76.000
0125069002	27411 100TH AVE NE 98014	BLAKELY MICHAEL A				PO BOX 997			CARNATION	WA	98014	1363314	31.297
1225069015	6911 WEST SNOQUALMIE VALLEY RD NE 98014	BLEGEN BENJAMIN D+JILL L		6911	W	SNOQUALMIE VALLEY	RD	NE	CARNATION	WA	98014	418047	9.597
1524079017	32925 SE 46TH ST 98024	BLUE HILL LLC				POB 338			FALL CITY	WA	98024	592436	13.600
0824079017	3208 300TH AVE SE 98024	BOEING EMPLOYEES CU		12770		GATEWAY	DR	S	TUKWILA	WA	98168	893846	20.520
0824079021		BOEING WILLIAM E JR		4020	E	MADISON	ST		SEATTLE	WA	98112	738778	16.960
0824079024	3515 308TH AVE SE 98024	BOEING WILLIAM E JR		4020	E	MADISON	ST		SEATTLE	WA	98112	1238411	28.430
2125079034		BOIS DENISE LEBEAU+ROBERT		2805		FALL CITY CARNATION	RD	NE	CARNATION	WA	98014	348480	8.000
2125079044	2805 FALL CITY-CARNATION RD NE 98014	BOIS DENISE LEBEAU+ROBERT		2805		FALL CITY-CARNATION	RD	NE	CARNATION	WA	98014	480456	11.030
1724079042		BOLSTER MARK S		30602	SE	ISSAQUAH-FALL CITY	RD		FALL CITY	WA	98024	183673	4.217

Parcel No.	Site Address	Taxpayer Name	Attn Line	House Nbr	Dir Prefix	Street	Street Type	Dir Suffix	City	State	Zip Code	Lot Size SQFT	Lot Size Acres
2925079026		BORDEN JUDITH		16749		ADDISON	ST		ENCINO	CA	91436	502246	11.530
2326069008	25530 NE 138TH ST 98019	BORDON V L		20023		GREENWOOD	AVE	N	SHORELINE	WA	98133	2357168	54.113
0924079022	31603 SE REDMOND FALL CITY RD 98024	BOSTWICK ROBERT H+SHARMA		31603	SE	REDMOND FALL CITY	RD		FALL CITY	WA	98024	531487	12.201
2925079039	1223 WEST SNOQUALMIE RIVER RD NE 98014	BOUDREAUX MICHAEL D		1223	W	SNOQUALMIE RIVER	RD	NE	CARNATION	WA	98014	246114	5.650
2424079025	36601 SE DAVID POWELL RD 98024	BREVICK DALE D		36601	SE	DAVID POWELL	RD		FALL CITY	WA	98024	315374	7.240
2424079064	35827 SE DAVID POWELL RD	BREVICK DALE D+KRISTINE J				36601-B SE DAVID POWELL	RD		FALL CITY	WA	98024	881218	20.230
2426069009		BURHEN RAYMOND C				PO BOX 6			DUVALL	WA	98019	477417	10.960
2426069007		BURHEN RAYMOND C				PO BOX 6			DUVALL	WA	98019	478724	10.990
2426069087		BURHEN RAYMOND C				PO BOX 6			DUVALL	WA	98019	541015	12.420
2426069010	13830 CARNATION+DUVALL RD NE 98019	BURHEN RAYMOND C				PO BOX 6			DUVALL	WA	98019	690426	15.850
2426069011	13820 CARNATION+DUVALL RD NE 98019	BURHEN RAYMOND C				PO BOX 6			DUVALL	WA	98019	1021046	23.440
2626069040	11630 WEST SNOQUALMIE VALLEY RD NE 98014	BURNS PATRICK T		2930		WESTLAKE	AVE	N	SEATTLE	WA	98109	1065478	24.460
2626069016	11622 WEST SNOQUALMIE VALLEY RD NE 98014	BURNS PATRICK T		2930		WESTLAKE	AVE	N	SEATTLE	WA	98109	1130382	25.950
2626069009	11616 WEST SNOQUALMIE VALLEY RD NE 98014	BURNS PATRICK T		2930		WESTLAKE	AVE	N	SEATTLE	WA	98109	1183525	27.170
2626069013	11608 WEST SNOQUALMIE VALLEY RD NE 98014	BURNS PATRICK T		2930		WESTLAKE	AVE	N	SEATTLE	WA	98109	1204869	27.660
2626069002		BURNS PATRICK T		2930		WESTLAKE	AVE	N	SEATTLE	WA	98109	1815580	41.680
2426069066		BURNS PATRICK T		2930		WESTLAKE	AVE	N	SEATTLE	WA	98109	1942776	44.600
2526069005	12814 CARNATION+DUVALL RD NE 98019	BURNS PATRICK T		2930		WESTLAKE	AVE	N	SEATTLE	WA	98109	2330460	53.500
0726079016	28510 NE CHERRY VALLEY RD 98019	CALDWELL BRANDON+HOLLY		28510	NE	CHERRY VALLEY	RD		DUVALL	WA	98019	622908	14.300
3226079014		CAMP KOREY		28901	NE	CARNATION FARM	RD		CARNATION	WA	98014	131115	3.010
3126079041		CAMP KOREY		28901	NE	CARNATION FARM	RD		CARNATION	WA	98014	306226	7.030
0525079009	28907 NE CARNATION FARM RD 98014	CAMP KOREY		28901	NE	CARNATION FARM	RD		CARNATION	WA	98014	1603879	36.820
0825079004		CAMP KOREY		28901	NE	CARNATION FARM	RD		CARNATION	WA	98014	1785933	40.999
0825079007	28901 NE CARNATION FARM RD 98014	CAMP KOREY		28901	NE	CARNATION FARM	RD		CARNATION	WA	98014	1787048	41.025
0825079029		CAMP KOREY		28901	NE	CARNATION FARM	RD		CARNATION	WA	98014	1787221	41.029
0825079030		CAMP KOREY		28901	NE	CARNATION FARM	RD		CARNATION	WA	98014	1787423	41.034
0825079028		CAMP KOREY		28901	NE	CARNATION FARM	RD		CARNATION	WA	98014	1789114	41.072
0825079003		CAMP KOREY		28901	NE	CARNATION FARM	RD		CARNATION	WA	98014	1795879	41.228
0825079002		CAMP KOREY		28901	NE	CARNATION FARM	RD		CARNATION	WA	98014	1807299	41.490
0825079031		CAMP KOREY		28901	NE	CARNATION FARM	RD		CARNATION	WA	98014	1814849	41.663
0825079032		CAMP KOREY		28901	NE	CARNATION FARM	RD		CARNATION	WA	98014	1837140	42.175
0825079010		CAMP KOREY		28901	NE	CARNATION FARM	RD		CARNATION	WA	98014	1847461	42.412
0825079033		CAMP KOREY		28901	NE	CARNATION FARM	RD		CARNATION	WA	98014	1902900	43.685
0525079016		CAMP KOREY		28901	NE	CARNATION FARM	RD		CARNATION	WA	98014	2740613	62.916
0625079001		CAMP KOREY		28901	NE	CARNATION FARM	RD		CARNATION	WA	98014	3118996	71.600
0625079021	29005 NE CARNATION FARM RD 98014	CAMP KOREY		28901	NE	CARNATION FARM	RD		CARNATION	WA	98014	3361089	77.160
0525079008	28919 NE CARNATION FARM RD 98014	CAMP KOREY		28901	NE	CARNATION FARM	RD		CARNATION	WA	98014	4139942	95.040
0324079011	2315 FALL CITY-CARNATION RD SE 98024	CARLSON BERTILJ + JUNE		35202	SE	DAVID POWELL	RD		FALL CITY	WA	98024	405979	9.320
3570100120	2520 FALL CITY-CARNATION RD NE 98014	CARLSON ROBERT B+MAUREEN P		2520		FALL CITY-CARNATION	RD	NE	CARNATION	WA	98014	426452	9.790
1525079005		CARNATION FIELDS LLC				PO BOX 177			CARNATION	WA	98014	273121	6.270
1525079010		CARNATION FIELDS LLC				PO BOX 177			CARNATION	WA	98014	291652	6.700
1525079049		CARNATION FIELDS LLC				PO BOX 177			CARNATION	WA	98014	566280	13.000
1526069037	14906 WEST SNOQUALMIE VALLEY RD NE 98019	CARTER GARY S+HAUGE ARNOLD		14906	W	SNOQUALMIE VALLEY	RD	N	DUVALL	WA	98019	90604	2.080
2925079058		CARTER KEVIN		5024		114TH	AVE	NE	KIRKLAND	WA	98033	442134	10.150
2925079059		CARTER KEVIN		5024		114TH	AVE	NE	KIRKLAND	WA	98033	442569	10.160
3225079001	722 WEST SNOQUALMIE RIVER RD NE 98014	CASEY DAVID W & LAURA C				PO BOX 1255			FALL CITY	WA	98024	285095	6.545
2925079040		CASEY DAVID+LAURA				PO BOX 1255			FALL CITY	WA	98024	206586	4.743
3225079028		CASEY DAVID+LAURA				PO BOX 1255			FALL CITY	WA	98024	281940	6.472
1426069010		CDI		4110		EATON	AVE		CALDWELL	ID	83607	1831262	42.040
1326069009		CDK INVESTMENTS LLC				PO BOX 1767			DUVALL	WA	98019	653497	15.002
1326069007	26231 NE 165TH ST 98019	CDK INVESTMENTS LLC				PO BOX 1767			DUVALL	WA	98019	1322065	30.350
1524079097		CE3 GROUP LLC		1016		10TH	ST		SNOHOMISH	WA	98290	277912	6.380
1024079030	2908 FALL CITY-CARNATION RD SE 98024	CHA MEECHAI+THOR CHEE		4711		328TH	AVE	NE	CARNATION	WA	98014	1233619	28.320
0824079043	3813 308TH AVE SE 98024	CHANDLER ROBERT+JULIE		3813		308TH	AVE	SE	FALL CITY	WA	98024	198198	4.550
0924079073	30925 SE 36TH ST 98024	CHAO ROBERT+CHAO ERICA J		30925	SE	36TH	ST		FALL CITY	WA	98024	223027	5.120
0924079074	2441 308TH AVE SE 98024	CHAO ROBERT+CHAO ERICA J		30925	SE	36TH	ST		FALL CITY	WA	98024	223027	5.120
7325800010	14244 CARNATION+DUVALL RD NE 98019	CHAPMAN MIKE E				PO BOX 790			DUVALL	WA	98019	217818	5.000
1024079022		CHEN FUKUEN ERIC		2450		109TH	PL	NE	BELLEVUE	WA	98004	500504	11.490
1124079011		CHEN FUKUEN ERIC		2450		109TH	PL	NE	BELLEVUE	WA	98004	938718	21.550
3325079003		CHEN FUKUEN ERIC		2450		109TH	PL	NE	BELLEVUE	WA	98004	5304312	121.770
1226069024		CHERRY VALLEY DAIRY				PO BOX 2001			WOODINVILLE	WA	98072	1538539	35.320
1226069023	26808 NE CHERRY VALLEY RD 98019	CHERRY VALLEY DAIRY				PO BOX 2001			WOODINVILLE	WA	98072	2999106	68.850
0824079036		CLEMENS DANIEL J+SUZANNE C		30632	SE	40TH	ST		FALL CITY	WA	98024	217800	5.000

Parcel No.	Situs Address	TaxpayerName	AttnLine	HouseNbr	DirPrefix	Street	Street Type	DirSuffix	City	State	ZipCode	LotSize SQFT	LotSize Acres
0824079034		CLEMENTS J DANIEL+SUZANNE C		30632	SE	40TH	ST		FALL CITY	WA	98024	108900	2.500
0824079035	30632 SE 40TH ST 98024	CLEMENTS J DANIEL+SUZANNE C		30632	SE	40TH	ST		FALL CITY	WA	98024	108900	2.500
3526069088	10699 WEST SNOQUALMIE VALLEY RD NE 98014	COOK GLENN				PO BOX 662			DUVALL	WA	98019	307969	7.070
2326069031		COOK GLENN				PO BOX 1659			DUVALL	WA	98019	1682723	38.630
3626069035		COOK GLENN 5				PO BOX 1659			DUVALL	WA	98019	900820	20.680
3626069006		COOK GLENN 5				PO BOX 1659			DUVALL	WA	98019	2501650	57.430
3626069008	10503 268TH AVE NE 98014	COOK LINDA M		2025		FAIRVIEW	AVE		SEATTLE	WA	98102	1859150	42.680
0924079076	31211 SE REDMOND-FALL CITY RD 98024	COWIN RANDALL C+LISA L		31211	SE	REDMOND FALL CITY			FALL CITY	WA	98024	480031	11.020
1226069048	26818 NE CHERRY VALLEY RD 98019	COY JOHN T		26818	NE	CHERRY VALLEY	RD		DUVALL	WA	98019	395525	9.080
1524079108	33216 SE REDMOND-FALL CITY RD 98024	CTT L L C				P O BOX 505			RAVENSDALE	WA	98051	653400	15.000
1625079024		CUNNINGHAM SEBASTIAN J		2001		REVOCABLE TRUST 1123 TREE			FALL CITY	WA	98024	133474	3.064
1625079032	31506 NE 55TH ST 98014	CUNNINGHAM SEBASTIAN J		2001		REVOCABLE TRUST 1123 TREE			FALL CITY	WA	98024	310582	7.130
1625079033	31340 NE 55TH ST 98014	CUNNINGHAM SEBASTIAN J		2001		REVOCABLE TRUST 1123 TREE			FALL CITY	WA	98024	310582	7.130
1625079053		CUNNINGHAM SEBASTIAN J		2001		REVOCABLE TRUST 1123 TREE			FALL CITY	WA	98024	486129	11.160
1625079011	5121 316TH AVE NE 98014	CUNNINGHAM SEBASTIAN J		2001		REVOCABLE TRUST 1123 TREE			FALL CITY	WA	98024	1644825	37.760
0826079102	17047 300TH AVE NE 98019	CURTIS LEWIS C+LINDA G				PO BOX 1728			DUVALL	WA	98019	466527	10.710
2025079015	2728 WEST SNOQUALMIE RIVER RD NE 98014	DALY AVRIL		2728	W	SNOQUALMIE RIVER	DR	NE	CARNATION	WA	98014	1368977	31.427
3225079021	731 WEST SNOQUALMIE RIVER RD SE 98014	DALY JOHN J		731		WEST SNOQUALMIE RIVER	RD		CARNATION	WA	98014	1929798	44.302
0524079019		DALY JOHN J+AVRIL T		731	W	SNOQUALMIE RIVER	RD	SE	CARNATION	WA	98014	365483	8.390
3425079105	32517 SE 3RD ST 98014	DAVIDSON PHILIP E D+MICHELL		32517	SE	3RD	ST		CARNATION	WA	98014	131551	3.020
1426069002		DAVIS KIRK M		20531		129TH	AVE	SE	SNOHOMISH	WA	98296	3114975	71.510
0725079062	7527 AMES LAKE-CARNATION RD NE 98014	DEASON JESSE H		7527		AMES LAKE-CARNATION	RD	NE	CARNATION	WA	98014	103672	2.380
0126069016	18525 WEST SNOQUALMIE RIVER RD NE 98019	DEJONG JERRY		18525	W	SNOQUALMIE RIVR	RD	NE	DUVALL	WA	98019	5939449	136.351
1226069005	18001 WEST SNOQUALMIE RIVER RD NE 98019	DEJONG JERRY		18525	W	SNOQUALMIE RIVER	RD	NE	DUVALL	WA	98019	1802824	41.387
1126069034	16904 WEST SNOQUALMIE VALLEY RD NE 98019	DEROY MICHAEL K+TERESA A		16825	W	SNOQUALMIE VALLEY	RD		DUVALL	WA	98019	468270	10.750
0226069014	19304 WEST SNOQUALMIE VALLEY RD NE 98019	DEVRIES RICHARD L+RANDY L		19309	W	SNOQUALMIE VALLEY			DUVALL	WA	98019	346738	7.960
0226069044		DEVRIES RICHARD L+RANDY L		19309	W	SNOQUALMIE VLY RDNE			DUVALL	WA	98019	2744280	63.000
2825079053	32232 NE 8TH ST	DIANICH GREGORY+ANNA		5524		157TH	DR	NE	REDMOND	WA	98052	180774	4.150
0726079005	28716 NE CHERRY VALLEY RD 98019	DONNEL HARLEY L				PO BOX 1208			DUVALL	WA	98019	1224036	28.100
0826079066	29407 NE 173RD ST 98019	DONNEL HARLEY L + CAROL				P O BOX 1208			DUVALL	WA	98019	579348	13.300
0826079010		DONNEL HARLEY L + CAROL				P O BOX 1208			DUVALL	WA	98019	835432	19.179
1025079090	7905 327TH AVE NE 98014	DONNOLLEY BRIAN + CALAB		7905		327TH	AVE	NE	CARNATION	WA	98014	253083	5.810
1126069016		DUCK HAVEN FARMS LLC		14931		827TH	AVE	SE	SNOHOMISH	WA	98296	3991403	91.630
1025079089	7315 328TH AVE NE 98014	DUNHAM GREGORY L				PO BOX 986			CARNATION	WA	98014	207365	4.760
0125069001		E SNO VALLEY LLC		1000		2ND	AVE		SEATTLE	WA	98010	323650	7.430
3626069017		E SNO VALLEY LLC		1000		2ND	AVE		SEATTLE	WA	98104	780178	17.910
3626069038	10819 CARNATION-DUVALL RD NE 98014	E SNO VALLEY LLC		1000		2ND	AVE		SEATTLE	WA	98104	831380	19.086
3626069037		E SNO VALLEY LLC		1000		2ND	AVE		SEATTLE	WA	98104	864666	19.850
3626069014		E SNO VALLEY LLC		1000		2ND	AVE		SEATTLE	WA	98104	871200	20.000
3126079011	10702 CARNATION-DUVALL RD NE 98014	E SNO VALLEY LLC		1000		2ND	AVE		SEATTLE	WA	98104	882918	20.269
3626069013		E SNO VALLEY LLC		1000		2ND	AVE		SEATTLE	WA	98104	1046311	24.020
3626069013		E SNO VALLEY LLC		1000		2ND	AVE		SEATTLE	WA	98104	1087029	24.955
2925079021		ELLA & EAGLES L L C		1525		16TH	AVE	E	SEATTLE	WA	98112	904554	20.766
2825079019		ELLA & EAGLES L L C		1525		16TH	AVE	E	SEATTLE	WA	98112	1586961	36.432
2925079016	1540 WEST SNOQUALMIE RIVER RD NE 98014	EPPLLEY GEARY L+LISA H		1540	W	SNOQUALMIE RIVER	RD	NE	CARNATION	WA	98014	975837	22.402
2526069015	11707 262ND AVE NE	ERICKSON-BROWN SIRI				PO BOX 526			DUVALL	WA	98019	1681154	38.594
2526069011	11707 262ND AVE NE	ERICKSON-BROWN SIRI				P O BOX 526			DUVALL	WA	98019	1812906	41.619
0924079016	31526 SE REDMOND-FALL CITY RD 98024	EVANS DON		31526		REDMOND-FALL CITY	RD		FALL CITY	WA	98024	1353844	31.080
1025079002	32514 NE 77TH ST 98014	FAGIOLI GIOVANNI+PAULA L		32514	NE	77TH	ST		CARNATION	WA	98014	259617	5.960
1024079005	2718 NEAL RD SE 98024	FALL CITY FARMS LLC		1111		FAIRVIEW	AVE	N	SEATTLE	WA	98109	1656739	38.033
0824079052		FALLS LITTLE LEAGUE				PO BOX 521			FALL CITY	WA	98024	217800	5.000
1724079027	30002 SE ISSAQUAH-FALL CITY RD 98024	FELS DONALD A		30002	SE	ISS-FALL CITY	RD		FALL CITY	WA	98024	323650	7.430
0625079023	8202 AMES LAKE-CARNATION RD NE 98014	FISHER RYAN J		8202		AMES LAKE-CARNATION	RD	NE	CARNATION	WA	98014	401188	9.210
0826079067	16501 300TH AVE NE 98019	FLICK MARK+LAURA		16501		300TH	AVE	NE	DUVALL	WA	98019	812829	18.660
0924079019	31405 SE REDMOND-FALL CITY RD 98024	FLYNN JOHN S+SAMANTHA H		1026		250TH	AVE	NE	SAMMAMISH	WA	98074	1588325	36.463
1226069051		FORMAN MICHAEL L+LAHEY RHON				P O BOX 849			CARNATION	WA	98014	1524600	35.000
0126069003		FORMAN MICHAEL+RHONDA		3920		332ND	AVE	NE	CARNATION	WA	98014	1768778	40.605
3570100050	2549 323RD AVE SE 98014	FOSTER DELL + LOIS		2549		323RD	AVE	NE	CARNATION	WA	98014	169012	3.880
2125079051	31515 NE TOLT HILL RD 98014	FOSTER STEVEN S & TERRY A		31515	NE	TOLT HILL	RD		CARNATION	WA	98014	297950	6.840
2025079013		FOSTER STEVEN S & TERRY ANN		31515	NE	TOLT HILL	RD		CARNATION	WA	98014	2010630	46.158
2125079012	31427 NE TOLT HILL RD 98014	FOSTER STEVEN S+TERRY ANN		31515	NE	TOLT HILL RE			CARNATION	WA	98014	3872981	88.911
7339500005	17949 WEST SNOQUALMIE RIVER RD NE 98019	FOX BRIAN JOSEPH+SANDRA K		17949	W	SNOQUALMIE RVR	RD	NE	DUVALL	WA	98019	1698840	39.000
3425079072	32424 SE 3RD ST 98014	FROST MONTA L		32424	SE	3RD	ST		CARNATION	WA	98014	615938	14.140

Parcel List

Parcel No.	Situs Address	TaxpayerName	AttnLine	HouseNbr	DirPrefix	Street	Street Type	DirSuffix	City	State	Zip Code	LotSize SQFT	LotSize Acres
0425079017	8519 CARNATION-DUVALL RD NE 98014	GAISFORD JULIE A		8519		CARNATION DUVALL	RD	NE	CARNATION	WA	98014	444312	10.200
0425079015		GAISFORD JULIE A		8519		CARNATION-DUVALL	RD	NE	CARNATION	WA	98014	1511128	34.691
0425079003		GAISFORD JULIE A		8519		CARNATION DUVALL	RD	NE	CARNATION	WA	98014	5117428	117.480
1424079008		GAMBLE CATHY E				PO BOX 1025			FALL CITY	WA	98024	1162600	26.690
1424079010		GAMBLE CATHY E				PO BOX 1025			FALL CITY	WA	98024	1669654	38.330
2825079052	31925 NE 16TH ST 98014	GARY+LYDIA				PO BOX 670			CARNATION	WA	98014	435615	10.000
0824079005	30219 SE REDMOND-FALL CITY RD 98024	GENDRON CHRISTOPHER P+SARA		30219	SE	REDMOND-FALL CITY	RD		FALL CITY	WA	98024	467811	10.739
3626069001	27311 NE 116TH ST 98019	GERARD ALAN / JAN E	DARST MAE E	27311	NE	116TH	ST		DUVALL	WA	98019	871200	20.000
0225079036	8620 NE 82ND PL 98014	GIAMPAPA PAUL+COLLEEN				PO BOX 1223			CARNATION	WA	98014	871200	20.000
2424079047		GIESE EMIL W	RIVERVIEW FARM			PO BOX 643			FALL CITY	WA	98024	666032	15.290
2225079013	32715 NE 32ND ST 98014	GOOD GROUND LLC		32610	NE	32ND	ST		CARNATION	WA	98014	178160	4.090
2225079034		GOOD GROUND LLC		32610	NE	32ND	ST		CARNATION	WA	98014	414691	9.520
2225079012		GOOD GROUND LLC		32610	NE	32ND	ST		CARNATION	WA	98014	548420	12.590
2125079021		GOOD GROUND LLC		32610	NE	32ND	ST		CARNATION	WA	98014	1224907	28.120
2125079023	3030 FALL CITY-CARNATION RD NE 98014	GOOD GROUND LLC		32610	NE	32ND	ST		CARNATION	WA	98014	1511096	34.690
0924079045	31030 SE REDMOND-FALL CITY RD	GORDON GLEN + REBECCA				PO BOX 8			FALL CITY	WA	98024	1432967	32.896
0924079058	31022 SE REDMOND-FALL CITY RD 98024	GORDON GLEN E+REBECCA M				PO BOX 8			FALL CITY	WA	98024	855954	19.650
0125069025		GRAND RIDGE COUNTRY ESTATES		12810		440TH	AVE	SE	NORTH BEND	WA	98045	386377	8.870
0625079024		GRAND RIDGE COUNTRY ESTATES		12810		440TH	AVE	SE	NORTH BEND	WA	98045	1059814	24.330
0625079017		GRAND RIDGE COUNTRY ESTATES		12810		440TH	AVE	SE	NORTH BEND	WA	98045	1089000	25.000
0125069029		GRAND RIDGE COUNTRY ESTATES		12810		440TH	AVE	SE	NORTH BEND	WA	98045	1131190	25.969
0125069005	27411 100TH AVE NE	GRAND RIDGE COUNTRY ESTATES		12810		440TH	AVE	SE	NORTH BEND	WA	98045	1829520	42.000
3425079078	32401 NE 8TH ST 98014	GREEN COREY WILLIAM		32401	NE	8TH	ST		CARNATION	WA	98014	196891	4.520
3425079075	32621 SE 3RD ST 98014	GREEN H MICHAEL				PO BOX 1240			CARNATION	WA	98014	506602	11.630
3425079116		GREEN H MICHAEL				PO BOX 1240			CARNATION	WA	98014	865972	19.880
0725079029	7709 AMES LAKE-CARNATION RD NE 98014	GREENMAN ROBERT F III		4751		90TH	AVE	SE	MERCER ISLAND	WA	98040	1208258	27.738
1625079007		GUNNINGHAM 2001 REVOCABLE T		1123		TREEMONT	WAY	SE	FALL CITY	WA	98024	426452	9.790
2725079038	1818 324TH AVE NE 98014	HAACK JAMES G+KATHERINE M		1818		324TH AV		NE	CARNATION	WA	98014	652486	14.979
2326069032		HAACK JIM + KATHERINE		1818		324TH	AVE	NE	CARNATION	WA	98014	2329786	53.485
3325079022		HAAKENSEN ERIK		229	W	SNOQUALMIE RIVER	RD	NE	CARNATION	WA	98014	376249	8.637
3225079029		HAAKENSEN ERIK		229	W	SNOQUALMIE RIVER	RD	NE	CARNATION	WA	98014	686877	15.769
3225079062		HAAKENSEN ERIK		229	W	SNOQUALMIE RIVER	RD	NE	CARNATION	WA	98014	737056	16.920
3225079005	229 WEST SNOQUALMIE RIVER RD NE 98014	HAAKENSEN ERIK		229	W	SNOQUALMIE RIVER	RD	NE	CARNATION	WA	98014	1137304	26.109
3225079007		HAAKENSEN ERIK		229	W	SNOQUALMIE RIVER	RD	NE	CARNATION	WA	98014	1202284	27.601
3225079012	211 WEST SNOQUALMIE RIVER RD NE	HAAKENSEN ERIK		229	W	SNOQUALMIE RIVER	RD	NE	CARNATION	WA	98014	1328810	30.505
3325079027		HAAKENSEN ERICK + WENDY		229	W	SNOQUALMIE RIVER	RD	NE	CARNATION	WA	98014	266789	6.125
3225079019	205 WEST SNOQUALMIE RIVER RD SE 98014	HAAKENSEN ERICK+WENDY R		229	W	SNOQUALMIE R	RD	NE	CARNATION	WA	98014	1648146	37.836
3225079020		HAAKENSEN ERICK+WENDY R		229	W	SNOQUALMIE R	RD	NE	CARNATION	WA	98014	1671460	38.371
2825079007	1931 FALL CITY-CARNATION RD NE 98014	HABERZETLE JOHN+JOSEPH		324		32ND	AVE	E	SEATTLE	WA	98112	1735852	39.850
1726079006	29530 NE CHERRY VALLEY RD 98019	HALLUM J D + M L LAIRD				PO BOX 178			DUVALL	WA	98019	435600	10.000
1726079061	29318 NE CHERRY VALLEY RD 98019	HALLUM J D + M L LAIRD				PO BOX 178			DUVALL	WA	98019	496584	11.400
1025079019	6813 329TH AVE NE 98014	HAMMOND PHILLIP J		6813		329TH	AVE	NE	CARNATION	WA	98014	391604	8.990
1025079010		HAMMOND PHILLIP J		6813		329TH	AVE	NE	CARNATION	WA	98014	1711908	39.300
0826079077	16519 300TH AVE NE 98019	HARDING MARK + LORI JO		16519		300TH	AVE	NE	DUVALL	WA	98019	913017	20.960
0725079011	6435 AMES LAKE-CARNATION RD NE 98014	HARLAN M		920	S	21ST	ST		MT VERNON	WA	98274	283140	6.500
0725079010	6819 AMES LAKE-CARNATION RD NE 98014	HART WILLIAM JR		11401		83RD	PL	NE	KIRKLAND	WA	98034	573249	13.160
1625079003	5005 CARNATION-DUVALL RD NE 98014	HARVOLD HERMAN + NANCY LOU	REVOCABLE LIVING TRUST	32325	NE	55TH STREET			CARNATION	WA	98014	576734	13.240
1625079004	32325 NE 55TH ST 98014	HARVOLD HERMAN + NANCY LOU	REVOCABLE LIVING TRUST	32325	NE	55TH STREET			CARNATION	WA	98014	815443	18.720
1625079047	5207 CARNATION-DUVALL RD NE 98014	HARVOLD HERMAN + NANCY LOU	REVOCABLE LIVING TRUST	32325	NE	55TH STREET			CARNATION	WA	98014	1210968	27.800
0925079004		HARVOLD HERMAN + NANCY LOU	REVOCABLE LIVING TRUST	32325	NE	55TH STREET			CARNATION	WA	98014	1437480	33.000
0925079016		HARVOLD HERMAN + NANCY LOU	REVOCABLE LIVING TRUST	32325	NE	55TH STREET			CARNATION	WA	98014	1447063	33.220
0925079002		HARVOLD HERMAN + NANCY LOU	REVOCABLE LIVING TRUST	32325	NE	55TH STREET			CARNATION	WA	98014	1510660	34.680
0925079033		HARVOLD HERMAN + NANCY LOU	REVOCABLE LIVING TRUST	32325	NE	55TH STREET			CARNATION	WA	98014	1020175	23.420
3126079018		HAYES JOSEPH A		27929	NE	100TH	ST		CARNATION	WA	98014	169803	3.898
0625079009		HAYES JOSEPH A		27929	NE	100TH	ST		CARNATION	WA	98014	618143	14.191
0625079006		HAYES JOSEPH A		27929	NE	100TH	ST		CARNATION	WA	98014	818056	18.780
0625079007	27929 NE 100TH ST 98014	HAYES JOSEPH A		27929	NE	100TH	ST		CARNATION	WA	98014	826768	18.980
0625079008	27929 NE 100TH ST 98014	HAYES JOSEPH A		27929	NE	100TH	ST		CARNATION	WA	98014	844628	19.390
0625079011		HAYES JOSEPH A		27929	NE	100TH	ST		CARNATION	WA	98014	865101	19.860
0625079012		HAYES JOSEPH A		27929	NE	100TH	ST		CARNATION	WA	98014	865101	19.860
1426069015		HERBCO INTERNATIONAL CORP		16661		WEST SNOQUALMIE RIVER	RD		DUVALL	WA	98019	905450	20.786
1426069017		HERBCO INTERNATIONAL CORP		16661		WEST SNOQUALMIE RIVER	RD		DUVALL	WA	98019	926085	21.260
1426069001		HERBCO INTERNATIONAL CORP		16661		WEST SNOQUALMIE RIVER	RD		DUVALL	WA	98019	1693612	38.880

Parcel No.	Situs Address	TaxpayerName	AttnLine	HouseNbr	DirPrefix	Street	Street Type	DirSuffix	City	State	ZipCode	LotSize SQFT	LotSize Acres
1426069004	15505 WEST SNOQUALMIE RIVER RD NE 98019	HERBCO INTERNATIONAL CORPOR		16661		WEST SNOQUALMIE RIVER	RD		DUVALL	WA	98019	1719010	39.463
1426069003		HERBCO INTERNATIONAL CORPOR		16661		WEST SNOQUALMIE RIVER	RD		DUVALL	WA	98019	1753725	40.260
1225069002		HEUBACH JANET GAIL+BARKER L		7515	W	SNOQUALMIE VALLEY	RD	NE	CARNATION	WA	98014	888624	20.400
2825079001	32127 NE 24TH ST 98014	HOCK KHEAM+LIM ALVIN+ET AL		32127	NE	24TH	ST		CARNATION	WA	98014	501376	11.510
2725079007	1826 324TH AVE NE 98014	HOLLINGER PAUL & SHARI ETAL				PO BOX 189			CARNATION	WA	98014	1018306	23.377
2225079016	32418 NE 24TH ST 98014	HOME FARM LLC		32610	NE	32ND	ST		CARNATION	WA	98014	5089550	116.840
8016100040	17625 CARNATION-DUVALL RD NE 98014	HONG MICHAEL+KYONG O		9301		CARNATION DUVALL	RD	NE	CARNATION	WA	98014	102482	2.353
2825079043	2204 FALL CITY-CARNATION RD NE 98014	HOOPER RAY				P O BOX 930			CARNATION	WA	98014	172062	3.950
0324079025		HUANG AN-JUNG		2450		109TH	PL	NE	BELLEVUE	WA	98004	537530	12.340
0424079024		HUSCHLE JOHN C		2411	E	ROY	ST		SEATTLE	WA	98112	923722	21.206
3325079008	201 FALL CITY-CARNATION RD NE 98014	JACKLIN SEAN		201		FALL CITY-CARNATION	RD	NE	CARNATION	WA	98014	212355	4.875
0324079023		JACKSON THOMAS L				P O BOX 1256			FALL CITY	WA	98024	363726	8.350
0324079024		JACKSON THOMAS L				P O BOX 1256			FALL CITY	WA	98024	449539	10.320
3526069002		JAFFE DEBRA+SILBERMAN STANF		11530	W	SNOQUALMIE VALLEY	RD	NE	CARNATION	WA	98014	137649	3.160
3526069004	11530 WEST SNOQUALMIE VALLEY RD NE 98014	JAFFE DEBRA+SILBERMAN STANF		11530	W	SNOQUALMIE VALLEY	RD	NE	CARNATION	WA	98014	1875693	43.060
1726079007		JOHNSON JILL E		28810	NE	CHERRY VALLEY	RD		DUVALL	WA	98019	242193	5.560
1826079001	28810 NE CHERRY VALLEY RD 98019	JOHNSON JILL E		28810	NE	CHERRY VALLEY	RD		DUVALL	WA	98019	469653	10.782
1525079050	5700 328TH AVE NE 98014	JONES DICK & LOUTSIS NICK				PO BOX 244			CARNATION	WA	98014	520977	11.960
0826079075	29529 NE 173RD ST 98019	JORDAN JOSEPH G				PO BOX 1387			DUVALL	WA	98019	435600	10.000
1126069001		JRT HOLDINGS US INC				PO BOX 752			LYNDEN	WA	98264	7798547	179.030
3325079032		KELLER STEVEN W				PO BOX 1377			FALL CITY	WA	98024	247856	5.690
3325079037		KELLER STEVEN W				PO BOX 1377			FALL CITY	WA	98024	356836	8.192
3325079031		KELLER STEVEN W				PO BOX 1377			FALL CITY	WA	98024	394715	9.061
3325079013	104 FALL CITY-CARNATION RD NE 98014	KELLER STEVEN W				PO BOX 1377			FALL CITY	WA	98024	419047	9.620
0424079023		KELLER STEVEN W				PO BOX 1377			FALL CITY	WA	98024	815529	18.722
3325079010		KELLER STEVEN W				PO BOX 1377			FALL CITY	WA	98024	893097	20.503
3325079030		KELLER STEVEN W				PO BOX 1377			FALL CITY	WA	98024	984967	22.612
3325079055		KELLER STEVEN W				PO BOX 1377			FALL CITY	WA	98024	1011898	23.230
3325079026		KELLER STEVEN W				PO BOX 1377			FALL CITY	WA	98024	1012191	23.237
3325079028		KELLER STEVEN W				PO BOX 1377			FALL CITY	WA	98024	1073369	24.641
0424079005		KELLER STEVEN W				PO BOX 1377			FALL CITY	WA	98024	1165342	26.753
3325079042		KELLER STEVEN W				PO BOX 1377			FALL CITY	WA	98024	1180349	27.097
3325079011	126 FALL CITY-CARNATION RD NE 98014	KELLER STEVEN W				PO BOX 1377			FALL CITY	WA	98024	1228827	28.210
0424079003	31700 SE 19TH WAY 98024	KELLER STEVEN W				PO BOX 1377			FALL CITY	WA	98024	1333406	30.611
3325079025		KELLER STEVEN W				PO BOX 1377			FALL CITY	WA	98024	1717311	39.424
1426069016		KELLER STEVEN W				PO BOX 1377			FALL CITY	WA	98024	1869506	42.918
0424079006		KELLER STEVEN W				PO BOX 1377			FALL CITY	WA	98024	2016447	46.291
0424079010	1931 WEST SNOQUALMIE RIVER RD SE 98024	KELLER STEVEN W				PO BOX 1377			FALL CITY	WA	98024	3409921	78.281
2326069005	14228 WEST SNOQUALMIE VALLEY RD NE 98019	KELLER STEVEN W				PO BOX 1377			FALL CITY	WA	98024	4128472	94.777
1426069012	14508 WEST SNOQUALMIE VALLEY RD NE 98019	KELLER STEVEN W				PO BOX 1377			FALL CITY	WA	98024	7039596	161.607
3325079060		KELLER STEVEN WALTER+JANET				PO BOX 1377			FALL CITY	WA	98024	316965	7.277
0924079029		KENAGY STEVEN W		31940	SE	REDMOND-FALL CITY	RD		FALL CITY	WA	98024	138085	3.170
0824079012		KENNEDY TIM		4580		KLAHANIE	DR	SE	ISSAQUAH	WA	98029	871200	20.000
0824079072		KENNEDY TIM		4580		KLAHANIE	DR	SE	ISSAQUAH	WA	98029	871200	20.000
0824079073	3219 300TH AVE SE 98024	KENNEDY TIM		4580		KLAHANIE	DR	SE	ISSAQUAH	WA	98029	871200	20.000
0824079074		KENNEDY TIM		4580		KLAHANIE	DR	SE	ISSAQUAH	WA	98029	871200	20.000
3425079076	32405 SE 3RD ST 98014	KENNELLY WILLIAM B+SALLY AN		32505	SE	3RD	ST		CARNATION	WA	98014	337154	7.740
0726079038	28420 NE CHERRY VALLEY RD 98019	KESSLER JANICE		7842		48TH	LOOP	SE	LACEY	WA	98503	230868	5.300
0324079022		KHAN NAYAB+HINA		6304		329TH	AVE	NE	CARNATION	WA	98014	453895	10.420
1025079013	6304 329TH AVE NE 98014	KHAN NAYAB+HINA		6304		329T	AVE	NE	CARNATION	WA	98014	1785088	40.980
0826079070	29401 NE 173RD ST 98019	KLOSTERMAN COLETTE L		29601	NE	173RD	ST		DUVALL	WA	98019	100188	2.300
3626069003	11575 268TH DR NE	KNOTT TANYA & AMOS SCOTT		11575		268TH	DR	NE	DUVALL	WA	98019	1563804	35.900
2825079020		KNUTSEN WILLIAM M JR		11519	NE	140TH	ST		KIRKLAND	WA	98034	1676796	38.494
2825079023	31904 NE 8TH ST 98014	KNUTSEN WILLIAM M JR		11519	NE	140TH	ST		KIRKLAND	WA	98034	1709730	39.250
1724079054	30607 SE 40TH ST 98024	KOETHE GERALD W		30607	SE	40TH			FALL CITY	WA	98024	1316819	30.230
1724079023	30625 SE 40TH ST 98024	KOETHE GERALD W+M MELINDA		30607	SE	40TH	ST		FALL CITY	WA	98024	480031	11.020
1226069037	17516 WEST SNOQUALMIE RIVER RD NE 98019	KOSTERS JEFFREY R+ANDREA K		17516	W	SNOQUALMIE RIVER	RD	NE	DUVALL	WA	98019	1263902	29.015
0626079026	19725 WEST SNOQUALMIE RIVER RD NE 98019	KOSTERS KEN		19721	W	SNOQUAL RIVER	RD	NE	DUVALL	WA	98019	871813	20.014
1226069032	18321 WEST SNOQUALMIE RIVER RD NE 98019	KOSTERS ROBERT V		18321	W	SNOQ RV	RD	NE	DUVALL	WA	98019	760927	17.468
1724079037	30624 SE ISSAQUAH-FALL CITY RD 98024	KUEHNELL CHARLES R+MARIANNE		30624	SE	ISSAQUAH-FALL CITY	RD		FALL CITY	WA	98024	218671	5.020
0924079026	3913 324TH AVE SE 98024	KULJIS ANDY + JUDITH		1950		CADDINGTON	DR		RANCHO PALOS VERDES	CA	90275	206910	4.750
1225069017		LA BENZ ARNOLD J JR				PO BOX 238			CARNATION	WA	98014	871200	20.000
1225069018	6627 WEST SNOQUALMIE VALLEY RD NE 98014	LA BENZ ARNOLD J JR				PO BOX 238			CARNATION	WA	98014	1742400	40.000

Parcel List

Attachment B
Revised September 21, 2015

Parcel No.	Situs Address	TaxpayerName	AttnLine	HouseNbr	DirPrefix	Street	Street Type	DirSuffix	City	State	ZipCode	LotSize SQFT	LotSize Acres
3425079109	32429 SE 3RD ST 98014	LAIRD GREGORY S		32429	SE	3RD	ST		CARNATION	WA	98014	217800	5.000
1426069011		LANGSTON PERRY J+LYNDA K		14411		235TH	ST	SE	SNOHOMISH	WA	98296	1710220	39.261
2825079055		LEBED NICK A				PO BOX 886			CARNATION	WA	98014	242193	5.560
2825079033	1213 324TH WAY NE 98014	LEBED-NICK A				PO BOX 886			CARNATION	WA	98014	987069	22.660
0924079034		LEIN JOHN N+CLAIRE C		2323		309TH	AVE	SE	FALL CITY	WA	98024	113160	2.598
0424079031	2323 309TH AVE SE 98024	LEIN JOHN N+CLAIRE C		2323		309TH	AVE	SE	FALL CITY	WA	98024	527076	12.100
0824079001		LEIN JOHN N+CLAIRE C		2323		309TH	AVE	SE	FALL CITY	WA	98024	865661	19.873
0424079013		LEIN MICHAEL N		30512	SE	31ST	ST		FALL CITY	WA	98024	1392969	31.978
0424079014		LEIN MICHAEL N		30512	SE	31ST	ST		FALL CITY	WA	98024	1441776	33.099
0924079048	2427 309TH AVE SE 98024	LEIN PATRICK+NANCY		2427		309TH	AVE	SE	FALL CITY	WA	98024	2105218	48.329
2424079008		LENNON PATRICK O+PATRICIA D		35815	SE	DAVID POWELL	RD		FALL CITY	WA	98024	449021	10.308
2825079018		LIEBE CHRISTI		1735		MARSDEN	RD		MARIETTA	OK	73448	188319	4.323
2825079022	31919 NE 16TH ST 98014	LIEBE CHRISTI		1735		MARSDEN	RD		MARIETTA	OK	73448	2168388	49.779
0824079042	30512 SE 31ST ST 98024	LIEN MICHAEL + DONNA		30512	SE	31ST	ST		FALL CITY	WA	98024	474052	10.883
2925079028		LIGHTFOOT JOSEPH F		3330		ISLAND CREST	WAY		MERCER ISLAND	WA	98040	226076	5.190
2925079037		LIGHTFOOT JOSEPH F		3330		ISLAND CREST	WAY		MERCER ISLAND	WA	98040	261795	6.010
2925079025		LIGHTFOOT JOSEPH F		3330		ISLAND CREST	WAY		MERCER ISLAND	WA	98040	283575	6.510
2925079010		LIGHTFOOT JOSEPH F		3330		ISLAND CREST	WAY		MERCER ISLAND	WA	98040	504424	11.580
0226069016	18521 WEST SNOQUALMIE VALLEY RD NE 98019	LINDEMULDER DAIRY	LINDEMULDER JOHN	18625	W	SNOQ VALLEY	RD	NE	DUVALL	WA	98019	1342151	30.812
0226069010		LINDEMULDER DAIRY	LINDEMULDER JOHN	18625	W	SNOQ VALLEY	RD	NE	DUVALL	WA	98019	2334816	53.600
0226069045	18521 WEST SNOQUALMIE VALLEY RD NE 98019	LINDEMULDER JOHN		18625	W	SNOQ VALLEY	RD	NE	DUVALL	WA	98019	2470288	56.710
0924079023	3825 324TH AVE SE 98024	LINDSEY LOUIS B JR		3825		324TH	AVE	SE	FALL CITY	WA	98024	301870	6.930
3325079001	32305 NE 8TH ST 98014	LINDVIG LARRY+ROLLA BIRGIT		32305	NE	8TH	ST		CARNATION	WA	98014	145054	3.330
1024079031	2556 NEAL RD SE 98024	LITTLE STANLEY E		2556		NEAL	RD	SE	FALL CITY	WA	98024	131551	3.020
2426069040		LOUTSIS CAROLINE C/O CHRIST		2310		DEERINGHOFF	RD		MOXEE	WA	98936	205167	4.710
2426069028		LOUTSIS CHRIS		1250		DEERINGHOFF	RD		MOXEE	WA	98936	462607	10.620
2426069018	26829 NE BIG ROCK RD 98019	LOUTSIS CHRIS		1250		DEERINGHOFF	RD		MOXEE	WA	98936	1028887	23.620
2426069019		LOUTSIS CHRIS		1250		DEERINGHOFF	RD		MOXEE	WA	98936	1175684	26.990
2426069059		LOUTSIS CHRIS J TRUST+LOUTS		2310		DEERINGHOFF	RD		MOXEE	WA	98936	653400	15.000
0924079025	3725 324TH AVE SE 98024	MACARTNEY MICHELLE		34115	SE	DAVID POWELL	RD		FALL CITY	WA	98024	464349	10.660
0924079012	2621 316TH AVE SE 98024	MACRAE IAN DAMPE				PO BOX 1329			FALL CITY	WA	98024	459267	10.543
0924079015		MACRAE IAN DAMPE				PO BOX 1329			FALL CITY	WA	98024	1873737	43.016
1525079007	NE 55TH ST 98014	MAGNOCHI GEORGE & DIANE J				PO BOX 519			CARNATION	WA	98014	864666	19.850
1525079006	32420 NE 55TH ST 98014	MAGNOCHI GEORGE E & DIANE J				PO BOX 519			CARNATION	WA	98014	1685772	38.700
0924079009		MASON GREG+TANYA		2411		316TH AV		SE	FALL CITY	WA	98024	624650	14.340
0925079031		MASON ROBIN L		6520		310TH	AVE	NE	CARNATION	WA	98014	149701	3.437
0925079014		MASON ROBIN L		6520		310TH	AVE	NE	CARNATION	WA	98014	720046	16.530
0925079010	6520 310TH AVE NE 98014	MASON ROBIN L		6520		310TH	AVE	NE	CARNATION	WA	98014	2115583	48.567
0824079019	30706 SE 40TH ST 98024	MASSEY SCOTT S J+SONIA M		30706	SE	40TH	ST		FALL CITY	WA	98024	88862	2.040
3626069007	10901 268TH AVE NE 98014	MAUHL GORDON		10901		268TH	AVE	NE	CARNATION	WA	98014	2023797	46.460
0726079040	28406 NE CHERRY VALLEY RD 98019	MAY JULIA POWELL		28406	NE	CHERRY VALLEY	RD		DUVALL	WA	98019	248292	5.700
2825079036	32311 NE 16TH ST 98014	MCALLISTER ROBERT A+DAWN A		32311	NE	16TH			CARNATION	WA	98014	220851	5.070
3626069005	11525 CARNATION-DUVALL RD NE 98014	MCCBRIDE JAMES D		11525		CARNATION-DUVALL	RD	NE	CARNATION	WA	98014	1877000	43.090
2725079011	32426 NE 8TH ST 98014	MCCANNA PATRICK+MICHELLE		32426	NE	8TH	ST		CARNATION	WA	98014	121968	2.800
0725079027	7015 AMES LAKE-CARNATION RD NE 98014	MCFALL BRANDY M+DANIEL F		7015		AMES LK CARNATION	RD	NE	CARNATION	WA	98014	100188	2.300
2125079025	2417 FALL CITY-CARNATION RD NE 98014	MCMILLEN PAUL P+SUSAN I		2417		FALL CITY CARNATION	RD	NE	CARNATION	WA	98014	91476	2.100
0424079032	1320 FALL CITY-CARNATION RD SE 98024	MICNAE WM BRUCE	CHESTNUT HILL FARM	1332		FALL CITY CARNATION	RD	SE	FALL CITY	WA	98024	130680	3.000
0424079004	1332 FALL CITY-CARNATION RD SE 98024	MICNAE WM BRUCE	CHESTNUT HILL FARM	1332		FALL CITY CARNATION	RD	SE	FALL CITY	WA	98024	1450548	33.300
0126069021		MILLER HAROLD+PAULA		3514	S	BENNETT	ST		SEATTLE	WA	98118	1764180	40.500
3425079102	32507 SE 3RD ST 98014	MOKLEBUST ARVID O		32507	SE	3RD	ST		CARNATION	WA	98014	341074	7.830
0125069006	9317 WEST SNOQUALMIE VALLEY RD NE 98014	MOLLI MEREDITH+MCGLOTHLIN P		3703	S	EDMUNDS	ST		SEATTLE	WA	98118	106286	2.440
0125069045	9316 WEST SNOQUALMIE VALLEY RD NE 98014	MOLLI MEREDITH+MCGLOTHLIN P		3703	S	EDMUNDS	ST		SEATTLE	WA	98118	2567862	58.950
1025079093		MORRIS CHASE		32517	NE	77TH	ST		CARNATION	WA	98014	98881	2.270
0925079001		MORRIS CHASE		32517	NE	77TH	ST		CARNATION	WA	98014	128587	2.952
3325079054	31801 SE 3RD ST 98014	MORRIS CURT+ANN		602	N	ST		SW	QUINCY	WA	98848	97727	2.244
1226069046		MORSE ROBIN BLAIR		18209	W	SNOQUALMIE RIVER	RD	NE	DUVALL	WA	98019	229995	5.280
1724079056		MYHRE DONALD C		30130		ISSAQUAH FALL CITY	RD		FALL CITY	WA	98024	152460	3.500
1724079025	30130 SE ISSAQUAH-FALL CITY RD 98024	MYHRE DONALD C		30130		ISSAQUAH-FALL CITY	RD		FALL CITY	WA	98024	325668	7.476
0824079033		NELSON DAVID E+LISA A		30520	SE	40TH	ST		FALL CITY	WA	98024	99316	2.280
2825079037	2106 FALL CITY-CARNATION RD NE 98014	NELSON JAMES R		2106		FALL CITY CARNATION RD NE			CARNATION	WA	98014	129808	2.980
3225079009	510 295TH WAY NE 98014	NELSON TIM J+MARY E		510		295TH	WAY	NE	CARNATION	WA	98014	1747211	40.110
0125069011		NIEDER MICHAEL A		4701	SW	ADMIRAL	WAY		SEATTLE	WA	98116	661676	15.190
3325079049	32331 NE 8TH ST 98014	NORDBY ANDREW P		32933	SE	43RD	ST		FALL CITY	WA	98024	919116	21.100

Parcel No.	Situs Address	TaxpayerName	AttnLine	HouseNbr	DirPrefix	Street	Street Type	DirSuffix	City	State	Zip Code	LotSize SQFT	LotSize Acres
0925079019	6410 CARNATION-DUVALL RD NE 98014	NYKREIM ARNFINN+ERIKA		6410		CARNATION-DUVALL	RD	NE	CARNATION	WA	98014	144811	3.324
1025079012		NYKREIM ARNFINN+ERIKA		6410		CARNATION-DUVALL	RD	NE	CARNATION	WA	98014	162478	3.730
1025079021		NYKREIM ARNFINN+ERIKA		6410		CARNATION-DUVALL	RD	NE	CARNATION	WA	98014	541886	12.440
0425079008		OHANLEY PATRICIA J				PO BOX 13			CARNATION	WA	98014	362042	8.311
0425079009	5215 CARNATION-DUVALL RD NE 98014	OHANLEY PATRICIA J				PO BOX 13			CARNATION	WA	98014	797519	18.309
1024079034		OKI SCOTT D+LAURIE B		4315		HUNTS POINT	RD		BELLEVUE	WA	98004	575863	13.220
1024079018		OKI SCOTT D+LAURIE B		4315		HUNTS POINT	RD		BELLEVUE	WA	98004	1721055	39.510
1024079001		OKI SCOTT D+LAURIE B		4315		HUNTS POINT	RD		BELLEVUE	WA	98004	4138200	95.000
1025079030	7311 328TH AVE NE 98014	OWEN STEPHEN		7311		328TH	AVE	NE	CARNATION	WA	98014	206762	4.747
1025079047	7005 328TH AVE NE 98014	PAGEL DIANE E+JEFFREY W		7005		328TH	AVE	NE	CARNATION	WA	98014	432115	9.920
2025079025	3107 WEST SNOQUALMIE RIVER RD NE 98014	PALMER RAY I		3107	W	SNOQUALMIE RIVER	RD	NE	CARNATION	WA	98014	112384	2.580
2025079020	3129 WEST SNOQUALMIE RIVER RD NE 98014	PALMER RAY I		3107	W	SNOQUALMIE RIVER	RD	NE	CARNATION	WA	98014	236530	5.430
2025079041		PALMER RAY I		3107	W	SNOQUALMIE RIVER	RD	NE	CARNATION	WA	98014	256240	5.882
2825079046	32310 NE 8TH ST 98014	PAOLETTI TYSON P+AMY M		32310	NE	8TH	ST		CARNATION	WA	98014	133729	3.070
2125079024	2815 FALL CITY-CARNATION RD NE 98014	PARKER ALFRED JOSEPH II		2815		FALL CITY-CARNATION	RD	NE	CARNATION	WA	98014	116305	2.670
0125069015		PCC FARMLAND TRUST		1917		FIRST AVE LEVEL A-100			SEATTLE	WA	98101	871194	20.000
0626079027	20226 DUVALL-MONROE RD NE 98019	PEARCE JEFFREY E+VIKKI K		20226		DUVALL-MONROE	RD	NE	DUVALL	WA	98019	3693888	84.800
1225069006	7029 W SNOQUALMIE VALLEY RD NE 98014	PEARSON GRACE A		7029	W	SNOQUALMIE VALLEY	RD	NE	CARNATION	WA	98014	207781	4.770
3526069031	10808 WEST SNOQUALMIE VALLEY RD NE 98014	PEPPER-FRENCH PEGGY E ET AL		2640		TELEQUANA	DR		ANCHORAGE	AK	99517	1444014	33.150
0826079076	29509 NE 173RD ST 98019	PEPPER-FRENCH PEGGY E ET AL		2640		TELEQUANA	DR		ANCHORAGE	AK	99517	2060823	47.310
1724079038	30716 SE ISSAQUAH-FALL CITY RD 98024	PETTERSEN GLEN A+CATHY		29509	NE	173RD	ST		DUVALL	WA	98019	618116	14.190
1625079035	31439 W COMMERCIAL ST 98014	PETITIT KENNETH W		30716	SE	ISSAQUAH-FALL CITY	RD		FALL CITY	WA	98024	252648	5.800
3225079026	203 WEST SNOQUALMIE RIVER RD NE 98014	PFEIFFER LINDA K		31439	W	COMMERCIAL	ST		CARNATION	WA	98014	1562932	35.880
0924079024	31608 SE 40TH ST	PHILLIPS LOUANN		203	W	SNOQUALMIE RIVER	RD		CARNATION	WA	98014	217800	5.000
0726079041		PHILPOTT MICHAEL S+JILL M				PO BOX 759			FALL CITY	WA	98024	321848	7.389
2526069008		PHOENIX RISING SANCTUARY				PO BOX 488			DUVALL	WA	98019	1549125	35.563
3526069035	10522 WEST SNOQUALMIE VALLEY RD NE 98014	PICKERING LARRY				PO BOX 1807			DUVALL	WA	98019	1810354	41.560
1025079003	32427 NE 77TH ST 98014	PICON FRANK A+KATHRYN D		10522	W	SNOQUALMIE VALLEY	RD	NE	CARNATION	WA	98014	87120	2.000
1025079091		POEHLEIN PEGGY				PO BOX 174			CARNATION	WA	98014	190792	4.380
1025079092	32517 NE 77TH ST 98014	POEHLEIN PEGGY				PO BOX 174			CARNATION	WA	98014	294030	6.750
1025079007		POEHLEIN PEGGY				PO BOX 174			CARNATION	WA	98014	324957	7.460
1726079038	29726 NE CHERRY VALLEY RD 98019	POEHLEIN PEGGY				PO BOX 174			CARNATION	WA	98014	867279	19.910
1226069041	27150 NE CHERRY VALLEY RD 98019	POLACEK JOSHUA P				PO BOX 1237			DUVALL	WA	98019	471484	10.824
1424079006		POWELL ROGER E		27150	NE	CHERRY VALLEY	RD		DUVALL	WA	98019	159412	4.578
1625079054	31015 NE 60TH ST 98014	RABBIT RUN FARM & NURSERY L				PO BOX 1308			WOODINVILLE	WA	98072	1326981	30.463
0424079033		RABEL JOHN B+HEIDI J		130		LAKESIDE	AVE		SEATTLE	WA	98122	360241	8.270
3425079073	32778 SE 3RD ST	RANSOM RICHARD & SHERRY				PO BOX 1000			FALL CITY	WA	98024	172293	3.955
3425079071	32752 SE 3RD ST 98014	REED FAITH S		32778	SE	3RD	ST		CARNATION	WA	98014	436195	10.014
0625079020		REED FAITH S		32752	SE	3RD	ST		CARNATION	WA	98104	471263	10.819
0625079020		REULE JANET M		28403	NE	CARNATION FARM	RD		CARNATION	WA	98014	1182654	27.150
0625079019	28403 NE CARNATION FARM RD 98014	REULE RICHARD+JANET		28403		CARNATION FARM	RD		CARNATION	WA	98014	836352	19.200
0924079005		RICHMOND HOWARD E		31913	SE	28TH			FALL CITY	WA	98024	186436	4.280
0924079002		RICHMOND HOWARD E		31913	SE	28TH			FALL CITY	WA	98024	469141	10.770
0924079037		RICHMOND HOWARD E		31913	SE	28TH	ST		FALL CITY	WA	98024	815007	18.710
0924079007		RICHMOND HOWARD E		31913	SE	28TH			FALL CITY	WA	98024	1765051	40.520
0924079020		RICHMOND HOWARD E		31913	SE	28TH	ST		FALL CITY	WA	98024	1858705	42.670
0924079039		RICHMOND HOWARD E JR		31913	SE	28TH			FALL CITY	WA	98024	757944	17.400
0924079021		RICHMOND HOWARD E JR		31913	SE	28TH			FALL CITY	WA	98024	1399582	32.130
0924079006	31913 SE 28TH ST 98024	RICHMOND HOWARD E JR		31913	SE	28TH			FALL CITY	WA	98024	1879614	43.150
1024079003	2610 FALL CITY-CARNATION RD SE 98024	RICHTER JAMES S		2610		FALL CITY-CARN	RD	SE	FALL CITY	WA	98024	789742	18.130
0726079033	28626 NE CHERRY VALLEY RD 98019	ROBERTIELLO PAUL D		28626	NE	CHERRY VALLEY	RD		DUVALL	WA	98019	422532	9.700
3325079012		ROBERTSON DALE REED		319		FALL CITY-CARNATION	RD	NE	CARNATION	WA	98014	140263	3.220
3325079007	319 FALL CITY-CARNATION RD NE 98014	ROBERTSON DALE REED		319		FALL CITY-CARNATION	RD	NE	CARNATION	WA	98014	435600	10.000
3325079020		ROBERTSON DALE REED		319		FALL CITY-CARNATION	RD	NE	CARNATION	WA	98014	810971	18.617
3325079023		ROBERTSON DALE REED		319		FALL CITY-CARNATION	RD	NE	CARNATION	WA	98014	811087	18.620
3225079002		ROBERTSON DALE REED		319		FALL CITY-CARNATION	RD	NE	CARNATION	WA	98014	1095174	25.142
3325079050		ROBERTSON E VIOLA+ROBERTSON		319		FALL CITY-CARNATION	RD	NE	CARNATION	WA	98014	223245	5.125
3126079013	27800 NE 100TH ST 98014	ROBERTSON WILLIAM+MEISHA				PO BOX 36			CARNATION	WA	98014	1951852	44.808
0626079010	19605 WEST SNOQUALMIE RIVER RD NE 98019	ROETCISOENDER JAMES		19605	W	SNOQ RIVER	RD	NE	DUVALL	WA	98019	3689532	84.700
0626079012	18717 WEST SNOQUALMIE RIVER RD NE 98019	ROETCISOENDER JASON M+KERRI		18633		WEST SNOQUALMIE RIVER	RD		DUVALL	WA	98019	988812	22.700
2825079047	1004 FALL CITY-CARNATION RD NE 98014	ROGERS GLEN G+BETHANY J		32317	NE	11TH	ST		CARNATION	WA	98104	276170	6.340
3526069004	11210 CARNATION-DUVALL RD NE 98014	RONNEI DUANE		11210		CARNATION-DUVALL	RD	NE	CARNATION	WA	98014	1636549	37.570
1124079022	342 SE 39TH PL 98024	ROONEY DALE E		3924		FALL CITY-CARNATION	RD		FALL CITY	WA	98024	315810	7.250

Parcel No.	Situs Address	TaxpayerName	AttnLine	HouseNbr	DirPrefix	Street	Street Type	DirSuffix	City	State	ZipCode	LotSize SQFT	LotSize Acres
0924079079		ROYAL DANIEL+LINDSEY		2165		39TH	AVE		OAKLAND	CA	94601	254517	5.843
0725079065	6623 AMES LAKE CARNATION RD NE	RUCKHABER BOYD D J				P O BOX 1373			BELLEVUE	WA	98009	483516	11.100
1126069038		RUPARD TYRANUS SAM		17320	W	SNOQUALMIE RV	RD	NE	DUVALL	WA	98013	456509	10.480
1226069017	17112 WEST SNOQUALMIE VALLEY RD NE 98019	RUPARD TYRANUS SAM		17320	W	SNOQUALMIE RIVER	RD	NE	DUVALL	WA	98019	974152	22.363
1126069013		RUPARD TYRANUS SAM		17320	W	SNOQUALMIE RV	RD	NE	DUVALL	WA	98019	3273534	75.150
1225069052		RUSCH MICHAEL A & KELLER L		7929	W	SNOQUALMIE VALLEY	RD		CARNATION	WA	98014	338896	7.780
1225069001		RUSCH MICHAEL A & KELLER L		7929	W	SNOQUALMIE VLY	RD	NE	CARNATION	WA	98014	839836	19.280
1225069003	7929 WEST SNOQUALMIE VALLEY RD NE 98014	RUSCH MICHAEL A+LEE KELLER		7929	W	SNOQUALMIE VLY	RD	NE	CARNATION	WA	98014	497455	11.420
0924079080		RUST MICHAEL D+SARAH M				PO BOX 416			FALL CITY	WA	98024	274780	6.308
1124079028		RUTHERFORD SLOUGH LLC	C/O WALL BRIAN	34349	SE	39TH	PL		FALL CITY	WA	98024	2838805	65.170
0925079005		SAMIS FOUNDATION		208		JAMES	ST		SEATTLE	WA	98104	375303	8.616
2426069034	14211 CARNATION-DUVALL RD NE 98019	SCHADER ROBERT M II+MARISE		8017	N	THORNE	LN		LAKEWOOD	WA	98498	1171764	26.900
2326069004		SCHADER ROBERT M II+MARISE		8017	N	THORNE	LN		LAKEWOOD	WA	98498	1989385	45.670
2326069003		SCHADER ROBERT M II+MARISE		8017	N	THORNE	LN		LAKEWOOD	WA	98498	2070913	47.542
2326069013		SCHADER ROBERT M II+MARISE		8017	N	THORNE	LN		LAKEWOOD	WA	98498	2900660	66.590
0824079028	3607 308TH AVE SE 98024	SCHALLER ROBERT T JR+THERES		3607	ROBERT	308TH	AVE	SE	FALL CITY	WA	98024	425561	9.770
1024079029	2506 NEAL RD SE 98024	SCHATTLER ROBERT T+ALINA R		2506		NEAL	RD	SE	FALL CITY	WA	98024	128502	2.950
0925079025	7110 310TH AVE NE 98014	SCHMOLL J+SUSAN		7110		310TH		NE	CARNATION	WA	98014	3177025	72.934
0924079071	2633 309TH AVE SE 98024	SCOGGINS BRIAN T+MEAGAN		2633		309TH	AVE	SE	FALL CITY	WA	98024	217776	4.999
2326069006	14120 W SNOQUALMIE VALLEY RD NE 98019	SEAMONS MICHAEL S+MICHELLE		14120	W	SNOQUALMIE VALLEY	RD	NE	DUVALL	WA	98019	490836	11.268
3225079023	623 WEST SNOQUALMIE RIVER RD SE 98014	SEANA ROBERT P		623	W	SNOQUALMIE RIVER	RD	SE	CARNATION	WA	98014	1531393	35.156
0824079079	3708 295TH AVE SE 98024	SEIBER JAMES L+SUSAN J		3708	W	295TH	AVE	SE	FALL CITY	WA	98024	164304	3.772
1024079032		SFERRA LISA & OLSEN GARTH		9761		BEACON AVE SO			SEATTLE	WA	98118	261360	6.000
1726079036	29810 NE CHERRY VALLEY RD 98019	SHELBY JAMES K+SANDRA D (TR		29810	NE	CHERRY VALLEY	RD		DUVALL	WA	98019	304505	6.990
0925079022		SIKES FARM LLC				PO BOX 177			CARNATION	WA	98014	331056	7.600
0925079020		SIKES FARM LLC				PO BOX 177			CARNATION	WA	98014	1263676	29.010
0925079017		SIKES FARM LLC				PO BOX 177			CARNATION	WA	98014	1543331	35.430
0925079018		SIKES FARM LLC				PO BOX 177			CARNATION	WA	98014	1570774	36.060
0925079015		SIKES FARM LLC				PO BOX 177			CARNATION	WA	98014	1704938	39.140
0125069017	8402 WEST SNOQUALMIE VALLEY RD NE 98014	SINNEMA JERALD C+SALLY		8402	W	SNOQUALMIE VALLEY	RD	NE	CARNATION	WA	98014	1395257	32.031
0125069003		SINNEMA JERALD C+SALLY		8402	W	SNOQUALMIE VALLEY	RD	NE	CARNATION	WA	98014	1518090	34.851
0125069016		SINNEMA JERALD C+SALLY		8402	W	SNOQUALMIE VALLEY	RD	NE	CARNATION	WA	98014	1591247	36.530
3626069016		SINNEMA JERRY+SALLY		8402	W	SNO VALLEY	RD	NE	CARNATION	WA	98014	488145	11.206
3626069012		SINNEMA JERRY+SALLY		8402	W	SNO VALLEY	RD	NE	CARNATION	WA	98014	879476	20.190
3325079057		SLATER JUDITH		32327	SE	3RD	ST		CARNATION	WA	98014	217800	5.000
3325079038	32327 SE 3RD ST 98014	SLATER JUDITH		32327	SE	3RD	ST		CARNATION	WA	98014	277912	6.380
3325079051	32004 SE 3RD ST 98014	SMITH JERRY M & KRISTYNA J		32004	SE	3RD	ST		CARNATION	WA	98014	89733	2.060
0325079011	8328 CARNATION-DUVALL RD NE 98014	SMITH WARNER W+ROXANA L AND		6929		123RD	AVE	NE	KIRKLAND	WA	98033	818637	18.793
1424079064	35109 SE FISH HATCHERY RD 98024	SNOQUALMIE FALLS DEVEL CORP				PO BOX 790			FALL CITY	WA	98024	1350360	31.000
2324079002	35109 SE FISH HATCHERY RD 98024	SNOQUALMIE FALLS DEVEL CORP				PO BOX 790			FALL CITY	WA	98024	2329889	53.487
2424079009	36326 SE 56TH ST 98024	SNOQUALMIE WEST INC	C/O BREVIK DALE+KRISTINE	36001		B SE DAVID POWELL	RD		FALL CITY	WA	98024	892544	20.490
3570100100	2545 323RD AVE NE 98014	SOLBERG JAMES A		2545		323RD	AVE	NE	CARNATION	WA	98014	196891	4.520
3570100110	32201 NE 25TH LN 98014	SOLBERG JAMES A+NANCY PETER		2545		323RD	AVE	NE	CARNATION	WA	98014	251776	5.780
0824079050	3633 300TH AVE SE 98024	SOLVANG K DONALD+RAGNHILD S				PO BOX 790			FALL CITY	WA	98024	476982	10.950
2326069012	13523 WEST SNOQUALMIE VALLEY RD NE 98077	SONG YAO		825		92ND	AVE	NE	BELLEVUE	WA	98004	901480	20.695
2326069028		SONG YAO		825		92ND	AVE	NE	BELLEVUE	WA	98004	1102994	25.321
0826079089	29727 NE 173RD ST	SPRUTE HERBERT A		29727	NE	173RD	ST		DUVALL	WA	98019	143748	3.300
1524079046	4458 PRESTON-FALL CITY RD SE 98024	STAHL MICHELE+JOHN H JR		4458		PRESTON-FALL CITY	HWY		FALL CITY	WA	98024	837223	19.220
0924079040	3613 324TH AVE SE 98024	STAINER SCOTT AND HANNAH				PO BOX 188			FALL CITY	WA	98024	355885	8.170
1424079078	34012 SE FALL CITY-SNOQUALMIE RD 98024	STALLMAN RUSSELL E+NELLIE B		23737	NE	REDMOND FALL CTY	RD		REDMOND	WA	98053	494474	11.352
2925079006		STEELE DEAN WESLEY		2655		298TH	PL	NE	CARNATION	WA	98014	875120	20.090
2925079079		STEELE DEAN WESLEY		2655		298TH	PL	NE	CARNATION	WA	98014	876862	20.130
1424079060		STEIL ROBERT L+JULIE R		34920	SE	FALL CITY-SNOQUALMIE R			FALL CITY	WA	98024	406129	9.323
1424079057	34920 SE FALL CITY-SNOQUALMIE RD 98024	STEIL ROBERT LEE SR+JULIE R		34920	SE	FALL CITY-SNOQUALMIE R			FALL CITY	WA	98024	422216	9.693
1024079019	3309 FALL CITY-CARNATION RD SE	STEVENSON ADRIAN L -FALL CI		1111		FAIRVIEW AV		N	SEATTLE	WA	98109	358934	8.240
1024079026	3636 NEAL RD SE 98024	STEVENSON ADRIAN L -FALL CI		1111		FAIRVIEW AV		N	SEATTLE	WA	98109	4016232	92.200
0725079066	6530 WEST SNOQUALMIE VALLEY RD NE 98014	STOWE WILLIAM K+JOYCE K		6530	W	SNOQUALMIE VALLEY	RD		CARNATION	WA	98014	486565	11.170
2925079048		STROM ARTHUR V		1202	W	SNOQUALMIE RIVER	RD	NE	CARNATION	WA	98014	363486	8.344
2925079019	1202 WEST SNOQUALMIE RIVER RD NE 98014	STROM ARTHUR V+WANCY J		1202	W	SNOQUALMIE RIVER	RD	NE	CARNATION	WA	98014	306999	7.048
2925079020		STROM ARTHUR VAN+NADOY JANE		1202	W	SNOQUALMIE RIVER	RD	NE	CARNATION	WA	98014	272113	6.247
2825079013		STROUSE WILLIAM VAN		5818		114TH		NE	KIRKLAND	WA	98033	165466	3.799
0824079022	30334 SE 26TH ST	TARANTOLA JOSEPH+LORNA L		4580		KLAHANIE	DR	SE	ISSAQUAH	WA	98029	216814	4.977
1226069016	17111 DUVALL-MONROE RD NE 98019	TERRY MARJORIE G+G TERRY HU		17111		DUVALL-MONROE	RD	NE	DUVALL	WA	98019	1494979	34.320

Parcel No.	Situs Address	TaxpayerName	AttnLine	HouseNbr	DirPrefix	Street	Street Type	DirSuffix	City	State	ZipCode	LotSize SQFT	LotSize Acres
0625079014	8718 AMES LAKE-CARNATION RD NE 98014	TGE CARNATION LLC				PO BOX 1309			NORTH BEND	WA	98045	4538269	106.480
2526069016		THAO THAI		14627	NE	178TH	ST		WOODINVILLE	WA	98072	1352538	31.050
2125079039	3019 FALL CITY-CARNATION RD NE 98014	THOMAS JANET C		3019		FALL CITY CARNATION	RD	NE	CARNATION	WA	98014	196020	4.500
2125079002		THORSON ROGER F		31523	NE	40TH			CARNATION	WA	98014	380278	8.730
2125079009	31523 NE 40TH ST 98014	THORSON ROGER F		31523	NE	40TH			CARNATION	WA	98014	646430	14.840
3325079035	102 FALL CITY-CARNATION RD SE 98014	THUERINGER KEVIN F+LORI		102		FALL CITY CARNATION	RD	NE	CARNATION	WA	98104	277041	6.360
3325079036		TOKUL TIMBER LLC				PO BOX 3771			BELLEVUE	WA	98009	386377	8.870
3325079052		TOKUL TIMBER LLC				PO BOX 3771			BELLEVUE	WA	98009	505296	11.600
3325079053		TOKUL TIMBER LLC				PO BOX 3771			BELLEVUE	WA	98009	903434	20.740
0424079001	802 FALL CITY-CARNATION RD SE 98024	TOKUL TIMBER LLC				PO BOX 3771			BELLEVUE	WA	98009	2034172	46.698
0726079039	28430 NE CHERRY VALLEY RD 98019	TOWN MIKE J				PO BOX 1124			DUVALL	WA	98019	230868	5.300
1025079005	7902 327TH AVE NE 98014	TRABONT GALEN		7902		327TH	AVE	NE	CARNATION	WA	98014	739213	16.970
3225079004	415 WEST SNOQUALMIE RIVER RD NE 98014	TREGONING MATTHEW S+DEANNA		415	W	SNOQUALMIE RIVER	RD	NE	CARNATION	WA	98014	826204	18.967
2825079040	1809 FALL CITY-CARNATION RD NE 98014	TRIM TERRY R+AUDREY J		1809	NE	FALL CITY-CARNATION	RD		CARNATION	WA	98014	522720	12.000
2526069073	12808 CARNATION-DUVALL RD NE 98019	TUBBS LOREN	DANGLIKER PAULA	12808		CARNATION-DUVALL	RD	NE	DUVALL	WA	98019	1328580	30.500
1225069019		TURNER CHARLES SCOTT+AMY MA		7125	W	SNOQUALMIE VLY	RD	NE	CARNATION	WA	98014	372438	8.550
1225069037		TURNER CHARLES SCOTT+AMY MA		7125	W	SNOQUALMIE VLY	RD	NE	CARNATION	WA	98014	482209	11.070
0725079017		TURNER CHARLES SCOTT+AMY MA		7125	W	SNOQUALMIE VLY	RD	NE	CARNATION	WA	98014	646866	14.850
1225069005	7125 WEST SNOQUALMIE VALLEY RD NE 98014	TURNER CHARLES SCOTT+AMY MA		7125	W	SNOQUALMIE VLY	RD	NE	CARNATION	WA	98014	666903	15.310
0226069003	19529 W SNOQUALMIE VALLEY RD NE	VANESS DOUWE		19529	W	SNOQUALMIE VALLEY	RD	NE	DUVALL	WA	98019	1320739	30.320
0226069043		VANESS DOUWE		19529	W	SNOQUALMIE VALLEY	RD	NE	DUVALL	WA	98019	11985969	275.160
0626079007		VANESS STEVEN R		1926		RD 17-5		NW	EPHRATA	WA	98823	1027144	23.580
0126069002		VANESS STEVEN R		1926		RD 17-5		NW	EPHRATA	WA	98823	3746160	86.000
0826079013		VANHULLE CHARLES & NANCY				PO BOX 55			DUVALL	WA	98019	1584713	36.380
0826079015	30032 NE CHERRY VALLEY RD 98019	VANHULLE CHARLES & NANCY				PO BOX 55			DUVALL	WA	98019	1963684	45.080
1726079019	30030 NE CHERRY VALLEY RD 98019	VANHULLE CHARLES E+NANCY				PO BOX 55			DUVALL	WA	98019	119354	2.740
0125069004		VINCENT RANCH LP		22426		SR 203			MONROE	WA	98272	1580792	36.290
2526069007		WALLACE ACRES LLC				PO BOX 1607			BELLEVUE	WA	98009	884268	20.300
2626069003		WALLACE ACRES LLC				PO BOX 1607			BELLEVUE	WA	98009	884268	20.300
2626069004		WALLACE ACRES LLC				PO BOX 1607			BELLEVUE	WA	98009	888624	20.400
2626069006	12910 WEST SNOQUALMIE VALLEY RD NE 98019	WALLACE ACRES LLC				PO BOX 1607			BELLEVUE	WA	98009	2561328	58.800
1226069019	16819 WEST SNOQUALMIE RIVER RD NE 98019	WARD RONEY		16621	W	SNOQ RV	RD	NE	DUVALL	WA	98019	1548300	35.544
2825079024		WATTS LYNDEN+LORNA		4438		332ND AV		SE	FALL CITY	WA	98024	599821	13.770
0625079016	8316 AMES LAKE-CARNATION RD NE 98014	WELLS WENDY	WISCHMAN JOHN	8316		AMES LK CARNATION FRM	RD		CARNATION	WA	98014	334105	7.670
0725079028	7111 AMES LAKE-CARNATION RD NE 98014	WEYANT RICK D+DEANA J		7111		AMES LAKE-CARNATION	RD	NE	CARNATION	WA	98014	965725	22.170
1226069007	17651 WEST SNOQUALMIE RIVER RD NE 98019	WICKS EDWARD D+LORA L		17651	W	SNOQUALMIE RIVER	RD	NE	DUVALL	WA	98019	2129648	48.890
1226069050		WICKS EDWARD D+NEALON LYNN L		17651	W	SNOQUALMIE RIVER	RD	NE	DUVALL	WA	98019	1665734	38.240
2326069016		WILD LIFE HABITAT CLUB	ATTN: DONOVAN DARRELL			PO BOX 818			AUBURN	WA	98071	1078110	24.750
0824079037	30414 SE 40TH ST 98024	WILL ROBERT & SUSAN				PO BOX 745			FALL CITY	WA	98024	316681	7.270
0824079018	30032 SE 40TH ST 98024	WILSON MARVIN	C/O HILL ESTHER	10521		DOUGLAS	DR	SW	LAKEWOOD	WA	98499	1742400	40.000
0226069002	20408 WEST SNOQUALMIE VALLEY RD NE 98019	WILSON MATTHEW J+SHANNON B		20408	W	SNOQUALMIE VALLEY	RD	NE	DUVALL	WA	98018	229125	5.260
0824079020		WOLDEGIORGIS LEMA & LEGESET	C/O PICKLES CHRIS			PO BOX 3188			REDMOND	WA	98073	87120	2.000
0824079006	30621 SE 31ST ST 98024	WOLDEGIORGIS LEMA +LEGESET W		30621	SE	31ST	ST		FALL CITY	WA	98024	205173	4.710
3325079059	101 FALL CITY-CARNATION RD NE 98014	WOOD CRISTIN JAY+JESSICA LY		36221	SE	25TH	ST		FALL CITY	WA	98024	300128	6.890
3325079009		WOOD CRISTIN JAY+JESSICA LY		36221	SE	25TH	ST		FALL CITY	WA	98024	400778	9.201
3526069001		WOOLSLAYER BONNIE JEAN -TRU		7030		149TH	AVE	NE	REDMOND	WA	98052	369177	8.475
2626069005		WOOLSLAYER BONNIE JEAN -TRU		7030		149TH	AVE	NE	REDMOND	WA	98052	914324	20.990
2626069015	25809 NE 124TH ST 98014	WOOLSLAYER BONNIE JEAN -TRU		7030		149TH	AVE	NE	REDMOND	WA	98052	2107432	48.380
2925079002	1804 WEST SNOQUALMIE RIVER RD NE 98014	YASSERI LLC		4202		140TH	AVE	NE	BELLEVUE	WA	98005	1814977	41.666
2825079011	1810 WEST SNOQUALMIE RIVER RD NE 98014	YASSERI LLC		4202		140TH	AVE	NE	BELLEVUE	WA	98005	4439135	101.909
0924079044	31920 SE REDMOND-FALL CITY RD 98024	YOUNG JOHN A.		31920	SE	REDMOND-FALL CITY	RD		FALL CITY	WA	98024	132422	3.040

13,305.376
Acres

Legal Description
of the
Snoqualmie Valley Watershed Improvement District
In King County, Washington

IN TOWNSHIP 26 NORTH, RANGE 6 EAST, WILLAMETTE MERIDIAN:

- Section 2: The S.E. 1/4, of the N.W. 1/4.
 The N.E. 1/4.
 The S.E. 1/4 of the S.W. 1/4.
 The S.E. 1/4.
- Section 1: All of Section 1.
- Section 11: The N.E. 1/4 of the N.W. 1/4.
 The S.E. 1/4 of the N.W. 1/4.
 The N.E. 1/4.
 The N.E. 1/4 of the S.W. 1/4.
 The S.E. 1/4 of the S.W. 1/4.
 The S.E. 1/4.
- Section 12: The N.W. 1/4.
 The N.E. 1/4.
 The S.W. 1/4; Except that portion thereof lying within the City of Duvall.
 The S.E. 1/4; Except that portion thereof lying Southeasterly of NE Cherry
 Valley Road.
- Section 15: The N.E. 1/4 of the S.E. 1/4.
 The S.E. 1/4 of the S.E. 1/4.
- Section 14: The N.E. 1/4 of the N.W. 1/4.
 The S.E. 1/4 of the N.W. 1/4.
 The S.W. 1/4 of the N.W. 1/4.
 The N.E. 1/4.
 The S.E. 1/4.
 The S.W. 1/4.
- Section 13: Government Lot 2 of the N.W. 1/4. (Subdivisionally being the N.W. 1/4 of
 the N.W. 1/4).
 Government Lot 3 of the N.W. 1/4. (Subdivisionally being the S.W. 1/4 of
 the N.W. 1/4).
-
- Section 23: The N.W. 1/4.
 The N.E. 1/4.

Legal Description
July 31, 2015

The S.W. 1/4.
The S.E. 1/4.

Section 24: The S.W. 1/4 of the N.W. 1/4.
The S.E. 1/4 of the N.W. 1/4.
The N.E. 1/4 of the N.W. 1/4.
The N.W. 1/4 of the N.W. 1/4.
The N.W. 1/4 of the S.W. 1/4.
The S.W. 1/4 of the S.W. 1/4.
The N.E. 1/4 of the S.W. 1/4.
The N.W. 1/4 of the S.E. 1/4.
The N.E. 1/4 of the S.E. 1/4.
The S.W. 1/4 of the S.E. 1/4.

Section 26: Government Lots 2 and 3 of the N.W. 1/4. (Subdivisionally being the N.E. 1/4 of the N.W. 1/4).
The S.E. 1/4 of the N.W. 1/4.
The N.E. 1/4.
The S.E. 1/4.
The N.E. 1/4 of the S.W. 1/4.

Section 25: The N.W. 1/4.
The S.W. 1/4.
The N.W. 1/4 of the S.E. 1/4.

Section 35: The N.E. 1/4.
The N.E. 1/4 of the S.E. 1/4.

Section 36: The N.W. 1/4.
The N.E. 1/4.
The S.W. 1/4.
The S.E. 1/4.

IN TOWNSHIP 26 NORTH, RANGE 7 EAST, WILLAMETTE MERIDIAN:

Section 6: The N.W. 1/4.
Government Lot 2 of the N.E. 1/4. (Subdivisionally being the N.W. 1/4 of the N.E. 1/4).
The S.W. 1/4 of the N.E. 1/4.
The N.W. 1/4 of the S.E. 1/4.
The S.W. 1/4 of the S.E. 1/4.
The S.W. 1/4.

Legal Description
July 31, 2015

Section 7: Government Lot 1 of the N.W. 1/4. (Subdivisionally being the N.W. 1/4 of the N.W. 1/4).
The N.E. 1/4 of the N.W. 1/4.
The N.W. 1/4 of the N.E. 1/4.
The S.E. 1/4 of the N.E. 1/4.
The N.E. 1/4 of the S.E. 1/4.
The S.W. 1/4 of the S.E. 1/4.
The S.E. 1/4 of the S.E. 1/4.

Section 8: The S.W. 1/4 of the N.W. 1/4.
The S.W. 1/4.
The S.W. 1/4 of the S.E. 1/4.
The S.E. 1/4 of the S.E. 1/4.

Section 18: The N.W. 1/4 of the N.E. 1/4.
The N.E. 1/4 of the N.E. 1/4.

Section 17: The N.W. 1/4 of the N.W. 1/4.
The N.E. 1/4 of the N.W. 1/4.
The N.W. 1/4 of the N.E. 1/4.

Section 31: The S.W. 1/4.
The S.E. 1/4.

Section 32: The S.W. 1/4.

IN TOWNSHIP 25 NORTH, RANGE 6 EAST, WILLAMETTE MERIDIAN:

Section 1: Government Lot 4 of the N.W. 1/4. (Subdivisionally being the N.E. 1/4 of the N.W. 1/4).
The S.W. 1/4 of the N.W. 1/4.
The S.E. 1/4 of the N.W. 1/4.
The N.E. 1/4.
The S.E. 1/4.
The N.E. 1/4 of the S.W. 1/4.

Section 12: The N.E. 1/4.
The N.E. 1/4 of the S.E. 1/4.
The S.E. 1/4 of the S.E. 1/4.
The S.W. 1/4 of the S.E. 1/4.

IN TOWNSHIP 25 NORTH, RANGE 7 EAST, WILLAMETTE MERIDIAN:

Legal Description
July 31, 2015

- Section 2: The N.W. 1/4 of the S.W. 1/4
 The S.W. 1/4 of the S.W. 1/4
- Section 6: The N.W. 1/4.
 The N.E. 1/4.
 The S.W. 1/4.
 The S.E. 1/4.
- Section 5: Government Lot 5 of the N.W. 1/4. (Subdivisionally being the N.W. 1/4 of
 the N.W. 1/4).
 Government Lot 6 of the N.W. 1/4. (Subdivisionally being the S.W. 1/4 of
 the N.W. 1/4).
 The S.W. 1/4.
 Government Lot 15 of the S.E. 1/4. (Subdivisionally being the S.W. 1/4 of
 the S.E. 1/4).
- Section 4: The S.E. 1/4 of the N.W. 1/4.
 The S.E. 1/4 of the S.W. 1/4.
 The N.E. 1/4 of the S.W. 1/4.
 The S.W. 1/4 of the N.E. 1/4.
 The S.E. 1/4.
- Section 3: The S.W. 1/4 of the S.W. 1/4.
 The S.E. 1/4 of the S.W. 1/4.
- Section 7: The N.W. 1/4.
 Government Lot 3 of the S.W. 1/4. (Subdivisionally being the N.W. 1/4 of
 the S.W. 1/4).
 Government Lot 4 of the S.W. 1/4. (Subdivisionally being the S.W. 1/4 of
 the S.W. 1/4).
- Section 8: The N.W. 1/4.
 The N.W. 1/4 of the S.W. 1/4.
 The N.E. 1/4 of the S.W. 1/4.
 The N.E. 1/4.
 The N.W. 1/4 of the S.E. 1/4
 The N.E. 1/4 of the S.E. 1/4.
- Section 9: Government lot 1 of the N.W. 1/4. (Subdivisionally being the N.E. 1/4 of
 the N.W. 1/4).
 Government lot 5 of the N.W. 1/4. (Subdivisionally being the S.E. 1/4 of
 the N.W. 1/4).
 The N.E. 1/4.
 The S.E. 1/4.

Legal Description
July 31, 2015

- The S.W. 1/4.
- Section 10: The N.W. 1/4 of the N.W. 1/4.
The S.W. 1/4 of the N.W. 1/4.
The N.E. 1/4 of the N.W. 1/4.
The S.W. 1/4.
- Section 15: The N.W. 1/4.
- Section 16: The N.E. 1/4 of the N.W. 1/4.
Government Lot 1 of the N.W. 1/4. (Subdivisionally being the N.W. 1/4 of the N.W. 1/4).
Government Lot 4 of the N.W. 1/4. (Subdivisionally being the S.E. 1/4 of the N.W. 1/4).
The N.W. 1/4 of the N.E. 1/4.
The S.W. 1/4 of the N.E. 1/4.
The S.E. 1/4 of the N.E. 1/4.
Government Lot 5 of the S.W. 1/4. (Subdivisionally being the N.E. 1/4 of the S.W. 1/4).
- Section 20: The S.W. 1/4 of the N.E. 1/4.
The S.E. 1/4.
- Section 21: The N.E. 1/4 of the N.W. 1/4.
Government Lot 8 of the N.W. 1/4. (Subdivisionally being the S.E. 1/4 of the N.W. 1/4).
Government Lot 9 of the N.W. 1/4. (Subdivisionally being the S.W. 1/4 of the N.W. 1/4).
The N.W. 1/4 of the N.E. 1/4.
The S.W. 1/4.
The S.E. 1/4.
- Section 22: Government Lot 9 of the N.W. 1/4. (Subdivisionally being the S.W. 1/4 of the N.W. 1/4).
Government Lot 5 of the N.W. 1/4. (Subdivisionally being the N.W. 1/4 of the N.W. 1/4).
The N.W. 1/4 of the S.W. 1/4.
The S.W. 1/4 of the S.W. 1/4.
The S.E. 1/4 of the S.W. 1/4.
-
- Section 27: The S.W. 1/4 of the N.W. 1/4.
The S.W. 1/4 of the S.W. 1/4.

Legal Description
July 31, 2015

Section 28: The N.E. 1/4.
The N.W. 1/4.
The S.E. 1/4.
The S.W. 1/4.

Section 29: The S.E. 1/4 of the N.E. 1/4.
Government Lot 3 of the N.E. 1/4. (Subdivisionally being the N.E. 1/4 of the N.E. 1/4).
The N.E. 1/4 of the N.W. 1/4.
The S.E. 1/4 of the N.W. 1/4.
The N.E. 1/4 of the S.W. 1/4.
The S.E. 1/4 of the S.W. 1/4.
The S.E. 1/4.

Section 32: The N.E. 1/4 of the N.W. 1/4.
The S.E. 1/4 of the N.W. 1/4.
The N.E. 1/4.
The S.E. 1/4.

Section 33: The N.W. 1/4.
The N.E. 1/4.
The S.W. 1/4.
The S.E. 1/4.

Section 34: The N.W. 1/4 of the N.W. 1/4.
The S.W. 1/4 of the N.W. 1/4.
The N.W. 1/4 of the S.W. 1/4.
The N.E. 1/4 of the S.W. 1/4.
The S.W. 1/4 of the S.W. 1/4.

IN TOWNSHIP 24 NORTH, RANGE 7 EAST, WILLAMETTE MERIDIAN:

Section 3: The N.W. 1/4 of the S.W. 1/4.
The S.W. 1/4 of the S.W. 1/4.
The S.E. 1/4 of the S.W. 1/4.

Section 4: The N.E. 1/4.
The N.W. 1/4.
The S.W. 1/4.
The S.E. 1/4.

Section 5: The N.E. 1/4.
The N.W. 1/4 of the S.E. 1/4.

Legal Description
July 31, 2015

The N.E. 1/4 of the S.E. 1/4.
The S.E. 1/4 of the S.E. 1/4.

Section 8: The N.E. 1/4.
The S.W. 1/4.
The S.E. 1/4.

Section 9: The N.W. 1/4.
The N.E. 1/4.
The S.E. 1/4.
The N.W. 1/4 of the S.W. 1/4.
The N.E. 1/4 of the S.W. 1/4.
The S.E. 1/4 of the S.W. 1/4.
The S.W. 1/4 of the S.W. 1/4.

Section 10: Government Lot 2 of the N.W. 1/4. (Subdivisionally being the N.W. 1/4 of the N.W. 1/4).
Government Lot 1 of the N.W. 1/4. (Subdivisionally being the N.E. 1/4 of the N.W. 1/4).
Government Lot 5 of the N.W. 1/4. (Subdivisionally being the S.E. 1/4 of the N.W. 1/4).
The N.E. 1/4.
The S.E. 1/4.
The S.W. 1/4 of the S.W. 1/4.
Government Lot 8 of the S.W. 1/4. (Subdivisionally being the N.W. 1/4 of the S.W. 1/4).
Government Lot 7 of the S.W. 1/4. (Subdivisionally being the N.E. 1/4 of the S.W. 1/4).

Section 11: The S.W. 1/4 of the N.W. 1/4.
The N.E. 1/4 of the S.W. 1/4.
The N.W. 1/4 of the S.W. 1/4.
The S.W. 1/4 of the S.W. 1/4.

Section 14: The N.W. 1/4 of the N.E. 1/4.
Government Lot 6 of the N.E. 1/4. (Subdivisionally being the S.W. 1/4 of the N.E. 1/4).
The S.E. 1/4 of the N.E. 1/4.
Government Lots 5 and 7 of the S.E. 1/4. (Subdivisionally being the N.W. 1/4 of the S.E. 1/4).

The S.W. 1/4 of the S.E. 1/4.
The S.W. 1/4.
The N.W. 1/4.

Legal Description
July 31, 2015

- Section 15: Government Lot 1 of the N.E. 1/4. (Subdivisionally being the N.E. 1/4 of the N.E. 1/4).
Government Lot 2 of the N.E. 1/4. (Subdivisionally being the N.W. 1/4 of the N.E. 1/4).
The N.E. 1/4 of the N.W. 1/4.
The S.E. 1/4 of the S.W. 1/4.
The N.E. 1/4 of the S.E. 1/4.
The S.E. 1/4 of the S.E. 1/4.
- Section 16: The S.W. 1/4 of the N.E. 1/4.
- Section 17: The N.E. 1/4.
- Section 23: Government Lot 3 of the N.W. 1/4. (Subdivisionally being the N.E. 1/4 of the N.W. 1/4).
Government Lot 4 of the N.W. 1/4. (Subdivisionally being the N.W. 1/4 of the N.W. 1/4).
Government Lot 2 of the N.E. 1/4. (Subdivisionally being the N.W. 1/4 of the N.E. 1/4).
- Section 24: Government Lot 6 of the N.E. 1/4. (Subdivisionally being the S.W. 1/4 of the N.E. 1/4).
Government Lot 7 of the N.E. 1/4. (Subdivisionally being the S.E. 1/4 of the N.E. 1/4).
The N.E. 1/4 of the N.E. 1/4.
Government Lot 8 of the N.E. 1/4. (Subdivisionally being the S.W. 1/4 of the N.E. 1/4).
Government Lot 5 of the N.W. 1/4. (Subdivisionally being the S.E. 1/4 of the N.W. 1/4).
Government Lot 4 of the N.W. 1/4. (Subdivisionally being the S.W. 1/4 of the N.W. 1/4).

Steve Van Patten
Professional Land Surveying Services
7431 153rd Ct NE
Redmond, WA 98052
425 867-1715

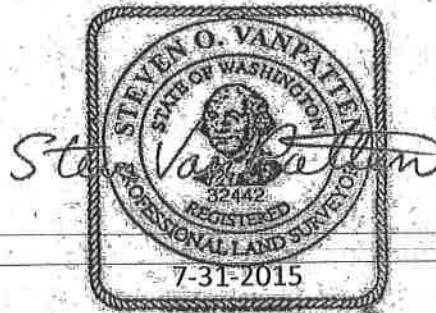

THE ELECTION PROCESS

THE ELECTION

The King County Council is responsible for conducting the district's formation election. Pursuant to RCW 87.03.032, the Council elects to use vote by mail to conduct the district formation election and election of directors. An election day of November 24, 2015, has been selected and ballots must be delivered to the Clerk of the Council or mailed with a postmark by that date and received by the Clerk by November 30, 2015 to be counted toward the election.

THE BALLOT

The County will prepare the ballots, ballot envelopes, and instructions indicating how joint ownership and community property votes are cast as well as a request to forward the ballot to the property owner if different from addressee. Voting rights shall be allocated as follows: two votes for each five acres of assessable land or fraction thereof. The chart below provides examples of how many votes parcels of differing acreage are entitled to receive. Additionally, electors (property owners) may receive more than one ballot if they own multiple parcels within the proposed district.

Acres From	Acres To	Number of Votes
2.0	5.0	2
5.1	10.0	4
10.1	15.0	6
15.1	20.0	8
20.1	25.0	10
ETC.		

Ballots will be coded to indicate how many votes each ballot is worth.

The ballot shall contain the following language:

"Irrigation District – YES"

"Irrigation District – NO"

The names of the persons to be voted for as directors of the district.

To be counted in this election, ballots must conform to these requirements and the voting instructions will advise the electors of the importance of the following requirements:

1. Voted ballots must be sealed and placed in a ballot envelope (provided) and the ballot envelope must be sealed in a return certification envelope (provided). The certification envelope will contain a "voters certificate" and a "witness certification" on the back of the envelope as follows:

Voters Certification

I certify as true, under penalty of perjury under the laws of the State of Washington, that I am a landowner within the proposed district who is 18 years or more of age, a citizen of the United States, a resident of the State of Washington, and hold title or evidence of title to assessable land in the proposed district. If the landowner is a corporation, I certify as true, under penalty of perjury under the laws of the State of Washington, that I am a duly authorized agent for the purpose of voting on this election by the corporation.

Signature _____
(Landowner/Voter)

Print Name _____
(Landowner/Voter)

City & State where signed _____

Date Signed _____

Witness Certification

I certify as true, under penalty of perjury under the laws of the State of Washington, that I am acquainted with the above voter and the voter's signature above was affixed in my presence.

Signature _____
(Witness)

Print Name _____
(Witness)

City & State where signed _____

Date Signed _____

-
2. Both the "voter's certification" and the "witness certification" must be completed and signed as indicated. Unsigned or unwitnessed ballots will not be counted.

3. Ballots must be hand delivered to the King County Clerk's Office prior to 4:30 p.m. on November 24, 2015; or mailed to the Clerk, postmarked no later than midnight on November 24, 2015, and received by the Clerk by 4:30 p.m. on November 30, 2015.

Ballots will be kept unopened and secure under the responsibility of the Clerk until the time in which ballots may be received is closed. The Council appoints the Clerk and assigned staff to proceed at once to determine whether the voters submitting ballots are qualified to vote and to count and tally the votes of those determined to be qualified.

The King County Council will meet on December 7, 2015, to canvass the returns. If it appears that at least two-thirds of all votes cast are in favor of the district, the Council shall by ordinance declare the district duly organized and shall declare the qualified persons receiving the highest number of votes to be duly elected directors and shall cause a certified copy of the ordinance to be filed for record in the offices of the Elections Director and the Assessor.