

ATTACHMENT A:

LEASE AGREEMENT

OFFICE LEASE

**COLUMBIA CENTER
SEATTLE, WASHINGTON**

GC COLUMBIA, LLC,

a Delaware limited liability company

as Landlord,

and

KING COUNTY,

a home rule charter county and political subdivision of the State of Washington,

as Tenant.

TABLE OF CONTENTS

| | <u>Page</u> |
|------------|--|
| ARTICLE 1 | PREMISES, BUILDING, PROJECT, AND COMMON AREAS 4 |
| ARTICLE 2 | LEASE TERM..... 5 |
| ARTICLE 3 | BASE RENT..... 5 |
| ARTICLE 4 | ADDITIONAL RENT 5 |
| ARTICLE 5 | USE OF PREMISES..... 11 |
| ARTICLE 6 | SERVICES AND UTILITIES 11 |
| ARTICLE 7 | REPAIRS..... 13 |
| ARTICLE 8 | ADDITIONS AND ALTERATIONS..... 14 |
| ARTICLE 9 | COVENANT AGAINST LIENS..... 15 |
| ARTICLE 10 | INSURANCE 15 |
| ARTICLE 11 | DAMAGE AND DESTRUCTION..... 18 |
| ARTICLE 12 | NONWAIVER..... 19 |
| ARTICLE 13 | CONDEMNATION..... 20 |
| ARTICLE 14 | ASSIGNMENT AND SUBLETTING 20 |
| ARTICLE 15 | SURRENDER OF PREMISES; OWNERSHIP AND REMOVAL OF TRADE FIXTURES 24 |
| ARTICLE 16 | HOLDING OVER 24 |
| ARTICLE 17 | ESTOPPEL CERTIFICATES 25 |
| ARTICLE 18 | SUBORDINATION 25 |
| ARTICLE 19 | DEFAULTS; REMEDIES..... 26 |
| ARTICLE 20 | COVENANT OF QUIET ENJOYMENT..... 28 |
| ARTICLE 21 | INTENTIONALLY DELETED 28 |
| ARTICLE 22 | INTENTIONALLY DELETED 28 |
| ARTICLE 23 | SIGNS..... 28 |
| ARTICLE 24 | COMPLIANCE WITH LAW 29 |
| ARTICLE 25 | LATE CHARGES 30 |
| ARTICLE 26 | LANDLORD’S RIGHT TO CURE DEFAULT; PAYMENTS BY TENANT 30 |
| ARTICLE 27 | ENTRY BY LANDLORD..... 30 |
| ARTICLE 28 | TENANT PARKING..... 31 |
| ARTICLE 29 | MISCELLANEOUS PROVISIONS..... 31 |

EXHIBITS

- A OUTLINE OF PREMISES
- A-1 LEGAL DESCRIPTION
- B TENANT WORK LETTER
- C FORM OF NOTICE OF LEASE TERM DATES
- D RULES AND REGULATIONS
- E-1 FORM OF TENANT’S ESTOPPEL CERTIFICATE
- E-2 FORM OF TENANT’S ESTOPPEL CERTIFICATE (CURRENT LENDER)

EXTENSION OPTION RIDER

TABLE OF CONTENTS

| | <u>Page</u> |
|-----------------------------------|-------------|
| Transferee..... | 20 |
| Tenant..... | 1 |
| Summary..... | 1 |
| Statement..... | 10 |
| Renovations..... | 35 |
| Project..... | 4 |
| Premises..... | 4 |
| Notices..... | 33 |
| Mail..... | 33 |
| Lines..... | 35 |
| Lease..... | 1 |
| Landlord..... | 1 |
| HVAC..... | 11 |
| Holidays..... | 11 |
| Excess..... | 10 |
| Estimate..... | 10 |
| Casualty..... | 18 |
| Building..... | 4 |
| Brokers..... | 35 |
| Alterations..... | 14 |
| Abatement Event..... | 13 |
| Applicable Laws..... | 29 |
| Base Rent..... | 5 |
| Base Taxes..... | 9 |
| Base Year..... | 6 |
| Building Common Areas..... | 4 |
| Building Hours..... | 11 |
| Common Areas..... | 4 |
| Comparable Buildings..... | Rider |
| Contemplated Effective Date..... | 22 |
| Contemplated Transfer Space..... | 22 |
| Cost Pools..... | 9 |
| Direct Expenses..... | 6 |
| Eligibility Period..... | 13 |
| Estimate Statement..... | 10 |
| Estimated Excess..... | 10 |
| Exercise Date..... | Rider |
| Exercise Notice..... | Rider |
| Expense Year..... | 6 |
| Extension Option..... | Rider |
| Extension Rider..... | Rider |
| Force Majeure..... | 33 |
| Free Rent Period..... | 5 |
| Identification Requirements..... | 36 |
| Intention to Transfer Notice..... | 22 |
| Interest Notice..... | Rider |
| Landlord Repair Notice..... | 18 |
| Landlord Parties..... | 16 |
| Law Department..... | 2 |
| Lease Commencement Date..... | 5 |
| Lease Expiration Date..... | 5 |
| Lease Term..... | 5 |
| Lease Year..... | 5 |

| | <u>Page</u> |
|---|-------------|
| Nine Month Period..... | 22 |
| Operating Expenses..... | 6 |
| Option Rent..... | Rider |
| Option Rent Notice..... | Rider |
| Option Term..... | Rider |
| Option Term Outside Agreement Date..... | Rider |
| Original Improvements..... | 17 |
| Original Tenant..... | Rider |
| Possession Date..... | 4 |
| Released Claims..... | 36 |
| Subject Space..... | 21 |
| Tax Expenses..... | 8 |
| Tenant's Share..... | 9 |
| Tenant Parties..... | 16 |
| Transfer Notice..... | 21 |

COLUMBIA CENTER

OFFICE LEASE

This Office Lease (the "**Lease**"), dated as of the date set forth in **Section 1** of the Summary of Basic Lease Information (the "**Summary**"), below, is made by and between GC COLUMBIA, LLC, a Delaware limited liability company ("**Landlord**"), and KING COUNTY, a home rule charter county and political subdivision of the State of Washington ("**Tenant**").

SUMMARY OF BASIC LEASE INFORMATION

| TERMS OF LEASE | DESCRIPTION |
|-------------------------------------|---|
| 1. Date: | March 24, 2022 |
| 2. Premises (<u>Article 1</u>): | |
| 2.1 Building: | 701 Fifth Avenue, Seattle, Washington, which is located on the real property more particularly described on <u>Exhibit A-1</u> , attached hereto. |
| 2.2 Premises: | Approximately 34,548 rentable square feet of space comprised of (i) 11,146 rentable square feet of space located on the fifth (5 th) floor of the Building and commonly known as Suite 500, and (ii) 23,402 rentable square feet of space located on the sixth (6 th) floor of the Building and commonly known as Suite 600, all as further set forth in <u>Exhibit A</u> to the Office Lease. |
| 3. Lease Term (<u>Article 2</u>): | |
| 3.1 Length of Term: | Ten (10) years and six (6) months. |
| 3.2 Lease Commencement Date: | The earlier to occur of (i) the date upon which Tenant first commences to conduct business in the Premises, and (ii) the "Possession Date," as that term is defined in <u>Section 1.1.1</u> of this Lease. |
| 3.3 Lease Expiration Date: | If the Lease Commencement Date shall be the first day of a calendar month, then the day immediately preceding the one hundred twenty-six (126) month anniversary of the Lease Commencement Date; or, if the Lease Commencement Date shall be other than the first day of a calendar month, then the last day of the month in which the one hundred twenty-six (126) month anniversary of the Lease Commencement Date occurs. |

4. Base Rent (Article 3):

| <u>Year of Lease Term</u> | <u>Annual Base Rent</u> | <u>Monthly Installment of Base Rent</u> | <u>Annual Base Rent per Rentable Square Foot</u> |
|---------------------------|-------------------------|---|--|
| 1* | \$1,606,482.00 | \$133,873.50 | \$46.50 |
| 2 | \$1,646,557.68 | \$137,213.14 | \$47.66 |
| 3 | \$1,687,669.80 | \$140,639.15 | \$48.85 |
| 4 | \$1,730,163.84 | \$144,180.32 | \$50.08 |
| 5 | \$1,773,348.84 | \$147,779.07 | \$51.33 |
| 6 | \$1,817,570.28 | \$151,464.19 | \$52.61 |
| 7 | \$1,863,173.64 | \$155,264.47 | \$53.93 |
| 8 | \$1,909,467.96 | \$159,122.33 | \$55.27 |
| 9 | \$1,957,489.68 | \$163,124.14 | \$56.66 |
| 10 | \$2,006,202.36 | \$167,183.53 | \$58.07 |
| 11** | \$2,056,296.96 | \$171,358.08 | \$59.52 |

*Subject to the terms of Section 3.2 of this Lease

**Ends on Lease Expiration Date

5. Base Year (Article 4):

Calendar year 2023.

6. Tenant's Share (Article 4):

Approximately 2.31%.

7. Permitted Use (Article 5):

General office use by King County's attorneys' office for civil matters (the "Civil Division") or another department or division of King County permitted pursuant to the terms of Section 14.8 of this Lease, in any event consistent with a first-class office building and subject to and in accordance with the terms of this Lease. Notwithstanding the foregoing, in no event shall the Premises be utilized for (i) any business that includes real estate title or real estate escrow services, and/or (ii) photocopying services, including, but not limited to, reprographic services, litigation support photocopying, printing or bindery services, and/or (iii) the operation of any type of ATM, cash machine, or other banking, machine or device or booth or kiosk offering telephone, satellite, computer or "on-line" banking services, and/or (iv) any "executive suite," "co-working," "incubator" or similar business, and/or (v) any other use that violates an exclusive use granted to any occupant of the Building. In addition, in no event shall the Premises be utilized for any criminal legal or other work, processing or other matter related to criminal defendants

and/or any crime or criminal activity. Without limitation of the foregoing, and notwithstanding anything to the contrary set forth herein, in no event shall the Premises be utilized (a) as a police station or holding cell, or for courtroom use, (b) as a location for the use or storage of weapons of any kind (and Tenant's employees and invitees shall in no event carry weapons), and/or (c) as a location where criminal defendants in police custody are brought for any purpose or in which criminal defendants are invited or processed.

8. Security Deposit: None.
9. Parking Pass Ratio (Article 28): One (1) unreserved parking pass for every 2,500 rentable square feet of the Premises, subject to the terms of Article 28 of this Lease.
10. Address of Tenant (Section 29.18): King County
Facilities Management Division
Attention: Lease Administrator
500 Fourth Avenue, Suite 800
Seattle, Washington 98104
11. Address of Landlord (Section 29.18): See Section 29.18 of the Lease.
12. Broker(s) (Section 29.24): CBRE, Inc., representing Landlord, and Flinn Ferguson Cresa, representing Tenant.
13. Guarantor: None.
14. Tenant Improvements: See Exhibit B, attached hereto.
15. Ordinance Authorizing Tenant execution: Ordinance No.: [REDACTED]

ARTICLE 1

PREMISES, BUILDING, PROJECT, AND COMMON AREAS

1.1 Premises, Building, Project and Common Areas.

1.1.1 **The Premises; Tender of Possession.** Landlord hereby leases to Tenant and Tenant hereby leases from Landlord the premises set forth in Section 2.2 of the Summary (the "**Premises**"). The outline of the Premises is set forth in Exhibit A attached hereto and the Premises has the number of rentable square feet as set forth in Section 2.2 of the Summary (which shall not be subject to re-measurement or modification). The parties hereto agree that the lease of the Premises is upon and subject to the terms, covenants and conditions herein set forth, and Tenant covenants as a material part of the consideration for this Lease to keep and perform each and all of such terms, covenants and conditions by it to be kept and performed and that this Lease is made upon the condition of such performance. The parties hereto hereby acknowledge that the purpose of Exhibit A is to show the approximate location of the Premises in the Building (as defined in Section 1.1.2 below), only, and such Exhibit is not meant to constitute an agreement, representation or warranty as to the construction of the Premises, the precise area thereof or the specific location of the Common Areas (as defined in Section 1.1.3 below), or the elements thereof or of the accessways to the Premises or the Project (as defined in Section 1.1.2 below). Except as specifically set forth in this Lease and in the Tenant Work Letter attached hereto as Exhibit B (the "**Tenant Work Letter**"), Landlord shall tender possession of the Premises to Tenant in its existing, "as is" condition, and Landlord shall not be obligated to provide or pay for any improvement work or services related to the improvement of the Premises. Landlord shall be deemed to have tendered possession of the Premises to Tenant upon the date the Premises are "Ready for Occupancy," as that term is defined in the Tenant Work Letter (the "**Possession Date**"), and no action by Tenant shall be required therefor. The anticipated Possession Date is January 1, 2023 (the "**Target Possession Date**"). If for any reason, Landlord is delayed in delivering possession of the Premises to Tenant by any particular date, Landlord shall not be subject to any liability for such failure, and the validity of this Lease shall not be impaired. Neither Landlord nor any agent of Landlord has made any representation or warranty regarding the condition of the Premises, the Building or the Project or with respect to the suitability of any of the foregoing for the conduct of Tenant's business, except as specifically set forth in this Lease and the Tenant Work Letter.

1.1.2 **The Building and The Project.** The Premises are a part of the building set forth in Section 2.1 of the Summary (the "**Building**"). The Building is part of an office project currently known as "Columbia Center." The term "**Project**," as used in this Lease, shall mean (i) the Building, the building located at 403 Columbia Street, Seattle, Washington (the "**Adjacent Building**"), and the Common Areas, (ii) the land (which is improved with landscaping, parking facilities and other improvements) upon which the Building, the Adjacent Building and the Common Areas are located, and (iii) at Landlord's discretion, any additional real property, areas, land, buildings or other improvements added thereto outside of the Project.

1.1.3 **Common Areas.** Tenant shall have the non-exclusive right to use in common with other tenants in the Project, and subject to the rules and regulations referred to in Article 5 of this Lease, those portions of the Project which are provided, from time to time, for use in common by Landlord, Tenant and any other tenants of the Project (such areas, together with such other portions of the Project designated by Landlord, in its discretion, including certain areas designated for the exclusive use of certain tenants, or to be shared by Landlord and certain tenants, are collectively referred to herein as the "**Common Areas**"). The Common Areas shall consist of the Project Common Areas and the Building Common Areas (as such terms are defined herein below). The term "**Project Common Areas**," as used in this Lease, shall mean the portion of the Project designated as such by Landlord. The term "**Building Common Areas**," as used in this Lease, shall mean the portions of the Common Areas located within the Building designated as such by Landlord. The manner in which the Common Areas are maintained and operated shall be materially consistent with "Comparable Buildings," as that term is defined in Section 2 of the Extension Option Rider attached hereto, but at the sole discretion of Landlord, and the use thereof shall be subject to such rules, regulations and restrictions as Landlord may make from time to time. Landlord reserves the right to close temporarily, make alterations or additions to, or change the location of elements of the Project and the Common Areas.

ARTICLE 2

LEASE TERM

The terms and provisions of this Lease shall be effective as of the date of this Lease. The term of this Lease (the "**Lease Term**") shall be as set forth in Section 3.1 of the Summary, shall commence on the date set forth in Section 3.2 of the Summary (the "**Lease Commencement Date**"), and shall terminate on the date set forth in Section 3.3 of the Summary (the "**Lease Expiration Date**") unless this Lease is sooner terminated as hereinafter provided. For purposes of this Lease, the term "**Lease Year**" shall mean each consecutive twelve (12) month period during the Lease Term, provided that the last Lease Year shall end on the Lease Expiration Date. Following the Lease Commencement Date, Landlord may deliver to Tenant a notice of lease term dates in the form as set forth in Exhibit C attached hereto, setting forth, among other things, the Lease Commencement Date and the Lease Expiration Date, which notice Tenant shall execute and return to Landlord within ten (10) business days after Tenant's receipt thereof. If Tenant fails to execute and return such notice within such 10-business day period, Tenant shall be deemed to have approved and confirmed the dates set forth therein, provided that such deemed approval shall not relieve Tenant of its obligation to execute and return such notice (and such failure shall constitute a default by Tenant hereunder).

ARTICLE 3

BASE RENT

3.1 **In General.** Tenant shall pay, without prior notice or demand, to Landlord or Landlord's agent at the management office of the Project, or, at Landlord's option, at such other place as Landlord may from time to time designate in writing, by a check for currency which, at the time of payment, is legal tender for private or public debts in the United States of America, base rent ("**Base Rent**") as set forth in Section 4 of the Summary, payable in equal monthly installments as set forth in Section 4 of the Summary in advance on or before the first day of each and every calendar month during the Lease Term, without any setoff or deduction whatsoever. The Base Rent for the first full month of the Lease Term which occurs after the expiration of the "Free Rent Period," as that term is defined in Section 3.2, below, shall be paid at the time of Tenant's execution of this Lease. If any Rent payment date (including the Lease Commencement Date) falls on a day of the month other than the first day of such month or if any payment of Rent is for a period which is shorter than one month, the Rent for any fractional month shall accrue on a daily basis for the period from the date such payment is due to the end of such calendar month or to the end of the Lease Term at a rate per day which is equal to 1/365 of the applicable annual Rent. All other payments or adjustments required to be made under the terms of this Lease that require proration on a time basis shall be prorated on the same basis.

3.2 **Abated Base Rent.** Notwithstanding anything in this Section 3.1, above, to the contrary, provided that Tenant is not in default of this Lease, Tenant shall not be obligated to pay an amount equal to \$133,873.50 of the monthly Base Rent attributable to the Premises for each of the first six (6) months of the initial Lease Term (the "**Free Rent Period**").

ARTICLE 4

ADDITIONAL RENT

4.1 **General Terms.** In addition to paying the Base Rent specified in Article 3 of this Lease, Tenant shall pay Tenant's Share of the annual Direct Expenses (as such terms are defined in Sections 4.2.6 and 4.2.2 below, respectively), which are in excess of the amount of Direct Expenses applicable to the Base Year (as defined in Section 4.2.1 below); provided, however, that in no event shall any decrease in Direct Expenses for any "**Expense Year**," as that term is defined in Section 4.2.6 below, below Direct Expenses for the Base Year entitle Tenant to any decrease in Base Rent or any credit against sums due under this Lease. Such payments by Tenant, together with any and all other amounts payable by Tenant to Landlord pursuant to the terms of this Lease, are hereinafter collectively referred to as the "**Additional Rent**," and the Base Rent and the Additional Rent are herein collectively referred to as "**Rent**." All amounts due under this Article 4 as Additional Rent shall be payable for the same periods and in the same manner as the Base Rent. Without limitation on other obligations of Tenant which survive the expiration of the Lease Term, the obligations of Tenant to pay the Additional Rent provided for in this Article 4 shall survive the expiration of the Lease Term.

4.2 **Definitions of Key Terms Relating to Additional Rent.** As used in this Article 4, the following terms shall have the meanings hereinafter set forth:

4.2.1 “**Base Year**” shall mean the period set forth in Section 5 of the Summary.

4.2.2 “**Direct Expenses**” shall mean “Operating Expenses” and “Tax Expenses.”

4.2.3 “**Expense Year**” shall mean each calendar year, including the Base Year, in which any portion of the Lease Term falls, through and including the calendar year in which the Lease Term expires, provided that Landlord, upon notice to Tenant, may change the Expense Year (other than the Base Year) from time to time to any other twelve (12) consecutive month period, and, in the event of any such change, Tenant’s Share of Direct Expenses shall be equitably adjusted for any Expense Year involved in any such change.

4.2.4 “**Operating Expenses**” shall mean all expenses, costs and amounts of every kind and nature which Landlord pays or accrues during any Expense Year because of or in connection with the ownership, management, maintenance, security, repair, replacement, restoration or operation of the Project, or any portion thereof. Without limiting the generality of the foregoing, Operating Expenses shall specifically include any and all of the following: (i) the cost of supplying all utilities, the cost of operating, repairing, maintaining, and renovating the utility, telephone, mechanical, sanitary, storm drainage, and elevator systems, and the cost of maintenance and service contracts in connection therewith; (ii) the cost of licenses, certificates, permits and inspections and the cost of contesting any governmental enactments which may affect Operating Expenses, and the costs incurred in connection with a governmentally mandated transportation system management program or similar program; (iii) the cost of all insurance carried by Landlord in connection with the Project as reasonably determined by Landlord; (iv) the cost of landscaping, relamping, and all supplies, tools, equipment and materials used in the operation, repair and maintenance of the Project, or any portion thereof; (v) the cost of parking area operation servicing the Project (whether on or offsite), repair, restoration, and maintenance; (vi) fees and other costs, including management and/or incentive fees, consulting fees, legal fees and accounting fees, in connection with the management, operation, maintenance and repair of the Project; (vii) payments under any equipment rental agreements and the fair rental value of any management office space; (viii) subject to item (f), below, wages, salaries and other compensation and benefits, including taxes levied thereon, of all persons engaged in the operation, maintenance and security of the Project; (ix) costs under any instrument pertaining to the sharing of costs by the Project; (x) operation, repair, maintenance and replacement of all systems and equipment and components thereof of the Project; (xi) the cost of janitorial, alarm, security and other services, replacement of wall and floor coverings, ceiling tiles and fixtures in common areas, maintenance and replacement of curbs and walkways, repair to roofs and re-roofing; (xii) amortization (including interest on the unamortized cost) over such period of time as Landlord shall reasonably determine, of the cost of acquiring or the rental expense of personal property used in the maintenance, operation and repair of the Project, or any portion thereof; (xiii) the cost of capital improvements or other costs incurred in connection with the Project (A) which are intended to effect economies in the operation or maintenance of the Project, or any portion thereof, or to reduce current or future Operating Expenses, or to enhance the safety or security of the Project or its occupants, (B) that are required to comply with present or anticipated conservation programs, (C) which are replacements or modifications of nonstructural items located in the Common Areas required to keep the Common Areas in good order or condition, or (D) that are required under any governmental law or regulation; provided, however, that any capital expenditure shall be amortized (including interest on the amortized cost) over such period of time as Landlord shall reasonably determine; (xiv) costs, fees, charges or assessments imposed by, or resulting from any mandate imposed on Landlord by, any federal, state or local government for fire and police protection, trash removal, community services, or other services which do not constitute Tax Expenses (as defined in Section 4.2.5 below); (xv) cost of tenant relation programs reasonably established by Landlord; and (xvi) payments under any easement, license, operating agreement, declaration, restrictive covenant, or instrument pertaining to the sharing of costs by the Project. Notwithstanding the foregoing, for purposes of this Lease, Operating Expenses shall not, however, include:

(a) costs, including legal fees, space planners’ fees, advertising and promotional expenses (except as otherwise set forth above), and brokerage fees incurred in connection with the original construction or development, or original or future leasing of the Project, and costs, including permit, license and inspection costs, incurred with respect to the installation of tenant improvements made for new tenants initially occupying space in the Project after the Lease Commencement Date or incurred in renovating or otherwise improving,

decorating, painting or redecorating vacant space for tenants or other occupants of the Project (excluding, however, such costs relating to any common areas of the Project or parking facilities);

(b) except as set forth in Section 4.2.4(xii), (xiii), and (xiv) above, depreciation, interest and principal payments on mortgages and other debt costs, if any, penalties and interest, costs of capital repairs and alterations, and costs of capital improvements and equipment;

(c) costs for which the Landlord is reimbursed by any tenant or occupant of the Project or by insurance by its carrier or any tenant's carrier or by anyone else, and electric power costs for which any tenant directly contracts with the local public service company;

(d) any bad debt loss, rent loss, or reserves for bad debts or rent loss;

(e) costs associated with the operation of the business of the partnership or entity which constitutes the Landlord, as the same are distinguished from the costs of operation of the Project (which shall specifically include, but not be limited to, accounting costs associated with the operation of the Project). Costs associated with the operation of the business of the partnership or entity which constitutes Landlord shall mean the costs of partnership accounting and legal matters, costs of defending any lawsuits with any mortgagee (except as the actions of the Tenant may be in issue), costs of selling, syndicating, financing, mortgaging or hypothecating any of the Landlord's interest in the Project, and costs incurred in connection with any disputes between Landlord and its employees, between Landlord and Project management, or between Landlord and other tenants or occupants;

(f) the wages and benefits of any employee who does not devote substantially all of his or her employed time to the Project unless such wages and benefits are prorated to reflect time spent on operating and managing the Project vis-a-vis time spent on matters unrelated to operating and managing the Project; provided, that in no event shall Operating Expenses for purposes of this Lease include wages and/or benefits attributable to personnel above the level of general manager of the Project;

(g) amount paid as ground rental for the Project by the Landlord;

(h) except for a Project management fee, overhead and profit increment paid to the Landlord or to subsidiaries or affiliates of the Landlord for services in the Project to the extent the same exceeds the costs of such services rendered by qualified, first-class unaffiliated third parties on a competitive basis;

(i) any compensation paid to clerks, attendants or other persons in commercial concessions operated by the Landlord, provided that any compensation paid to any concierge at the Project shall be includable as an Operating Expense;

(j) rentals and other related expenses incurred in leasing air conditioning systems, elevators or other equipment which if purchased the cost of which would be excluded from Operating Expenses as a capital cost, except equipment not affixed to the Project which is used in providing janitorial or similar services and, further excepting from this exclusion such equipment rented or leased to remedy or ameliorate an emergency condition in the Project;

(k) all items and services for which Tenant or any other tenant in the Project reimburses Landlord or which Landlord provides selectively to one or more tenants (other than Tenant) without reimbursement;

(l) any costs expressly excluded from Operating Expenses elsewhere in this Lease;

(m) rent for any office space occupied by Project management personnel to the extent the size or rental rate of such office space exceeds the size or fair market rental value of office space occupied by management personnel of the comparable buildings in the vicinity of the Building, with adjustment where appropriate for the size of the applicable project;

(n) costs arising from the gross negligence or willful misconduct of Landlord or its agents, employees, vendors, contractors, or providers of materials or services; and

(o) costs incurred to comply with laws relating to the removal of hazardous material (as defined under applicable law) which was in existence in the Building or on the Project prior to the Lease Commencement Date, and was of such a nature that a federal, State or municipal governmental authority, if it had then had knowledge of the presence of such hazardous material, in the state, and under the conditions that it then existed in the Building or on the Project, would have then required the removal of such hazardous material or other remedial or containment action with respect thereto; and costs incurred to remove, remedy, contain, or treat hazardous material, which hazardous material is brought into the Building or onto the Project after the date hereof by Landlord or any other tenant of the Project and is of such a nature, at that time, that a federal, State or municipal governmental authority, if it had then had knowledge of the presence of such hazardous material, in the state, and under the conditions, that it then exists in the Building or on the Project, would have then required the removal of such hazardous material or other remedial or containment action with respect thereto.

If Landlord is not furnishing any particular work or service (the cost of which, if performed by Landlord, would be included in Operating Expenses) to a tenant who has undertaken to perform such work or service in lieu of the performance thereof by Landlord, Operating Expenses shall be deemed to be increased by an amount equal to the additional Operating Expenses which would reasonably have been incurred during such period by Landlord if it had at its own expense furnished such work or service to such tenant. If the Project is not one hundred percent (100%) occupied during all or a portion of any Expense Year (including, without limitation, if any portion of the Project is unleased or is leased, but is not then being used by a tenant in the ordinary course of its business), Landlord shall make an appropriate adjustment to the components of Operating Expenses for such Expense Year to determine the amount of Operating Expenses that would have been incurred had the Project been one hundred percent (100%) occupied; and the amount so determined shall be deemed to have been the amount of Operating Expenses for such Expense Year. For purposes hereof, cost savings in components of Operating Expenses arising by reason of the cessation of use by tenants at the Project due to a "Casualty," as that term is defined in Section 11.1 below, "Force Majeure," as that term is defined in Section 29.16 below, or other extraordinary circumstances are considered variable Operating Expenses that may be grossed up in Operating Expenses. If Operating Expenses for the Base Year include amortized costs or costs (including, but not limited to, costs of personnel, insurance, and increased or new services) relating to extraordinary circumstances, including, but not limited to, Casualty, Force Majeure, boycotts, strikes, conservation surcharges, embargoes or shortages, then at such time as such costs are no longer applicable, the increased Operating Expenses attributable thereto shall be excluded from the Base Year Operating Expenses. In no event shall the components of Direct Expenses for any Expense Year related to Project insurance, security or utility costs be less than the components of Direct Expenses related to Project insurance, security or utility costs, respectively, in the Base Year.

4.2.5 **Taxes.**

4.2.5.1 "Tax Expenses" shall mean all federal, state, county, or local governmental or municipal taxes, fees, charges or other impositions of every kind and nature, whether general, special, ordinary or extraordinary, (including, without limitation, real estate taxes, real estate excise taxes, general and special assessments, transit taxes, leasehold taxes or taxes based upon the receipt of rent, including gross receipts or sales taxes applicable to the receipt of rent, unless required to be paid by Tenant, personal property taxes imposed upon the fixtures, machinery, equipment, apparatus, systems and equipment, appurtenances, furniture and other personal property used in connection with the Project, or any portion thereof), which shall be paid or accrued during any Expense Year (without regard to any different fiscal year used by such governmental or municipal authority) because of or in connection with the ownership, leasing and operation of the Project, or any portion thereof.

4.2.5.2 Tax Expenses shall include, without limitation: (i) Any tax on the rent, right to rent or other income from the Project, or any portion thereof, or as against the business of leasing the Project, or any portion thereof; (ii) Any assessment, tax, fee, levy or charge in addition to, or in substitution, partially or totally, of any assessment, tax, fee, levy or charge previously included within the definition of real property tax, it being acknowledged by Tenant and Landlord that assessments, taxes, fees, levies and charges may be imposed by governmental agencies for such services as fire protection, street, sidewalk and road maintenance, refuse removal and for other governmental services formerly provided without charge to property owners or occupants, and, Tax Expenses

shall also include any governmental or private assessments or the Project's contribution towards a governmental or private cost-sharing agreement for the purpose of augmenting or improving the quality of services and amenities normally provided by governmental agencies; (iii) Any assessment, tax, fee, levy, or charge allocable to or measured by the area of the Premises or the Rent payable hereunder, including, without limitation, any business or gross income tax or excise tax with respect to the receipt of such rent, or upon or with respect to the possession, leasing, operating, management, maintenance, alteration, repair, use or occupancy by Tenant of the Premises, or any portion thereof; and (iv) Any assessment, tax, fee, levy or charge, upon this transaction or any document to which Tenant is a party, creating or transferring an interest or an estate in the Premises or the improvements thereon.

4.2.5.3 Any costs and expenses (including, without limitation, reasonable attorneys' and consultants' fees) incurred in attempting to protest, reduce or minimize Tax Expenses shall be included in Tax Expenses in the Expense Year such expenses are incurred. Tax refunds shall be credited against Tax Expenses and refunded to Tenant regardless of when received, based on the Expense Year to which the refund is applicable, provided that in no event shall the amount to be refunded to Tenant for any such Expense Year exceed the total amount paid by Tenant as Additional Rent under this Article 4 for such Expense Year. Notwithstanding anything to the contrary set forth in this Lease, (a) only Landlord may institute proceedings to reduce Tax Expenses and the filing of any such proceeding by Tenant without Landlord's consent shall constitute an event of default by Tenant under this Lease, and (b) Landlord shall not be obligated to file any application or institute any proceeding seeking a reduction in Tax Expenses. If Tax Expenses for any period during the Lease Term or any extension thereof are increased after payment thereof for any reason, including, without limitation, error or reassessment by applicable governmental or municipal authorities, Tenant shall pay Landlord upon demand Tenant's Share of any such increased Tax Expenses. Notwithstanding anything to the contrary contained in this Section 4.2.5 (except as set forth in Section 4.2.5.1 above), there shall be excluded from Tax Expenses (i) all excess profits taxes, franchise taxes, gift taxes, capital stock taxes, inheritance and succession taxes, estate taxes, federal and state income taxes, and other taxes to the extent applicable to Landlord's general or net income (as opposed to rents, receipts or income attributable to operations at the Project), (ii) any items included as Operating Expenses, and (iii) any items paid by Tenant under Section 4.5 below.

4.2.5.4 The amount of Tax Expenses for the Base Year attributable to the valuation of the Project, inclusive of tenant improvements, shall be known as the "Base Taxes". If in any comparison year subsequent to the Base Year, the amount of Tax Expenses decreases below the amount of Base Taxes, then for purposes of all subsequent comparison years, including the comparison year in which such decrease in Tax Expenses occurred, the Base Taxes, and therefore the Base Year, shall be decreased by an amount equal to the decrease in Tax Expenses.

4.2.6 "Tenant's Share" shall mean the percentage set forth in Section 6 of the Summary.

4.3 Allocations.

4.3.1 Method of Allocation. The parties acknowledge that, notwithstanding any contrary provision contained in the Lease, the Building is a part of a multi-building project and that the costs and expenses incurred in connection with the Project (i.e., the Direct Expenses) should be shared between the tenants of the Building and the tenants of the Adjacent Building. Accordingly, Direct Expenses are determined annually for the Property as a whole, and a portion of the Direct Expenses, which portion shall be determined by Landlord on an equitable basis, shall be allocated to the tenants of the Building (as opposed to the tenants of the Adjacent Building) and such portion shall be the Direct Expenses for purposes of this Lease. Such portion of Direct Expenses allocated to the tenants of the Building shall include all Direct Expenses attributable solely to the Building and an equitable portion of the Direct Expenses attributable to the Project as a whole.

4.3.2 Cost Pools. Landlord shall have the right, from time to time, to equitably allocate some or all of the Direct Expenses for the Project among different portions or occupants of the Project (the "Cost Pools"), in Landlord's reasonable discretion. Such Cost Pools may include, but shall not be limited to, the office space tenants of a building of the Project or of the Project, and the retail space tenants of a building of the Project or of the Project. The Direct Expenses within each such Cost Pool shall be allocated and charged to the tenants within such Cost Pool in an equitable manner.

4.4 Calculation and Payment of Additional Rent. If for any Expense Year ending or commencing within the Lease Term, Tenant's Share of Direct Expenses for such Expense Year exceeds Tenant's Share of Direct

Expenses applicable to the Base Year, then Tenant shall pay to Landlord, in the manner set forth in Section 4.4.1, below, and as Additional Rent, an amount equal to the excess (the "Excess").

4.4.1 **Statement of Actual Direct Expenses and Payment by Tenant.** During each Expense Year, Tenant shall pay "Estimated Excess," as that term is defined in Section 4.4.2, below, in accordance with the terms of Section 4.4.2, below. Landlord shall endeavor to give to Tenant following the end of each Expense Year, a statement (the "Statement") which shall state the Direct Expenses incurred or accrued for such preceding Expense Year, and which shall indicate the amount of the Excess, if any. Upon receipt of the Statement for each Expense Year commencing or ending during the Lease Term, if an Excess is present, Tenant shall pay, with its next installment of Base Rent due, the full amount of the Excess for such Expense Year, less the amounts, if any, paid during such Expense Year as "Estimated Excess," as that term is defined in Section 4.4.2 below, and if Tenant paid more as Estimated Excess than the actual Excess, Tenant shall receive a credit in the amount of Tenant's overpayment against Rent next due under this Lease. The failure of Landlord to timely furnish the Statement for any Expense Year shall not prejudice Landlord or Tenant from enforcing its rights under this Article 4. Even though the Lease Term has expired and Tenant has vacated the Premises, when the final determination is made of Tenant's Share of Direct Expenses for the Expense Year in which this Lease terminates, if an Excess is present, Tenant shall immediately pay to Landlord such amount, and if Tenant paid more as Estimated Excess than the actual Excess, Landlord shall, within thirty (30) days, deliver a check payable to Tenant in the amount of the overpayment or apply such overpayment against any unpaid Rent. The provisions of this Section 4.4.1 shall survive the expiration or earlier termination of the Lease Term.

4.4.2 **Statement of Estimated Direct Expenses.** In addition, Landlord shall endeavor to give Tenant a yearly expense estimate statement (the "Estimate Statement") which shall set forth Landlord's reasonable estimate (the "Estimate") of what the total amount of Direct Expenses for the then-current Expense Year shall be and the estimated excess (the "Estimated Excess") as calculated by comparing the Direct Expenses for such Expense Year, which shall be based upon the Estimate, to the amount of Direct Expenses for the Base Year. The failure of Landlord to timely furnish the Estimate Statement for any Expense Year shall not preclude Landlord from enforcing its rights to collect any Estimated Excess under this Article 4, nor shall Landlord be prohibited from revising any Estimate Statement or Estimated Excess theretofore delivered to the extent necessary. Thereafter, Tenant shall pay, with its next installment of Base Rent due, a fraction of the Estimated Excess for the then-current Expense Year (reduced by any amounts paid pursuant to the last sentence of this Section 4.4.2). Such fraction shall have as its numerator the number of months which have elapsed in such current Expense Year, including the month of such payment, and twelve (12) as its denominator. Until a new Estimate Statement is furnished (which Landlord shall have the right to deliver to Tenant at any time), Tenant shall pay monthly, with the monthly Base Rent installments, an amount equal to one-twelfth (1/12) of the total Estimated Excess set forth in the previous Estimate Statement delivered by Landlord to Tenant.

4.5 **Taxes and Other Charges for Which Tenant Is Directly Responsible.**

4.5.1 Tenant shall be liable for and shall pay before delinquency, taxes levied against Tenant's equipment, furniture, fixtures and any other personal property located in or about the Premises. If any such taxes on Tenant's equipment, furniture, fixtures and any other personal property are levied against Landlord or Landlord's property or if the assessed value of Landlord's property is increased by the inclusion therein of a value placed upon such equipment, furniture, fixtures or any other personal property and if Landlord pays the taxes based upon such increased assessment, which Landlord shall have the right to do regardless of the validity thereof but only under proper protest if requested by Tenant, Tenant shall upon demand repay to Landlord the taxes so levied against Landlord or the proportion of such taxes resulting from such increase in the assessment, as the case may be.

4.5.2 If the tenant improvements in the Premises, whether installed and/or paid for by Landlord or Tenant and whether or not affixed to the real property so as to become a part thereof, are assessed for real property tax purposes at a valuation higher than the valuation at which tenant improvements conforming to Landlord's "building standard" in other space in the Building are assessed, then the Tax Expenses levied against Landlord or the property by reason of such excess assessed valuation shall be deemed to be taxes levied against personal property of Tenant and shall be governed by the provisions of Section 4.5.1 above. Notwithstanding the foregoing, so long as Tenant makes no material changes to the "Space Plan," as that term is defined in Section 1.1 of the Tenant Work Letter, or once completed, the Working Drawings, Approved Working Drawings or Tenant Improvements, Landlord hereby agrees that Tenant shall not be obligated to pay amounts pursuant to the terms of this Section 4.5.2.

4.5.3 Notwithstanding any contrary provision herein, Tenant shall pay prior to delinquency any (i) rent tax or sales tax, service tax, transfer tax or value added tax, or any other applicable tax on the rent or services herein or otherwise respecting this Lease, (ii) taxes assessed upon or with respect to the possession, leasing, operation, management, maintenance, alteration, repair, use or occupancy by Tenant of the Premises or any portion of the Project, including the parking facility servicing the Project; or (iii) taxes assessed upon this transaction or any document to which Tenant is a party creating or transferring an interest or an estate in the Premises.

ARTICLE 5

USE OF PREMISES

5.1 **Permitted Use.** Tenant shall use the Premises solely for the Permitted Use set forth in Section 7 of the Summary and Tenant shall not use or permit the Premises or the Project to be used for any other purpose or purposes whatsoever without the prior written consent of Landlord, which may be withheld in Landlord's sole discretion. Except as provided and upon the terms set forth in Section 14.8 of this Lease, Tenant hereby acknowledges and agrees that no departments, divisions or employees of King County, other than the Civil Division, shall be permitted to use or occupy the Premises pursuant to the terms of this Lease.

5.2 **Prohibited Uses.** Tenant further covenants and agrees that Tenant shall not use, or suffer or permit any person or persons to use, the Premises or any part thereof for any use or purpose contrary to the provisions of the Rules and Regulations set forth in Exhibit D, attached hereto, or in violation of the laws of the United States of America, the State of Washington, or the ordinances, regulations or requirements of the local municipal or county governing body or other lawful authorities having jurisdiction over the Project, including, without limitation, any such laws, ordinances, regulations or requirements relating to hazardous materials or substances, as those terms are defined by applicable laws now or hereafter in effect. Tenant shall not do or permit anything to be done in or about the Premises which will in any way damage the reputation of the Project or obstruct or interfere with the rights of other tenants or occupants of the Building, or injure or annoy them or use or allow the Premises to be used for any improper, unlawful or objectionable purpose, nor shall Tenant cause, maintain or permit any nuisance in, on or about the Premises. Tenant shall comply with, and Tenant's rights and obligations under the Lease and Tenant's use of the Premises shall be subject and subordinate to, all recorded easements, covenants, conditions, and restrictions now or hereafter affecting the Project.

ARTICLE 6

SERVICES AND UTILITIES

6.1 **Standard Tenant Services.** Landlord shall provide the following services on all days (unless otherwise stated below) during the Lease Term.

6.1.1 Subject to limitations imposed by all governmental rules, regulations and guidelines applicable thereto, Landlord shall provide heating and air conditioning ("**HVAC**") when necessary for normal comfort for normal office use in the Premises from 7:00 A.M. to 6:00 P.M. Monday through Friday, and on Saturdays from 8:00 A.M. to 1:00 P.M. (collectively, the "**Building Hours**"), except for the date of observation of New Year's Day, Independence Day, Labor Day, Memorial Day, Thanksgiving Day, Christmas Day and, at Landlord's discretion, other locally or nationally recognized holidays which are observed by other buildings comparable to and in the vicinity of the Building (collectively, the "**Holidays**").

6.1.2 Landlord shall provide adequate electrical wiring and facilities for connection to Tenant's lighting fixtures and incidental use equipment, subject to the terms of this Section 6.1.2 and the terms of Section 6.2, below. In connection with the foregoing, Landlord shall provide, as an Operating Expense, electrical equipment and facilities so long as (i) the connected electrical load of the incidental use equipment in the Premises does not exceed an average of three (3) watts per rentable square foot of the Premises during Building Hours, and the electricity so furnished for incidental use equipment will be at a nominal one hundred twenty (120) volts and no electrical circuit for the supply of such incidental use equipment will require a current capacity exceeding twenty (20) amperes, and (ii) the connected electrical load of Tenant's lighting fixtures does not exceed an average of one (1) watt per rentable square foot of the Premises during Building Hours, and the electricity so furnished for Tenant's lighting will be at a

nominal two hundred seventy-seven (277) volts, which electrical usage shall be subject to applicable laws and regulations. Subject to the foregoing limitations regarding the electrical wiring and facilities to be provided by Landlord, Landlord shall only provide electricity for Tenant's lighting fixtures during the Building Hours, excluding Holidays. Tenant shall bear the cost of replacement of lamps, starters and ballasts for non-Building standard lighting fixtures within the Premises.

6.1.3 Landlord shall provide city water from the regular Building outlets for drinking, lavatory and toilet purposes in the Building Common Areas, and shall also provide city water for (i) the base building restrooms servicing the floors of the Premises, and (ii) any typical office kitchen and pantries within the Premises constructed in accordance with the terms of the Tenant Work Letter.

6.1.4 Landlord shall provide janitorial services to the Premises, except for weekends and the date of observation of the Holidays, in and about the Premises and window washing services in a manner consistent with other comparable buildings in the vicinity of the Building.

6.1.5 Landlord shall provide nonexclusive, non-attended automatic passenger elevator service during the Building Hours, shall have one elevator available at all other times, including on the Holidays.

6.1.6 Landlord shall provide nonexclusive freight elevator service subject to scheduling by Landlord.

Tenant shall cooperate fully with Landlord at all times and abide by all regulations and requirements that Landlord may reasonably prescribe for the proper functioning and protection of the HVAC, electrical, mechanical and plumbing systems.

6.2 **Overstandard Tenant Use.** Tenant shall not, without Landlord's prior written consent, use heat-generating machines, machines other than normal fractional horsepower office machines, or equipment or lighting other than Building standard lights in the Premises, which may affect the temperature otherwise maintained by the air conditioning system or increase the water normally furnished for the Premises by Landlord pursuant to the terms of Section 6.1 above. If Tenant uses water, electricity, heat or air conditioning in excess of that supplied by Landlord pursuant to Section 6.1 above, Tenant shall pay to Landlord, upon billing, the actual cost of such excess consumption, the cost of the installation, operation, and maintenance of equipment which is installed in order to supply such excess consumption, and the cost of the increased wear and tear on existing equipment caused by such excess consumption; and Landlord may install devices to separately meter any increased use and in such event Tenant shall pay the increased cost directly to Landlord, on demand, at the rates charged by the public utility company furnishing the same, including the cost of installing, testing and maintaining of such additional metering devices. Tenant's use of electricity shall never exceed the capacity of the feeders to the Project or the risers or wiring installation, and subject to the terms of Section 29.31 below, Tenant shall not install or use or permit the installation or use of any computer or electronic data processing equipment in the Premises, without the prior written consent of Landlord. If Tenant desires to use heat, ventilation or air conditioning during hours other than those for which Landlord is obligated to supply such utilities pursuant to the terms of Section 6.1 above, Tenant shall give Landlord such prior notice, if any, as Landlord shall from time to time establish as appropriate, of Tenant's desired use in order to supply such utilities, and Landlord shall supply such utilities to Tenant at such hourly cost per zone to Tenant (which shall be treated as Additional Rent) as Landlord shall from time to time establish. Notwithstanding any provision to the contrary contained in this Lease, Tenant shall promptly pay to Landlord, Landlord's standard charge for any services provided to Tenant which Landlord is not specifically obligated to provide to Tenant pursuant to the terms of this Lease.

6.3 **Interruption of Use.** Tenant agrees that Landlord shall not be liable for damages, by abatement of Rent (except as specifically set forth in Section 6.4, below) or otherwise, for failure to furnish or delay in furnishing any service (including telephone and telecommunication services), or for any diminution in the quality or quantity thereof, when such failure or delay or diminution is occasioned, in whole or in part, by breakage, repairs, replacements, or improvements, by any strike, lockout or other labor trouble, by inability to secure electricity, gas, water, or other fuel at the Building or Project after reasonable effort to do so, by any riot or other dangerous condition, emergency, accident or casualty whatsoever, by act or default of Tenant or other parties, or by any other cause beyond Landlord's reasonable control; and such failures or delays or diminution shall never be deemed to constitute an eviction or disturbance of Tenant's use and possession of the Premises or relieve Tenant from paying Rent (except as specifically

set forth in Section 6.4, below) or performing any of its obligations under this Lease. Furthermore, Landlord shall not be liable under any circumstances for a loss of, or injury to, property or for injury to, or interference with, Tenant's business, including, without limitation, loss of profits, however occurring, through or in connection with or incidental to a failure to furnish any of the services or utilities as set forth in this Article 6.

6.4 **Abatement Event.** In the event that (i) Tenant is prevented from using, and actually does not use, a material portion of the Premises as a result of (a) any failure by Landlord to provide services to the Premises as required by Section 6.1 of this Lease, or (b) Landlord's performance of any "Renovations," as that term is defined in Section 29.29, of this Lease, (ii) such failure is within the reasonable control of Landlord to cure, and (iii) such failure is not the result of the acts and/or omissions of Tenant and/or other "Tenant Parties," as that term is defined in Section 10.1 of this Lease (an "Abatement Event"), then Tenant shall give Landlord notice of such Abatement Event, and if such Abatement Event continues for five (5) consecutive business days (three (3) business days in connection with an Abatement Event resulting from any Renovation undertaken by Landlord) after Landlord's receipt of any such notice (the "Eligibility Period"), then the Base Rent and Tenant's Share of Direct Expenses shall be abated or reduced, as the case may be, after expiration of the Eligibility Period for such time that Tenant continues to be so prevented from using, and does not use, the Premises or a portion thereof, in the proportion that the rentable area of the portion of the Premises that Tenant is prevented from using, and does not use, bears to the total rentable area of the Premises; provided, however, in the event that Tenant is prevented from using, and does not use, a portion of the Premises for a period of time in excess of the Eligibility Period and the remaining portion of the Premises is not sufficient to allow Tenant to effectively conduct its business therein, and if Tenant does not conduct its business from such remaining portion, then for such time after expiration of the Eligibility Period during which Tenant is so prevented from effectively conducting its business therein, the Base Rent and Tenant's Share of Direct Expenses for the entire Premises shall be abated for such time as Tenant continues to be so prevented from using, and does not use, the Premises. If, however, Tenant reoccupies any portion of the Premises during such period, the Rent allocable to such reoccupied portion, based on the proportion that the rentable area of such reoccupied portion of the Premises bears to the total rentable area of the Premises, shall be payable by Tenant from the date Tenant reoccupies such portion of the Premises. Such right to abate Base Rent and Tenant's Share of Direct Expenses shall be Tenant's sole and exclusive remedy at law or in equity for an Abatement Event. Except as provided in this Section 6.4, nothing contained herein shall be interpreted to mean that Tenant is excused from paying Rent due hereunder.

ARTICLE 7

REPAIRS

Tenant shall, at Tenant's own expense, keep the Premises, including all improvements, fixtures, furnishings, and systems and equipment therein (including, without limitation, (a) plumbing fixtures and equipment such as dishwashers, garbage disposals, and insta-hot dispensers, and (b) all equipment located in the Premises that is utilized to supply supplemental HVAC to the Premises), and the floor or floors of the Building on which the Premises are located, in good order, repair and condition at all times during the Lease Term. In addition, Tenant shall, at Tenant's own expense, but under the supervision and subject to the prior approval of Landlord, and within any reasonable period of time specified by Landlord, promptly and adequately repair all damage to the Premises and replace or repair all damaged, broken, or worn fixtures and appurtenances, except for damage caused by ordinary wear and tear or beyond the reasonable control of Tenant; provided however, that, at Landlord's option, or if Tenant fails to make such repairs, Landlord may, but need not, make such repairs and replacements, and Tenant shall pay Landlord the cost thereof, including a percentage of the cost thereof (to be uniformly established for the Building and/or the Project) sufficient to reimburse Landlord for all overhead, general conditions, fees and other costs or expenses arising from Landlord's involvement with such repairs and replacements forthwith upon being billed for same. Notwithstanding the foregoing, Landlord shall be responsible for repairs to the Common Areas, exterior walls, foundation and roof of the Building, the structural portions of the floors of the Building, and the base building systems and equipment of the Building, except to the extent that such repairs are required due to the negligence or willful misconduct of Tenant; provided, however, that if such repairs are due to the negligence or willful misconduct of Tenant, Landlord shall nevertheless make such repairs at Tenant's expense, or, if covered by Landlord's insurance, Tenant shall only be obligated to pay any deductible in connection therewith. Landlord may, but shall not be required to, enter the Premises at all reasonable times to make such repairs, alterations, improvements or additions to the Premises or to the Project or to any equipment located in the Project as Landlord shall desire or deem necessary or as Landlord may be required

to do by governmental or quasi-governmental authority or court order or decree. Tenant hereby waives and releases any and all rights it may have at law or in equity to make repairs at the expense of Landlord

ARTICLE 8

ADDITIONS AND ALTERATIONS

8.1 **Landlord's Consent to Alterations.** Tenant may not make any improvements, alterations, additions or changes to the Premises or any mechanical, plumbing or HVAC facilities or systems pertaining to the Premises (collectively, the "**Alterations**") without first procuring the prior written consent of Landlord to such Alterations, which consent shall be requested by Tenant not less than thirty (30) days prior to the commencement thereof, and which consent shall not be unreasonably withheld by Landlord, provided it shall be deemed reasonable for Landlord to withhold its consent to any Alteration which adversely affects the structural portions or the systems or equipment of the Building or is visible from the exterior of the Building. Notwithstanding the foregoing, Tenant shall be permitted to make Alterations following ten (10) business days' notice to Landlord, but without Landlord's prior consent, to the extent that such Alterations are decorative only (i.e., installation of carpeting or painting of the Premises). The construction of the initial improvements to the Premises shall be governed by the terms of the Tenant Work Letter and not the terms of this Article 8.

8.2 **Manner of Construction.** Landlord may impose, as a condition of its consent to any and all Alterations or repairs of the Premises or about the Premises, such requirements as Landlord in its reasonable discretion may deem desirable, including, but not limited to, the requirement that Tenant utilize for such purposes only contractors, subcontractors, materials, mechanics and materialmen selected by Tenant and approved by Landlord (in Landlord's reasonable discretion), provided that Landlord may require certain subcontractors be retained to the extent the subject work shall impact the Building structure or Building systems, and the requirement that upon Landlord's request, Tenant shall, at Tenant's expense, remove such Alterations upon the expiration or any early termination of the Lease Term. Tenant shall construct such Alterations and perform such repairs in a good and workmanlike manner, in conformance with any and all applicable federal, state, county or municipal laws, rules and regulations and pursuant to a valid building permit, issued by the city in which the Building is located (or other applicable governmental authority), all in conformance with Landlord's construction rules and regulations; provided, however, that prior to commencing to construct any Alteration, Tenant shall meet with Landlord to discuss Landlord's design parameters and code compliance issues. In the event Tenant performs any Alterations in the Premises which require or give rise to governmentally required changes to the Base Building (as defined below), then Landlord shall, at Tenant's expense, make such changes to the Base Building. The "**Base Building**" shall include the structural portions of the Building, and the public restrooms, elevators, exit stairwells and the systems and equipment located in the internal core of the Building on the floor or floors on which the Premises are located. In performing the work of any such Alterations, Tenant shall have the work performed in such manner so as not to obstruct access to the Project or any portion thereof, by any other tenant of the Project, and so as not to obstruct the business of Landlord or other tenants in the Project. Tenant shall not use (and upon notice from Landlord shall cease using) contractors, services, workmen, labor, materials or equipment that, in Landlord's reasonable judgment, would disturb labor harmony with the workforce or trades engaged in performing other work, labor or services in or about the Project, Building or the Common Areas and/or that results in picketing or other labor disturbances at the Project and/or in areas adjacent thereto. In addition to Tenant's obligations under Article 9 below, Tenant shall deliver to the Project construction manager a reproducible copy of the "as built" drawings of the Alterations as well as all permits, approvals and other documents issued by any governmental agency in connection with the Alterations.

8.3 **Payment for Improvements.** If payment is made by Tenant directly to contractors, Tenant shall (i) comply with Landlord's requirements for final lien releases and waivers in connection with Tenant's payment for work to contractors, and (ii) sign Landlord's standard contractor's rules and regulations. Tenant shall pay to Landlord an amount equal to five percent (5%) of the cost of any Alterations to compensate Landlord for all overhead, general conditions, fees and other costs and expenses arising from Landlord's involvement with such work. In addition, upon receipt of a statement from Landlord with reasonable supporting documentation, Tenant shall reimburse Landlord for Landlord's reasonable, actual, out-of-pocket costs and expenses actually incurred in connection with Landlord's review of such work.

8.4 **Construction Insurance.** In addition to the requirements of Article 10 below, in the event that Tenant makes any Alterations, prior to the commencement of such Alterations, Tenant shall provide Landlord with evidence that Tenant or its contractor carries "Builder's All Risk" insurance in an amount reasonably approved by Landlord covering the construction of such Alterations, and such other insurance as Landlord may reasonably require, it being understood and agreed that all of such Alterations shall be insured by Tenant pursuant to Article 10 below immediately upon completion thereof. In addition, Tenant's contractors and subcontractors shall be required to carry Commercial General Liability Insurance in an amount reasonably approved by Landlord and otherwise in accordance with the requirements of Article 10 below. Landlord may, in its discretion, require Tenant to obtain a payment and performance bond satisfactory to Landlord in an amount sufficient to ensure the lien-free completion of such Alterations.

8.5 **Landlord's Property.** All Alterations, improvements, fixtures, equipment and/or appurtenances which may be installed or placed in or about the Premises, from time to time, shall be at the sole cost of Tenant and shall be and become the property of Landlord. Notwithstanding the foregoing, Landlord may, by written notice to Tenant prior to the end of the Lease Term, or given following any earlier termination of this Lease, require Tenant, at Tenant's expense, to remove any Alterations and/or improvements and/or systems and equipment within the Premises and to repair any damage to the Premises and Building caused by such removal and return the affected portion of the Premises to a building standard tenant improved condition as determined by Landlord. If Tenant fails to complete such removal and/or to repair any damage caused by the removal of any Alterations and/or improvements and/or systems and equipment in the Premises and return the affected portion of the Premises to a building standard tenant improved condition as reasonably determined by Landlord, Landlord may do so and may charge the cost thereof to Tenant. Except to the extent caused by or arising out of the negligence or willful misconduct of any of the Landlord Parties, Tenant hereby protects, defends, indemnifies and holds Landlord harmless from any liability, cost, obligation, expense or claim of lien in any manner relating to the installation, placement, removal or financing of any such Alterations, improvements, fixtures and/or equipment in, on or about the Premises, which obligations of Tenant shall survive the expiration or earlier termination of this Lease.

ARTICLE 9

COVENANT AGAINST LIENS

Tenant shall keep the Project and Premises free from any liens or encumbrances arising out of the work performed, materials furnished or obligations incurred by or on behalf of Tenant, and shall protect, defend, indemnify and hold Landlord harmless from and against any claims, liabilities, judgments or costs (including, without limitation, reasonable attorneys' fees and costs) arising out of same or in connection therewith. Tenant shall give Landlord notice at least twenty (20) days prior to the commencement of any such work on the Premises (or such additional time as may be necessary under applicable laws) to afford Landlord the opportunity of posting and recording appropriate notices of non-responsibility. Tenant shall remove any such lien or encumbrance by bond or otherwise within ten (10) business days after notice by Landlord, and if Tenant shall fail to do so, Landlord may pay the amount necessary to remove such lien or encumbrance, without being responsible for investigating the validity thereof. The amount so paid shall be deemed Additional Rent under this Lease payable upon demand, without limitation as to other remedies available to Landlord under this Lease. Nothing contained in this Lease shall authorize Tenant to do any act which shall subject Landlord's title to the Building or Premises to any liens or encumbrances whether claimed by operation of law or express or implied contract. Any claim to a lien or encumbrance upon the Building or Premises arising in connection with any such work or respecting the Premises not performed by or at the request of Landlord shall be null and void, or at Landlord's option shall attach only against Tenant's interest in the Premises and shall in all respects be subordinate to Landlord's title to the Project, Building and Premises.

ARTICLE 10

INSURANCE

10.1 **Indemnification and Waiver.** Except to the extent of any damage, injury or loss caused by the negligence of willful misconduct of the Landlord Parties (but subject to the terms of Section 10.5 of this Lease), Tenant hereby assumes all risk of damage to property or injury to persons in, upon or about the Premises from any cause whatsoever (including, but not limited to, any personal injuries resulting from a slip and fall in, upon or about

the Premises) and agrees that Landlord, its managers and members, partners, subpartners and their respective officers, agents, servants, employees, and independent contractors (collectively, "**Landlord Parties**") shall not be liable for, and are hereby released from any responsibility for, any damage either to person or property or resulting from the loss of use thereof, which damage is sustained by Tenant or by other persons claiming through Tenant. Tenant shall indemnify, defend, protect, and hold harmless the Landlord Parties from any and all loss, cost, damage, expense and liability (including without limitation court costs and reasonable attorneys' fees) incurred in connection with or arising from any cause in, on or about the Premises (including, but not limited to, a slip and fall), any acts, omissions or negligence of Tenant or of any person claiming by, through or under Tenant, or of the contractors, agents, servants, employees, invitees, or licensees of Tenant or any such person (collectively, "**Tenant Parties**"), in, on or about the Project or any breach of the terms of this Lease, either prior to, during, or after the expiration of the Lease Term, provided that the terms of the foregoing indemnity shall not apply to the extent of any loss, cost, damage, expense or liability that arises out of the negligence or willful misconduct of the Landlord Parties. Should Landlord be named as a defendant in any suit brought against Tenant in connection with or arising out of Tenant's occupancy of the Premises, except to the extent such suit arises out of the negligence or willful misconduct of any of the Landlord Parties, Tenant shall pay to Landlord its costs and expenses incurred in such suit, including without limitation, its reasonable professional fees such as reasonable appraisers', accountants' and attorneys' fees. Tenant hereby agrees that it shall not assert any industrial insurance immunity rights pursuant to Title 51 RCW (as the same may be amended, substituted or replaced) if such assertion would be inconsistent with or otherwise impair Landlord's right to indemnification under this Section 10.1, and, accordingly, hereby waives all such industrial insurance immunity rights as to Landlord only, and only to the extent necessary to give full effect to the indemnity set forth in this Section 10.1. The foregoing waiver of industrial insurance immunity rights was specifically negotiated by Landlord and Tenant and is solely for the benefit of the Landlord and Tenant, and their successors and assigns, under the Lease, and is not intended as a waiver of Tenant's rights of immunity under such industrial insurance for any other purposes. The provisions of this Section 10.1 shall survive the expiration or sooner termination of this Lease with respect to any claims or liability arising in connection with any event occurring prior to such expiration or termination.

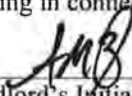
Landlord's Initials

Tenant's Initials

10.2 Landlord's Liability and Fire and Casualty Insurance. Landlord shall carry commercial general liability insurance with respect to the Building during the Lease Term, and shall further insure the Building and the Project during the Lease Term (for the full replacement value to the extent consistent with the practices of landlords of Comparable Buildings) against loss or damage due to fire and other casualties covered within the classification of fire and extended coverage, vandalism coverage and malicious mischief, sprinkler leakage, water damage and special extended coverage. Such coverage shall be in such amounts, from such companies, and on such other terms and conditions, as Landlord may from time to time reasonably determine. Additionally, at the option of Landlord, such insurance coverage may include the risks of earthquakes and/or flood damage, terrorist acts and additional hazards, a rental loss endorsement and one or more loss payee endorsements in favor of the holders of any mortgages or deeds of trust encumbering the interest of Landlord in the Building or the ground or underlying lessors of the Building, or any portion thereof. Notwithstanding the foregoing provisions of this Section 10.2, the coverage and amounts of insurance carried by Landlord in connection with the Building shall, at a minimum, be comparable to the coverage and amounts of insurance which are carried by reasonably prudent landlords of Comparable Buildings (provided that in no event shall Landlord be required to carry earthquake or terrorism insurance), and Worker's Compensation and Employer's Liability coverage as required by Applicable Law. Tenant shall, at Tenant's expense, comply with all insurance company requirements pertaining to the use of the Premises. If Tenant's conduct or use of the Premises causes any increase in the premium for such insurance policies then Tenant shall reimburse Landlord for any such reasonable increase. Tenant, at Tenant's expense, shall comply with all rules, orders, regulations or requirements of the American Insurance Association (formerly the National Board of Fire Underwriters) and with any similar body.

10.3 Tenant's Insurance. Tenant shall maintain the following coverages in the following amounts:

10.3.1 Commercial General Liability Insurance on an occurrence basis covering the insured against third party claims of bodily injury, including death, non-owned automobile liability, host liquor liability, owners and contractors protective liability, and Tenant's legal liability for the full replacement cost of the Premises with such coverage to include the activities and operation conducted by Tenant, or for which Tenant is legally liable and any other person performing work on behalf of Tenant, or for which Tenant is by law responsible, personal and

advertising injury and tangible property damage (including loss of use thereof) arising out of Tenant's operations, and blanket contractual liabilities (covering the performance by Tenant of its indemnity agreements) including a Broad Form endorsement covering the insuring provisions of this Lease and the performance by Tenant of the indemnity agreements set forth in Section 10.1 above, and including premises and products and completed operations coverage, and shall contain severability of interest clause, for limits of liability on a per location basis of not less than:

| | |
|--|---|
| Bodily Injury and Property Damage Liability | \$5,000,000 each occurrence \$5,000,000 annual aggregate |
| Personal Injury Liability | \$5,000,000 each occurrence \$5,000,000 annual aggregate 0% Insured's participation |

10.3.2 Physical Damage Insurance covering (i) all office furniture, business and trade fixtures, office equipment, machinery, inventory, property of others located in the Premises, free-standing cabinet work, movable partitions, merchandise and all other items of Tenant's property on the Premises installed by, for, or at the expense of Tenant, (ii) the "Tenant Improvements," as that term is defined in the Tenant Work Letter, and any other improvements which exist in the Premises as of the Lease Commencement Date (excluding the Base Building) (the "**Original Improvements**"), and (iii) all other improvements, alterations and additions to the Premises. Such insurance shall be written on an "all risks" of physical loss or damage basis, for the full replacement cost value (subject to reasonable deductible amounts) new without deduction for depreciation of the covered items and in amounts that meet any co-insurance clauses of the policies of insurance and shall include coverage for damage or other loss caused by fire or other peril including, but not limited to, vandalism and malicious mischief, theft, water damage of any type, including sprinkler leakage, bursting or stoppage of pipes, and explosion.

10.3.3 Worker's Compensation and Employer's Liability ("Stop Gap") or other similar insurance pursuant to all applicable state and local statutes and regulations.

10.4 **Form of Policies.** The minimum limits of policies of insurance required of Tenant under this Lease shall in no event limit the liability of Tenant under this Lease. Such insurance shall (i) name Landlord, and any other party the Landlord so specifies, as an additional insured, including Landlord's managing agent, if any; (ii) specifically cover the liability assumed by Tenant under this Lease, including, but not limited to, Tenant's obligations under Section 10.1 above; (iii) be issued by an insurance company having a rating of not less than A-:X in A.M. Best Insurance Guide or which is otherwise reasonably acceptable to Landlord and licensed to do business in the State of Washington; (iv) be primary and noncontributory insurance as to all claims thereunder and provide that any insurance carried by Landlord is excess and is non-contributing with any insurance requirement of Tenant; (v) be in form and content reasonably acceptable to Landlord; and (vi) provide that said insurance shall not be canceled or coverage changed unless thirty (30) days' prior written notice shall have been given to Landlord and any mortgagee of Landlord. Tenant shall deliver said policy or policies or certificates thereof to Landlord on or before the Lease Commencement Date and at least thirty (30) days before the expiration dates thereof. Further, Landlord shall have the right, from time to time, to request copies of policies of Tenant's insurance required hereunder, which Tenant shall thereafter provide within ten (10) business days.

10.5 **Subrogation.** Landlord and Tenant intend that their respective property loss risks shall be borne by reasonable insurance carriers to the extent above provided, and Landlord and Tenant hereby agree to look solely to, and seek recovery only from, their respective insurance carriers in the event of a property loss to the extent that such coverage is agreed to be provided hereunder. The parties each hereby waive all rights and claims against each other for such losses, and, in the case of Landlord, against all Tenant Parties, and in the case of Tenant, against, all Landlord Parties. In addition, the parties waive all rights of subrogation of their respective insurers, provided such waiver of subrogation shall not affect the right to the insured to recover thereunder. The parties agree that their respective insurance policies are now, or shall be, endorsed such that the waiver of subrogation shall not affect the right of the insured to recover thereunder, so long as no material additional premium is charged therefor.

10.6 **Additional Insurance Obligations.** Tenant shall carry and maintain during the entire Lease Term, at Tenant's sole cost and expense, increased amounts of the insurance required to be carried by Tenant pursuant to this Article 10 and such other reasonable types of insurance coverage and in such reasonable amounts covering the

Premises and Tenant's operations therein, as may be reasonably requested by Landlord, but in no event in excess of the amounts and types of insurance then being required by landlords of buildings comparable to and in the vicinity of the Building.

10.7

Tenant's Right to Self-Insure Re Liability Insurance.

10.7.1 **In General.** In lieu of the liability insurance policies and associated endorsements described in this Article 10, Tenant maintains a fully funded self-insurance program for the protection and handling of Tenant's liabilities including injuries to persons and damage to property. Landlord acknowledges, agrees and understands that Tenant is self-funded for all of its liability exposures. Tenant shall, at its own expense, maintain through its fully funded self-insurance program, coverage for all of its liability exposures for this Lease. Tenant shall provide Landlord with at least thirty (30) days prior written notice of any material change in Tenant's self-funded insurance program and shall provide Landlord with a letter of self-insurance as adequate proof of coverage upon Landlord's written request for the same. Landlord further acknowledges, agrees and understands that, since Tenant does not purchase commercial general liability insurance and is a self-insured governmental entity with respect thereto, Tenant does not have the ability to name Landlord as an additional insured with respect its commercial liability coverage. Subject to the foregoing, all of the terms and conditions of this Lease applicable to general liability insurance shall apply to Tenant's self-insurance with respect thereto in the same manner as if Tenant maintained third party insurance as contemplated by this Article 10 (i.e., without regard to this Section 10.7). Without limitation of the foregoing, with respect to any claims which may result from incidents occurring during the Lease Term, Tenant's self-insurance obligation shall survive the expiration or earlier termination of this Lease to the same extent as the insurance required would survive.

10.7.2 **Limitations.** This Section 10.7 is applicable (i) only with respect to Tenant's insurance obligation under Section 10.3.1, above, and (ii) only to the "Original Tenant," as that term is defined in Section 1 of the Extension Option Rider (so that, *for clarity purposes*, this Section 10.7 shall be inapplicable with regard to any subtenant, assignee, or other Transferee, all of whom, if applicable, shall be required to carry third party insurance as contemplated by this Article 10).

ARTICLE 11

DAMAGE AND DESTRUCTION

11.1 **Repair of Damage to Premises by Landlord.** Tenant shall promptly notify Landlord of any damage to the Premises resulting from fire or any other casualty ("**Casualty**"). If the Premises or any Common Areas serving or providing access to the Premises shall be damaged by Casualty, Landlord shall promptly and diligently, subject to reasonable delays for insurance adjustment or other matters beyond Landlord's reasonable control, and subject to all other terms of this Article 11, restore the Base Building and such Common Areas. Such restoration shall be to substantially the same condition of the Base Building and the Common Areas prior to the Casualty, except for modifications required by zoning and building codes and other laws or by the holder of a mortgage on the Building or Project or any other modifications to the Common Areas deemed desirable by Landlord, which are consistent with the character of the Project, provided that access to the Premises and any common restrooms serving the Premises shall not be materially impaired. Upon the occurrence of any damage to the Premises, upon notice (the "**Landlord Repair Notice**") to Tenant from Landlord, Tenant shall assign to Landlord all insurance proceeds payable to Tenant under Tenant's insurance required under Section 10.3 above, and Landlord shall repair any injury or damage to the Tenant Improvements and the Original Improvements installed in the Premises and shall return such Tenant Improvements and Original Improvements to their original condition; provided that if the cost of such repair by Landlord exceeds the amount of insurance proceeds received by Landlord from Tenant's insurance carrier, as assigned by Tenant, the cost of such repairs shall be paid by Tenant to Landlord prior to Landlord's commencement of repair of the damage. In the event that Landlord does not deliver the Landlord Repair Notice within sixty (60) days following the date the Casualty becomes known to Landlord, Tenant shall, at its sole cost and expense, repair any injury or damage to the Tenant Improvements and the Original Improvements installed in the Premises and shall return such Tenant Improvements and Original Improvements to their original condition. Whether or not Landlord delivers a Landlord Repair Notice, prior to the commencement of construction, Tenant shall submit to Landlord, for Landlord's review and approval, all plans, specifications and working drawings relating thereto, and Landlord shall select the contractors to perform such improvement work. Landlord shall not be liable for any inconvenience or annoyance to Tenant or its

visitors, or injury to Tenant's business resulting in any way from such damage or the repair thereof; provided however, that if such Casualty shall have damaged the Premises or Common Areas necessary to Tenant's occupancy, and the Premises are not occupied by Tenant as a result thereof, then during the time and to the extent the Premises are unfit for occupancy, the Rent shall be abated in proportion to the ratio that the amount of rentable square feet of the Premises which is unfit for occupancy for the purposes permitted under this Lease bears to the total rentable square feet of the Premises. In the event that Landlord shall not deliver the Landlord Repair Notice, Tenant's right to rent abatement pursuant to the preceding sentence shall terminate as of the date which is reasonably determined by Landlord to be the date Tenant should have completed repairs to the Premises assuming Tenant used reasonable due diligence in connection therewith. Notwithstanding any contrary provision of this Article 11, the parties hereby agree as follows: (i) the closure of the Project, the Building, the Common Areas, or any part thereof to protect public health shall not constitute a Casualty for purposes of this Lease, (ii) Casualty covered by this Article 11 shall require that the physical or structural integrity of the Premises, the Project, the Building, or the Common Areas is degraded as a direct result of such occurrence, and (iii) a Casualty under this Article 11 shall not be deemed to occur merely because Tenant is unable to productively use the Premises in the event that the physical and structural integrity of the Premises is undamaged.

11.2 Landlord's Option to Repair. Notwithstanding the terms of Section 11.1 above, Landlord may elect not to rebuild and/or restore the Premises, Building and/or Project, and instead terminate this Lease, by notifying Tenant in writing of such termination within sixty (60) days after the date of discovery of the damage, such notice to include a termination date giving Tenant sixty (60) days to vacate the Premises, but Landlord may so elect only if the Building or Project shall be damaged by Casualty, whether or not the Premises are affected, and one or more of the following conditions is present: (i) in Landlord's reasonable judgment, repairs cannot reasonably be completed within one hundred eighty (180) days after the date of discovery of the damage (when such repairs are made without the payment of overtime or other premiums); (ii) the holder of any mortgage on the Building or Project or ground lessor with respect to the Building or Project shall require that the insurance proceeds or any portion thereof be used to retire the mortgage debt, or shall terminate the ground lease, as the case may be; (iii) the damage is not fully covered by Landlord's insurance policies; (iv) Landlord decides to rebuild the Building or Common Areas so that they will be substantially different structurally or architecturally; (v) the damage occurs during the last twelve (12) months of the Lease Term; or (vi) any owner of any other portion of the Project, other than Landlord, does not intend to repair the damage to such portion of the Project; provided, however, that if Landlord does not elect to terminate this Lease pursuant to Landlord's termination right as provided above, and the repairs cannot, in the reasonable opinion of Landlord, be completed within one hundred eighty (180) days after being commenced, Tenant may elect, no earlier than sixty (60) days after the date of the damage and not later than ninety (90) days after the date of such damage, to terminate this Lease by written notice to Landlord effective as of the date specified in the notice, which date shall not be less than thirty (30) days nor more than sixty (60) days after the date such notice is given by Tenant. Notwithstanding the provisions of this Section 11.2, Tenant shall have the right to terminate this Lease under this Section 11.2 only if each of the following conditions is satisfied: (a) the damage to the Project by Casualty was not caused by the gross negligence or intentional act of Tenant or its partners or subpartners and their respective officers, agents, servants, employees, and independent contractors; (b) Tenant is not then in default under this Lease; (c) as a result of the damage, Tenant cannot reasonably conduct business from the Premises; and, (d) as a result of the damage to the Project, Tenant does not occupy or use the Premises at all.

11.3 Waiver of Statutory Provisions. The provisions of this Lease, including this Article 11, constitute an express agreement between Landlord and Tenant with respect to any and all damage to, or destruction of, all or any part of the Premises, the Building or the Project, and any statute or regulation of the State of Washington with respect to any rights or obligations concerning damage or destruction in the absence of an express agreement between the parties, and any other statute or regulation, now or hereafter in effect, shall have no application to this Lease or any damage or destruction to all or any part of the Premises, the Building or the Project.

ARTICLE 12

NONWAIVER

No provision of this Lease shall be deemed waived by either party hereto unless expressly waived in a writing signed thereby. The waiver by either party hereto of any breach of any term, covenant or condition herein contained shall not be deemed to be a waiver of any subsequent breach of same or any other term, covenant or condition herein

contained. The subsequent acceptance of Rent hereunder by Landlord shall not be deemed to be a waiver of any preceding breach by Tenant of any term, covenant or condition of this Lease, other than the failure of Tenant to pay the particular Rent so accepted, regardless of Landlord's knowledge of such preceding breach at the time of acceptance of such Rent. No acceptance of a lesser amount than the Rent herein stipulated shall be deemed a waiver of Landlord's right to receive the full amount due, nor shall any endorsement or statement on any check or payment or any letter accompanying such check or payment be deemed an accord and satisfaction, and Landlord may accept such check or payment without prejudice to Landlord's right to recover the full amount due. No receipt of monies by Landlord from Tenant after the termination of this Lease shall in any way alter the length of the Lease Term or of Tenant's right of possession hereunder, or after the giving of any notice shall reinstate, continue or extend the Lease Term or affect any notice given Tenant prior to the receipt of such monies, it being agreed that after the service of notice or the commencement of a suit, or after final judgment for possession of the Premises, Landlord may receive and collect any Rent due, and the payment of said Rent shall not waive or affect said notice, suit or judgment.

ARTICLE 13

CONDEMNATION

If the whole or any part of the Premises, Building or Project shall be taken by power of eminent domain or condemned by any competent authority for any public or quasi-public use or purpose, or if any adjacent property or street shall be so taken or condemned, or reconfigured or vacated by such authority in such manner as to require the use, reconstruction or remodeling of any part of the Premises, Building or Project, or if Landlord shall grant a deed or other instrument in lieu of such taking by eminent domain or condemnation, Landlord shall have the option to terminate this Lease effective as of the date possession is required to be surrendered to the authority. If more than twenty-five percent (25%) of the rentable square feet of the Premises is taken, or if access to the Premises is substantially impaired, in each case for a period in excess of one hundred eighty (180) days, Tenant shall have the option to terminate this Lease effective as of the date possession is required to be surrendered to the authority. Tenant shall not because of such taking assert any claim against Landlord or the authority for any compensation because of such taking and Landlord shall be entitled to the entire award or payment in connection therewith, except that Tenant shall have the right to file any separate claim available to Tenant for any taking of Tenant's personal property and fixtures belonging to Tenant and removable by Tenant upon expiration of the Lease Term pursuant to the terms of this Lease, and for moving expenses, so long as such claims do not diminish the award available to Landlord, its ground lessor with respect to the Building or Project or its mortgagee, and such claim is payable separately to Tenant. All Rent shall be apportioned as of the date of such termination. If any part of the Premises shall be taken, and this Lease shall not be so terminated, the Rent shall be proportionately abated. Notwithstanding anything to the contrary contained in this Article 13, in the event of a temporary taking of all or any portion of the Premises for a period of one hundred and eighty (180) days or less, then this Lease shall not terminate but the Base Rent and the Additional Rent shall be abated for the period of such taking in proportion to the ratio that the amount of rentable square feet of the Premises taken bears to the total rentable square feet of the Premises. Landlord shall be entitled to receive the entire award made in connection with any such temporary taking. Notwithstanding any contrary provision of this Lease, the following governmental actions shall not constitute a taking or condemnation, either permanent or temporary: (i) an action that requires Tenant's business or the Building or Project to close during the Lease Term, and (ii) an action taken for the purpose of protecting public safety (e.g., to protect against acts of war, the spread of communicable diseases, or an infestation), and no such governmental actions shall entitle Tenant to any compensation from Landlord or any authority, or Rent abatement or any other remedy under this Lease.

ARTICLE 14

ASSIGNMENT AND SUBLETTING

14.1 **Transfers.** Tenant shall not, without the prior written consent of Landlord, assign, mortgage, pledge, hypothecate, encumber, or permit any lien to attach to, or otherwise transfer, this Lease or any interest hereunder, permit any assignment, or other transfer of this Lease or any interest hereunder by operation of law, sublet the Premises or any part thereof, or enter into any license or concession agreements or otherwise permit the occupancy or use of the Premises or any part thereof by any persons other than Tenant and its employees and contractors (all of the foregoing are hereinafter sometimes referred to collectively as "**Transfers**" and any person to whom any Transfer is made or sought to be made is hereinafter sometimes referred to as a "**Transferee**"). If Tenant desires Landlord's

consent to any Transfer, Tenant shall notify Landlord in writing, which notice (the "Transfer Notice") shall include (i) the proposed effective date of the Transfer, which shall not be less than thirty (30) days nor more than one hundred eighty (180) days after the date of delivery of the Transfer Notice, (ii) a description of the portion of the Premises to be transferred (the "Subject Space"), (iii) all of the terms of the proposed Transfer and the consideration therefor, including calculation of the "Transfer Premium", as that term is defined in Section 14.3 below, in connection with such Transfer, the name and address of the proposed Transferee, and a copy of all existing executed and/or proposed documentation pertaining to the proposed Transfer, including all existing operative documents to be executed to evidence such Transfer or the agreements incidental or related to such Transfer, provided that Landlord shall have the right to require Tenant to utilize Landlord's standard Transfer documents in connection with the documentation of such Transfer, (iv) current financial statements of the proposed Transferee certified by an officer, partner or owner thereof, business credit and personal references and history of the proposed Transferee and any other information reasonably required by Landlord which will enable Landlord to determine the financial responsibility, character, and reputation of the proposed Transferee, nature of such Transferee's business and proposed use of the Subject Space, and (v) an executed estoppel certificate from Tenant in the form attached hereto as Exhibit E. Any Transfer made without Landlord's prior written consent shall, at Landlord's option, be null, void and of no effect, and shall, at Landlord's option, constitute a default by Tenant under this Lease. Whether or not Landlord consents to any proposed Transfer, Tenant shall pay Landlord's reasonable review and processing fees, as well as any reasonable professional fees (including, without limitation, attorneys', accountants', architects', engineers' and consultants' fees) incurred by Landlord, within thirty (30) days after written request by Landlord.

14.2 Landlord's Consent. Landlord shall not unreasonably withhold or delay its consent to any proposed Transfer of the Subject Space to the Transferee on the terms specified in the Transfer Notice. Without limitation as to other reasonable grounds for withholding consent, the parties hereby agree that it shall be reasonable under this Lease and under any applicable law for Landlord to withhold consent to any proposed Transfer where one or more of the following apply:

14.2.1 The Transferee is of a character or reputation or engaged in a business which is not consistent with the quality of the Building or the Project;

14.2.2 The Transferee intends to use the Subject Space for purposes which are not permitted under this Lease;

14.2.3 The Transferee is either a governmental agency (provided that the foregoing shall not limit Tenant's rights pursuant to the terms of Section 14.8, below) or instrumentality thereof or a non-profit organization;

14.2.4 The Transfer occurs during the period from the Lease Commencement Date until the earlier of (i) the fourth anniversary of the Lease Commencement Date or (ii) the date at least ninety five percent (95%) of the rentable square feet of the Project is leased, and the rent charged by Tenant to such Transferee during the term of such Transfer, calculated using a present value analysis, is less than ninety-five percent (95%) of the rent being quoted by Landlord at the time of such Transfer for comparable space in the Project for a comparable term, calculated using a present value analysis;

14.2.5 The Transferee is not a party of reasonable financial worth and/or financial stability in light of the responsibilities to be undertaken in connection with the Transfer on the date consent is requested;

14.2.6 The proposed Transfer would cause a violation of another lease for space in the Project, or would give an occupant of the Project a right to cancel its lease; or

14.2.7 Either the proposed Transferee, or any person or entity which directly or indirectly, controls, is controlled by, or is under common control with, the proposed Transferee, (i) occupies space in the Project at the time of the request for consent, or (ii) is negotiating with Landlord or has negotiated with Landlord during the six (6) month period immediately preceding the date Landlord receives the Transfer Notice, to lease space in the Project.

If Landlord consents to any Transfer pursuant to the terms of this Section 14.2 (and does not exercise any recapture rights Landlord may have under Section 14.4 below), Tenant may within six (6) months after Landlord's consent, but not later than the expiration of said six-month period, enter into such Transfer of the Premises or portion thereof, upon substantially the same terms and conditions as are set forth in the Transfer Notice furnished by Tenant to Landlord pursuant to Section 14.1 above, provided that if there are any changes in the terms and conditions from those specified in the Transfer Notice (i) such that Landlord would initially have been entitled to refuse its consent to such Transfer under this Section 14.2, or (ii) which would cause the proposed Transfer to be more favorable to the Transferee than the terms set forth in Tenant's original Transfer Notice, Tenant shall again submit the Transfer to Landlord for its approval and other action under this Article 14 (including Landlord's right of recapture, if any, under Section 14.4 below). Notwithstanding anything to the contrary in this Lease, if Tenant or any proposed Transferee claims that Landlord has unreasonably withheld or delayed its consent under Section 14.2 or otherwise has breached or acted unreasonably under this Article 14, their sole remedies shall be a suit for contract damages (other than damages for injury to, or interference with, Tenant's business including, without limitation, loss of profits, however occurring) or declaratory judgment and an injunction for the relief sought, and Tenant hereby waives all other remedies, including, without limitation, any right at law or equity to terminate this Lease, on its own behalf and, to the extent permitted under all applicable laws, on behalf of the proposed Transferee.

14.3 Transfer Premium. If Landlord consents to a Transfer, as a condition thereto which the parties hereby agree is reasonable, Tenant shall pay to Landlord fifty percent (50%) of any "Transfer Premium," as that term is defined in this Section 14.3, received by Tenant from such Transferee. "Transfer Premium" shall mean all rent, additional rent or other consideration payable by such Transferee in connection with the Transfer in excess of the Rent and Additional Rent payable by Tenant under this Lease during the term of the Transfer on a per rentable square foot basis if less than all of the Premises is transferred, after deducting the reasonable expenses incurred by Tenant for (i) any changes, alterations and improvements to the Premises in connection with the Transfer, (ii) any free base rent provided to the Transferee, (iii) any brokerage commissions paid in connection with the Transfer, (iv) any improvement allowance or other economic concessions paid by Tenant to the Transferee in connection with the Transfer; and (v) reasonable attorneys' fees paid by Tenant in connection with the Transfer. "Transfer Premium" shall also include, but not be limited to, key money, bonus money or other cash consideration paid by Transferee to Tenant in connection with such Transfer, and any payment in excess of fair market value for services rendered by Tenant to Transferee or for assets, fixtures, inventory, equipment, or furniture transferred by Tenant to Transferee in connection with such Transfer. The determination of the amount of Landlord's applicable share of the Transfer Premium shall be made on a monthly basis as rent or other consideration is received by Tenant under the Transfer.

14.4 Landlord's Option as to Subject Space. Notwithstanding anything to the contrary contained in this Article 14, in the event Tenant contemplates a Transfer of all or a portion of the Premises, Tenant shall give Landlord notice (the "Intention to Transfer Notice") of such contemplated Transfer (whether or not the contemplated Transferee or the terms of such contemplated Transfer have been determined). The Intention to Transfer Notice shall specify the portion of and amount of rentable square feet of the Premises which Tenant intends to Transfer (the "Contemplated Transfer Space"), the contemplated date of commencement of the contemplated Transfer (the "Contemplated Effective Date"), and the contemplated length of the term of such contemplated Transfer, and shall specify that such Intention to Transfer Notice is delivered to Landlord pursuant to this Section 14.4 in order to allow Landlord to elect to recapture the Contemplated Transfer Space. Thereafter, Landlord shall have the option, by giving written notice to Tenant within thirty (30) days after receipt of any Intention to Transfer Notice, to recapture the Contemplated Transfer Space. Such recapture shall cancel and terminate this Lease with respect to such Contemplated Transfer Space as of the Contemplated Effective Date. In the event of a recapture by Landlord, if this Lease shall be canceled with respect to less than the entire Premises, the Rent reserved herein shall be prorated on the basis of the number of rentable square feet retained by Tenant in proportion to the number of rentable square feet contained in the Premises, and this Lease as so amended shall continue thereafter in full force and effect, and upon request of either party, the parties shall execute written confirmation of the same. If Landlord declines, or fails to elect in a timely manner, to recapture such Contemplated Transfer Space under this Section 14.4, then, subject to the other terms of this Article 14, for a period of nine (9) months (the "Nine Month Period") commencing on the last day of such thirty (30) day period, Landlord shall not have any right to recapture the Contemplated Transfer Space with respect to any Transfer made during the Nine Month Period, provided that any such Transfer is substantially on the terms set forth in the Intention to Transfer Notice, and provided further that any such Transfer shall be subject to the remaining terms of this Article 14. If such a Transfer is not so consummated within the Nine Month Period (or if a Transfer is so consummated, then upon the expiration of the term of any Transfer of such Contemplated Transfer Space

consummated within such Nine Month Period), Tenant shall again be required to submit a new Intention to Transfer Notice to Landlord with respect any contemplated Transfer, as provided above in this Section 14.4.

14.5 Effect of Transfer. If Landlord consents to a Transfer, (i) the terms and conditions of this Lease shall in no way be deemed to have been waived or modified, (ii) such consent shall not be deemed consent to any further Transfer by either Tenant or a Transferee, (iii) Tenant shall deliver to Landlord, promptly after execution, an original executed copy of all documentation pertaining to the Transfer in form reasonably acceptable to Landlord, (iv) Tenant shall furnish upon Landlord's request a complete statement, certified by an independent certified public accountant, or Tenant's chief financial officer, setting forth in detail the computation of any Transfer Premium Tenant has derived and shall derive from such Transfer, and (v) no Transfer relating to this Lease or agreement entered into with respect thereto, whether with or without Landlord's consent, shall relieve Tenant or any guarantor of the Lease from any liability under this Lease, including, without limitation, in connection with the Subject Space. In the event that Tenant subleases all or any portion of the Premises in accordance with the terms of this Article 14, Tenant shall cause such subtenant to carry and maintain the same insurance coverage terms and limits as are required of Tenant, in accordance with the terms of Article 10 above. Landlord or its authorized representatives shall have the right at all reasonable times to audit the books, records and papers of Tenant relating to any Transfer, and shall have the right to make copies thereof. If the Transfer Premium respecting any Transfer shall be found understated, Tenant shall, within thirty (30) days after demand, pay the deficiency, and if understated by more than two percent (2%), Tenant shall pay Landlord's costs of such audit.

14.6 Additional Transfers. For purposes of this Lease, the term "Transfer" shall also include (i) if Tenant is a partnership, the withdrawal or change, voluntary, involuntary or by operation of law, of fifty percent (50%) or more of the partners, or transfer of fifty percent (50%) or more of partnership interests, within a twelve (12)-month period, or the dissolution of the partnership without immediate reconstitution thereof, and (ii) if Tenant is a closely held corporation (*i.e.*, whose stock is not publicly held and not traded through an exchange or over the counter), (A) the dissolution, merger, consolidation or other reorganization of Tenant or (B) the sale or other transfer of an aggregate of fifty percent (50%) or more of the voting shares of Tenant (other than to immediate family members by reason of gift or death), within a twelve (12)-month period, or (C) the sale, mortgage, hypothecation or pledge of an aggregate of fifty percent (50%) or more of the value of the unencumbered assets of Tenant within a twelve (12)-month period.

14.7 Occurrence of Default. Any Transfer hereunder shall be subordinate and subject to the provisions of this Lease, and if this Lease shall be terminated during the term of any Transfer, Landlord shall have the right to: (i) treat such Transfer as cancelled and repossess the Subject Space by any lawful means, or (ii) require that such Transferee attorn to and recognize Landlord as its landlord under any such Transfer. If Tenant shall be in default under this Lease, Landlord is hereby irrevocably authorized, as Tenant's agent and attorney-in-fact, to direct any Transferee to make all payments under or in connection with the Transfer directly to Landlord (which Landlord shall apply towards Tenant's obligations under this Lease) until such default is cured. Such Transferee shall rely on any representation by Landlord that Tenant is in default hereunder, without any need for confirmation thereof by Tenant. Upon any assignment, the assignee shall assume in writing all obligations and covenants of Tenant thereafter to be performed or observed under this Lease. No collection or acceptance of rent by Landlord from any Transferee shall be deemed a waiver of any provision of this Article 14 or the approval of any Transferee or a release of Tenant from any obligation under this Lease, whether theretofore or thereafter accruing. In no event shall Landlord's enforcement of any provision of this Lease against any Transferee be deemed a waiver of Landlord's right to enforce any term of this Lease against Tenant or any other person. If Tenant's obligations hereunder have been guaranteed, Landlord's consent to any Transfer shall not be effective unless the guarantor also consents to such Transfer.

14.8 Non-Transfers - King County Departments/Divisions. Except as specifically set forth in this Section 14.8, no departments or divisions or employees of King County, other than the Civil Division and its employees, shall use or occupy the Premises. Notwithstanding the foregoing, Landlord hereby acknowledges and agrees that occupancy and use of the Premises pursuant to the terms of this Lease by King County departments or divisions or employees other than the Civil Division and its employees shall not be considered a Transfer for purposes of this Lease (and shall be permitted pursuant to the terms of this Lease), provided that, in Landlord's reasonable determination (i) any such division or department or employees of King County other than the Civil Division and its employees shall be of a character and reputation (and shall have employees and visitors) consistent with a first class office building, (ii) any such department or division or employees of King County other than the Civil Division and its employees shall not violate the terms of this Lease (including, without limitation, with regard to the permitted use

of the Premises), (iii) any such department or division or employees of King County other than the Civil Division and its employees shall not create security concerns greater than those associated with the occupancy by the Civil Division and its employees as permitted pursuant to the terms of this Lease, (iv) any such department or division or employees of King County other than the Civil Division shall not create foot traffic greater than that associated with the occupancy by the Civil Division as permitted pursuant to the terms of this Lease, and (v) any such department or division or employees of King County other than the Civil Division shall not solicit, promote or require regular visits to the Premises by members of the public. Tenant shall provide Landlord not less than thirty (30) days' prior notice to Landlord of any intended occupancy of the Premises by a department or division or employees of King County other than the Civil Division and its employees.

ARTICLE 15

SURRENDER OF PREMISES; OWNERSHIP AND REMOVAL OF TRADE FIXTURES

15.1 **Surrender of Premises.** No act or thing done by Landlord or any agent or employee of Landlord during the Lease Term shall be deemed to constitute an acceptance by Landlord of a surrender of the Premises unless such intent is specifically acknowledged in writing by Landlord. The delivery of keys to the Premises to Landlord or any agent or employee of Landlord shall not constitute a surrender of the Premises or effect a termination of this Lease, whether or not the keys are thereafter retained by Landlord, and notwithstanding such delivery Tenant shall be entitled to the return of such keys at any reasonable time upon request until this Lease shall have been properly terminated. The voluntary or other surrender of this Lease by Tenant, whether accepted by Landlord or not, or a mutual termination hereof, shall not work a merger, and at the option of Landlord shall operate as an assignment to Landlord of all subleases or subtenancies affecting the Premises or terminate any or all such sublessees or subtenancies.

15.2 **Removal of Tenant Property by Tenant.** Upon the expiration of the Lease Term, or upon any earlier termination of this Lease, Tenant shall, subject to the provisions of this Article 15, quit and surrender possession of the Premises to Landlord in as good order and condition as when Tenant took possession and as thereafter improved by Landlord and/or Tenant, reasonable wear and tear and repairs which are specifically made the responsibility of Landlord hereunder excepted. Upon such expiration or termination, Tenant shall, without expense to Landlord, remove or cause to be removed from the Premises all debris and rubbish, and such items of furniture, equipment, business and trade fixtures, free-standing cabinet work, movable partitions and other articles of personal property owned by Tenant or installed or placed by Tenant at its expense in the Premises, and such similar articles of any other persons claiming under Tenant, as Landlord may, in its sole discretion, require to be removed, and Tenant shall repair at its own expense all damage to the Premises and Building resulting from such removal.

ARTICLE 16

HOLDING OVER

If Tenant holds over after the expiration of the Lease Term or earlier termination thereof, such tenancy shall be a tenancy-at-sufferance, and shall not constitute a renewal hereof or an extension for any further term, and in such case Rent shall be payable at a daily rate equal to the product of (i) the daily Rent applicable during the last rental period of the Lease Term under this Lease, and (ii) a percentage equal to 125% during the first (1st) month immediately following the expiration or earlier termination of the Lease Term, and 150% thereafter. Such tenancy shall be subject to every other applicable term, covenant and agreement contained herein. Nothing contained in this Article 16 shall be construed as consent by Landlord to any holding over by Tenant, and Landlord expressly reserves the right to require Tenant to surrender possession of the Premises to Landlord as provided in this Lease upon the expiration or other termination of this Lease. If Tenant holds over without Landlord's express written consent, and tenders payment of rent for any period beyond the expiration of the Lease Term by way of check (whether directly to Landlord, its agents, or to a lock box) or wire transfer, Tenant acknowledges and agrees that the cashing of such check or acceptance of such wire shall be considered inadvertent and not be construed as creating a month-to-month tenancy, provided Landlord refunds such payment to Tenant promptly upon learning that such check has been cashed or wire transfer received. The provisions of this Article 16 shall not be deemed to limit or constitute a waiver of any other rights or remedies of Landlord provided herein or at law. If Tenant fails to surrender the Premises upon the termination or

expiration of this Lease, in addition to any other liabilities to Landlord accruing therefrom, Tenant shall protect, defend, indemnify and hold Landlord harmless from all loss, costs (including reasonable attorneys' fees) and liability resulting from such failure, including, without limiting the generality of the foregoing, any claims made by any succeeding tenant founded upon such failure to surrender and any lost profits to Landlord resulting therefrom. Tenant agrees that any proceedings necessary to recover possession of the Premises, whether before or after expiration of the Lease Term, shall be considered an action to enforce the terms of this Lease for purposes of the awarding of any attorney's fees in connection therewith.

ARTICLE 17

ESTOPPEL CERTIFICATES

Within ten (10) business days following a request in writing by Landlord, Tenant shall execute, acknowledge and deliver to Landlord an estoppel certificate, which, as submitted by Landlord, shall be substantially in the form of Exhibit E-1 attached hereto (or in such other form as may be reasonably required by any prospective mortgagee or purchaser of the Project, or any portion thereof (so long as such form is commercially reasonable), or if Landlord's current lender requests the execution and delivery of an estoppel certificate, in the form of Exhibit E-2 attached hereto), indicating therein any exceptions thereto that may exist at that time, and shall also contain any other information reasonably requested by Landlord or Landlord's mortgagee or prospective mortgagee (so long as such other information is commercially reasonable, giving due consideration to information commonly required in connection with estoppel certificates required under leases at Comparable Buildings). Any such certificate may be relied upon by any prospective mortgagee or purchaser of all or any portion of the Project. At any time during the Lease Term, but only if the Tenant is not the "Original Tenant," as that term is defined in Section 1 of the Extension Option Rider, Landlord may require Tenant to provide Landlord with a current financial statement and financial statements of the two (2) years prior to the current financial statement year. Such statements shall be prepared in accordance with generally accepted accounting principles and, if such is the normal practice of Tenant, shall be audited by an independent certified public accountant. Failure of Tenant to timely execute, acknowledge and deliver such estoppel certificate shall constitute an acceptance of the Premises and an acknowledgment by Tenant that statements included in the estoppel certificate are true and correct, without exception.

ARTICLE 18

SUBORDINATION

This Lease shall be subject and subordinate to all present and future ground or underlying leases of the Building or Project and to the lien of any mortgage, trust deed or other encumbrances now or hereafter in force against the Building or Project or any part thereof, if any, and to all renewals, extensions, modifications, consolidations and replacements thereof, and to all advances made or hereafter to be made upon the security of such mortgages or trust deeds, unless the holders of such mortgages, trust deeds or other encumbrances, or the lessors under such ground lease or underlying leases, require in writing that this Lease be superior thereto. Tenant covenants and agrees in the event any proceedings are brought for the foreclosure of any such mortgage or deed in lieu thereof (or if any ground lease is terminated), to attorn, without any deductions or set-offs whatsoever, to the lienholder or purchaser or any successors thereto upon any such foreclosure sale or deed in lieu thereof (or to the ground lessor), if so requested to do so by such purchaser or lienholder or ground lessor, and to recognize such purchaser or lienholder or ground lessor as the lessor under this Lease, provided such lienholder or purchaser or ground lessor shall agree to accept this Lease and not disturb Tenant's occupancy, so long as Tenant timely pays the rent and observes and performs the terms, covenants and conditions of this Lease to be observed and performed by Tenant. Landlord's interest herein may be assigned as security at any time to any lienholder. Tenant shall, within ten (10) business days of request by Landlord, execute such further instruments or assurances as Landlord may reasonably deem necessary to evidence or confirm the subordination or superiority of this Lease to any such mortgages, trust deeds, ground leases or underlying leases. Tenant waives the provisions of any current or future statute, rule or law which may give or purport to give Tenant any right or election to terminate or otherwise adversely affect this Lease and the obligations of the Tenant hereunder in the event of any foreclosure proceeding or sale.

ARTICLE 19

DEFAULTS; REMEDIES

19.1 **Events of Default.** The occurrence of any of the following shall constitute a default of this Lease by Tenant:

19.1.1 Any failure by Tenant to pay any Rent or any other charge required to be paid under this Lease, or any part thereof, within five (5) business days following notice from Landlord that the same was not paid when due; or

19.1.2 Except where a specific time period is otherwise set forth for Tenant's performance in this Lease, in which event the failure to perform by Tenant within such time period shall be a default by Tenant under this Section 19.1.2, any failure by Tenant to observe or perform any other provision, covenant or condition of this Lease to be observed or performed by Tenant where such failure continues for thirty (30) days after written notice thereof from Landlord to Tenant; provided that if the nature of such default is such that the same cannot reasonably be cured within a thirty (30) day period, Tenant shall not be deemed to be in default if it diligently commences such cure within such period and thereafter diligently proceeds to rectify and cure such default; or

19.1.3 Abandonment or vacation of all or a substantial portion of the Premises by Tenant; or

19.1.4 The failure by Tenant to observe or perform according to the provisions of Articles 5 or 14, above, or the Tenant Work Letter, where, in each instance, such failure continues for more than three (3) business days after notice from Landlord; or

19.1.5 The failure by Tenant to observe or perform according to the provisions of Articles 17 or 18, above, where, in each instance, such failure continues for more than five (5) business days after notice from Landlord; or

19.1.6 Tenant's failure to occupy the Premises within ten (10) business days after the Lease Commencement Date, unless Landlord has previously authorized Tenant's request for delay in occupying the Premises in writing, which authorization may be withheld, conditioned or delayed in Landlord's reasonable discretion.

The notice periods provided herein are in lieu of, and not in addition to, any notice periods provided by law.

19.2 **Remedies Upon Default.** Upon the occurrence of any event of default by Tenant, Landlord shall have, in addition to any other remedies available to Landlord at law or in equity (all of which remedies shall be distinct, separate and cumulative), the option to pursue any one or more of the following remedies (including, without limitation, during any eviction moratorium, to the extent allowed by "Applicable Law," as that term is defined in Article 24 of this Lease), each and all of which shall be cumulative and nonexclusive, without any notice or demand whatsoever.

19.2.1 Terminate this Lease, in which event Tenant shall immediately surrender the Premises to Landlord, and if Tenant fails to do so, Landlord may, without prejudice to any other remedy which it may have for possession or arrearages in rent, enter upon and take possession of the Premises and expel or remove Tenant and any other person who may be occupying the Premises or any part thereof, without being liable for prosecution or any claim or damages therefor; and Landlord may recover from Tenant the following:

(i) The worth at the time of award of the unpaid rent which has been earned at the time of such termination; plus

(ii) The worth at the time of award of the amount by which the unpaid rent which would have been earned after termination until the time of award exceeds the amount of such rental loss that Tenant proves could have been reasonably avoided; plus

(iii) The worth at the time of award of the amount by which the unpaid rent for the balance of the Lease Term after the time of award exceeds the amount of such rental loss that Tenant proves could have been reasonably avoided; plus

(iv) Any other amount necessary to compensate Landlord for all the detriment proximately caused by Tenant's failure to perform its obligations under this Lease or which in the ordinary course of things would be likely to result therefrom, specifically including, but not limited to, brokerage commissions and advertising expenses incurred, expenses of remodeling the Premises or any portion thereof for a new tenant, whether for the same or a different use, and any special concessions made to obtain a new tenant; and

(v) At Landlord's election, such other amounts in addition to or in lieu of the foregoing as may be permitted from time to time by applicable law.

The term "rent" as used in this Section 19.2 shall be deemed to be and to mean all sums of every nature required to be paid by Tenant pursuant to the terms of this Lease, whether to Landlord or to others. As used in Sections 19.2.1(i) and (ii) above, the "worth at the time of award" shall be computed by allowing interest at the rate set forth in Article 25 below, but in no case greater than the maximum amount of such interest permitted by law. As used in Section 19.2.1(iii) above, the "worth at the time of award" shall be computed by discounting such amount at the discount rate of the Federal Reserve Bank of San Francisco at the time of award plus one percent (1%).

19.2.2 If Landlord does not elect to terminate this Lease on account of any default by Tenant, Landlord may continue the Lease in effect (whether or not Tenant has abandoned or vacated the Premises) and, from time to time, without terminating this Lease, enforce all of its rights and remedies under this Lease, including the right to recover all rent as it becomes due.

19.2.3 Landlord may re-enter and attempt to relet the Premises without terminating this Lease and remove all persons and property from the Premises (which property may be removed and stored in a public warehouse or elsewhere at the sole cost and risk of, and for the account of, Tenant), all without service of notice or resort to legal process and without being deemed guilty of trespass, or any liability of Landlord for any loss or damage which may be occasioned thereby. If Landlord, without terminating this Lease, either (i) elects to re-enter the Premises and attempts to relet the Premises, (ii) takes possession of the Premises pursuant to legal proceedings, or (iii) takes possession of the Premises pursuant to any notice provided by law, then Landlord may, from time to time, make such alterations and repairs as may be necessary in order to relet the Premises or any part thereof for such term or terms (which may be for a term extending beyond the Lease Term) and at such rent and other terms as Landlord in its reasonable discretion deems advisable. Upon such reletting, all rent received by Landlord from such reletting shall be applied, first to the payment of any indebtedness of Tenant to Landlord (other than for any rent due hereunder); second, to the payment of any costs and expenses of obtaining possession and any such reletting, including the expense of alterations and repairs, brokerage fees and attorneys' fees; third, to the payment of any rent due and unpaid hereunder. If such rents and any other amounts received from such reletting during any month are less than that to be paid during that month by Tenant, then Tenant shall immediately pay such deficiency to Landlord. No such re-entry or taking of possession of the Premises by Landlord shall be construed as an election by Landlord to terminate this Lease unless a notice of such intention is given by Landlord to Tenant. Notwithstanding any such reletting without termination, Landlord may at any time thereafter elect to terminate this Lease for such previous default. Should Landlord at any time terminate this Lease for any default, in addition to any other remedies it may have, Landlord shall be entitled to the remedy set forth in Section 19.2.1 above, and may recover all damages it may incur by reason of such default, including the cost of recovering the Premises, reimbursement of any brokerage fees incurred by Landlord in connection with this Lease and all rent (accrued or to accrue during the Lease Term) which, at Landlord's election, shall be accelerated and be due in full on demand.

19.2.4 Landlord shall at all times have the rights and remedies (which shall be cumulative with each other and cumulative and in addition to those rights and remedies available under Sections 19.2.1, 19.2.2 and 19.2.3 above, or any law or other provision of this Lease), without prior demand or notice except as required by applicable law, to seek any declaratory, injunctive or other equitable relief, and specifically enforce this Lease, or restrain or enjoin a violation or breach of any provision hereof.

19.3 **Subleases of Tenant.** Whether or not Landlord elects to terminate this Lease on account of any default by Tenant, as set forth in this Article 19, Landlord shall have the right to terminate any and all subleases, licenses, concessions or other consensual arrangements for possession entered into by Tenant and affecting the Premises or may, in Landlord's sole discretion, succeed to Tenant's interest in such subleases, licenses, concessions or arrangements. In the event of Landlord's election to succeed to Tenant's interest in any such subleases, licenses, concessions or arrangements, Tenant shall, as of the date of notice by Landlord of such election, have no further right to or interest in the rent or other consideration receivable thereunder.

19.4 **Efforts to Relet.** No re-entry or repossession, repairs, maintenance, changes, alterations and additions, reletting, appointment of a receiver to protect Landlord's interests hereunder, or any other action or omission by Landlord shall be construed as an election by Landlord to terminate this Lease or Tenant's right to possession, or to accept a surrender of the Premises, nor shall same operate to release Tenant in whole or in part from any of Tenant's obligations hereunder, unless express written notice of such intention is sent by Landlord to Tenant. Tenant hereby irrevocably waives any right otherwise available under any law to redeem or reinstate this Lease.

19.5 **Landlord Default.** Landlord shall be in default under this Lease if Landlord fails to perform any of its obligations hereunder following the Lease Commencement Date and such failure continues for thirty (30) days after Tenant delivers to Landlord written notice specifying such failure; however, if such failure cannot reasonably be cured within such 30-day period, but Landlord commences to cure such failure within such 30-day period and thereafter diligently pursues the curing thereof to completion, then Landlord shall not be in default hereunder or liable for damages therefor. Except where the provisions of this Lease grant Tenant an express, exclusive remedy, or expressly deny Tenant a remedy, Tenant's exclusive remedy for Landlord's failure to perform its obligations under this Lease shall be limited to damages, injunctive relief, or specific performance; in each case, Landlord's liability or obligations with respect to any such remedy shall be limited as provided in Section 29.13.

ARTICLE 20

COVENANT OF QUIET ENJOYMENT

Landlord covenants that Tenant, on paying the Rent, charges for services and other payments herein reserved and on keeping, observing and performing all the other terms, covenants, conditions, provisions and agreements herein contained on the part of Tenant to be kept, observed and performed, shall, during the Lease Term, peaceably and quietly have, hold and enjoy the Premises subject to the terms, covenants, conditions, provisions and agreements hereof without interference by any persons lawfully claiming by or through Landlord. The foregoing covenant is in lieu of any other covenant express or implied.

ARTICLE 21

INTENTIONALLY DELETED

ARTICLE 22

INTENTIONALLY DELETED

ARTICLE 23

SIGNS

23.1 **Full Floors.** Subject to Landlord's prior written approval, in its sole discretion, and provided all signs are in keeping with the quality, design and style of the Building and Project, Tenant, if the Premises comprise an entire floor of the Building, at its sole cost and expense, may install identification signage anywhere in the Premises including in the elevator lobby of the Premises, provided that such signs must not be visible from the exterior of the Building.

23.2 **Multi-Tenant Floors.** If other tenants occupy space on the floor on which the Premises is located, Tenant's initial identifying signage shall be provided by Landlord, at Landlord's cost, and such signage shall be comparable to that used by Landlord for other similar floors in the Building and shall comply with Landlord's then-current Building standard signage program.

23.3 **Prohibited Signage and Other Items.** Any signs, notices, logos, pictures, names or advertisements which are installed and that have not been separately approved by Landlord may be removed without notice by Landlord at the sole expense of Tenant. Tenant may not install any signs on the exterior or roof of the Project or the Common Areas. Any signs, window coverings, or blinds (even if the same are located behind the Landlord-approved window coverings for the Building), or other items visible from the exterior of the Premises or Building, shall be subject to the prior approval of Landlord, in its sole discretion.

23.4 **Directories.**

23.4.1 **Fifth Floor Directory.** Tenant's name shall, at Landlord's expense, be listed on the directory located on the fifth (5th) floor of the Building.

23.4.2 **Building Directory.** Tenant shall be entitled, at Landlord's sole cost and expense, to have its name listed on the electronic directory located in the lobby of the Building.

23.4.3 **Other Terms.** Tenant's listing on all directories shall be in accordance with Landlord's Building standards.

ARTICLE 24

COMPLIANCE WITH LAW

24.1 Tenant shall not do anything or suffer anything to be done in or about the Premises or the Project which will in any way conflict with any law, statute, ordinance or other rule, directive, order, regulation, guideline, or requirement of any governmental entity or governmental agency now in force or which may hereafter be enacted or promulgated (collectively, "**Applicable Laws**"). At its sole cost and expense, Tenant shall promptly comply with all Applicable Laws which relate to (i) Tenant's use of, or requirements to cease or reduce Tenant's business operations in or Tenant's use of, the Premises, (ii) the tenant improvements in the Premises (including, without limitation, the Tenant Improvements and any Alterations), or (iii) the Base Building, but as to the Base Building, only to the extent such obligations are triggered by the tenant improvements in the Premises (including, without limitation, the Tenant Improvements and any Alterations) or Tenant's use of the Premises for non-typical general office use. Should any standard or regulation now or hereafter be imposed on Landlord or Tenant by a state, federal or local governmental body charged with the establishment, regulation and enforcement of occupational, health or safety standards for employers, employees, landlords or tenants, then Tenant agrees, at its sole cost and expense, to comply promptly with such standards or regulations. Tenant shall be responsible, at its sole cost and expense, to make all alterations to the Premises as are required to comply with the governmental rules, regulations, requirements or standards described in this **Article 24**. The judgment of any court of competent jurisdiction or the admission of Tenant in any judicial action, regardless of whether Landlord is a party thereto, that Tenant has violated any of said governmental measures, shall be conclusive of that fact as between Landlord and Tenant.

24.2 As required by K.C.C. 12.16.125, neither Tenant nor Landlord shall discriminate on the basis of race, color, marital status, national origin, religious affiliation, disability, sexual orientation, gender identity or expression or age except by minimum age and retirement provisions, unless based upon a bona fide occupational qualification, in the employment or application for employment or in the administration or delivery of services or any other benefits under King County Code chapter 12.16. Tenant and Landlord shall comply fully with all applicable federal, state and local laws, ordinances, executive orders and regulations that prohibit such discrimination. These laws include, but are not limited to, chapter 49.60 RCW, and Titles VI and VII of the Civil Rights Act of 1964.

ARTICLE 25

LATE CHARGES

If any installment of Rent or any other sum due from Tenant shall not be received by Landlord or Landlord's designee within ten (10) business days after Tenant's receipt of written notice from Landlord that said amount is due, then Tenant shall pay to Landlord a late charge equal to five percent (5%) of the overdue amount plus any reasonable attorneys' fees incurred by Landlord by reason of Tenant's failure to pay Rent and/or other charges when due hereunder. The late charge shall be deemed Additional Rent and the right to require it shall be in addition to all of Landlord's other rights and remedies hereunder or at law and shall not be construed as liquidated damages or as limiting Landlord's remedies in any manner. In addition to the late charge described above, any Rent or other amounts owing hereunder which are not paid within ten (10) business days after the date they are due shall bear interest from the date when due until paid at a rate per annum equal to the lesser of (i) the annual "Bank Prime Loan" rate cited in the Federal Reserve Statistical Release Publication H.15, published on the first Tuesday of each calendar month (or such other comparable index as Landlord and Tenant shall reasonably agree upon if such rate ceases to be published) plus two (2) percentage points, and (ii) the highest rate permitted by applicable law.

ARTICLE 26

LANDLORD'S RIGHT TO CURE DEFAULT; PAYMENTS BY TENANT

26.1 **Landlord's Cure.** All covenants and agreements to be kept or performed by Tenant under this Lease shall be performed by Tenant at Tenant's sole cost and expense and without any reduction of Rent, except to the extent, if any, otherwise expressly provided herein. If Tenant shall fail to perform any obligation under this Lease, and such failure shall continue in excess of the time allowed under Section 19.1.2 above, unless a specific time period is otherwise stated in this Lease, Landlord may, but shall not be obligated to, make any such payment or perform any such act on Tenant's part without waiving its rights based upon any default of Tenant and without releasing Tenant from any obligations hereunder.

26.2 **Tenant's Reimbursement.** Except as may be specifically provided to the contrary in this Lease, Tenant shall pay to Landlord, upon delivery by Landlord to Tenant of statements therefor: (i) sums equal to expenditures reasonably made and obligations incurred by Landlord in connection with the remedying by Landlord of Tenant's defaults pursuant to the provisions of Section 26.1; (ii) sums equal to all losses, costs, liabilities, damages and expenses referred to in Article 10 above; and (iii) sums equal to all expenditures made and obligations incurred by Landlord in collecting or attempting to collect the Rent or in enforcing or attempting to enforce any rights of Landlord under this Lease or pursuant to law, including, without limitation, all reasonable legal fees and other amounts so expended. Tenant's obligations under this Section 26.2 shall survive the expiration or sooner termination of the Lease Term.

ARTICLE 27

ENTRY BY LANDLORD

Landlord reserves the right at all reasonable times and upon reasonable notice to Tenant (except in the case of an emergency) to enter the Premises to (i) inspect them; (ii) show the Premises to prospective purchasers, or to current or prospective mortgagees, ground or underlying lessors or insurers or, during the last twelve (12) months of the Lease Term, to prospective tenants; (iii) post notices of nonresponsibility; or (iv) alter, improve or repair the Premises or the Building, or for structural alterations, repairs or improvements to the Building or the Building's systems and equipment. Notwithstanding anything to the contrary contained in this Article 27, Landlord may enter the Premises at any time to (A) perform services required of Landlord, including janitorial service; (B) take possession due to any breach of this Lease in the manner provided herein; and (C) perform any covenants of Tenant which Tenant fails to perform. Landlord may make any such entries without the abatement of Rent, except as otherwise provided in this Lease, and may take such reasonable steps as required to accomplish the stated purposes. Tenant hereby waives any claims for damages or for any injuries or inconvenience to or interference with Tenant's business, lost profits, any loss of occupancy or quiet enjoyment of the Premises, and any other loss occasioned thereby. For each of the above purposes, Landlord shall at all times have a key with which to unlock all the doors in the Premises, excluding Tenant's

vaults, safes and special security areas designated in advance by Tenant. In an emergency, Landlord shall have the right to use any means that Landlord may deem proper to open the doors in and to the Premises. Any entry into the Premises by Landlord in the manner hereinbefore described shall not be deemed to be a forcible or unlawful entry into, or a detainer of, the Premises, or an actual or constructive eviction of Tenant from any portion of the Premises. No provision of this Lease shall be construed as obligating Landlord to perform any repairs, alterations or decorations except as otherwise expressly agreed to be performed by Landlord herein.

ARTICLE 28

TENANT PARKING

Tenant shall have the right, but not the obligation, to rent from Landlord, commencing on the Lease Commencement Date, the amount of parking passes set forth in Section 9 of the Summary, on a monthly basis throughout the Lease Term, which parking passes shall pertain to the Project parking facility. Subject to the maximum number of parking passes to which Tenant is entitled pursuant to the terms of this Lease, Tenant may increase or decrease the number of parking passes rented by Tenant from time to time upon not less than thirty (30) days' notice to Landlord. Tenant shall pay to Landlord for such parking passes on a monthly basis the prevailing rate charged from time to time at the location of such parking passes. In addition, Tenant shall be responsible for the full amount of any taxes imposed by any governmental authority in connection with the renting of such parking passes by Tenant or the use of the parking facility by Tenant. Tenant's continued right to use the parking passes is conditioned upon Tenant abiding by all rules and regulations which are prescribed from time to time for the orderly operation and use of the parking facility where the parking passes are located (including any sticker or other identification system established by Landlord and the prohibition of vehicle repair and maintenance activities in the Project's parking facilities), Tenant's cooperation in seeing that Tenant's employees and visitors also comply with such rules and regulations and Tenant not being in default under this Lease. Tenant's use of the Project parking facility shall be at Tenant's sole risk and Tenant acknowledges and agrees that Landlord shall have no liability whatsoever for damage to the vehicles of Tenant, its employees and/or visitors, or for other personal injury or property damage or theft relating to or connected with the parking rights granted herein or any of Tenant's, its employees' and/or visitors' use of the parking facilities. Landlord specifically reserves the right to change the size, configuration, design, layout and all other aspects of the Project parking facility at any time and Tenant acknowledges and agrees that Landlord may, without incurring any liability to Tenant and without any abatement of Rent under this Lease, from time to time, close-off or restrict access to the Project parking facility for purposes of permitting or facilitating any such construction, alteration or improvements. Landlord may delegate its responsibilities hereunder to a parking operator in which case such parking operator shall have all the rights of control attributed hereby to the Landlord. The parking passes rented by Tenant pursuant to this Article 28 are provided to Tenant solely for use by Tenant's own personnel and such passes may not be transferred, assigned, subleased or otherwise alienated by Tenant without Landlord's prior approval. Tenant may validate visitor parking by such method or methods as the Landlord may establish, at the validation rate from time to time generally applicable to visitor parking.

ARTICLE 29

MISCELLANEOUS PROVISIONS

29.1 **Terms; Captions.** The words "Landlord" and "Tenant" as used herein shall include the plural as well as the singular. The necessary grammatical changes required to make the provisions hereof apply either to corporations or partnerships or individuals, and to natural persons of any gender, as the case may require, shall in all cases be assumed as though in each case fully expressed. The captions of Articles and Sections are for convenience only and shall not be deemed to limit, construe, affect or alter the meaning of such Articles and Sections.

29.2 **Binding Effect.** Subject to all other provisions of this Lease, each of the covenants, conditions and provisions of this Lease shall extend to and shall, as the case may require, bind or inure to the benefit not only of Landlord and of Tenant, but also of their respective heirs, personal representatives, successors or assigns, provided this clause shall not permit any assignment by Tenant contrary to the provisions of Article 14 above.

29.3 **No Air Rights.** No rights to any view or to light or air over any property, whether belonging to Landlord or any other person, are granted to Tenant by this Lease. If at any time any windows of the Premises are

temporarily darkened or the light or view therefrom is obstructed by reason of any repairs, improvements, maintenance or cleaning in or about the Project, the same shall be without liability to Landlord and without any reduction or diminution of Tenant's obligations under this Lease.

29.4 **Modification of Lease.** Should any current or prospective mortgagee or ground lessor for the Building or Project require a modification of this Lease, which modification in Tenant's reasonable business judgment will not cause an increased cost or expense to Tenant or in any other way materially and adversely change the rights and obligations of Tenant hereunder, then and in such event, Tenant agrees that this Lease may be so modified and agrees to execute whatever documents are reasonably required therefor and to deliver the same to Landlord within ten (10) business days following a request therefor. At the request of Landlord or any mortgagee or ground lessor, Tenant agrees to execute a short form of Lease and deliver the same to Landlord within ten (10) business days following the request therefor.

29.5 **Transfer of Landlord's Interest.** Tenant acknowledges that Landlord has the right to transfer all or any portion of its interest in the Project or Building and in this Lease, and Tenant agrees that in the event of any such transfer, Landlord shall automatically be released from all liability under this Lease and Tenant agrees to look solely to such transferee for the performance of Landlord's obligations hereunder after the date of transfer and such transferee shall be deemed to have fully assumed and be liable for all obligations of this Lease to be performed by Landlord, including the return of any Security Deposit, and Tenant shall attorn to such transferee.

29.6 **Prohibition Against Recording.** Except as provided in Section 29.4 above, neither this Lease, nor any memorandum, affidavit or other writing with respect thereto, shall be recorded by Tenant or by anyone acting through, under or on behalf of Tenant.

29.7 **Landlord's Title.** Landlord's title is and always shall be paramount to the title of Tenant. Nothing herein contained shall empower Tenant to do any act which can, shall or may encumber the title of Landlord.

29.8 **Relationship of Parties.** Nothing contained in this Lease shall be deemed or construed by the parties hereto or by any third party to create the relationship of principal and agent, partnership, joint venturer or any association between Landlord and Tenant. Nothing in this Lease shall create or be deemed to create any right, privilege, duty, claim, or cause of action in any person or entity not a party to this Lease.

29.9 **Application of Payments.** Landlord shall have the right to apply payments received from Tenant pursuant to this Lease, regardless of Tenant's designation of such payments, to satisfy any obligations of Tenant hereunder, in such order and amounts as Landlord, in its sole discretion, may elect.

29.10 **Time of Essence.** Time is of the essence with respect to the performance of every provision of this Lease in which time of performance is a factor.

29.11 **Partial Invalidity.** If any term, provision or condition contained in this Lease shall, to any extent, be invalid or unenforceable, the remainder of this Lease, or the application of such term, provision or condition to persons or circumstances other than those with respect to which it is invalid or unenforceable, shall not be affected thereby, and each and every other term, provision and condition of this Lease shall be valid and enforceable to the fullest extent possible permitted by law.

29.12 **No Warranty.** In executing and delivering this Lease, Tenant has not relied on any representations, including, but not limited to, any representation as to the amount of any item comprising Additional Rent or the amount of the Additional Rent in the aggregate or that Landlord is furnishing the same services to other tenants, at all, on the same level or on the same basis, or any warranty or any statement of Landlord which is not set forth herein or in one or more of the exhibits attached hereto.

29.13 **Landlord Exculpation.** The liability of Landlord or the Landlord Parties to Tenant for any default by Landlord under this Lease or arising in connection herewith or with Landlord's operation, management, leasing, repair, renovation, alteration or any other matter relating to the Project or the Premises shall be limited solely and exclusively to an amount which is equal to the lesser of (a) the interest of Landlord in the Building, (b) the equity

interest Landlord would have in the Building if the Building were encumbered by third-party debt in an amount equal to eighty percent (80%) of the value of the Building (as such value is determined by Landlord), provided that in no event shall such liability extend to any sales or insurance proceeds received by Landlord or the Landlord Parties in connection with the Project, Building or Premises, or (c) Ten Million and No/100 Dollars (\$10,000,000.00). Neither Landlord, nor any of the Landlord Parties shall have any personal liability therefor, and Tenant hereby expressly waives and releases such personal liability on behalf of itself and all persons claiming by, through or under Tenant. The limitations of liability contained in this Section 29.13 shall inure to the benefit of Landlord's and the Landlord Parties' present and future partners, beneficiaries, officers, directors, trustees, shareholders, agents and employees, and their respective partners, heirs, successors and assigns. Under no circumstances shall any present or future partner of Landlord (if Landlord is a partnership), or trustee or beneficiary (if Landlord or any partner of Landlord is a trust), have any liability for the performance of Landlord's obligations under this Lease. Notwithstanding any contrary provision herein, neither Landlord nor the Landlord Parties shall be liable under any circumstances for injury or damage to, or interference with, Tenant's business, including but not limited to, loss of profits, loss of rents or other revenues, loss of business opportunity, loss of goodwill or loss of use, in each case, however occurring.

29.14 **Entire Agreement.** It is understood and acknowledged that there are no oral agreements between the parties hereto affecting this Lease and this Lease constitutes the parties' entire agreement with respect to the leasing of the Premises and supersedes and cancels any and all previous negotiations, arrangements, brochures, agreements and understandings, if any, between the parties hereto or displayed by Landlord to Tenant with respect to the subject matter thereof, and none thereof shall be used to interpret or construe this Lease. None of the terms, covenants, conditions or provisions of this Lease can be modified, deleted or added to except in writing signed by the parties hereto.

29.15 **Right to Lease.** Landlord reserves the absolute right to effect such other tenancies in the Project as Landlord in the exercise of its sole business judgment shall determine to best promote the interests of the Building or Project. Tenant does not rely on the fact, nor does Landlord represent, that any specific tenant or type or number of tenants shall, during the Lease Term, occupy any space in the Building or Project.

29.16 **Force Majeure.** Notwithstanding anything to the contrary contained in this Lease, any prevention, delay or stoppage due to strikes, lockouts, labor disputes, acts of God, acts of war, terrorist acts, inability to obtain services, labor, or materials or reasonable substitutes therefor, governmental actions, governmental laws, regulations or restrictions, civil commotions, Casualty, actual or threatened public health emergency (including, without limitation, epidemic, pandemic, famine, disease, plague, quarantine, and other significant public health risk), governmental edicts, actions, declarations or quarantines by a governmental entity or health organization (including, without limitation, any shelter-in-place orders, stay at home orders or any restrictions on travel related thereto that preclude Tenant, its agents, contractors or its employees from accessing the Premises, national or regional emergency), breaches in cybersecurity, and other causes beyond the reasonable control of the party obligated to perform, regardless of whether such other causes are (i) foreseeable or unforeseeable or (ii) related to the specifically enumerated events in this paragraph (collectively, a "**Force Majeure**"), shall excuse the performance of such party for a period equal to any such prevention, delay or stoppage. If this Lease specifies a time period for performance of an obligation of either party, that time period shall be extended by the period of any delay in such party's performance caused by a Force Majeure. Notwithstanding anything to the contrary in this Lease, no event of Force Majeure shall (i) excuse Tenant's obligations to pay Rent and other charges due pursuant to this Lease, (ii) be grounds for Tenant to abate any portion of Rent due pursuant to this Lease, or entitle either party to terminate this Lease, except as allowed pursuant to Articles 11 and 13 of this Lease, or (iii) excuse Tenant's obligations under Articles 5 and 24 of this Lease.

29.17 **Waiver of Redemption by Tenant.** Tenant hereby waives, for Tenant and for all those claiming under Tenant, any and all rights now or hereafter existing to redeem by order or judgment of any court or by any legal process or writ, Tenant's right of occupancy of the Premises after any termination of this Lease.

29.18 **Notices.** All notices, demands, statements, designations, approvals or other communications (collectively, "**Notices**") given or required to be given by either party to the other hereunder or by law shall be in writing, shall be (A) sent by United States certified or registered mail, postage prepaid, return receipt requested ("**Mail**"), (B) delivered by a nationally recognized overnight courier, or (C) delivered personally. Any Notice shall be sent, transmitted, or delivered, as the case may be, to Tenant at the appropriate address set forth in Section 10 of the Summary, or to such other place as Tenant may from time to time designate in a Notice to Landlord, or to Landlord

at the addresses set forth below, or to such other places as Landlord may from time to time designate in a Notice to Tenant. Any Notice will be deemed given (i) three (3) days after the date it is posted if sent by Mail, (ii) the date the overnight courier delivery is made, or (iii) the date personal delivery is made. As of the date of this Lease, any Notices to Landlord must be sent, transmitted, or delivered, as the case may be, to the following addresses:

GC Columbia, LLC
c/o Urban Renaissance Property Company
701 5th Avenue, Suite 4000
Seattle, Washington 98104

and

GC Columbia, LLC
c/o Gaw Capital Advisors (USA), LLC
701 Fifth Avenue, Suite 4000
Seattle, WA 98104
Attention: Adam Bowser

and

Allen Matkins Leck Gamble Mallory & Natsis LLP
865 S. Figueroa Street, Suite 2800
Los Angeles, California 90017
Attention: David B. Stone, Esq.

29.19 **Joint and Several.** If there is more than one Tenant, the obligations imposed upon Tenant under this Lease shall be joint and several.

29.20 **Authority.** Each individual executing this Lease on behalf of Tenant hereby represents and warrants that Tenant is a duly formed and existing entity qualified to do business in the State of Washington and that Tenant has full right and authority to execute and deliver this Lease and that each person signing on behalf of Tenant is authorized to do so. Tenant represents and warrants to Landlord, and Landlord acknowledges, that Tenant is a home rule charter county and political subdivision of the State of Washington, and that Tenant's execution of this Lease was duly authorized by ordinance as set forth in Section 15 of the Summary.

29.21 **Attorneys' Fees.** In the event that either Landlord or Tenant should bring suit for the possession of the Premises, for the recovery of any sum due under this Lease, or because of the breach of any provision of this Lease or for any other relief against the other, then all costs and expenses, including reasonable attorneys' fees, incurred by the prevailing party therein shall be paid by the other party, which obligation on the part of the other party shall be deemed to have accrued on the date of the commencement of such action and shall be enforceable whether or not the action is prosecuted to judgment.

29.22 **Governing Law; WAIVER OF TRIAL BY JURY.** This Lease shall be construed and enforced in accordance with the laws of the State of Washington, without giving effect to its conflicts of laws rules or choice of law provisions. IN ANY ACTION OR PROCEEDING ARISING HEREFROM, LANDLORD AND TENANT HEREBY CONSENT TO (I) THE JURISDICTION OF ANY COMPETENT COURT WITHIN THE STATE OF WASHINGTON, (II) SERVICE OF PROCESS BY ANY MEANS AUTHORIZED BY WASHINGTON LAW, AND (III) TO THE EXTENT PERMITTED BY APPLICABLE LAW, IN THE INTEREST OF SAVING TIME AND EXPENSE, TRIAL WITHOUT A JURY IN ANY ACTION, PROCEEDING OR COUNTERCLAIM BROUGHT BY EITHER OF THE PARTIES HERETO AGAINST THE OTHER OR THEIR SUCCESSORS IN RESPECT OF ANY MATTER ARISING OUT OF OR IN CONNECTION WITH THIS LEASE, THE RELATIONSHIP OF LANDLORD AND TENANT, TENANT'S USE OR OCCUPANCY OF THE PREMISES, AND/OR ANY CLAIM FOR INJURY OR DAMAGE, OR ANY EMERGENCY OR STATUTORY REMEDY.

29.23 **Submission of Lease.** Submission of this instrument for examination or signature by Tenant does not constitute a reservation of, option for or option to lease, and it is not effective as a lease or otherwise until execution and delivery by both Landlord and Tenant.

29.24 **Brokers.** Landlord and Tenant hereby warrant to each other that they have had no dealings with any real estate broker or agent in connection with the negotiation of this Lease, excepting only the real estate brokers or agents specified in Section 12 of the Summary (the "**Brokers**"), and that they know of no other real estate broker or agent who is entitled to a commission in connection with this Lease. Each party agrees to indemnify and defend the other party against and hold the other party harmless from any and all claims, demands, losses, liabilities, lawsuits, judgments, costs and expenses (including without limitation reasonable attorneys' fees) with respect to any leasing commission or equivalent compensation alleged to be owing on account of any dealings with any real estate broker or agent, other than the Brokers, occurring by, through, or under the indemnifying party. The terms of this Section 29.24 shall survive the expiration or earlier termination of the Lease Term.

29.25 **Independent Covenants.** This Lease shall be construed as though the covenants herein between Landlord and Tenant are independent and not dependent and Tenant hereby expressly waives the benefit of any statute to the contrary and agrees that if Landlord fails to perform its obligations set forth herein, Tenant shall not be entitled to make any repairs or perform any acts hereunder at Landlord's expense or to any setoff of the Rent or other amounts owing hereunder against Landlord.

29.26 **Project or Building Name, Address and Signage.** Landlord shall have the right at any time to change the name and/or address of the Project or Building and to install, affix and maintain any and all signs on the exterior and on the interior of the Project or Building as Landlord may, in Landlord's sole discretion, desire. Tenant shall not use the name of the Project or Building or use pictures or illustrations of the Project or Building in advertising or other publicity or for any purpose other than as the address of the business to be conducted by Tenant in the Premises, without the prior written consent of Landlord.

29.27 **Counterparts.** This Lease may be executed in counterparts with the same effect as if both parties hereto had executed the same document. Both counterparts shall be construed together and shall constitute a single lease.

29.28 **Intentionally Deleted.**

29.29 **Building Renovations.** It is specifically understood and agreed that Landlord has no obligation and has made no promises to alter, remodel, improve, renovate, repair or decorate the Premises, Building, or any part thereof and that no representations respecting the condition of the Premises or the Building have been made by Landlord to Tenant except as specifically set forth herein or in the Tenant Work Letter. However, Tenant hereby acknowledges that Landlord is currently renovating or may during the Lease Term renovate, improve, alter, or modify (collectively, the "**Renovations**") the Project, the Building and/or the Premises. Tenant hereby agrees that such Renovations shall in no way constitute a constructive eviction of Tenant nor entitle Tenant to any abatement of Rent (except as specifically set forth in Section 6.4 of this Lease). Landlord shall have no responsibility and shall not be liable to Tenant for any injury to or interference with Tenant's business arising from the Renovations, nor shall Tenant be entitled to any compensation or damages from Landlord for loss of the use of the whole or any part of the Premises or of Tenant's personal property or improvements resulting from the Renovations, or for any inconvenience or annoyance occasioned by such Renovations. Notwithstanding anything in this Section 29.29 to the contrary, Landlord shall use commercially reasonable efforts to perform all Renovations so as to minimize any material, adverse interference with Tenant's business operations at the Premises.

29.30 **No Violation.** Tenant hereby warrants and represents that neither its execution of nor performance under this Lease shall cause Tenant to be in violation of any agreement, instrument, contract, law, rule or regulation by which Tenant is bound, and Tenant shall protect, defend, indemnify and hold Landlord harmless against any claims, demands, losses, damages, liabilities, costs and expenses, including, without limitation, reasonable attorneys' fees and costs, arising from Tenant's breach of this warranty and representation.

29.31 **Communications and Computer Lines.** Tenant may install, maintain, replace, remove or use any communications or computer wires and cables serving the Premises (collectively, the "**Lines**"), provided that (i)

Tenant shall obtain Landlord's prior written consent, use an experienced and qualified contractor approved in writing by Landlord, and comply with all of the other provisions of Articles 7 and 8 of this Lease, (ii) an acceptable number of spare Lines and space for additional Lines shall be maintained for existing and future occupants of the Project, as determined in Landlord's reasonable opinion, (iii) the Lines therefor (including riser cables) shall be appropriately insulated to prevent excessive electromagnetic fields or radiation, shall be surrounded by a protective conduit reasonably acceptable to Landlord, and shall be identified in accordance with the "Identification Requirements," as that term is set forth hereinbelow, (iv) any new or existing Lines servicing the Premises shall comply with all applicable governmental laws and regulations, (v) as a condition to permitting the installation of new Lines, Landlord may require that Tenant remove existing Lines located in or serving the Premises and repair any damage in connection with such removal, and (vi) Tenant shall pay all costs in connection therewith. All Lines shall be clearly marked with adhesive plastic labels (or plastic tags attached to such Lines with wire) to show Tenant's name, suite number, telephone number and the name of the person to contact in the case of an emergency (A) every four feet (4') outside the Premises (specifically including, but not limited to, the electrical room risers and other Common Areas), and (B) at the Lines' termination point(s) (collectively, the "**Identification Requirements**"). Prior to the expiration or earlier termination of this Lease, Tenant shall, at Tenant's sole cost and expense, remove any Lines located in or serving the Premises.

29.32 **Office and Communications Services.**

29.32.1 **The Provider.** Landlord has advised Tenant that certain office and communications services may be offered to tenants of the Building by a concessionaire under contract to Landlord ("**Provider**"). Tenant may contract with Provider for the provision of any or all of such services on such terms and conditions as Tenant and Provider may agree, but nothing contained herein shall obligate Tenant to contract with a Provider.

29.32.2 **Other Terms.** Tenant acknowledges and agrees that: (i) Landlord has made no warranty or representation to Tenant with respect to the availability of any such services, or the quality, reliability or suitability thereof; (ii) the Provider is not acting as the agent or representative of Landlord in the provision of such services, and Landlord shall have no liability or responsibility for any failure or inadequacy of such services, or any equipment or facilities used in the furnishing thereof, or any act or omission of Provider, or its agents, employees, representatives, officers or contractors; (iii) Landlord shall have no responsibility or liability for the installation, alteration, repair, maintenance, furnishing, operation, adjustment or removal of any such services, equipment or facilities; and (iv) any contract or other agreement between Tenant and Provider shall be independent of this Lease, the obligations of Tenant hereunder, and the rights of Landlord hereunder, and, without limiting the foregoing, no default or failure of Provider with respect to any such services, equipment or facilities, or under any contract or agreement relating thereto, shall have any effect on this Lease or give to Tenant any offset or defense to the full and timely performance of its obligations hereunder, or entitle Tenant to any abatement of rent or additional rent or any other payment required to be made by Tenant hereunder, or constitute any accrual or constructive eviction of Tenant, or otherwise give rise to any other claim of any nature against Landlord.

29.33 **Waiver of Claims.** As a material inducement to Landlord to enter into this Lease, Tenant hereby releases Landlord from, and hereby waives, any and all losses, costs, damages, expenses, liabilities, claims and causes of action (collectively, the "**Released Claims**") arising from or related to Tenant's inability or limitation to conduct operations from the Premises as a result of any "shelter in place" orders or similar governmental directives, including, without limitation, any claims for, and/or rights of, termination of this Lease and/or abatement, offset and/or deferral of Rent under this Lease, at law and/or in equity related to the inability of Tenant to conduct operations from the Premises as a result of any "shelter in place" orders or similar governmental directives related thereto. Tenant additionally hereby expressly waives any rights Tenant may have under any statutes or common-law principles pertaining to the Released Claims. With respect to the Released Claims, Tenant acknowledges that Tenant has either been advised by legal counsel or has made itself familiar with the effect of this Section 29.33.

IN WITNESS WHEREOF, Landlord and Tenant have caused this Lease to be executed the day and date first above written.

LANDLORD:

GC COLUMBIA, LLC,
a Delaware limited liability company

By: Adam Bowsor
Name: ADAM BOWSOR
Title: VICE PRESIDENT

TENANT:

KING COUNTY, a home rule charter county and
political subdivision of the State of Washington

By: _____
Name: _____
Title: _____

By: _____
Name: _____
Title: _____

CUSTODIAL AGENCY: KING COUNTY
PROSECUTING ATTORNEY'S OFFICE

By: _____
Name: _____
Title: _____

TENANT NOTARY PAGE

STATE OF _____)
) ss.
COUNTY OF _____)

I certify that I know or have satisfactory evidence that _____ is the person who appeared before me, and said person acknowledged that (he/she) signed this instrument, on oath stated that (he/she) was authorized to execute the instrument and acknowledged it as the _____ of KING COUNTY, a home rule charter county and political subdivision of the State of Washington to be the free and voluntary act of such party for the uses and purposes mentioned in the instrument.

Dated: _____

(Signature)

(Seal or stamp)

Title: _____

Notary Public in and for the State of _____

My appointment expires: _____

STATE OF _____)
) ss.
COUNTY OF _____)

I certify that I know or have satisfactory evidence that _____ is the person who appeared before me, and said person acknowledged that (he/she) signed this instrument, on oath stated that (he/she) was authorized to execute the instrument and acknowledged it as the _____ of KING COUNTY, a home rule charter county and political subdivision of the State of Washington to be the free and voluntary act of such party for the uses and purposes mentioned in the instrument.

Dated: _____

(Signature)

(Seal or stamp)

Title: _____

Notary Public in and for the State of _____

My appointment expires: _____

LANDLORD NOTARY PAGE

STATE OF Washington)
) ss.
COUNTY OF King)

I certify that I know or have satisfactory evidence that Adam Brewer is the person who appeared before me, and said person acknowledged that (he/she) signed this instrument, on oath stated that (he/she) was authorized to execute the instrument and acknowledged it as the Vice President of GC COLUMBIA, LLC, a Delaware limited liability company, to be the free and voluntary act of such party for the uses and purposes mentioned in the instrument.

Dated: 3/28/2022

Kathy Dougherty
(Signature)

(Seal or stamp)

Title: Notary Public

Notary Public in and for the State of Washington

My appointment expires: 11/16/2025

KD

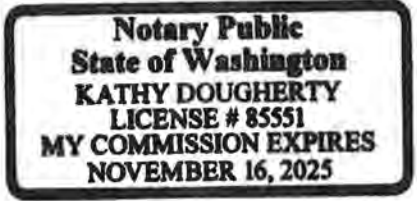
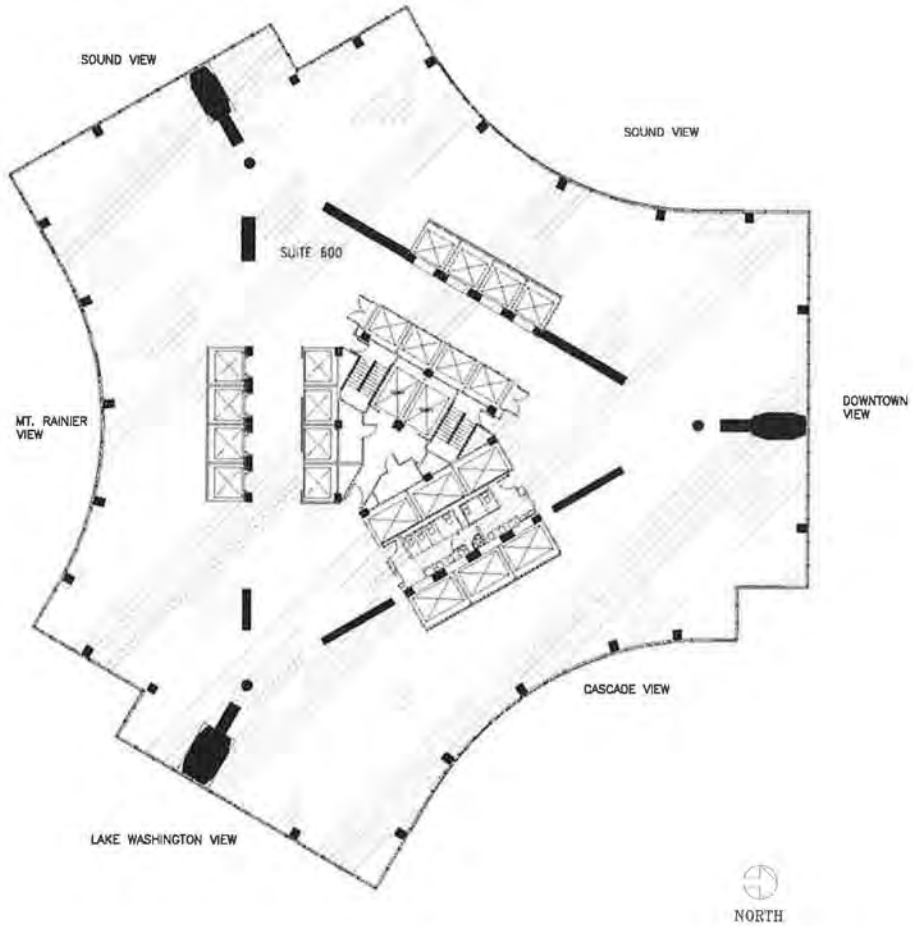

EXHIBIT A
COLUMBIA CENTER
OUTLINE OF PREMISES



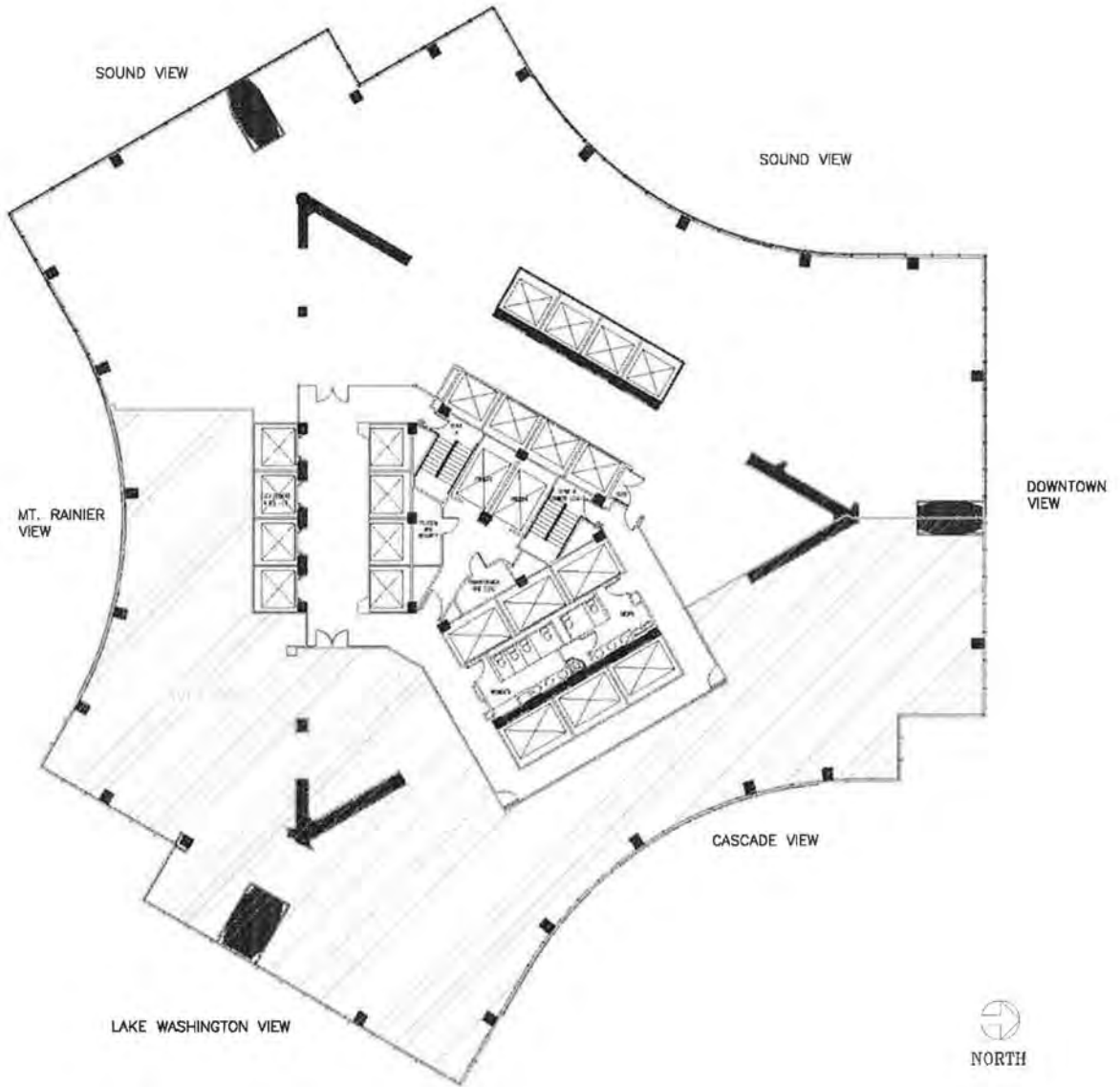

EXHIBIT A-1
COLUMBIA CENTER
LEGAL DESCRIPTION

PARCEL A:

ALL OF BLOCK 28, ADDITION TO THE TOWN OF SEATTLE, AS LAID OUT ON THE CLAIMS OF C. D. BOREN AND A. A. DENNY AND H. L. YESLER (COMMONLY KNOWN AS C. D. BOREN'S ADDITION TO THE CITY OF SEATTLE), AS PER PLAT RECORDED IN VOLUME 1 OF PLATS, PAGE 25, RECORDS OF KING COUNTY;

TOGETHER WITH THE VACATED ALLEY ADJOINING, LYING WITHIN SAID BLOCK, AS VACATED UNDER CITY OF SEATTLE ORDINANCE NO. 656;

EXCEPT THE WESTERLY 9 FEET OF SAID BLOCK 28 CONDEMNED IN KING COUNTY SUPERIOR COURT CAUSE NO. 50320 FOR WIDENING OF 4TH AVENUE, AS PROVIDED FOR BY ORDINANCE NO. 13074 OF THE CITY OF SEATTLE;

SITUATE IN THE CITY OF SEATTLE, COUNTY OF KING, STATE OF WASHINGTON.

PARCEL B:

THAT PORTION OF THE SOUTHERLY ½ OF COLUMBIA STREET LYING EASTERLY OF THE CENTER LINE OF FIFTH AVENUE AND THAT PORTION OF THE EASTERLY ½ OF FIFTH AVENUE LYING SOUTHERLY OF THE CENTER LINE OF SAID COLUMBIA STREET LYING WITHIN A STRIP OF LAND 14 FEET IN WIDTH, LYING BETWEEN ELEVATION 120.00 FEET AND ELEVATION 138.00 FEET, CITY OF SEATTLE DATUM, THE CENTER LINE OF WHICH IS DESCRIBED AS FOLLOWS:

BEGINNING AT A POINT ON THE EASTERLY PROPERTY LINE OF BLOCK 28 OF C.D. BOREN'S ADDITION TO THE CITY OF SEATTLE, SOUTH 30°40'34" EAST, 41.05 FEET FROM THE NORTHEASTERLY CORNER OF SAID BLOCK;

THENCE NORTH 21°25'31" EAST, 167.75 FEET;

THENCE NORTH 30°37'16" WEST, 3.98 FEET TO A POINT IN THE SOUTHERLY PROPERTY LINE OF BLOCK 24 OF SAID BOREN'S ADDITION, FROM WHICH THE SOUTHWESTERLY CORNER OF SAID BLOCK BEARS SOUTH 59°23'05" WEST 66.84 FEET;

SITUATE IN THE CITY OF SEATTLE, COUNTY OF KING, STATE OF WASHINGTON.

PARCEL C:

RIGHTS INURING TO A PORTION OF THE LAND DESCRIBED IN PARCEL A ABOVE, AS PROVIDED FOR UNDER THAT CERTAIN RESTRICTIVE USE COVENANT DATED APRIL 3, 1989, EXECUTED BY AND BETWEEN COSTACOS FAMILY PARTNERSHIP I, A WASHINGTON GENERAL PARTNERSHIP, AND MARTIN SELIG AND ANDREA SELIG, HUSBAND AND WIFE, RECORDED APRIL 10, 1989, UNDER RECORDING NUMBER 8904100807; AS ASSIGNED PURSUANT TO AN ASSIGNMENT OF AGREEMENT AND OPTION TO SEAFIRST CENTER LIMITED PARTNERSHIP, A WASHINGTON LIMITED PARTNERSHIP, RECORDED DECEMBER 15, 1989, UNDER RECORDING NUMBER 8912150289; AS FURTHER ASSIGNED PURSUANT TO AN ASSIGNMENT OF RESTRICTIVE COVENANT TO EOP-COLUMBIA CENTER, L.L.C., A DELAWARE LIMITED LIABILITY COMPANY, RECORDED JUNE 26, 1998, UNDER RECORDING NUMBER 9806261558.

PARCEL D:

EASEMENTS, RIGHTS OF ACCESS AND RIGHTS-OF-WAY AS SET FORTH IN THAT CERTAIN MEMORANDUM OF AGREEMENT DATED NOVEMBER 30, 1984, BY AND BETWEEN BLOCK 24, SEATTLE, LTD., A WASHINGTON LIMITED PARTNERSHIP, SEATTLE FIRST NATIONAL BANK, A NATIONAL BANKING ASSOCIATION, AND MARTIN SELIG, RECORDED JANUARY 31, 1985, UNDER RECORDING NO. 8501310855;

SITUATE IN THE CITY OF SEATTLE, COUNTY OF KING, STATE OF WASHINGTON.

EXHIBIT B
COLUMBIA CENTER
TENANT WORK LETTER

This Tenant Work Letter shall set forth the terms and conditions relating to the construction of the tenant improvements in the Premises. This Tenant Work Letter is essentially organized chronologically and addresses the issues of the construction of the Premises, in sequence, as such issues will arise during the actual construction of the Premises. All references in this Tenant Work Letter to Articles or Sections of "this Lease" shall mean the relevant portion of Articles 1 through 29 of the Office Lease to which this Tenant Work Letter is attached as Exhibit B and of which this Tenant Work Letter forms a part, and all references in this Tenant Work Letter to Sections of "this Tenant Work Letter" shall mean the relevant portion of Sections 1 through 6 of this Tenant Work Letter.

SECTION 1

CONSTRUCTION DRAWINGS FOR THE PREMISES

1.1 **Space Plan; Working Drawings.** Landlord and Tenant have approved (i) that certain space plan, prepared by Burgess Design, dated February 18, 2022 (the "Plan"), and (ii) that certain "**Tenant Improvement Estimated Scope at Columbia Center, Floors 5 and 6**", prepared by Rolluda Architects, dated March 9, 2022 (the "Rolluda Work Letter") (collectively, the "Space Plan"). In connection with the foregoing, in the event of any conflict between the Plan and the Rolluda Work Letter, the Rolluda Work Letter shall govern. Immediately following Tenant's execution and delivery of this Lease, Tenant shall cooperate in good faith with Landlord's architects and engineers to supply such information as is necessary to allow the Landlord's architects and engineers to complete the architectural and engineering drawings for the Premises, and the final architectural working drawings in a form which is complete to allow subcontractors to bid on the work and to obtain all applicable permits and in a manner consistent with, and which are a logical extension of, the Space Plan (as reasonably determined by Landlord) and otherwise in accordance with Building standards (collectively, the "Working Drawings"). In connection with the foregoing, Landlord shall retain Burgess Design in connection with the preparation of the Working Drawings. Upon completion of the Working Drawings, Landlord shall deliver the Working Drawings to Tenant, and Tenant shall approve or disapprove of such drawings (in accordance with the terms hereof) within ten (10) business days following receipt of the Working Drawings. Tenant hereby acknowledges and agrees that Tenant shall not disapprove of the Working Drawings unless the same fail to meet the requirements set forth above in this Section 1 (any such failure, a "Landlord Drawing Failure"). In the event that Tenant shall properly disapprove of the Working Drawings, Tenant shall notify Landlord with specificity of the basis therefor within the foregoing 10-business day period, and, subject to Landlord's approval of any requested change(s) (which shall not be unreasonably withheld), Landlord shall have the Working Drawings revised accordingly and provide the same to Tenant for its approval as provided for hereinabove. The foregoing procedure shall be repeated until the Working Drawings are approved by Landlord and Tenant (as so approved by Landlord and Tenant, the "Approved Working Drawings").

1.2 **Construction of Tenant Improvements.** Landlord shall construct the improvements in the Premises (the "Tenant Improvements") pursuant to the Approved Working Drawings. Tenant shall make no changes or modifications to (i) the Space Plan, or (ii) once completed, the Working Drawings or Approved Working Drawings without the prior written consent of Landlord, which consent may be withheld in Landlord's sole discretion if such change or modification would (a) directly or indirectly delay the "Substantial Completion," as that term is defined in Section 5.1 of this Tenant Work Letter, of the Premises, or (b) increase the cost of designing or constructing the Tenant Improvements; provided, however, that items (a) and (b) shall be inapplicable, and Landlord shall not unreasonably withhold its consent with regard to changes or modifications to the Working Drawings, to the extent resulting from a Landlord Drawing Failure.

1.3 **Furniture.** *For clarity purposes,* Tenant hereby acknowledges and agrees that, notwithstanding that the Plan includes representations of furniture, Landlord shall have no obligation to provide or pay for any furniture for the Premises and that all furniture for the Premises shall be obtained and installed by Tenant, at Tenant's sole cost and expense.

SECTION 2

TENANT PAYMENT OBLIGATIONS

2.1 In General. Except as provided for in this Section 2, Landlord shall construct the Tenant Improvements at its sole cost and expense.

2.2 Tenant Decisions, Changes or Substitutions. In the event that after Tenant's execution of this Lease, any revisions, changes, or substitutions shall be made to (i) the Space Plan, (ii) the Working Drawings (once the same are completed), (iii) the Approved Working Drawings (once the same are completed), or (iv) the Tenant Improvements, or in the event that Tenant requests revisions, changes, or substitutions which cause the Working Drawings or Approved Working Drawings to not be a logical extension of the Space Plan, then, except to the extent resulting from a Landlord Drawing Failure, any additional costs which arise in connection with such revisions, changes or substitutions shall be paid by Tenant to Landlord immediately upon Landlord's request.

2.3 Space Plan - Budget/Allowance Items. Tenant hereby acknowledges and agrees that, notwithstanding anything in this Tenant Work Letter to the contrary, in any instance in the Space Plan where a "budget" or "allowance" is provided for a particular item or items, (i) to the extent that the cost of such item or items exceeds the applicable budget or allowance, Tenant shall be responsible to pay the amount of such overage to Landlord, and (ii) to the extent that the cost of such item is lower than the applicable budget or allowance, such savings shall inure to the exclusive benefit of Landlord (and Tenant shall have no rights with respect thereto, whether for application to other costs to be paid by Tenant under this Tenant Work Letter, as a credit against rent or otherwise). Any such sums due to Landlord from Tenant hereunder shall be paid by Tenant within ten (10) business days following demand by Landlord.

SECTION 3

CONTRACTOR'S WARRANTIES AND GUARANTIES; PREVAILING WAGE REQUIREMENTS

3.1 Landlord hereby assigns to Tenant all warranties and guaranties by the contractor who constructs the Tenant Improvements (the "Contractor") relating to the Tenant Improvements, and Tenant hereby waives all claims against Landlord relating to, or arising out of the construction of, the Tenant Improvements.

3.2 Landlord shall require the Contractor retained in connection with the Tenant Improvements to comply with the State of Washington's prevailing wage statutes, as and to the extent required by applicable law.

SECTION 4

TENANT'S COVENANTS

Tenant hereby indemnifies Landlord for any loss, claims, damages or delays arising from the actions of Tenant's space planner/architect on the Premises or in the Building.

SECTION 5

COMPLETION OF THE TENANT IMPROVEMENTS; LEASE COMMENCEMENT DATE

5.1 Ready for Occupancy. The Premises shall be deemed "Ready for Occupancy" upon the Substantial Completion of the Premises. For purposes of this Lease, "Substantial Completion" of the Premises shall occur upon the completion of construction of the Tenant Improvements in the Premises pursuant to the Approved Working Drawings (as reasonably determined by Landlord), with the exception of any punch list items and any tenant fixtures, work-stations (including any related fixture and/or equipment electrification), built-in furniture, or equipment (including security and other Tenant systems) to be installed by Tenant or under the supervision of Contractor.

5.2 Delay of the Substantial Completion of the Premises. Except as provided in this Section 5.2, the Lease Commencement Date shall occur as set forth in the Lease and Section 5.1, above. If there shall be a delay or there are delays in the Substantial Completion of the Premises or in the occurrence of any of the other conditions precedent to the Lease Commencement Date, as set forth in of the Lease, as a direct, indirect, partial, or total result of any "Tenant Delay," as that term is defined, below, then, notwithstanding anything to the contrary set forth in this Lease or this Tenant Work Letter and regardless of the actual date of the Substantial Completion of the Premises, the Possession Date shall be deemed to be the date the Possession Date would have occurred if no Tenant Delay or Tenant Delays, as set forth above, had occurred. A "Tenant Delay" shall mean the occurrence of any of the following:

5.2.1 Tenant's failure to timely approve any matter requiring Tenant's approval;

5.2.2 A breach by Tenant of the terms of this Tenant Work Letter or the Lease;

5.2.3 Tenant's request for changes in the Space Plan, the Tenant Improvements, or, once completed, the Working Drawings or Approved Working Drawings, or Tenant's request for changes which cause the Working Drawings or Approved Working Drawings to not be a logical extension of the Space Plan;

5.2.4 Tenant's requirement for materials, components, finishes or improvements which are not available in a commercially reasonable time given the Target Possession Date, as set forth in the Lease, or which are different from, or not included in, Landlord's standard improvement package items for the Building;

5.2.5 Changes to the base, shell and core work of the Building required by the Approved Working Drawings; or

5.2.6 Any other acts or omissions of Tenant, or its agents, or employees.

SECTION 6

MISCELLANEOUS

6.1 Tenant's Entry Into the Premises Prior to Substantial Completion. Provided that Tenant and its agents do not interfere with Contractor's work in the Building and the Premises, Landlord shall allow Tenant access to the Premises prior to the Substantial Completion of the Premises for the purpose of Tenant installing overstandard equipment or fixtures (including Tenant's data and telephone equipment) in the Premises. Prior to Tenant's entry into the Premises as permitted by the terms of this Section 6.1, Tenant shall submit a schedule to Landlord and Contractor, for their approval, which schedule shall detail the timing and purpose of Tenant's entry. Tenant shall hold Landlord harmless from and indemnify, protect and defend Landlord against any loss or damage to the Building or Premises and against injury to any persons caused by Tenant's actions pursuant to this Section 6.1.

6.2 Freight Elevators. Subject to Landlord's reasonable rules, regulations and requirements, Landlord shall, consistent with its obligations to other tenants of the Building, make the freight elevator reasonably available to Tenant in connection with initial decorating, furnishing and moving into the Premises.

6.3 Tenant's Representative. Tenant has designated Karen Todd of the Civil Division of the King County Prosecuting Attorney's Office as its sole representative with respect to the matters set forth in this Tenant Work Letter, who, until further notice to Landlord, shall have full authority and responsibility to act on behalf of the Tenant as required in this Tenant Work Letter.

6.4 Landlord's Representative. Landlord has designated Chelsea Whitton as its sole representative with respect to the matters set forth in this Tenant Work Letter, who, until further notice to Tenant, shall have full authority and responsibility to act on behalf of the Landlord as required in this Tenant Work Letter.

6.5 Labor Harmony. Tenant shall not use (and upon notice from Landlord shall cease using) contractors, subcontractors, services, workmen, labor, materials or equipment that, in Landlord's reasonable judgment, would disturb labor harmony with the workforce or trades engaged in performing other work, labor or services in or about

the Project, Building or the Common Areas and/or that otherwise results in picketing or other labor disturbances at the Project and/or on property adjacent thereto.

6.6 Time of the Essence in This Tenant Work Letter. Unless otherwise indicated, all references herein to a "number of days" shall mean and refer to calendar days.

6.7 Tenant's Lease Default. Notwithstanding any provision to the contrary contained in this Lease, if an event of default as described in the Lease, or a default by Tenant under this Tenant Work Letter, has occurred at any time on or before the Substantial Completion of the Premises, then (i) in addition to all other rights and remedies granted to Landlord pursuant to the Lease, Landlord shall have the right to cause Contractor to cease the construction of the Premises (in which case, Tenant shall be responsible for any delay in the Substantial Completion of the Premises caused by such work stoppage as set forth in Section 5 of this Tenant Work Letter), and (ii) all other obligations of Landlord under the terms of this Tenant Work Letter shall be forgiven until such time as such default is cured pursuant to the terms of the Lease.

6.8 Cooperation by Tenant. Tenant acknowledges that the timing of the completion of the Working Drawings and Approved Working Drawings and the Tenant Improvements is of the utmost importance to Landlord. Accordingly, Tenant hereby agrees to fully and diligently cooperate with all reasonable requests by Landlord in connection with or related to the design and construction of the Tenant Improvements, and in connection therewith, shall respond to Landlord's requests for information and/or approvals, except as specifically set forth herein to the contrary, within three (3) business days following request by Landlord.

END OF TENANT WORK LETTER

EXHIBIT C

COLUMBIA CENTER

NOTICE OF LEASE TERM DATES

To: _____

Re: Office Lease dated _____, 20__ between GC COLUMBIA, LLC, a Delaware limited liability company ("**Landlord**"), and _____, a ("**Tenant**") concerning Suite _____ on floor(s) _____ of the office building located at 701 Fifth Avenue, Seattle, Washington.

Gentlemen:

In accordance with the Office Lease (the "**Lease**"), we wish to advise you and/or confirm as follows:

1. The Lease Term shall commence on or has commenced on _____ for a term of _____ ending on _____.
2. Rent commenced to accrue on _____, in the amount of _____.
3. If the Lease Commencement Date is other than the first day of the month, the first billing will contain a pro rata adjustment. Each billing thereafter, with the exception of the final billing, shall be for the full amount of the monthly installment as provided for in the Lease.
4. Your rent checks should be made payable to _____ at _____.

"Landlord":

GC COLUMBIA, LLC,
a Delaware limited liability company

By: _____
Its: _____

Agreed to and Accepted as
of _____, 20__.

"Tenant":

a _____

By: _____
Its: _____

EXHIBIT D

COLUMBIA CENTER

RULES AND REGULATIONS

Tenant shall faithfully observe and comply with the following Rules and Regulations. Landlord shall not be responsible to Tenant for the nonperformance of any of said Rules and Regulations by or otherwise with respect to the acts or omissions of any other tenants or occupants of the Project. In the event of any conflict between the Rules and Regulations and the other provisions of this Lease, the latter shall control.

1. Tenant shall not alter any lock or install any new or additional locks or bolts on any doors or windows of the Premises without obtaining Landlord's prior written consent. Tenant shall bear the cost of any lock changes or repairs required by Tenant. Two keys will be furnished by Landlord for the Premises, and any additional keys required by Tenant must be obtained from Landlord at a reasonable cost to be established by Landlord. Upon the termination of this Lease, Tenant shall restore to Landlord all keys of stores, offices, and toilet rooms, either furnished to, or otherwise procured by, Tenant and in the event of the loss of keys so furnished, Tenant shall pay to Landlord the cost of replacing same or of changing the lock or locks opened by such lost key if Landlord shall deem it necessary to make such changes.

2. All doors opening to public corridors shall be kept closed at all times except for normal ingress and egress to the Premises.

3. Landlord reserves the right to close and keep locked all entrance and exit doors of the Building during such hours as are customary for comparable buildings in the vicinity of the Building. Tenant, its employees and agents must be sure that the doors to the Building are securely closed and locked when leaving the Premises if it is after the normal hours of business for the Building. Any tenant, its employees, agents or any other persons entering or leaving the Building at any time when it is so locked, or any time when it is considered to be after normal business hours for the Building, may be required to sign the Building register. Access to the Building may be refused unless the person seeking access has proper identification or has a previously arranged pass for access to the Building. Landlord will furnish passes to persons for whom Tenant requests same in writing. Tenant shall be responsible for all persons for whom Tenant requests passes and shall be liable to Landlord for all acts of such persons. The Landlord and his agents shall in no case be liable for damages for any error with regard to the admission to or exclusion from the Building of any person. In case of invasion, mob, riot, public excitement, or other commotion, Landlord reserves the right to prevent access to the Building or the Project during the continuance thereof by any means it deems appropriate for the safety and protection of life and property.

4. No furniture, freight or equipment of any kind shall be brought into the Building without prior notice to Landlord. All moving activity into or out of the Building shall be scheduled with Landlord and done only at such time and in such manner as Landlord designates. Landlord shall have the right to prescribe the weight, size and position of all safes and other heavy property brought into the Building and also the times and manner of moving the same in and out of the Building. Safes and other heavy objects shall, if considered necessary by Landlord, stand on supports of such thickness as is necessary to properly distribute the weight. Landlord will not be responsible for loss of or damage to any such safe or property in any case. Any damage to any part of the Building, its contents, occupants or visitors by moving or maintaining any such safe or other property shall be the sole responsibility and expense of Tenant.

5. No furniture, packages, supplies, equipment or merchandise will be received in the Building or carried up or down in the elevators, except between such hours, in such specific elevator and by such personnel as shall be designated by Landlord.

6. The requirements of Tenant will be attended to only upon application at the management office for the Project or at such office location designated by Landlord. Employees of Landlord shall not perform any work or do anything outside their regular duties unless under special instructions from Landlord.

7. No sign, advertisement, notice or handbill shall be exhibited, distributed, painted or affixed by Tenant on any part of the Premises or the Building without the prior written consent of the Landlord. Tenant shall not disturb, solicit, peddle, or canvass any occupant of the Project and shall cooperate with Landlord and its agents of Landlord to prevent same.

8. The toilet rooms, urinals, wash bowls and other apparatus shall not be used for any purpose other than that for which they were constructed, and no foreign substance of any kind whatsoever shall be thrown therein. The expense of any breakage, stoppage or damage resulting from the violation of this rule shall be borne by the tenant who, or whose servants, employees, agents, visitors or licensees shall have caused same.

9. Tenant shall not overload the floor of the Premises, nor mark, drive nails or screws, or drill into the partitions, woodwork or drywall or in any way deface the Premises or any part thereof without Landlord's prior written consent. Tenant shall not purchase spring water, ice, towel, linen, maintenance or other like services from any person or persons not approved by Landlord.

10. Except for vending machines intended for the sole use of Tenant's employees and invitees, no vending machine or machines other than fractional horsepower office machines shall be installed, maintained or operated upon the Premises without the written consent of Landlord.

11. Tenant shall not use or keep in or on the Premises, the Building, or the Project any kerosene, gasoline or other inflammable or combustible fluid, chemical, substance or material.

12. Tenant shall not without the prior written consent of Landlord use any method of heating or air conditioning other than that supplied by Landlord.

13. Tenant shall not use, keep or permit to be used or kept, any foul or noxious gas or substance in or on the Premises, or permit or allow the Premises to be occupied or used in a manner offensive or objectionable to Landlord or other occupants of the Project by reason of noise, odors, or vibrations, or interfere with other tenants or those having business therein, whether by the use of any musical instrument, radio, phonograph, or in any other way. Tenant shall not throw anything out of doors, windows or skylights or down passageways.

14. Tenant shall not bring into or keep within the Project, the Building or the Premises any animals, birds, aquariums, or, except in areas designated by Landlord, bicycles or other vehicles.

15. No cooking shall be done or permitted on the Premises, nor shall the Premises be used for the storage of merchandise, for lodging or for any improper, objectionable or immoral purposes. Notwithstanding the foregoing, Underwriters' laboratory-approved equipment and microwave ovens may be used in the Premises for heating food and brewing coffee, tea, hot chocolate and similar beverages for employees and visitors, provided that such use is in accordance with all applicable federal, state, county and city laws, codes, ordinances, rules and regulations.

16. The Premises shall not be used for manufacturing or for the storage of merchandise except as such storage may be incidental to the use of the Premises provided for in the Summary. Tenant shall not occupy or permit any portion of the Premises to be occupied as an office for a messenger-type operation or dispatch office, public stenographer or typist, or for the manufacture or sale of liquor, narcotics, or tobacco in any form, or as a medical office, or as a barber or manicure shop, or as an employment bureau without the express prior written consent of Landlord. Tenant shall not engage or pay any employees on the Premises except those actually working for such tenant on the Premises nor advertise for laborers giving an address at the Premises.

17. Landlord reserves the right to exclude or expel from the Project any person who, in the judgment of Landlord, is intoxicated or under the influence of liquor or drugs, or who shall in any manner do any act in violation of any of these Rules and Regulations.

18. Tenant, its employees and agents shall not loiter in or on the entrances, corridors, sidewalks, lobbies, courts, halls, stairways, elevators, vestibules or any Common Areas for the purpose of smoking tobacco products or

for any other purpose, nor in any way obstruct such areas, and shall use them only as a means of ingress and egress for the Premises.

19. Tenant shall not waste electricity, water or air conditioning and agrees to cooperate fully with Landlord to ensure the most effective operation of the Building's heating and air conditioning system, and shall refrain from attempting to adjust any controls.

20. Tenant shall store all its trash and garbage within the interior of the Premises. No material shall be placed in the trash boxes or receptacles if such material is of such nature that it may not be disposed of in the ordinary and customary manner of removing and disposing of trash and garbage in city in which the Building is located without violation of any law or ordinance governing such disposal. All trash, garbage and refuse disposal shall be made only through entry-ways and elevators provided for such purposes at such times as Landlord shall designate.

21. Tenant shall comply with all safety, fire protection and evacuation procedures and regulations established by Landlord or any governmental agency.

22. Any persons employed by Tenant to do janitorial work shall be subject to the prior written approval of Landlord, and while in the Building and outside of the Premises, shall be subject to and under the control and direction of the Building manager (but not as an agent or servant of such manager or of Landlord), and Tenant shall be responsible for all acts of such persons.

23. No awnings or other projection shall be attached to the outside walls of the Building without the prior written consent of Landlord, and no curtains, blinds, shades or screens shall be attached to or hung in, or used in connection with, any window or door of the Premises other than Landlord standard drapes. All electrical ceiling fixtures hung in the Premises or spaces along the perimeter of the Building must be fluorescent and/or of a quality, type, design and a warm white bulb color approved in advance in writing by Landlord. Neither the interior nor exterior of any windows shall be coated or otherwise sunscreened without the prior written consent of Landlord. Tenant shall abide by Landlord's regulations concerning the opening and closing of window coverings which are attached to the windows in the Premises, if any, which have a view of any interior portion of the Building or Building Common Areas.

24. The sashes, sash doors, skylights, windows, and doors that reflect or admit light and air into the halls, passageways or other public places in the Building shall not be covered or obstructed by Tenant, nor shall any bottles, parcels or other articles be placed on the windowsills.

25. Tenant must comply with requests by the Landlord concerning the informing of their employees of items of importance to the Landlord.

26. Tenant hereby acknowledges that Landlord shall have no obligation to provide guard service or other security measures for the benefit of the Premises, the Building or the Project. Tenant hereby assumes all responsibility for the protection of Tenant and its agents, employees, contractors, invitees and guests, and the property thereof, from acts of third parties, including keeping doors locked and other means of entry to the Premises closed, whether or not Landlord, at its option, elects to provide security protection for the Project or any portion thereof. Tenant further assumes the risk that any safety and security devices, services and programs which Landlord elects, in its sole discretion, to provide may not be effective, or may malfunction or be circumvented by an unauthorized third party, and Tenant shall, in addition to its other insurance obligations under this Lease, obtain its own insurance coverage to the extent Tenant desires protection against losses related to such occurrences. Tenant shall cooperate in any reasonable safety or security program developed by Landlord or required by law.

27. All office equipment of any electrical or mechanical nature shall be placed by Tenant in the Premises in settings approved by Landlord, to absorb or prevent any vibration, noise and annoyance.

28. Tenant shall not use in any space or in the public halls of the Building, any hand trucks except those equipped with rubber tires and rubber side guards.

29. No auction, liquidation, fire sale, going-out-of-business or bankruptcy sale shall be conducted in the Premises without the prior written consent of Landlord.

30. No tenant shall use or permit the use of any portion of the Premises for living quarters, sleeping apartments or lodging rooms.

Landlord reserves the right at any time to change or rescind any one or more of these Rules and Regulations, or to make such other and further reasonable Rules and Regulations as in Landlord's judgment may from time to time be necessary for the management, safety, care and cleanliness of the Premises, Building, the Common Areas and the Project, and for the preservation of good order therein, as well as for the convenience of other occupants and tenants therein. Landlord may waive any one or more of these Rules and Regulations for the benefit of any particular tenants, but no such waiver by Landlord shall be construed as a waiver of such Rules and Regulations in favor of any other tenant, nor prevent Landlord from thereafter enforcing any such Rules or Regulations against any or all tenants of the Project. Tenant shall be deemed to have read these Rules and Regulations and to have agreed to abide by them as a condition of its occupancy of the Premises.

EXHIBIT E-1

COLUMBIA CENTER

FORM OF TENANT'S ESTOPPEL CERTIFICATE

_____ [TENANT ENTITY TO BE INSERTED], the "Tenant" under that certain Office Lease (the "Lease") made and entered into as of _____, 20__ by and between _____ as Landlord, and Tenant, for Premises on the _____ floor(s) of the office building located at _____, Washington _____, certifies as follows:

1. Attached hereto as **Exhibit A** is a true and correct copy of the Lease and all amendments and modifications thereto. The documents contained in **Exhibit A** represent the entire agreement between the parties as to the Premises.

2. Tenant currently occupies the Premises described in the Lease, the Lease Term commenced on _____, and the Lease Term expires on _____, and Tenant has no option to terminate or cancel the Lease or to purchase all or any part of the Premises, the Building and/or the Project.

3. Base Rent became payable on _____.

4. To Tenant's knowledge, the Lease is in full force and effect. The Lease has not been modified, supplemented or amended in any way except as provided in **Exhibit A**.

5. Tenant has not transferred, assigned, or sublet any portion of the Premises nor entered into any license or concession agreements with respect thereto except as follows:

6. Tenant shall not modify the documents contained in **Exhibit A** without the prior written consent of Landlord's mortgagee.

7. All monthly installments of Base Rent, all Additional Rent and all monthly installments of estimated Additional Rent have been paid when due through _____. The current monthly installment of Base Rent is \$ _____.

8. To Tenant's knowledge, all conditions of the Lease to be performed by Landlord necessary to the enforceability of the Lease have been satisfied. Landlord is not in default under the Lease. In addition, Tenant has not delivered any notice to Landlord regarding a default by Landlord thereunder.

9. No rental has been paid more than thirty (30) days in advance and no security has been deposited with Landlord except as provided in the Lease.

10. To Tenant's knowledge, as of the date hereof, there are no existing defenses or offsets, or, to Tenant's knowledge, claims or any basis for a claim, that Tenant has against Landlord.

11. If Tenant is a corporation or partnership, each individual executing this Estoppel Certificate on behalf of Tenant hereby represents and warrants that Tenant is a duly formed and existing entity qualified to do business in the State of Washington and that Tenant has full right and authority to execute and deliver this Estoppel Certificate and that each person signing on behalf of Tenant is authorized to do so.

12. To Tenant's knowledge, there are no actions pending against Tenant under the bankruptcy or similar laws of the United States or any state.

13. To Tenant's knowledge, other than in compliance with all applicable laws and incidental to the ordinary course of the use of the Premises, Tenant has not used or stored any hazardous substances in the Premises.

14. To Tenant's knowledge, all tenant improvement work to be performed by Landlord under the Lease has been completed in accordance with the Lease and has been accepted by Tenant and all reimbursements and allowances due to Tenant under the Lease in connection with any tenant improvement work have been paid in full.

15. Any and all representations or warranties or other provisions in this Estoppel Certificate that are conditions on terms such as "actual knowledge" or "to Tenant's knowledge" or "about which Tenant has knowledge" are made to and limited by the present, actual knowledge of _____ [NAME], who has executed this Estoppel Certificate below and is an employee of King County who has reasonable knowledge of facts and circumstances associated with the Lease and is qualified to accurately provide the information set forth herein (the "Executing Individual"). The Executing Individual is a _____ [JOB TITLE] of the _____ [DIVISION OR DEPARTMENT] of Tenant. Subject to the foregoing provisions applicable to the qualifications of the person that may execute this Estoppel Certificate, the Executing Individual has made no inquiries or investigations with respect to Tenant's representations or warranties or other provisions prior to the making thereof and has no duty to undertake the same.

Tenant acknowledges that this Estoppel Certificate may be delivered to Landlord or to a prospective mortgagee or prospective purchaser, and acknowledges that said prospective mortgagee or prospective purchaser will be relying upon the statements contained herein in making the loan or acquiring the property of which the Premises are a part and that receipt by it of this certificate is a condition of making such loan or acquiring such property.

Executed at _____ on the ____ day of _____, 20__.

"Tenant":

a _____

By: _____
Its: _____

By: _____
Its: _____

EXHIBIT E-2

COLUMBIA CENTER

FORM OF TENANT'S ESTOPPEL CERTIFICATE
(CURRENT LENDER)

_____, 20____

Metropolitan Life Insurance Company

[_____]
[_____]

To whom it may concern:

The undersigned, [_____] ("Tenant"), as tenant under a lease (the "Lease") of certain premises dated [_____] executed by Tenant and [_____] ("Landlord"), does hereby state, declare, represent and warrant to Metropolitan Life Insurance Company and its subsidiaries and/or affiliates, as applicable, successors and assigns (collectively, "Lender"), as follows:

1. The copy of the Lease attached hereto as Exhibit A is a true and correct copy of the Lease and, to Tenant's knowledge, the Lease is in full force and effect. The Lease has not been amended, supplemented or changed, except as follows [if none, so state]:

2. Tenant has accepted possession of the premises demised under the Lease, and all items of an executory nature have been completed under the terms of the Lease, including, but not limited to, completion of construction of the demised premises (and all other improvements required under the Lease) in accordance with applicable plans and specifications and within the time periods set forth in the Lease and otherwise in accordance with the Lease, and payment of any improvement allowance or other funds owing by Landlord to Tenant. Tenant further acknowledges that the term commenced on [_____] and shall expire on [_____] unless sooner terminated or extended in accordance with the terms of the Lease.

3. No default or, to Tenant's knowledge, event that with the passing of time or the giving of notice, or both, would constitute a default (referred to herein collectively as a "default") on the part of Tenant exists under the Lease in the performance of the terms, covenants and conditions of the Lease required to be performed on the part of Tenant.

4. No default on the part of Landlord exists under the Lease in the performance of the terms, covenants and conditions of the Lease required to be performed on the part of Landlord.

5. Tenant has no option or right to purchase the property of which the premises are a part, or any part thereof.

6. To Tenant's knowledge, no rentals are accrued and unpaid under the Lease.

7. No prepayments of rentals due under the Lease have been made and no security or deposits as security have been made thereunder, except as set forth in the Lease.

8. To Tenant's knowledge, Tenant has no defense as to its obligations under the Lease and claims no setoff or counterclaim against Landlord.

9. To Tenant's knowledge, Tenant has not received notice of any assignment, hypothecation, mortgage, or pledge of Landlord's interest in the Lease or the rents or other amounts payable thereunder.

10. Tenant agrees to notify Lender of any default on the part of Landlord under the Lease which would entitle Tenant to cancel the Lease or to abate the rent payable thereunder, and further agrees that, notwithstanding any provisions of the Lease, no notice or cancellation thereof shall be effective unless Lender has received said notice and has failed within thirty (30) days after the expiration of the cure period provided to Landlord under the Lease to cure or commence to cure the default which gave rise to the notice of cancellation.

11. Tenant understands and acknowledges that Lender is about to make a loan to Landlord and receive as part of the security for such loan (i) a [Mortgage/Deed of Trust], Security Agreement and Fixture Filing encumbering Landlord's fee interest in the property of which the leased premises are a portion and the rents, issues and profits of the Lease and (ii) an Assignment of Leases which affects the Lease, and that Lender is relying upon the representations and warranties contained herein in making such loan.

12. Any and all representations or warranties or other provisions in this Estoppel Certificate that are conditions on terms such as "actual knowledge" or "to Tenant's knowledge" or "about which Tenant has knowledge" are made to and limited by the present, actual knowledge of _____ [NAME], who has executed this Estoppel Certificate below and is an employee of King County who has reasonable knowledge of facts and circumstances associated with the Lease and is qualified to accurately provide the information set forth herein (the "Executing Individual"). The Executing Individual is a _____ [JOB TITLE] of the _____ [DIVISION OR DEPARTMENT] of Tenant. Subject to the foregoing provisions applicable to the qualifications of the person that may execute this Estoppel Certificate, the Executing Individual has made no inquiries or investigations with respect to Tenant's representations or warranties or other provisions prior to the making thereof and has no duty to undertake the same.

[TENANT],
a _____]

By: _____
Name:
Title:

EXHIBIT A
TO TENANT ESTOPPEL CERTIFICATE

COPY OF LEASE AND AMENDMENTS TO LEASE

EXTENSION OPTION RIDER

This Extension Option Rider ("**Extension Rider**") is attached to and made a part of the Lease by and between Landlord and Tenant. The agreements set forth in this Extension Rider shall have the same force and effect as if set forth in the Lease. To the extent the terms of this Extension Rider are inconsistent with the terms of the Lease, the terms of this Extension Rider shall control.

1. **Extension Option.** Landlord hereby grants Tenant one (1) option (the "**Extension Option**") to extend the Lease Term for a period of five (5) years (the "**Option Term**"), which Extension Option shall be exercisable only by written "Exercise Notice" (as that term is defined below) delivered by Tenant to Landlord as provided below. Upon the proper exercise of the Extension Option, the Lease Term, as it relates to the entire Premises, shall be extended for the Option Term. Notwithstanding the foregoing, at Landlord's option, in addition to any other remedies available to Landlord under the Lease, at law or in equity, the Extension Option shall not be deemed properly exercised if as of the date of delivery of the Exercise Notice (as defined below) by Tenant: (i) Tenant has previously been in default under the Lease beyond all applicable notice and cure periods; and/or (ii) Landlord does not approve of Tenant's then-existing financial condition and/or Landlord's lender does not approve of the terms for the Option Term, including, without limitation, the Option Rent (as those terms are defined below). The Extension Option is personal to the original Tenant executing the Lease (the "**Original Tenant**") and may only be exercised by the Original Tenant (and not any assignee, sublessee or other transferee of Tenant's interest in the Lease) if the Original Tenant occupies the entire Premises as of the date of Tenant's delivery of the Exercise Notice and as of the commencement of the Option Term.

2. **Option Rent.** The Rent payable by Tenant during the Option Term (the "**Option Rent**") shall be equal to the rent (including additional rent and considering any "base year" or "expense stop" applicable thereto), including escalations, at which tenants, as of the commencement of the Option Term, are leasing non-sublease, non-encumbered, non-equity space comparable in size, location and quality to the Premises for a comparable term as the Option Term, which comparable space is located in the Project and in "Comparable Buildings," as that term is defined, below ("**Comparable Transactions**"), taking into consideration only the following concessions: (a) rental abatement concessions, if any, being granted such tenants in connection with such comparable space, and (b) tenant improvements or allowances provided or to be provided for such comparable space, taking into account, and deducting the value of, the existing improvements in the Premises, such value to be based upon the age, quality and layout of the improvements and the extent to which the same could be utilized by Tenant based upon the fact that the precise tenant improvements existing in the Premises are specifically suitable to Tenant. All other terms and conditions of this Lease shall apply throughout the Option Term; however, Tenant shall, in no event, have the option to extend the Lease Term beyond the Option Term described in Section 1, above. As used herein, the term "**Comparable Buildings**" shall mean first-class high-rise office buildings containing not less than 300,000 rentable square feet of space which are located in the area of Seattle bounded by Yesler Way on the South, Interstate 5 on the East, Stewart Street on the North, and Alaskan Way on the West.

3. **Exercise of Option.** The Extension Option shall be exercised by Tenant, if at all, only in the following manner: (i) Tenant shall deliver written notice ("**Interest Notice**") to Landlord not more than sixteen (16) months nor less than fourteen (14) months prior to the expiration of the initial Lease Term stating that Tenant may be interested in exercising the Extension Option; (ii) Landlord, after receipt of Tenant's notice, shall deliver notice (the "**Option Rent Notice**") to Tenant not less than thirteen (13) months prior to the expiration of the initial Lease Term setting forth the Option Rent; and (iii) if Tenant wishes to exercise the Extension Option, Tenant shall, on or before the date (the "**Exercise Date**") which is twelve (12) months prior to the expiration of the initial Lease Term, exercise the Extension Option by delivering written notice ("**Exercise Notice**") thereof to Landlord, and upon, and concurrent with, such exercise, Tenant may, at its option, object to the Option Rent contained in the Option Rent Notice, in which case the parties shall follow the procedure, and the Option Rent shall be determined, as set forth in Section 4, below. Tenant's failure to deliver the Interest Notice or Exercise Notice on or before the applicable delivery dates therefore specified hereinabove shall be deemed to constitute Tenant's waiver of the Extension Option.

4. **Determination of Option Rent.** In the event Tenant timely and appropriately objects to the Option Rent, Landlord and Tenant shall attempt to agree upon the Option Rent using their commercially reasonable, good-faith efforts. If Landlord and Tenant fail to reach agreement within fifteen (15) business days following Tenant's objection to the Option Rent (the "**Option Term Outside Agreement Date**"), then each party shall make a separate

determination of the Option Rent, as the case may be, within fifteen (15) business days, and such determinations shall be submitted to arbitration in accordance with Sections 4.1 through 4.7, below.

4.1 Landlord and Tenant shall each appoint one arbitrator who shall by profession be a real estate broker or lawyer who shall have been active over the five (5) year period ending on the date of such appointment in the leasing of Comparable Buildings. The determination of the arbitrators shall be limited solely to the issue area of whether Landlord's or Tenant's submitted Option Rent, is the closest to the actual Option Rent as determined by the arbitrators, taking into account the requirements of Section 2, above. Each such arbitrator shall be appointed within fifteen (15) days after the applicable Option Term Outside Agreement Date.

4.2 The two arbitrators so appointed shall within ten (10) days of the date of the appointment of the last appointed arbitrator agree upon and appoint a third arbitrator who shall be qualified under the same criteria set forth hereinabove for qualification of the initial two arbitrators.

4.3 The three arbitrators shall within thirty (30) days of the appointment of the third arbitrator reach a decision as to whether the parties shall use Landlord's or Tenant's submitted Option Rent, and shall notify Landlord and Tenant thereof.

4.4 The decision of the majority of the three arbitrators shall be binding upon Landlord and Tenant.

4.5 If either Landlord or Tenant fails to appoint an arbitrator within fifteen (15) days after the applicable Outside Agreement Date, the arbitrator appointed by one of them shall reach a decision, notify Landlord and Tenant thereof, and such arbitrator's decision shall be binding upon Landlord and Tenant.

4.6 If the two arbitrators fail to agree upon and appoint a third arbitrator, or both parties fail to appoint an arbitrator, then the appointment of the third arbitrator or any arbitrator shall be dismissed and the matter to be decided shall be forthwith submitted to arbitration under the provisions of the American Arbitration Association, but subject to the instruction set forth in this Section 4.

4.7 The cost of arbitration shall be paid by Landlord and Tenant equally.