

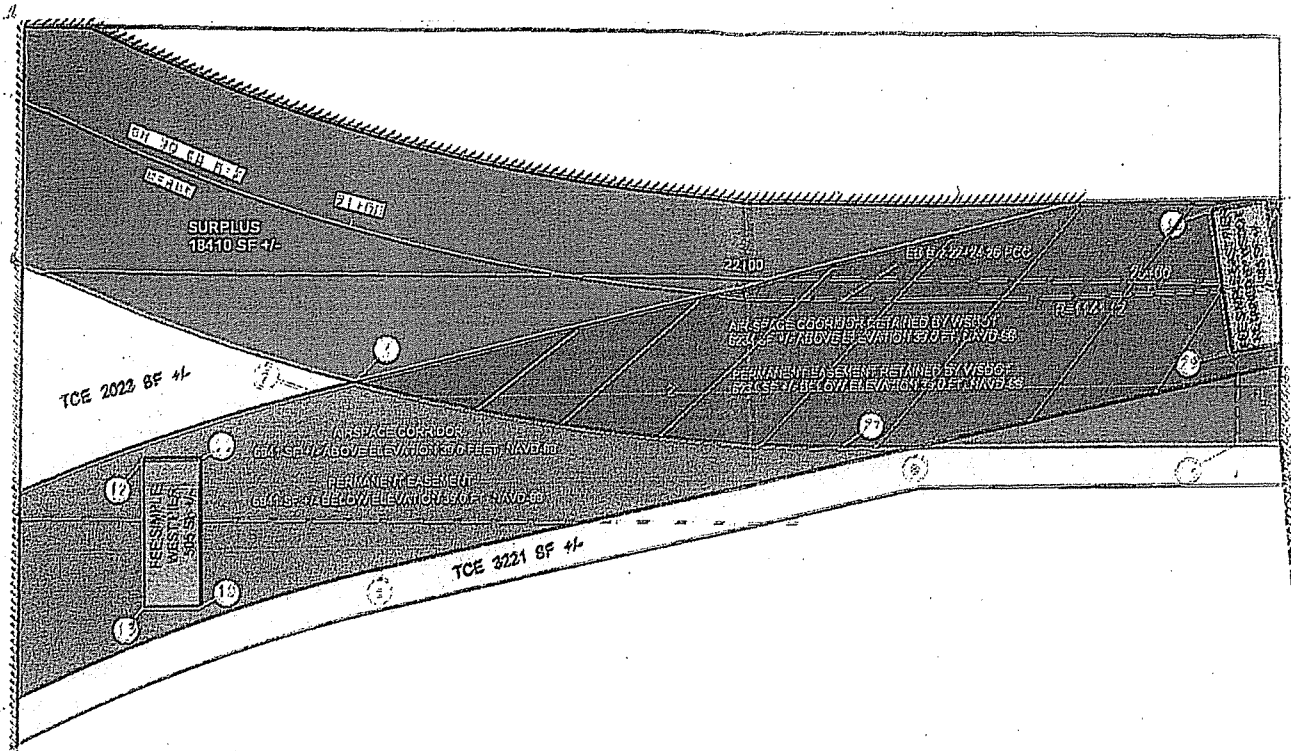





# ATTACHMENT TO TRANSMITTAL LETTER DEPICTION of EXCHANGED PROPERTY RIGHTS



## FROM WSDOT to COUNTY

-  "Leased Area' in Fee
-  Ingress and egress under highway structures as clearance permits

## FROM COUNTY to WSDOT

-  Fee Simple West Pier Area
-  Temporary Construction Easement
-  Fee Simple East Pier retained in Leased Area
-  Ground & Airspace Easements either retained in Leased Area OR granted in within the Base