

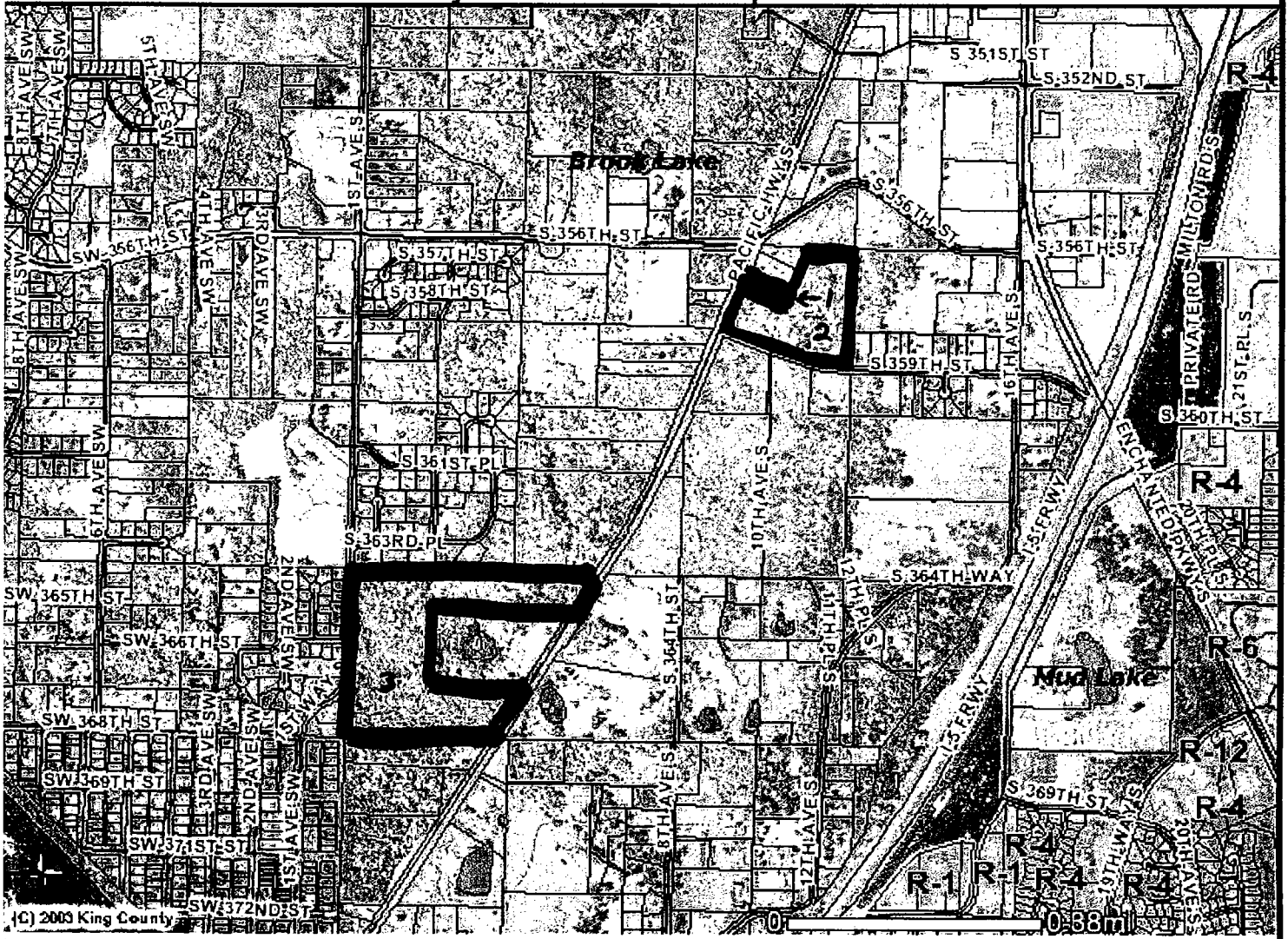

### Hylebos Transfer Properties



#### Legend

- Selected Features
- Streets
- Lakes and Large Rivers
- Parcel
- Incorporated Area
- Zoning Labels**
- Zoning**
- A 10 Agricultural one DU per 10 acres
- A 35 Agricultural one DU per 35 acres
- F Forest
- M Mixed land

- RA 25 Rural Area one DU per 5 acres
- RA 5 Rural Area one DU per 5 acres
- RA 10 Rural Area one DU per 10 acres
- UR Urban Reserve one DU per 5 acres
- R 1 Residential one DU per acre
- R 4 Residential 4 DU per acre
- R 6 Residential 6 DU per acre
- R 8 Residential 8 DU per acre
- R 12 Residential 12 DU per acre
- R 18 Residential 18 DU per acre
- R 24 Residential 24 DU per acre
- R 48 Residential 48 DU per acre

- NB Neighborhood Business
- CB Community Business
- RB Regional Business
- O Office
- I Industrial
- Cmsr
- 2000 Color Imagery (West King County)

The information included on this map has been compiled by King County staff from a variety of sources and is subject to change without notice. King County makes no representations or warranties, express or implied, as to accuracy, completeness, timeliness, or rights to the use of such information. King County shall not be liable for any general, special, indirect, incidental, or consequential damages including, but not limited to, lost revenues or lost profits resulting from the use or misuse of the information contained on this map. Any sale of this map or information on this map is prohibited except by written permission of King County.