

RECORDING NO.

VOL./PAGE

246/0

SCALE: 1 INCH = 200 FT.

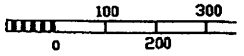

N 89°13'02" W 1326.54'
S 89°13'02" E 683.20' TO PC
1326.54' 643.34' NE 4TH ST
N 00°46'58" E 50.00'

RENTON ID 1502
N 181109.40
E 1308748.93

CASE
E
SE
EN
ANGLE
ED
DIVISION
DEWALK

SEATTLE
KC-CUMMINS
HEALTH BLDG
LOT 1
4.72107 AC.
LUA-01-090, SHPL
9130

LOT A
PORTION OF EXISTING LOT 2
60.020891 AC.
9003

LOT B
PORTION OF EXISTING LOT 2
3009 NE 4TH ST.
9133

LOT 3
LUA-01-090
5.30493 AC.
9133

JEFFERSON
E LINE OF THE V 1/2 OF
NE 1/4 OF THE NW 1/4
S 01°04'31" W 536.463'
S 01°04'31" W 1271.152'
S 01°04'31" W 1323.08'

MONROE AV NE
N 01°04'17" E 1323.08'

Cemetery Property

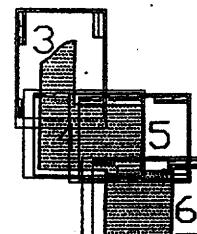

SHEET INDEX

Storage facility

ROADS
TO CITY OF
RENTON
FOR
PARKS
FACILITIES
MINIMUM
STATION

LOT A
60.020891 AC.
9003
PORTION OF EXISTING LOT 2
LUA-01-090, SHPL

LOT 4
LUA-01-090, SHPL
2.63792 AC.
9133

ROADS
LOT A
60.020891 AC.
9003
PORTION OF EXISTING LOT 2
LUA-01-090, SHPL

- LEGEND
- CORNER & MONUMENT IN CASE OF FOUND SECTION CORNER
 - CALCULATED SECTION CORNER
 - FOUND QUARTER CORNER MONUMENT IN CASE OF MONUMENT FOUND
 - MONUMENT FOUND
 - REBAR OR IRON PIPE FOUND
 - 5/8" IRON WASHER STAMPED LS18922
 - TAX LOT NO.
 - BENJAMEN STAINLESS AL WASHER SCRIBED
 - SET 3/8" IRON WASHER STAMPED LS 29292



2/13/08

CASSIDY COVE
SUBDIVISION
KING COUNTY DEPARTMENT OF TRANSPORTATION
RENTON FACILITY
KING COUNTY DEPARTMENT OF TRANSPORTATION
ROADS SERVICES DIVISION - SURV
155 MONROE AVE. NE, RENTON WA
(206)296-6508 FAX (206)296-
JOB NO. 02067 M46993