

2011-09

KING COUNTY
WATER DISTRICT
NO. 119
SERVICE
AREA BOUNDARY

PROPOSED
ANNEXATION

KING COUNTY
WATER DISTRICT
NO. 119
CORPORATE
BOUNDARY

TOWNSHIP 26 N, RANGE 7 EAST

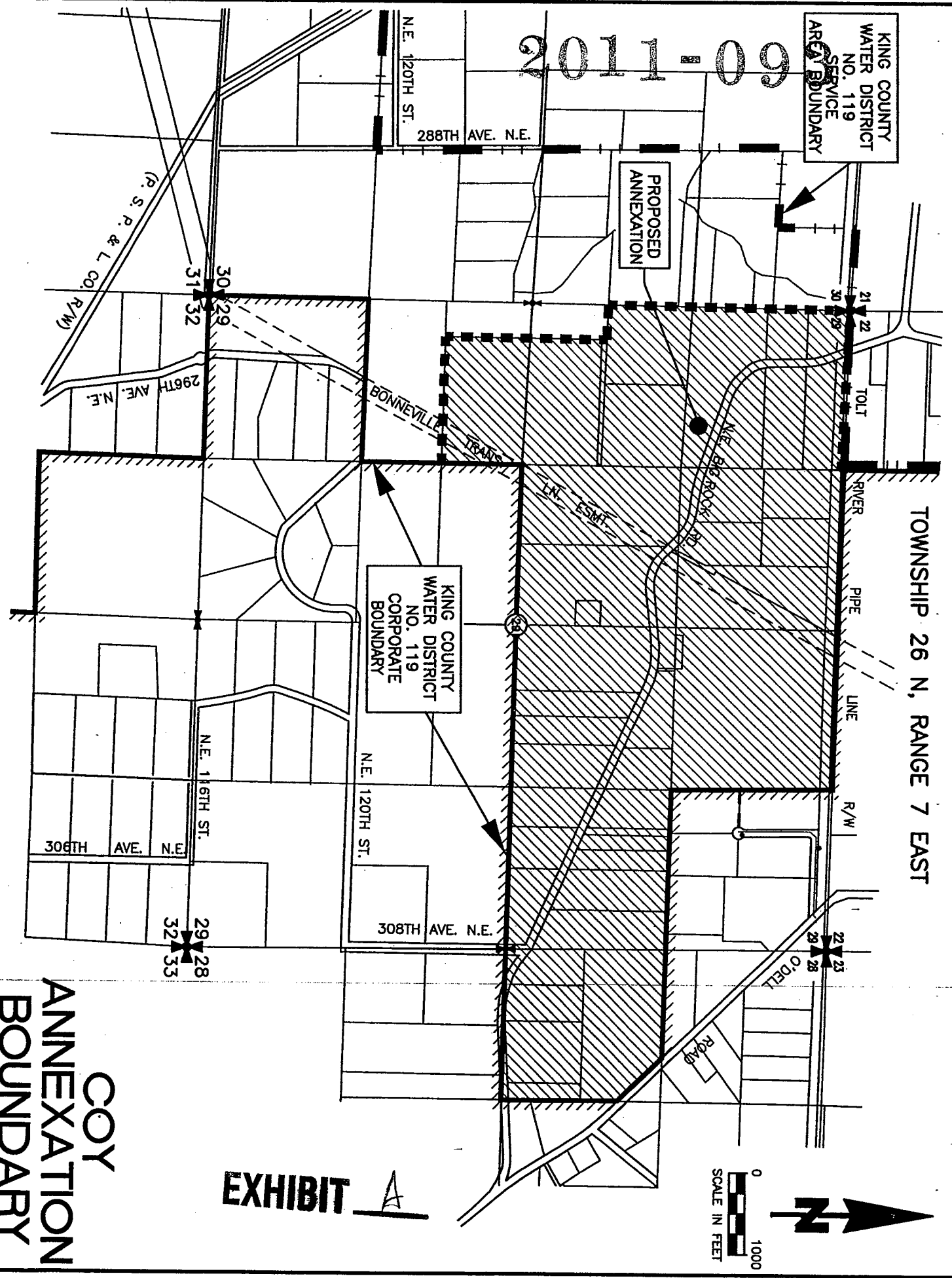

COY
ANNEXATION
BOUNDARY

EXHIBIT A