

ATTACHMENT A

15058

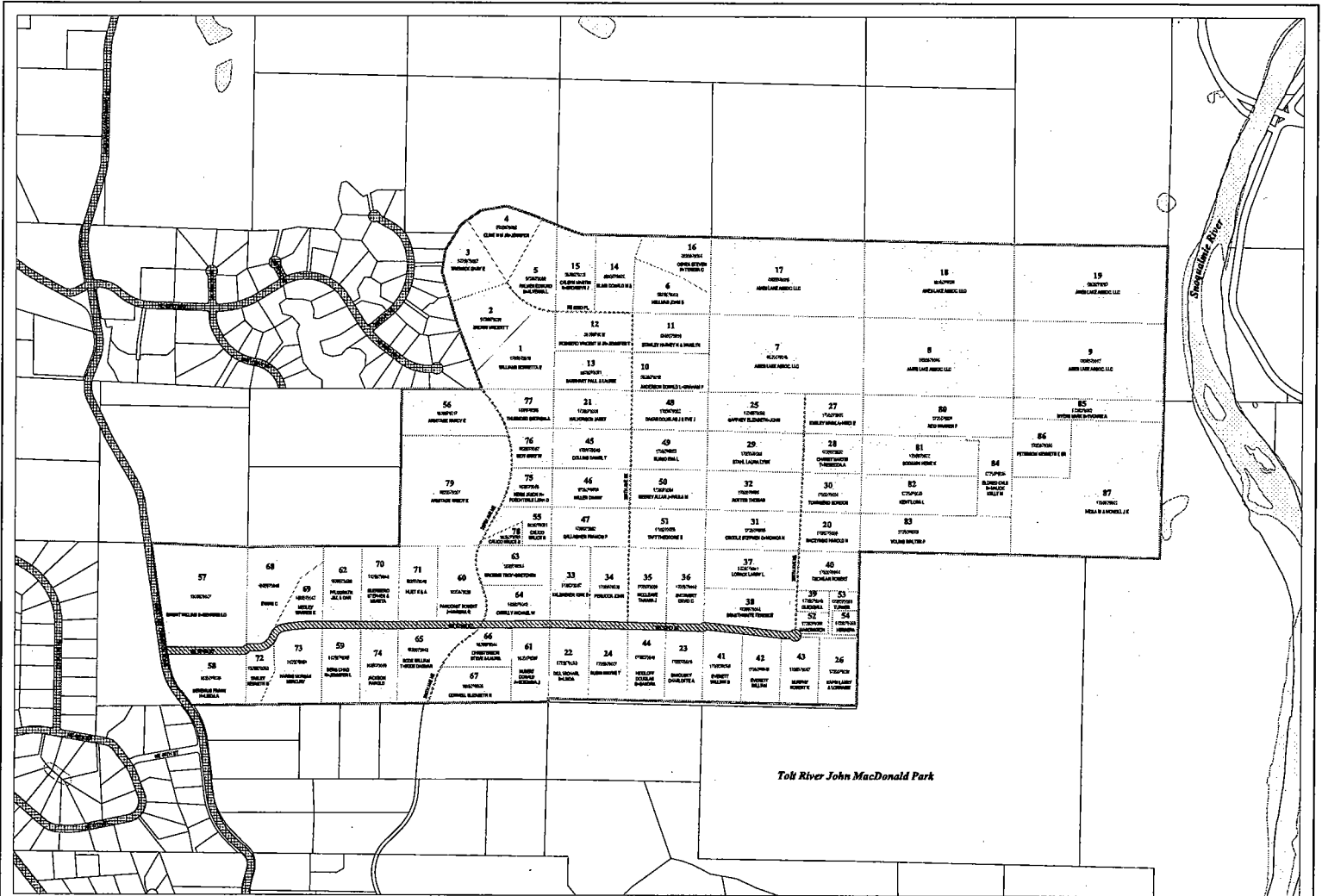

Proposed RID

For NE 52nd Street

- RID Assessment Area
- Improvement Area
- Existing Mainlined Roads
- Parcels proposed to be assessed @ 5,259.62 each
- Private Road Easements
- Water Area
- Parks
- Incorporated Area



The information included on this map has been compiled by King County and does not constitute a warranty or representation by King County. King County does not warrant the accuracy, completeness, or timeliness of the information. King County shall not be liable for any damages, including consequential damages, arising from the use of this information. The information is provided as a public service and is not intended to be used for any other purpose. King County is not responsible for any errors or omissions in this information. King County is not responsible for any actions taken based on this information. King County is not responsible for any actions taken based on this information.

King County Overview

