

FEDERAL WAY

AUBURN

KING COUNTY

TACOMA

MILTON

PACIFIC

ALGONA

FIFE

EDGEWOOD

SUMNER

ENUMCLAW

BONNEY LAKE

PUYALLUP

SOUTH PRAIRIE

PIERCE COUNTY

ORTING

CARBONADO

ENUMCLAW

TRAIL SEGMENT A COMPLETE

FUTURE WHITE RIVER BRIDGE

FUTURE TRAIL SEGMENT B

LOCATION OF HISTORIC BOISE CREEK BRIDGE

BUCKLEY

PIERCE COUNTY

LEGEND

Foothills Trail

- Future
- Completed

Other Trails

- Existing
- - - Planned

- Major Road
- - - County Boundary



BRIDGE RENDERINGS



BRIDGE RENDERINGS



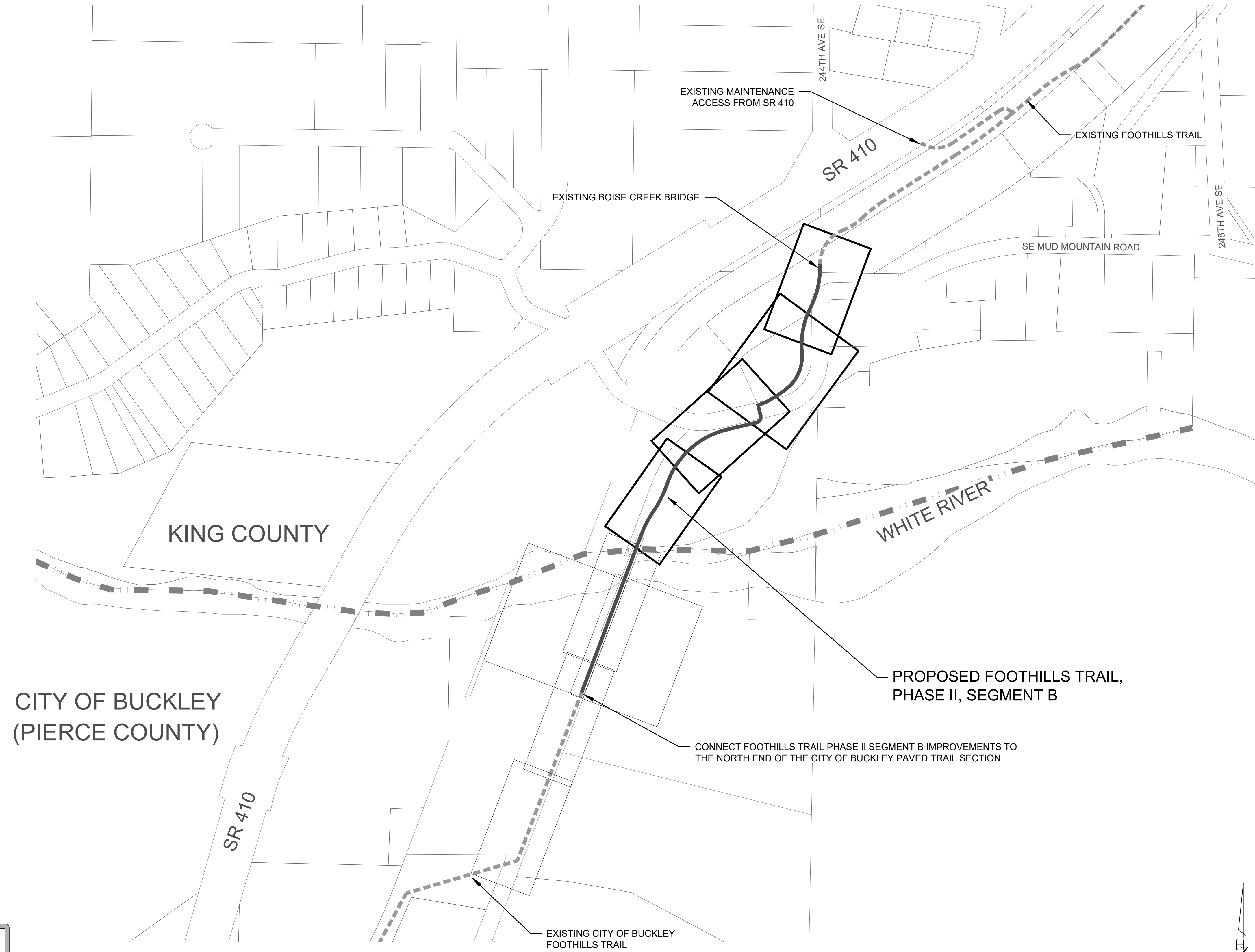

King County

Department of Natural Resources
and Parks
Parks and Recreation Division
King Street Center, KSC-NR-0700
201 So. Jackson Street, Suite 700
Seattle, Washington 98104
Telephone: (206) 477-4527
Fax: (206) 263-6217

HUITZOLARS
Huitzolars & Associates, Inc. - Seattle
818 Stewart St. Suite 1120
Seattle, Washington, 98101-1479
Phone (206) 324-5500 Fax (206) 328-1880



FOOTHILLS TRAIL
PHASE II SEGMENT B
KING COUNTY DEPT. OF NATURAL RESOURCES & PARKS
CONTRACT # C---

ISSUE / REVISIONS		
ID	DATE	DESCRIPTION
△	2/13/2020	30% SUBMITTAL
△	12/30/2020	65% SUBMITTAL
△	5/24/2021	90% SUBMITTAL

PROJECT NO. 15095305
SITE NO.
FILE
CONTRACT NO. E00115E08 - AM. 20
DRAWN BY VUL CHECKED BY GRS

SHEET TITLE
**OVERALL TRAIL
PLAN KEY MAP**

GRDE XX-XXXX

KING COUNTY DLSPD APPROVAL

Review Engineer	Completion Date
Senior Engineer	Completion Date
Scott Smith, P.E. DEVELOPMENT ENGINEER	Approval Date

GI-004



Know what's below.
Call before you dig.

90% SUBMITTAL

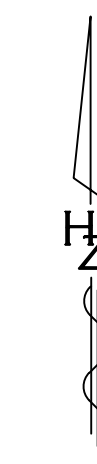



King County

Department of Natural Resources and Parks
Parks and Recreation Division
King Street Center, KSC-NR-0700
201 So. Jackson Street, Suite 700
Seattle, Washington 98104
Telephone: (206) 477-4527
Fax: (206) 263-6217

HUITZOLARS
Huitzolars, Inc.
818 Stewart St, Suite 1120 Seattle
Seattle, Washington, 98101-1479
Phone (206) 324-6500 Fax (206) 328-8880

FOOTHILLS TRAIL
TRAIL IMPROVEMENTS - PHASE II
KING COUNTY DEPT. OF NATURAL RESOURCES & PARKS

ISSUE / REVISIONS		
ID	DATE	DESCRIPTION

PROJECT NO. 15095303
SITE NO.
FILE
CONTRACT NO. E00115E08 - AM. 8
DRAWN BY LAJ CHECKED BY GS

SHEET TITLE
SITE PLAN

EX-1

1 OF 1

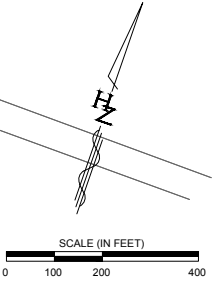
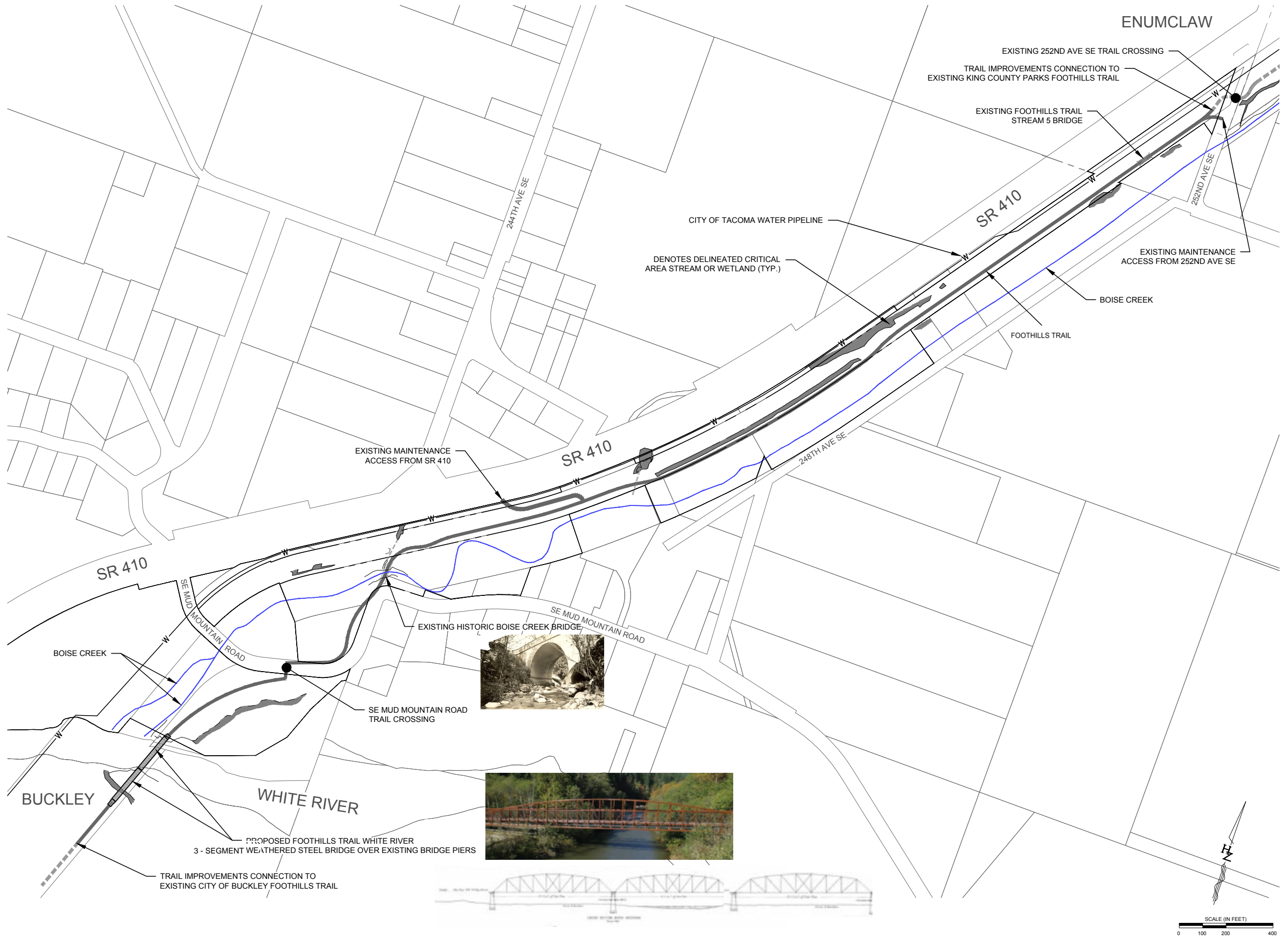

J:\15095303 Foothills Trail Amd 716_AMENDMENT 8111_DESIGN_CAD\Exhibits\ Foothills Trail SEPA exhibit.dwg Wednesday, September 07, 2016 10:54am

SEC. 34 & 35, T 20 N, R 6 E, W.M.

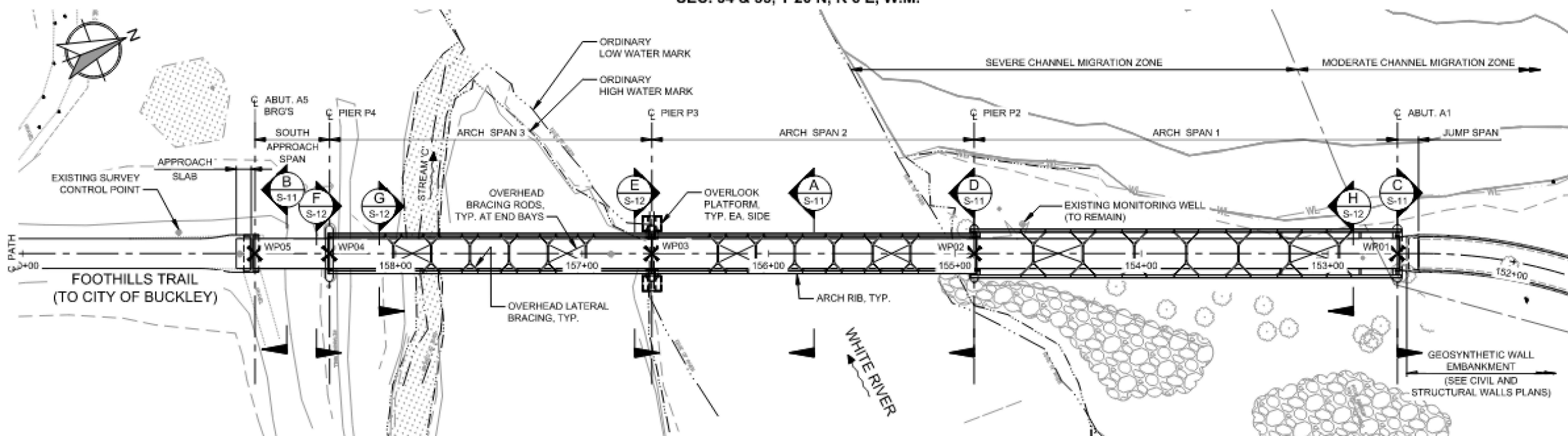

PLAN
SCALE: 1" = 30'

