

SECTION 2.1: EXISTING INTERIOR CONDITIONS

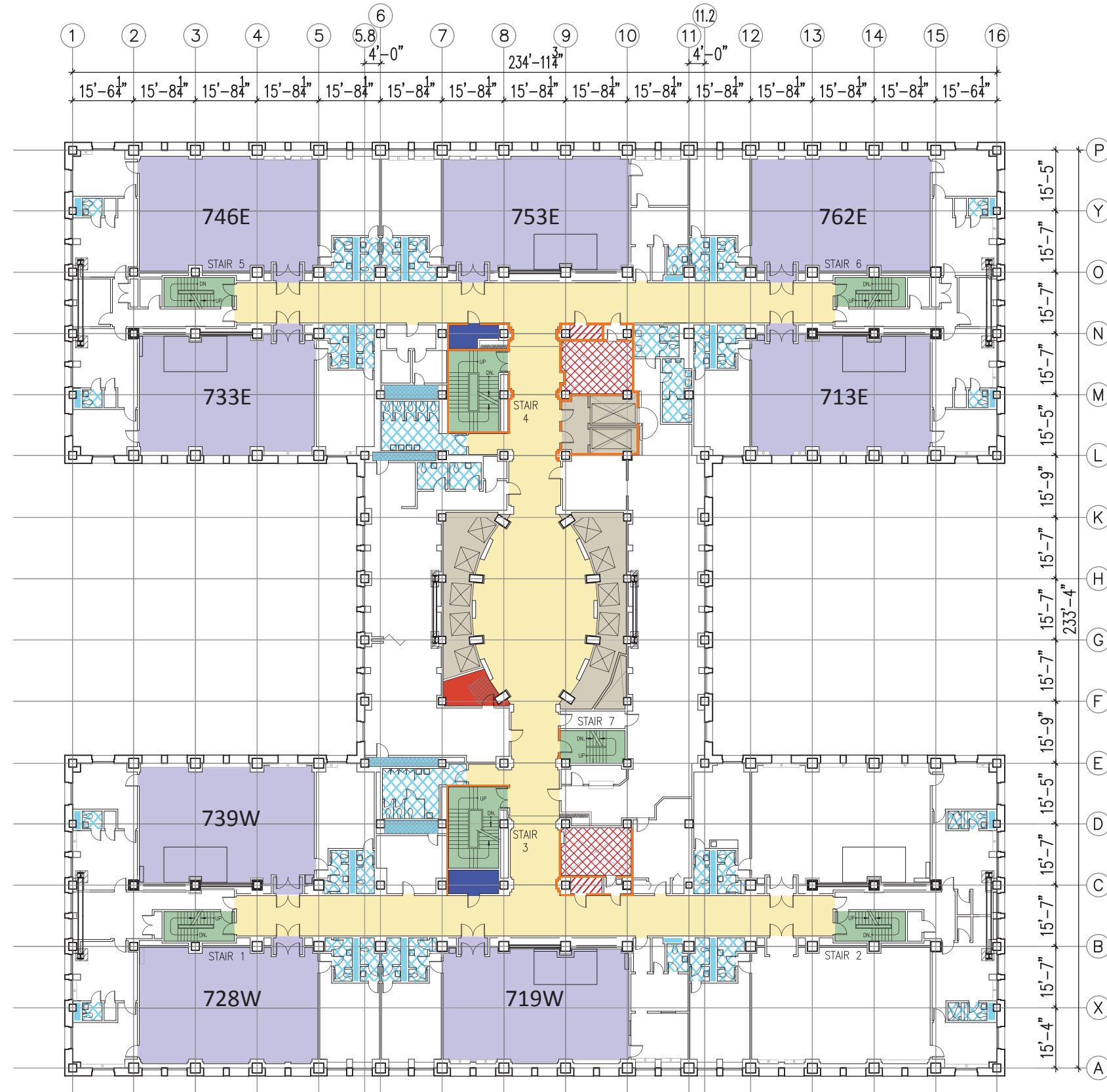

- Remaining clay tile walls at vertical stairs and elevators
  - Vertical MEP shaft / chase
  - Electrical distribution / rooms
  - Elevator hoistway
  - Stairs
  - Vertical plumbing chase
  - Restrooms
  - Historic designated corridors 1987 & 1994
  - Historic court rooms
- Courtooms:**
- 713E: "Traditional Dark"
  - 719W: "Traditional Light"
  - 720W: "Traditional Light"
  - 733E: "Traditional Dark"
  - 739W: "Traditional Light"
  - 746E: "Traditional Dark"
  - 753E: "Traditional Dark"
  - 762E: "Traditional Dark"
- Note:**  
This refers to the color of the wood stain in the courtroom, as described in the historic designation memorandum of understanding.
- Intermediate distribution frame (IDF) room & vertical telecommunications riser
  - Telecommunications & security equipment

LEVEL 7